



COSTS AND
 DIAMOND DRILL LOGS
 FOR
 HOLES 80 B-2
 80 B-3

BAR CLAIM GROUPS

YA 27	BAR 2	YA 26	BAR 1
YA 29	BAR 4	YA 28	BAR 3
YA 30-33	BAR 5-8	YA 917-922	BAR 13-18
YA 913-916	BAR 9-12		
YA 923,924	BAR 19,20		

WATSON LAKE MINING DISTRICT
 MAP SHEETS 105C/8,9

OPERATOR: D.C. SYNDICATE

JULY 6, 1980

090651

This report has been examined by the Geological Evaluation Unit and is recommended to the Commissioner to be considered as representation work for the amount of

\$ 9200.00

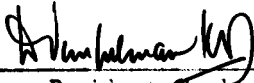

Resident Geologist or
Resident Mining Engineer

Considered as representation work under
Section 53 (4) Yukon Quartz Mining Act.



B. R. BAXTER
Supervising Mining Recorder

Commissioner of Yukon Territory

TABLE OF CONTENTS

	<u>PAGE</u>
COST OF DIAMOND DRILL PROGRAM	1
COPIES OF INVOICES FOR DRILLING	2
DIAMOND DRILL LOGS	5
VERTICAL SECTION 20+00W DRILL HOLE B-2	FOLLOWING PAGE 11
VERTICAL SECTION 20+00W DRILL HOLE B-3	FOLLOWING PAGE 11
TOPOGRAPHIC MAP 1"-50' SHOWING LOCATION OF DRILL HOLES	IN POCKET OF REPORT
FIGURE 1 LOCATION MAP 1:250,000	FOLLOWING PAGE 4
FIGURE 2 GRID LOCATION 1"- $\frac{1}{2}$ mile	FOLLOWING PAGE 4

BAR CLAIM GROUP

MAPS 105C/8,9

COST OF DIAMOND DRILL PROGRAM JUNE 1980.

INVOICE	\$22,346.18
INVOICE	\$14,244.37
	<hr/>
TOTAL	\$36,590.55

TOTAL FOOTAGE DRILLED:

80 B-1	348'
B-2	292' #
B-3	287' #
B-4	188' #
	<hr/>
	1115'

FILED FOR ASSESSMENT WORK

TOTAL DRILLING COST PER FOOT $\frac{\$36,590.55}{1115} = \32.816

COST OF DRILL HOLE 80 B-2 292' @ \$32.816 = \$9,582.45

COST OF DRILL HOLE 80 B-3 287' @ \$32.816 = \$9,418.37

ASSAYS ARE NOT INCLUDED IN THE DRILL LOGS SINCE THEY ARE NOT YET AVAILABLE (JULY 6).

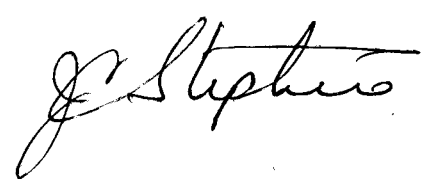

Drilcor Industries Ltd.

18 - 12871 Bathgate Way
 Richmond, British Columbia
 Canada V6V 1Y5

Telephone (604) 273-1878
 Telex 04-357519

July 2/80

8005/1

INVOICE

J.C. Stephen Exploration Ltd.
 1124 W. 15th Street,
 North Vancouver, B.C.
 V7P 1M9

re: diamond drilling - Bar Group

HW-1: Drilling Footage - Wolf River

		<u>BW Casing</u>	<u>BQ Coring</u>	
DDH-1	0-28.5	28.5		
	0-348		348'	
DDH-2	0-38.5	38.5		
	0-292		292'	
DDH-3	0-33.5	33.5		
	0-67		67'	
		<u>100.5</u>	<u>707'</u>	
		@ 12.50	@ 22.50	
		1,256.25	+ 15,907.50	17,163.75

LaborMan Hours

June 4	28		
5	09		
7	27½		
8	75		
9	22		
10	02		
11	06		
12	16		
15	17		
	<u>202.5</u>	@ 17.50/hr.	<u>3,543.75</u>

20,707.50

Additives

8 bags mud @ 11.50	92.00	
1 Alcomber	<u>232.53</u>	<u>324.53</u>
		21,032.03

Invoice: 8005/1

2.

3.

J.C. Stephen Exploration Ltd.
July 2, 1980.

b/f

21,032.03

Mob:

Load Camp Gear to Teslin: 1,169.10 + 10%
Your ½ of Truck Rental: 25.59 + 10%

1,286.01

28.14

\$22,346.18

A handwritten signature in black ink, appearing to read "J.C. Stephen". The signature is written in a cursive style and is positioned in the lower right quadrant of the page.

Drilcor Industries Ltd.

18 - 12871 Bathgate Way
 Richmond, British Columbia
 Canada V6V 1Y5

Telephone (604) 273-1878
 Telex 04-357519

INVOICE 8005/2

July 3, 1980.

J.C. Stephen Exploration Ltd.
 1124 W. 15th Street,
 North Vancouver, B.C.
 V7P 1M9

Diam. Drilling Bar Group: June 16-19/80

HW-1 Drilling Footage - Wolf River.

	<u>BW Casing</u>	<u>BQ Coring</u>	
DDH-3		67-287 : 220	
DDH-4	0-23.5	0-188 : 188	
	<u>23.5 @ 12.50 = 293.75</u>	<u>408 @ 22.50</u>	9,180.00
			293.75

Man Hours

June 16	-		
17	41		
18	06		
19	48		
	<u>95 hrs. @ 17.50</u>		1,662.50

Local pickup & del. to Swift River			
Lumber, plywood & fuel		60.00	
Groc. - del		60.00	
Gas & Groc.		<u>75.00</u>	
		195.00 + 10%	214.50

Materials Consumed

40 Core boxes @ 7.00	280.00	
25 Core box lids @ 2.00	50.00	
30 Groved c/boxes-Watson @ 4.85+15%	167.33	
4 propane @ 21.80	87.20	
3 bentonite @ 11.50	34.50	
1 casing advancer	117.70	
1 casing shoe 12305	171.50	
(above 2 items left in hole)		
Accomm. & meals-Teslin: 666.50+10%	733.15	
Drilcor truck mileage: 800km @ 25	<u>200.00</u>	1,841.38

Cook's Wages: 1900.00x125x13/30 36/89	416.28 + 10%	457.60
Groceries: 4th 1187.95		
13th 148.53		
	<u>1336.48x36/89</u>	540.59 + 10%
		<u>594.64</u>
		<u>\$14,244.37</u>

OK J.C. Stephen

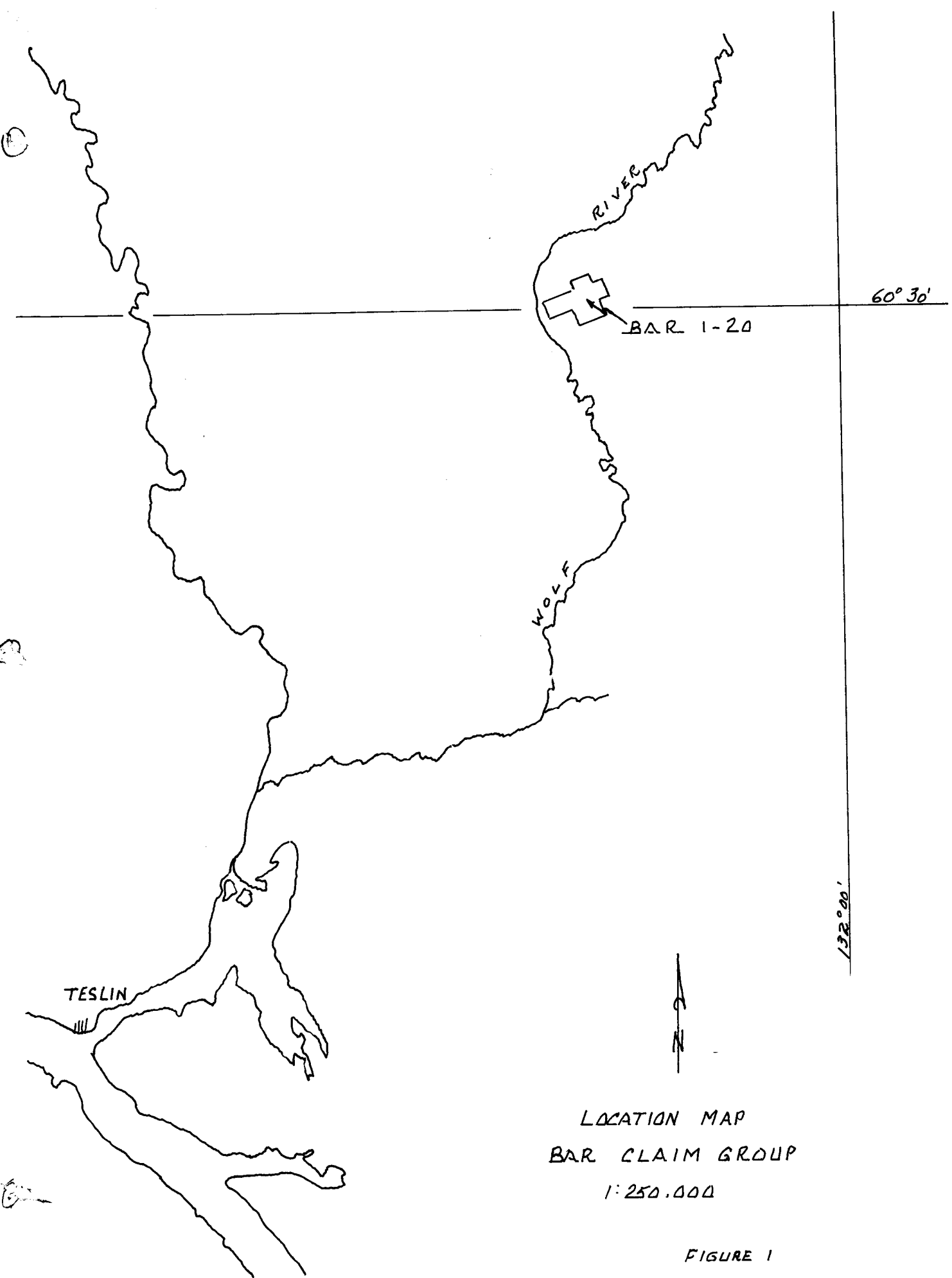

LOCATION MAP
BAR CLAIM GROUP
1:250,000

FIGURE 1

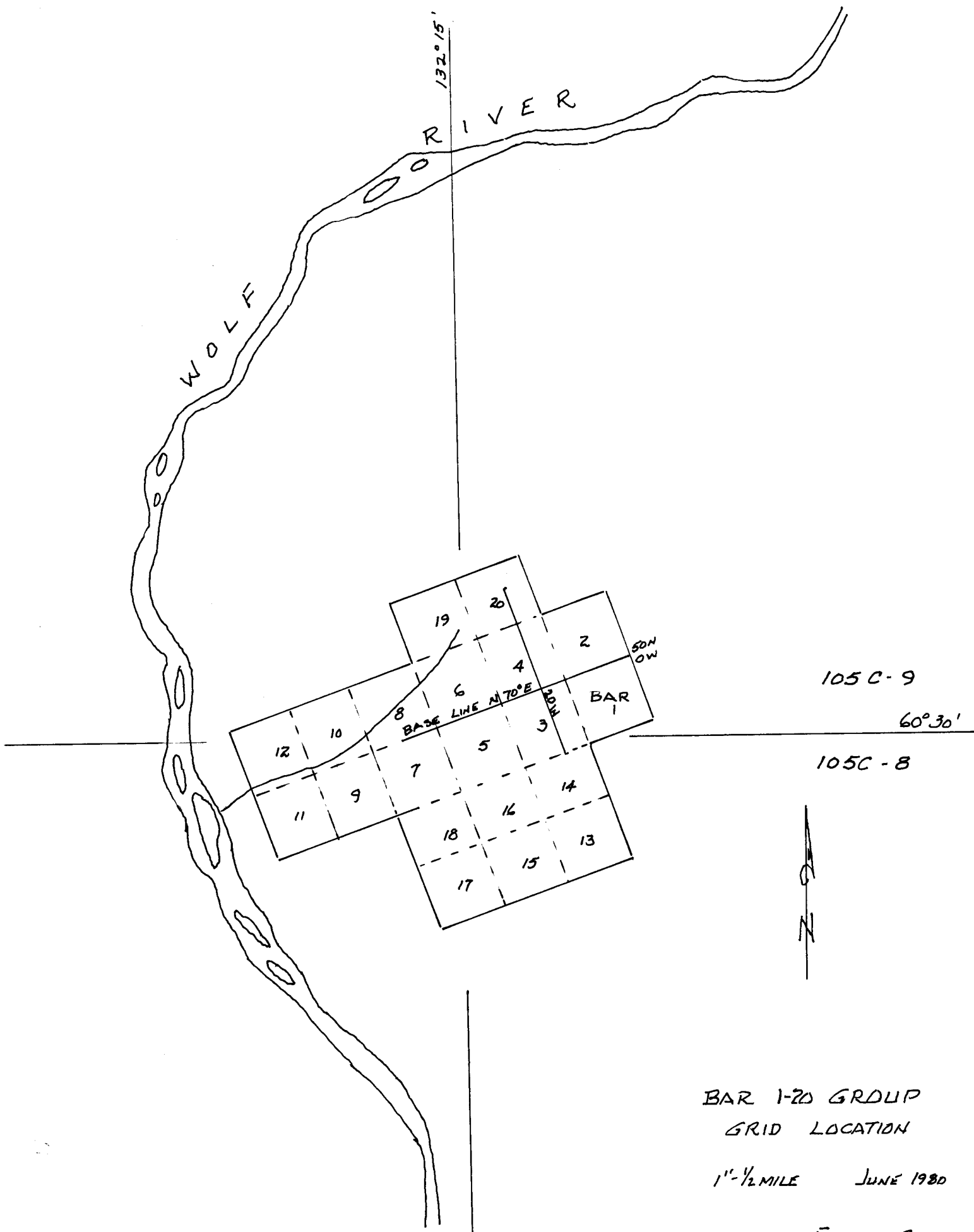

FIGURE 2

SURVEY:		ANGLE	
Footage	Bearing	Reading	Corrected

Purpose Comment

0-6.5 OVERBURDEN
 6.5-23.5 OVERBURDEN, ROCK SLABS - CASING
 BROKEN FRAGMENTS GREY-GREEN CHERT

33-61. GREY-GREEN CHERT, WELL FRACTURED: LIMONITE ON FRACTURE SURFACES, LEACHED

61-101. GREY-GREEN CHERT, VERY LEACHED, MINOR PYRITE AT 35-40"
 MINOR PYRITE ON WEAK FRACTURES

101-113 FRESHENED CHERT SEAMING BY PYRITE & MINOR BARITE. SOME HEMATITE IN CHERT. MINERALIZATION WEAK 101-113

113-131.3 CLEAN COLORED FELDSPATHIC LOOKING CORAL CHERT - BIFURCIA

ALTERATION

MINERAL

FRACTURING

SCALE 1" = 20'

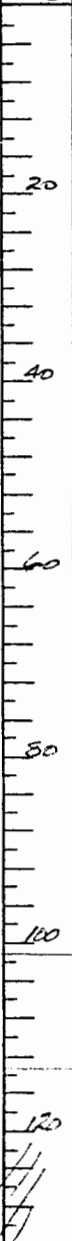

BOX NO.

% CORE RECOVERED

DRILLING INTERVAL

Length

Bearing 330° 30' N (340°)

Dip -60°

Lat. 48° N

Dep. 20 W

Elev. 3760

O.B. Thickness

B.R. Thickness

Contractor DRILCOR

Core BR

Casing

Logged by JCS

Location

Date June 13 - 1980

Started

Finished

Hole No. SD B-3

Project DE SYPHONIA

Claim BAR 3

Page 1 of

J.C. STEPHEN
EXPLORATIONS LTD.

SURVEY:		ANGLE	
Footage	Bearing	Reading	Corrected

Pyrite mineralization on fractures - spotty

131.3-159 Grey fine chert blocks - appears veiled. Considerable
 Py. mineralization. up to 30%

159 - 201 Quartzite - massive - relatively fine grained.
 very minor fracturing and Qtz veins, bedding
 at about 50° indistinct
 166.3-172 pale grey green in color.
 171-201.5
 205.5-208
 Pyrite mineralization on fractures, and veins, irregular
 zones at 174, 178, 183 with little barite; 187 1/2 - 189 1/2
 204-205, 210.5; 212.5 with little barite
 grey green Qtz veins generally barren

238-291 FINE GRAINED, BETTER BEDDED GREENISH TO GREY
 TAIN BEDS AT 40° TO CORE CHERTY
 SESS

GEOLOGY	MINERAL	FRACTURING	ALTERATION	SCALE	BOC No.	% CORE RECOVERED	DR LING INTERVAL	Purpose Comment
	P ₁			120				
	P ₄			140				
	P ₄			160				
	P ₄			180				
				200				
				220				
				240				
				260				
				280				
				300				

Length _____ Contractor _____
 Bearing _____ Core _____ Stored _____
 Dip _____ Casing _____
 Log _____ Logged by _____ Date _____
 Dev. _____ Location _____
 Elev. _____
 O.H. Thickness _____ Started _____ Finished _____
 B.R. Thickness _____ Started _____ Finished _____
 Claim _____
 Hole No. _____
 Project _____
 Page 2 of _____

J.C. STEPHEN
EXPLORATIONS
LTD.

SURVEY:		ANGLE	
Footage	Bearing	Reading	Corrected

Purpose
Comment

281 3" MASSIVE WHITE ~~FAULT~~ ^{FABRIC} WITH SPALLS
 280 2" 15.5' OF MIN
 281 7' FROM BY VEINING
 291 END HOLE

GEOLGY
MINERAL
FRACTURING
ALTERATION

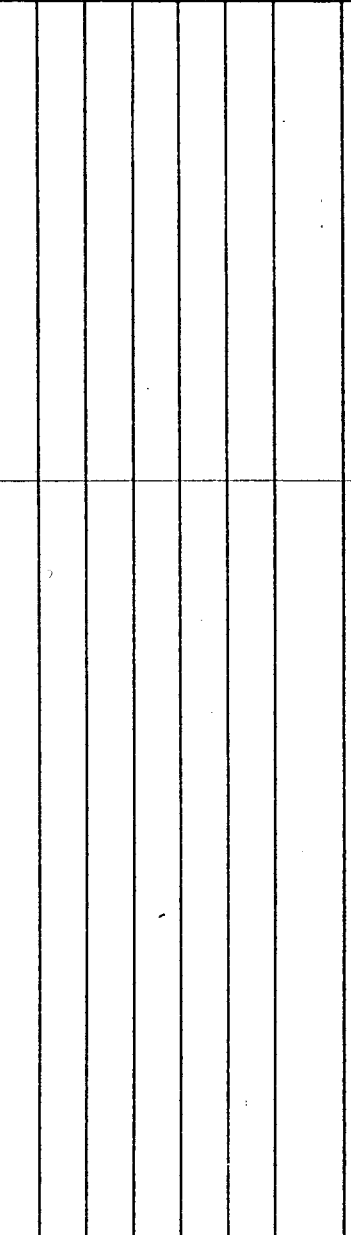

SCALE
1" = _____
240

BOX No. _____

% CORE
RECOVERED _____

DRILLING
INTERVAL _____

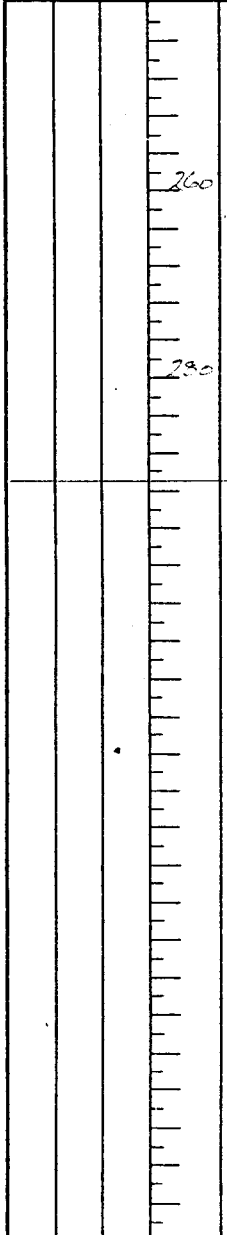

Length _____ Contractor _____
 Bearing _____ Core _____ Stored _____
 Dip _____ Casing _____
 Lot _____ Logged by _____ Date _____
 Dep _____ Location _____
 Elev. _____
 O.B. Thickness _____ Started _____ Finished _____
 B.R. Thickness _____ Started _____ Finished _____
 Hole No. _____
 Project _____
 Claim _____
 Page 3 of _____

**J.C. STEPHEN
EXPLORATIONS
LTD.**

SURVEY:		ANGLE	
Footage	Bearing	Reading	Corrected

Purpose
Comment

142' GRAY TO GREENISH GREY FINE GRAINED CHERT OR ARGILLACEOUS CHERT, BEDDING AT 35°, FAIRLY MASSIVE - WEAK FRACTURING WITH PYRITE

174.5 - 175.6 DARK GREY CHERTY ARGILLITE

177 - 237 DARK GREY ARGILLITE, BEDDING SOMEWHAT VARIABLE 60° AT 180', 45° @ 215' LOCALLY UP TO 75° NEAR 270' OCCASIONAL FRACTURES WITH PYRITE

SECTIONS VARY FROM FINE GRAINED GRITTY ARGILLITE TO IRREGULARLY THIN BEDDED TO MASSIVE.

241 - 249 NARROW SILTY GRAY CORE VEINING AT 15° TO CORE

287' END LOG

GEOLOGY
MINERAL
FRACTURING

ALTERATION

SCALE
1" = 20'
120
140
160
180
200
220
240

BOC No.
% CORE RECOVERED
DRILLING INTERVAL

Length
Bearing
Dip
Log
Dep.
Elev.

Contractor
Core
Casing
Logged by
Location
Date

O.B. Thickness
B.R. Thickness
Started
Finished

Hole No. 80 B-3
Project
Claim
Page of

J.C. STEPHEN
EXPLORATIONS
LTD.

From	To	Width	Recovery		Sample	Assays								
			ft./lbs.	%		Zn	Ag	B ₂ SO ₄						
45.0	50.0	5.0			48AAA									
50	57	7.0			45									
57	62	5.0			46									
62	72	10.0			47									
72	82	10.0			48									
82	92	10.0			49									
92	102	10.0			50 A									
102	107	5.0			5258 B									
107	112	5.0			59									
112	122	10.0			60									
122	132	10.0			61									
132	142	10.0			62									

Length _____ Contractor _____
 Bearing _____ Core _____ Stored _____
 Dip _____ Casing _____
 Lat. _____ Logged by _____ Date _____
 Dep. _____ Location _____
 Elev. _____
 O.B. Thickness _____ Started _____ Finished _____
 B.R. Thickness _____ Started _____ Finished _____

**J.C. STEPHEN
EXPLORATIONS
LTD.**

Hole No. 80 B-3
 Project DC. SYNDICATE
 Claim BAR 4
 Page _____ of _____

64100N

62100N

57100N

Elev 3800'

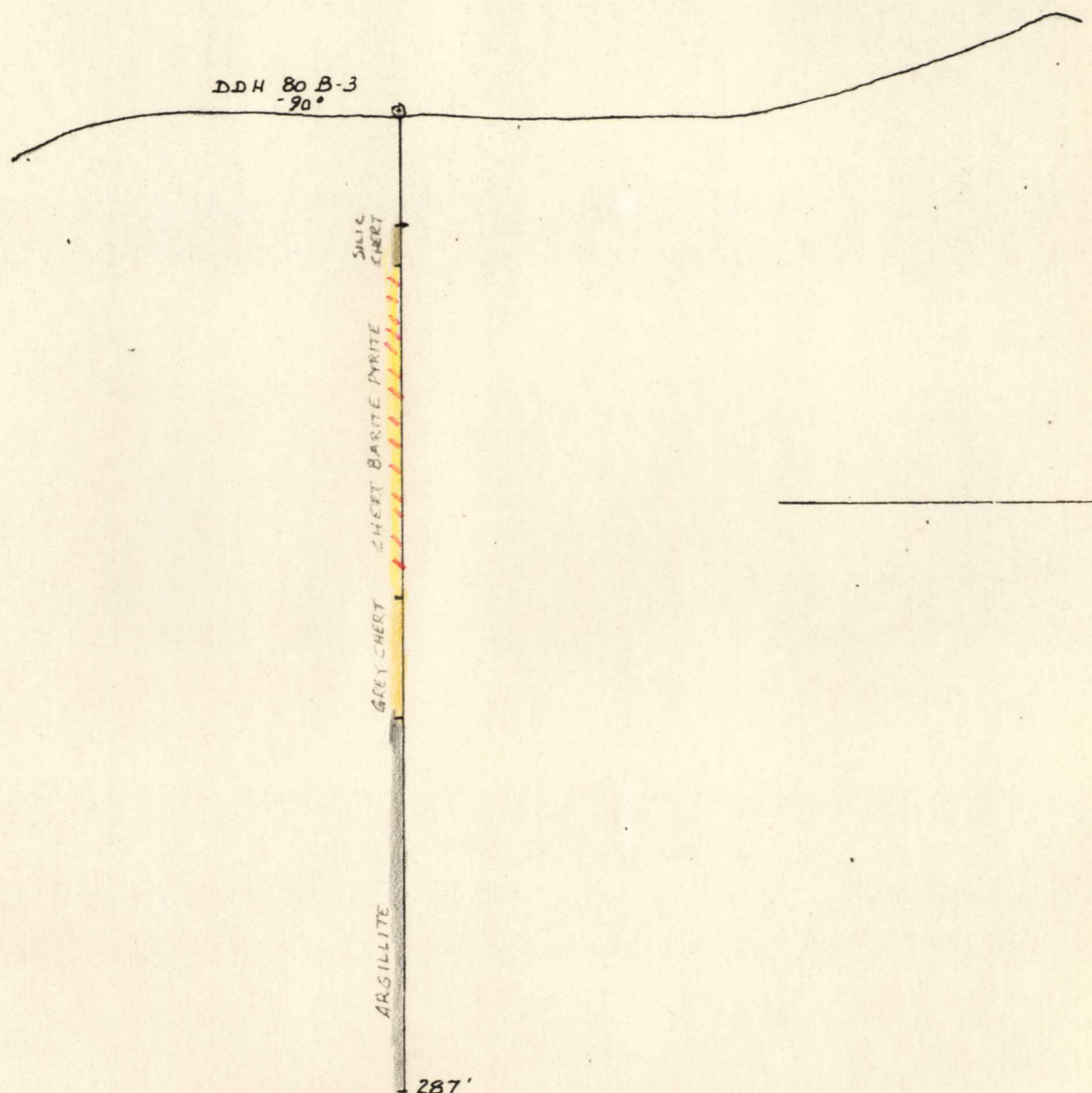

Elev 3600'

D.D.H. 80 B-3

J.C. STEPHEN EXPLORATIONS LTD.
 D.C. SYNDICATE
 BAR CLAIM GROUP
 VERTICAL SECTION 20100 W
 FACING EASTERLY
 SCALE 1" = 50' JUNE 1980

FIGURE 4

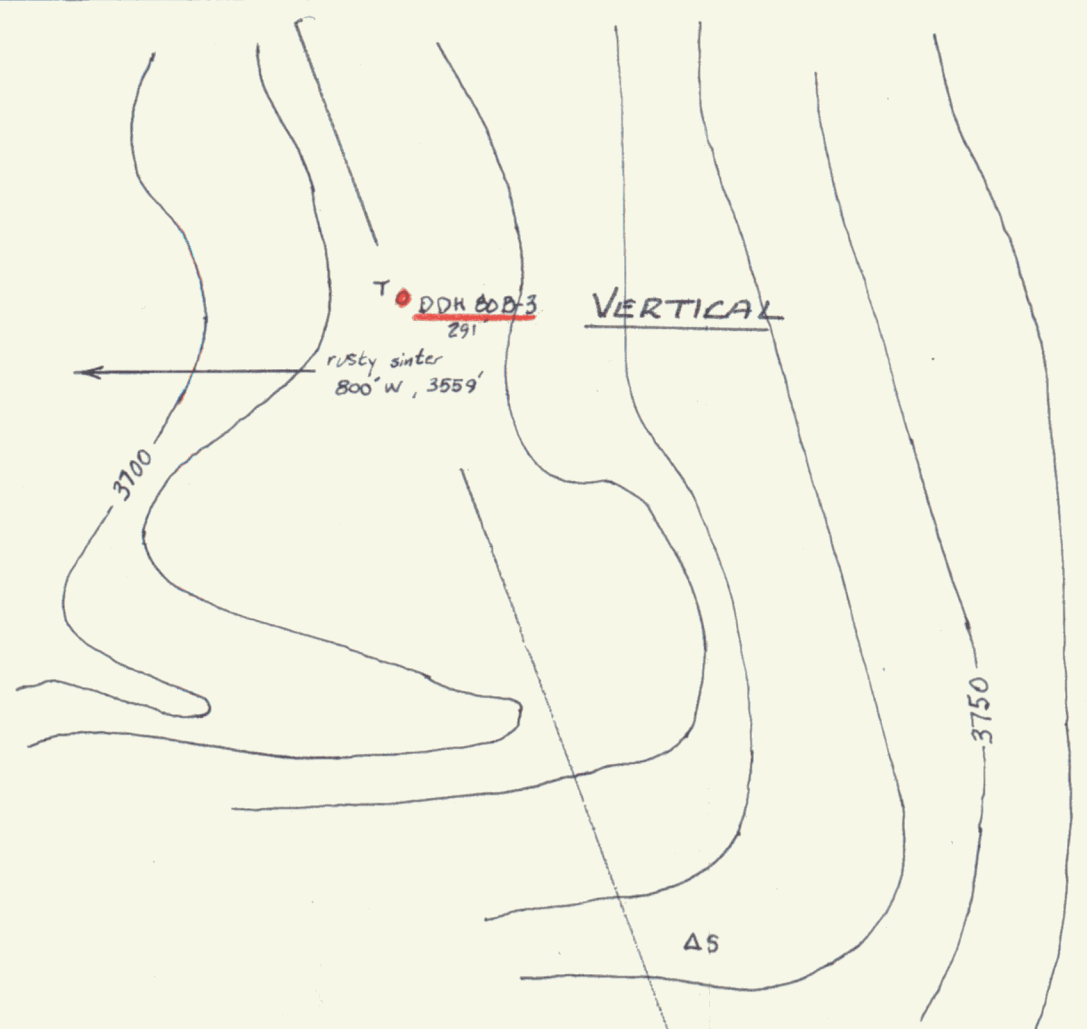

AR
AP
AO

BAR 4
YA 29

BAR 2
YA 27

BAR 1
YA 26

BAR 3
YA 28

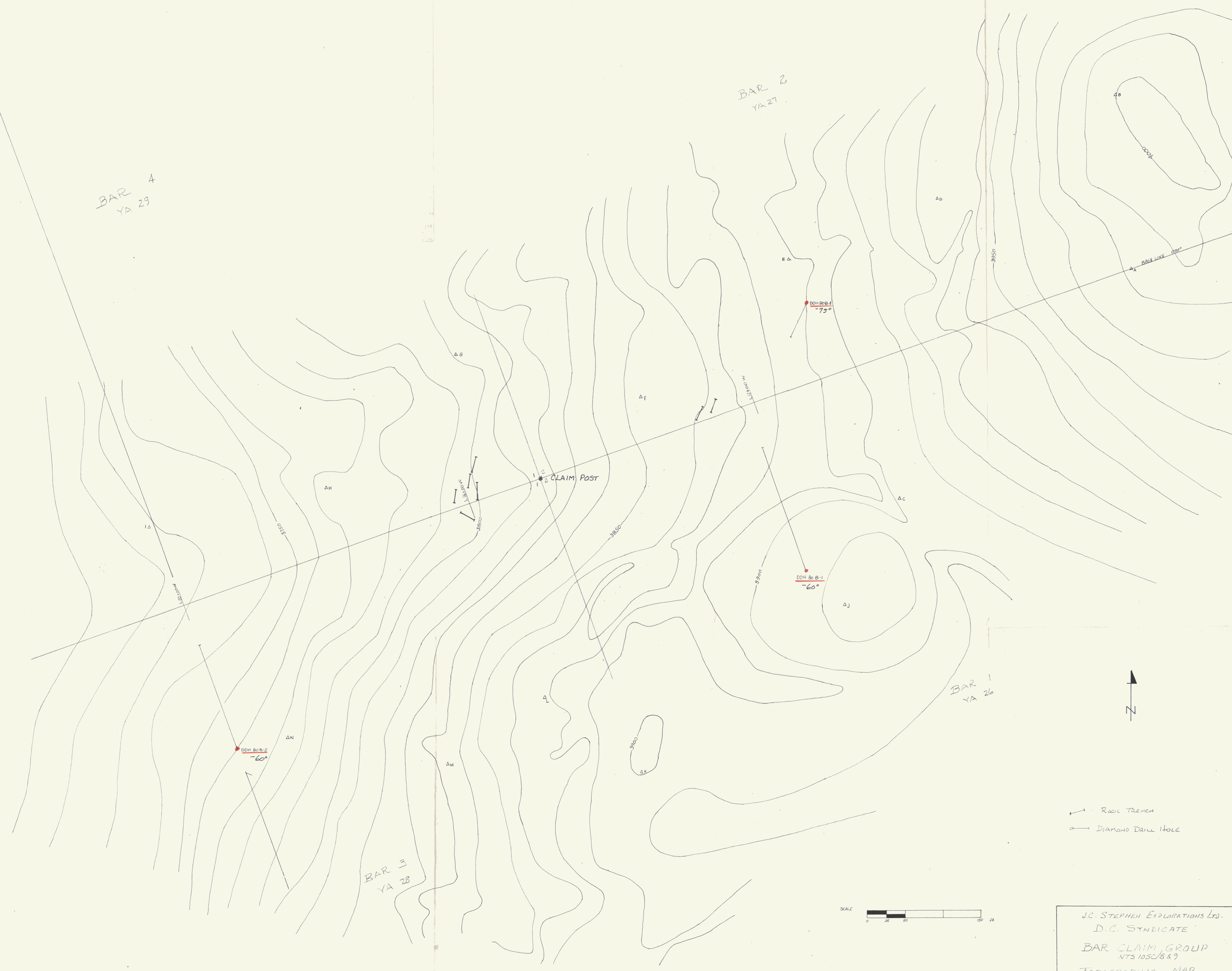

— RACE TRENCH
— DIAMOND DRILL HOLE

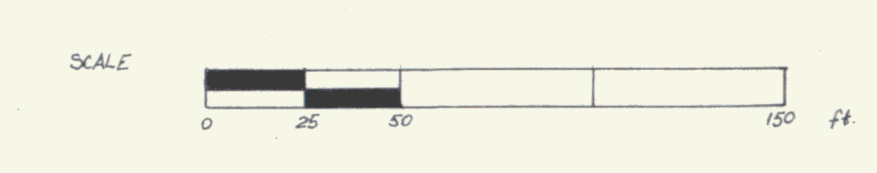

J.C. STEPHEN EXPLORATIONS LTD.
D.C. SYNDICATE
BAR CLAIM GROUP
NTS 105C/8&9
TOPOGRAPHIC MAP
SCALE 1" = 50'
JUNE 1980