

# WATER WELL DRILLERS FORM



Government  
Department of Environment  
Water Resources Section V-310  
Yukon Water Well Registry  
Box 2703 Whitehorse, Yukon Y1A 2C6

Well ID:

To be assigned by Dept. Of Environment

### INSTRUCTIONS FOR COMPLETING THE FORM

- 1. Additional information is provided at the bottom of this form on page 2.
- 2. Question can be directed to Water Resources at 867 667-3171.
- 3. All well construction measurements shall be reported to 0.1 m or 0.3 ft.

- 4. Please print clearly in blue or black ink.
- 5. Completion and submission of this form is the responsibility of the drilling contractor.
- 6. Please specify metric or imperial units for all measurements.

### WELL LOCATION AND OWNER'S INFORMATION

A1 Well Name:  Optional (i.e. City Well No. 2)

A2 Drilled For: First Name  Last Name  Company / Department / Organization

A3 Street Address of Well Location:

A4 Town / Village / Area / Lot #:

A5 UTM Coordinates (using handheld GPS): NAD  Zone

Easting  Northing

A6 Elevation of Top of Casing:  (m) ft ASL

A7 Accuracy of GPS:  +/- m / ft

### A8 Purpose of Wells

- Domestic  Test Well  Irrigation  Environmental (Quality)
- Commercial  Municipal  Observation - Water Level  Other (please identify use)
- Industrial  Agricultural  Public/Recreational

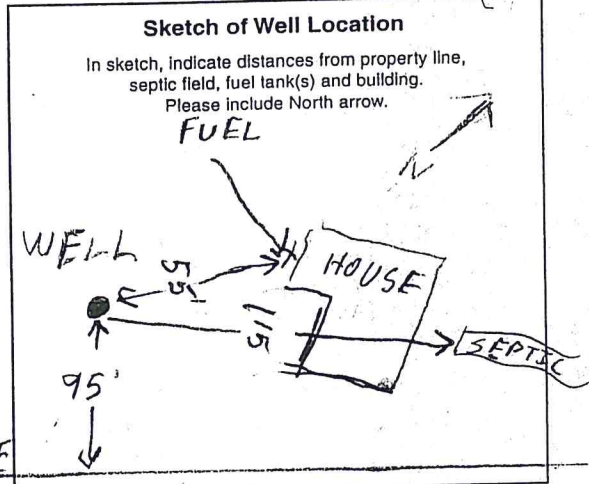

### LOG OF OVERBURDEN AND BEDROCK MATERIALS (All depths are below ground surface, circle appropriate units, use descriptors provided)

EXAMPLE ONLY	Depth (m/ft) B2 From B3 To	B4 General Colour <small>(brown, grey, green, black, redish, beige, olive, yellowish)</small>	B5 Most Common Material <small>CLAY, SILT, SAND, GRAVEL, COBBLES, BOULDERS, BEDROCK</small>	MOISTURE: dry / moist / saturated (wet) HARDNESS: soft / hard / very hard		
				trace gravel	some silt	soft and saturated
	0 114	brown	SAND	trace gravel	some silt	soft and saturated
	114 118	Grey	Clay			
	118 160	Grey	Gravel	Silt		Hard
	160 170	Brown	Gravel	Silt / Clay		Very little water
			Sand	Gravel Layer		Pressurized

B8 Permafrost Encountered:  NO  YES If yes, indicated depth ( m / ft ): from:  to:

### WELL CONSTRUCTION (Continues on Page 2)

Date Well Completed

Example: 2005 01 31

C1 Drilling Method  Air Rotary (Conventional)  Dug  Other (please specify)  Reverse Air Rotary  Cable Tool  Mud Rotary  Auger (Hollow / Solid Stem)

C2 Well Type: In what geological material is the water producing zone located?  OVERBURDEN  BEDROCK

### Casing (depth below ground surface, please circle appropriate units)

C3 Outside Diameter  (cm) (in) C4 Casing Material  Steel  Plastic  Other  C5 Casing Wall Thickness  (cm) (in) C6 Casing Depth to:  (m) (ft)

C7 Other Comments Regarding Casing:

Surface / Environmental Seal (depth below ground surface, please circle appropriate units)

C8 Seal Material Type: Bentonite (i.e. Bentonite)
C9 Diameter of Seal: 10 (cm/in)
C10 Seal Depth from: 0 (m/ft)
C11 Seal Depth to: 13 (m/ft)
C12 Volume Placed: (m³/ft³)

Gravel Pack (depth below ground surface, please circle appropriate units)

C13 Gravel Pack: [X] NO If yes, indicated depth (m/ft): from: to: Indicate diameter of material: (mm/inches) Material type: (i.e. silica)

Well Screen Information (depth below ground surface, please circle appropriate units)

C14 Outside Diameter: 6 (cm/in)
C15 Screen Material: [X] Stainless Steel
C16 Screen Type: [X] Continuous Wire Wrap
C17 Depth from: 16.9 (m/ft)
C18 Depth to: 16.5 (m/ft)
Slot Size / Perforation: 12 Thou. / mm / in

WELL DEVELOPMENT AND STATUS

D1 Well Developed by: [X] Air Jetting / Air Lifting
D2 Well Head Completion: [X] Pitless Adaptor
D3 Well Head Stick-up: 1.5 (m/ft)
D4 Static Water Level: 37 (m/ft)
D5 Well Yield Estimate: 15+ (Lps/gpm)
D6 Final Well Status: [X] Water Supply (in use)
D7 Well Abandonment Status: Was the well properly decommissioned with bentonite grout? [ ] YES [ ] NO
D8 Method Used to Estimate Well Yield: [X] Air Lifting

PUMPING TEST RECORD AND GROUNDWATER QUALITY

(All depths below ground, circle appropriate units)

E1 Pumping Test Information

Pumping Test Start Date: Y Y Y Y M M D D

Static Water Level (SWL): (m/ft)

Pump Intake Set at: (m/ft)

Duration of pumping: hrs min

Final Water Level (FWL) at end of Pumping Test: (m/ft)

RECOMMENDATIONS

Recomm. Pump Depth: (m/ft)
Recomm. Pumping Rate: (Lps/gpm)
If flowing, provide rate: (Lps/gpm)

F1 Well Water Level Drawdown/Recovery DATA

Table with 4 columns: Time (min), Water Level (m/ft), Time (min), Water Level (m/ft). Rows for drawdown and recovery at 0, 1, 2, 3, 4, 5, 10, 15, 20, 25, 30, 40, 50, 60 minutes.

G1 GROUNDWATER QUALITY

Field Data
Date Measurements Taken: Y Y Y Y M M D D

Electrical Conductivity: uS
pH:
Temperature: °C

Turbidity/Sand Content

[ ] Clear
[ ] Slightly turbid/cloudy
[ ] Moderately turbid/cloudy
[ ] Turbid/cloudy
[ ] Trace sand present
[ ] No sand present

Bacteria Testing

Was a sample taken? [ ] YES [ ] NO
Date Sample Taken: Y Y Y Y M M D D

Chemical Analysis of Water

Was a sample taken? [ ] YES [ ] NO
Date Sample Taken: Y Y Y Y M M D D

Groundwater Type

[ ] Salty
[ ] Sulphur / Egg Odour
[ ] Organic Taste / Odour
[ ] Metallic Taste
[ ] Other:

Well Disinfection

Was the well disinfected upon completion of the pump installation? [ ] YES [ ] NO

Briefly describe method of well disinfection.

Javex

WELL CONTRACTOR

H1 Name of Contractor / Drilling Company: Impact Well Drilling
H2 Name of Driller(s): Brian Mac Dougal
H3 Address of Driller: Box 10254 Whitehorse, Y7Y 1A7A1
Signature of Primary Driller: [Signature]
Date Submitted to Dept. Of Environment: 2011002117

CONSULTANT (If applicable)

I 1 Company Name:
I 2 Company Address:
I 3 Report Reference:
I 4 Report Date: Y Y Y Y M M D D

ADDITIONAL INSTRUCTIONS

Upon completing this form, please mail or fax it to: Water Resources Section (V-310), Department of Environment, Government of Yukon Box 2703, Whitehorse, Yukon, Canada Y1A 2C6
Please feel free to contact us at: Phone: (867) 667-3171, Toll free (in Yukon): (1-800) 661-0408, local 3171 Fax: (867) 667-3195 E-mail: Water.Resources@gov.yk.ca

Personal information contained on this form is collected under the authority of the Access to Information and Protection of Privacy (ATIPP) Act, Section 29 (c) and will be used to compile a public database of well and ground water information. For further information contact the Manager of Hydrology, Water Resources at (867) 667-3223, toll free within Yukon 1-800-661-0408 Ext 3223.

I have read the above clause and understand the purpose for collection of personal information.

Signature of Well Owner