

Well ID: **204100510**

To be assigned by Dept. Of Environment

**WATER WEL
DRILLERS FORM**

RECEIVED
105D10

MAY 31 2012

INSTRUCTIONS FOR COMPLETING THE FORM

- Additional information is provided at the bottom of this form on page 2.
- Question can be directed to Water Resources at 867 667-3171.
- All well construction measurements shall be reported to 0.1 m or 0.3 ft.
- Please print clearly in blue or black ink.
- Completion and submission of this form is the responsibility of the drilling contractor.
- Please specify metric or imperial units for all measurements.

WELL LOCATION AND OWNER'S INFORMATION

A1 Well Name: Optional (i.e. City Well No. 2)

A2 Drilled For: First Name Last Name Company / Department / Organization

A3 Street Address of Well Location:

A4 Town / Village / Area / Lot #:

A5 UTM Coordinates (using handheld GPS): NAD Zone
TOPOMAP.
 Easting
 Northing

A6 Elevation of Top of Casing: m / ft ASL

A7 Accuracy of GPS: +/- m / ft

A8 Purpose of Wells

- Domestic
- Commercial
- Industrial
- Test Well
- Municipal
- Agricultural
- Irrigation
- Observation - Water Level
- Public/Recreational
- Environmental (Quality)
- Other (please identify use)

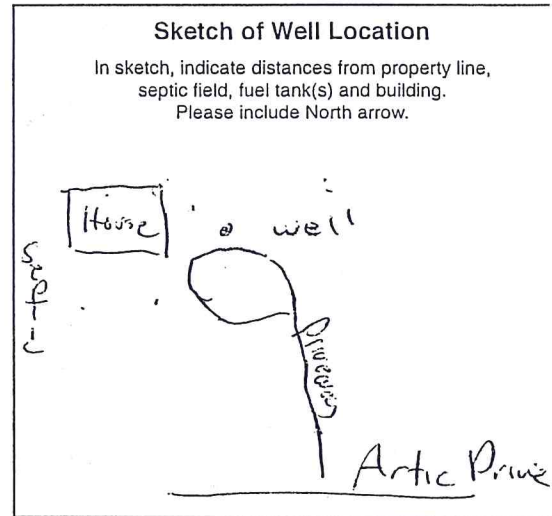

LOG OF OVERBURDEN AND BEDROCK MATERIALS (All depths are below ground surface, circle appropriate units, use descriptors provided)

EXAMPLE ONLY		(brown, grey, green, black, redish, beige, olive, yellowish)	CLAY, SILT, SAND, GRAVEL, COBBLES, BOULDERS, BEDROCK	'trace' <10% (i.e. SILT trace gravel) 'some' 10-20% (i.e. SAND some gravel) 'silty / sandy / gravelly' 20-30% (i.e. silty SAND) 'and sand' or 'and gravel' 35-50%	MOISTURE: dry / moist / saturated (wet) HARDNESS: soft / hard / very hard
		brown	SAND	trace gravel some silt	soft and saturated
Depth (m / ft)	B2 From	B4 General Colour	B5 Most Common Material	B6 Secondary Materials	B7 General Description
	B3 To				
	0		organic		
	2		gravel	sand clay	
	6		gravel		
	22		gravel	clay	
	40		gravel	gravel	
	40		sand		damp
	80		clay	green/black	grey moist
	81		silt	gravel	wet
	120		clay		
	133		gravel		wet
	133				
	150				
	150				

B8 Permafrost Encountered: NO YES If yes, indicated depth (m / ft): from: to:

WELL CONSTRUCTION (Continues on Page 2)

Date Well Completed
Y Y Y Y M M D D

Example:
2005 01 31

C1 Drilling Method Air Rotary (Conventional) Dug Other (please specify)
 Reverse Air Rotary Cable Tool
 Mud Rotary Auger (Hollow / Solid Stem)

C2 Well Type: In what geological material is the water producing zone located?
 OVERBURDEN BEDROCK

Casing (depth below ground surface, please circle appropriate units)

C3 Outside Diameter (cm / in)
C4 Casing Material Steel Plastic Other
C5 Casing Wall Thickness (cm / in)
C6 Casing Depth to: (m / ft)

C7 Other Comments Regarding Casing:

Surface / Environmental Seal (depth below ground surface, please circle appropriate units)

C8 Seal Material Type: Bentonite (i.e. Bentonite)
C9 Diameter of Seal: 10 (cm/in)
C10 Seal Depth from: 0.5 (m/ft)
C11 Seal Depth to: 1.5 (m/ft)
C12 Volume Placed: (m³/ft³)

Gravel Pack (depth below ground surface, please circle appropriate units)

C13 Gravel Pack: NO
If yes, indicated depth (m/ft):
from: to: Indicate diameter of material: (mm/inches) Material type:

Well Screen Information (depth below ground surface, please circle appropriate units)

C14 Outside Diameter: 6 (cm/in)
C15 Screen Material: Stainless Steel
C16 Screen Type: Continuous Wire Wrap
C17 Depth from: 1.55 (m/ft)
C18 Depth to: 1.59 (m/ft)
Slot Size / Perforation: 20 Thou. / mm /

WELL DEVELOPMENT AND STATUS

D1 Well Developed by: Air Jetting / Air Lifting
D2 Well Head Completion: Pitless Adaptor
D3 Well Head Stick-up: 1.91 (m/ft)
D4 Static Water Level: 1.9 (m/ft)
D5 Well Yield Estimate: 1.6 (Lps/gpm)
D6 Final Well Status: Water Supply (in use)
D7 Well Abandonment Status: YES
D8 Method Used to Estimate Well Yield: Air Lifting

PUMPING TEST RECORD AND GROUNDWATER QUALITY

(All depths below ground, circle appropriate units)

E1 Pumping Test Information

Pumping Test Start Date:
Static Water Level (SWL): (m/ft)
Pump Intake Set at: (m/ft)
Duration of pumping: hrs min
Final Water Level (FWL) at end of Pumping Test: (m/ft)

RECOMMENDATIONS

Recomm. Pump Depth: (m/ft)
Recomm. Pumping Rate: (Lps/gpm)
If flowing, provide rate: (Lps/gpm)

F1 Well Water Level Drawdown/Recovery DATA

Table with 4 columns: Time (min), Drawdown Water Level (m/ft), Recovery Time (min), Recovery Water Level (m/ft). Rows include 0 (SWL), 0 (FWL), 1, 2, 3, 4, 5, 10, 15, 20, 25, 30, 40, 50, 60.

G1 GROUNDWATER QUALITY

Field Data

Date Measurements Taken:
Electrical Conductivity: uS
pH:
Temperature: °C

Turbidity/Sand Content

Clear
Slightly turbid/cloudy
Moderately turbid/cloudy
Turbid/cloudy
Trace sand present
No sand present

Groundwater Type

Salty
Sulphur / Egg Odour
Organic Taste / Odour
Metallic Taste
Other:

Well Disinfection

Was the well disinfected upon completion of the pump installation? YES NO
Briefly describe method of well disinfection.

Bacteria Testing

Was a sample taken? YES NO
Date Sample Taken:

Chemical Analysis of Water

Was a sample taken? YES NO
Date Sample Taken:

WELL CONTRACTOR

H1 Name of Contractor / Drilling Company: Impact Well Drilling
H2 Name of Driller(s): Arsen Mac Donnell
H3 Address of Driller:
Signature of Primary Driller:
Date Submitted to Dept. Of Environment:

CONSULTANT (If applicable)

I 1 Company Name:
I 2 Company Address:
I 3 Report Reference:
I 4 Report Date:

ADDITIONAL INSTRUCTIONS

Upon completing this form, please mail or fax it to:

Water Resources Section (V-310), Department of Environment, Government of Yukon Box 2703, Whitehorse, Yukon, Canada Y1A 2C6

Personal information contained on this form is collected under the authority of the Access to Information and Protection of Privacy (ATIPP) Act, Section 29 (c) and will be used to compile a public database of well and ground water information.

Please feel free to contact us at: Phone: (867) 667-3171, Toll free (in Yukon): (1-800) 661-0408, local 3171 Fax: (867) 667-3195 E-mail: Water.Resources@gov.yk.ca

I have read the above clause and understand the purpose for collection of personal information. Signature of Well Owner