

WATER WELL DRILLERS FORM

Well ID: **204100519**

To be assigned by Dept. Of Environment

105D10

INSTRUCTIONS FOR COMPLETING THE FORM

1. Additional information is provided at the bottom of this form on page 2.
2. Question can be directed to Water Resources at 867 667-3171.
3. All well construction measurements shall be reported to 0.1 m or 0.3 ft.
4. Please print clearly in blue or black ink.
5. Completion and submission of this form is the responsibility of the drilling contractor.
6. Please specify metric or imperial units for all measurements.

WELL LOCATION AND OWNER'S INFORMATION

A1 Well Name: Optional (i.e. City Well No. 2)

A2 Drilled For: First Name **Cruikshank** Last Name **Ron** Company / Department / Organization

A3 Street Address of Well Location: **Lot 146**

A4 Town / Village / Area / Lot #: **Golden Horn**

A5 UTM Coordinates (using handheld GPS): NAD **8 3** Zone **8 N**

5 0 7 8 0 1 Easting **6 7 1 9 0 4 2** Northing **± 30-100m**

A6 Elevation of Top of Casing: m / ft ASL

A7 Accuracy of GPS: +/- m / ft

A8 Purpose of Wells

- Domestic Test Well Irrigation Environmental (Quality)
 Commercial Municipal Observation - Water Level Other (please identify use)
 Industrial Agricultural Public/Recreational

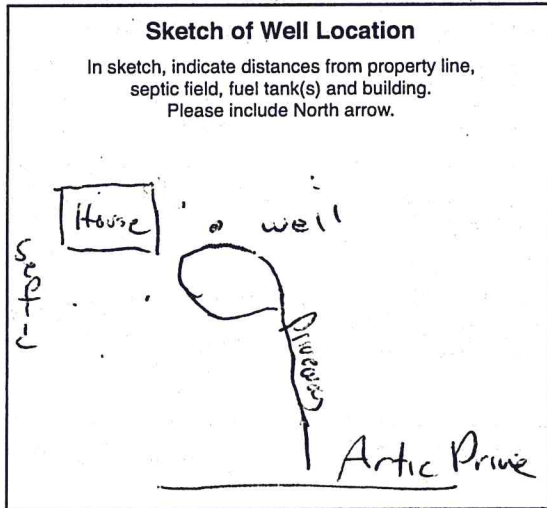

LOG OF OVERBURDEN AND BEDROCK MATERIALS (All depths are below ground surface, circle appropriate units, use descriptors provided)

EXAMPLE ONLY

(brown, grey, green, black, redish, beige, olive, yellowish)

CLAY, SILT, SAND, GRAVEL, COBBLES, BOULDERS, BEDROCK

"trace" <10% (i.e. SILT trace gravel)
"some" 10-20% (i.e. SAND some gravel)
"silty / sandy / gravelly" 20-30% (i.e. silty SAND)
"and sand" or "and gravel" 35-50%

MOISTURE: dry / moist / saturated (wet)
HARDNESS: soft / hard / very hard

Depth (m / ft)		B4 General Colour	B5 Most Common Material	B6 Secondary Materials	B7 General Description
B2 From	B3 To				
0	2		organics		
6	22		gravel	sand clay	
22	40		gravel	clay	
40	80		gravel	gravel	
80	81		sand		damp
81	120		clay		grey moist
120	133		silt	grey/black	wet
133	150		clay	gravel	
150	159		gravel		wet

B8 Permafrost Encountered: NO YES If yes, indicated depth (m / ft): from: to:

WELL CONSTRUCTION (Continues on Page 2)

Date Well Completed **20120711**
Y Y Y Y M M D D

Example: 2005 01 31

C1 Drilling Method Air Rotary (Conventional) Dug
 Reverse Air Rotary Cable Tool
 Mud Rotary Auger (Hollow / Solid Stem)
 Other (please specify) **Partial Rotary**

C2 Well Type: In what geological material is the water producing zone located?
 OVERBURDEN BEDROCK

Casing (depth below ground surface, please circle appropriate units)

C3 Outside Diameter **65/8** (cm / in)
 C4 Casing Material Steel Plastic Other
 C5 Casing Wall Thickness **2.14** (cm / in)
 C6 Casing Depth to: **155** (m / ft)

C7 Other Comments Regarding Casing:
P.R. Shoe

Surface / Environmental Seal (depth below ground surface, please circle appropriate units)

C8 Seal Material Type: Bentonite (i.e. Bentonite)
C9 Diameter of Seal: 10 (cm / in)
C10 Seal Depth from: 0.5 (m / ft)
C11 Seal Depth to: 1.5 (m / ft)
C12 Volume Placed: (m³ / ft³)

Gravel Pack (depth below ground surface, please circle appropriate units)

C13 Gravel Pack: [] NO [] YES
If yes, indicated depth (m / ft): from: [] to: []
Indicate diameter of material: [] (mm / inches)
Material type: []

Well Screen Information (depth below ground surface, please circle appropriate units)

C14 Outside Diameter: 6 (cm / in)
C15 Screen Material: [x] Stainless Steel [] Steel [] Plastic [] N/A [] Other
C16 Screen Type: [x] Continuous Wire Wrap [] Louver Screen [] Perforated [] Slotted [] Open Hole
C17 Depth from: 1.55 (m / ft)
C18 Depth to: 1.52 (m / ft)
Slot Size / Perforation Dia: 20 Thou. / mm / inches
C19 Screen Comments: []

WELL DEVELOPMENT AND STATUS

D1 Well Developed by: [x] Air Jetting / Air Lifting
D2 Well Head Completion: [x] Pitless Adaptor
D3 Well Head Stick-up: 1.81 (m / ft)
D4 Static Water Level: 1.19 (m / ft)
D5 Well Yield Estimate: 1.8 (Lps / gpm)
D6 Final Well Status: [x] Water Supply (in use)
D7 Well Abandonment Status: [] YES [] NO
D8 Method Used to Estimate Well Yield: [x] Air Lifting

PUMPING TEST RECORD AND GROUNDWATER QUALITY

(All depths below ground, circle appropriate units)

E1 Pumping Test Information

Pumping Test Start Date: [] Y [] Y [] Y [] M [] M [] D [] D
Static Water Level (SWL): [] (m / ft)
Pump Intake Set at: [] (m / ft)
Duration of pumping: [] hrs [] min
Final Water Level (FWL) at end of Pumping Test: [] (m / ft)

RECOMMENDATIONS

Recomm. Pump Depth: [] (m / ft)
Recomm. Pumping Rate: [] (Lps / gpm)
If flowing, provide rate: [] (Lps / gpm)

F1 Well Water Level Drawdown/Recovery DATA

Table with 4 columns: Time (min), Water Level (m / ft), Time (min), Water Level (m / ft). Rows for 0 (SWL) and 0 (FWL) at various time intervals from 1 to 60 minutes.

G1 GROUNDWATER QUALITY

Field Data
Date Measurements Taken: [] Y [] Y [] Y [] M [] M [] D [] D
Electrical Conductivity: [] uS
pH: []
Temperature: [] °C

Turbidity/Sand Content

[] Clear
[] Slightly turbid/cloudy
[] Moderately turbid/cloudy
[] Turbid/cloudy
[] Trace sand present
[] No sand present

Groundwater Type

[] Salty
[] Sulphur / Egg Odour
[] Organic Taste / Odour
[] Metallic Taste
[] Other: []

Well Disinfection

Was the well disinfected upon completion of the pump installation? [x] YES [] NO
Briefly describe method of well disinfection. []

Bacteria Testing

Was a sample taken? [x] YES [] NO
Date Sample Taken: [] Y [] Y [] Y [] M [] M [] D [] D

Chemical Analysis of Water

Was a sample taken? [x] YES [] NO
Date Sample Taken: [] Y [] Y [] Y [] M [] M [] D [] D

WELL CONTRACTOR

H1 Name of Contractor / Drilling Company: Impact Well Drilling
H2 Name of Driller(s): Brian Mac Royal
H3 Address of Driller: []
Signature of Primary Driller: []
Date Submitted to Dept. Of Environment: [] Y [] Y [] Y [] M [] M [] D [] D

CONSULTANT (If applicable)

I 1 Company Name: []
I 2 Company Address: []
I 3 Report Reference: []
I 4 Report Date: [] Y [] Y [] Y [] M [] M [] D [] D

ADDITIONAL INSTRUCTIONS

Upon completing this form, please mail or fax it to:
Water Resources Section (V-310), Department of Environment, Government of Yukon Box 2703, Whitehorse, Yukon, Canada Y1A 2C6
Please feel free to contact us at:
Phone: (867) 667-3171, Toll free (in Yukon): (1-800) 661-0408, local 3171
Fax: (867) 667-3195 E-mail: Water.Resources@gov.yk.ca

Personal information collected on this form is collected under the authority of the Access to Information and Protection of Privacy (ATIP) Act, Section 29 (c) and will be used to compile a public database of well and ground water information.

I have read the above clause and understand the purpose for collection of personal information.

Signature of Well Owner