

204140258/28

COPY



Government  
Department of Environment  
Water Resources Section V-310  
Yukon Water Well Registry  
Box 2703 Whitehorse, Yukon Y1A 2C6

Well Record Page 1 of  
**WATER WELL  
DRILLERS FORM**

Well ID:   
To be assigned by Dept. Of Environment

**INSTRUCTIONS FOR COMPLETING THE FORM**

1. Additional information is provided at the bottom of this form on page 2.
2. Question can be directed to Water Resources at 867 667-3171.
3. All well construction measurements shall be reported to 0.1 m or 0.3 ft.
4. Please print clearly in blue or black ink.
5. Completion and submission of this form is the responsibility of the drilling contractor.
6. Please specify metric or imperial units for all measurements.

**WELL LOCATION AND OWNER'S INFORMATION**

A1 Well Name:  Optional (i.e. City Well No. 2)

A2 Drilled For: First Name  Last Name  Company / Department / Organization

A3 Street Address of Well Location:

A4 Town / Village / Area / Lot #:

A5 UTM Coordinates (using handheld GPS): NAD  Zone

Easting  Northing

A6 Elevation of Top of Casing:  (m/ft ASL)

A7 Accuracy of GPS:  +/- (m)/ft

**A8 Purpose of Wells**

- Domestic
- Commercial
- Industrial
- Test Well
- Municipal
- Agricultural
- Irrigation
- Observation - Water Level
- Public/Recreational
- Environmental (Quality)
- Other (please identify use)

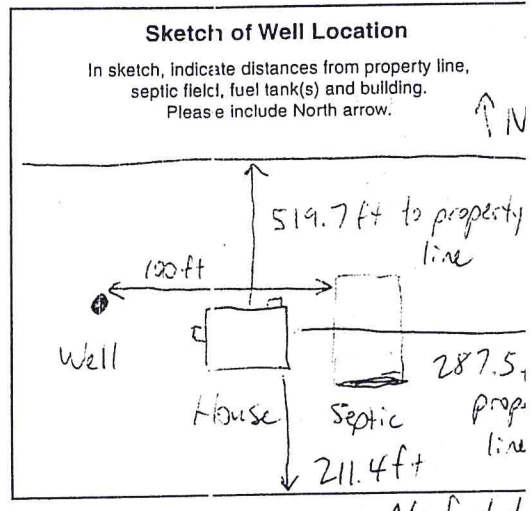

**LOG OF OVERBURDEN AND BEDROCK MATERIALS** (All depths are below ground surface, circle appropriate units, use descriptors provided)

EXAMPLE ONLY		(brown, grey, green, black, redish, beige, olive, yellowish)	CLAY, SILT, SAND, GRAVEL, COBBLES, BOULDERS, BEDROCK	"trace" <10% (i.e. SILT trace gravel) "some" 10-20% (i.e. SAND some gravel) "silty / sandy / gravelly" 20-30% (i.e. silty SAND) "and sand" or "and gravel" 35-50%	MOISTURE: dry / moist / saturated (wet) HARDNESS: soft / hard / very hard
		brown	SAND	trace gravel some silt	soft and saturated
Depth (m / ft)		B4 General Colour	B5 Most Common Material	B6 Secondary Materials	B7 General Description
B2 From	B3 To				
0	20	Brown	Sand		wet
20	185	grey	clay		
185	199	grey	clay	Silt gravel sand	191-199 water
199	220	grey	clay	Silt	
220	240	grey	gravel	sand silt	water bearing

B8 Permafrost Encountered:  NO  YES If yes, indicated depth (m / ft): from:  to:

**WELL CONSTRUCTION** (Continues on Page 2)

Date Well Completed  Example: 2005 01 31

C1 Drilling Method  Air Rotary (Conventional)  Dug  Other (please specify)  Reverse Air Rotary  Cable Tool  Dual Rotary  Mud Rotary  Auger (Hollow / Solid Stem)

C2 Well Type: In what geological material is water producing zone located?  OVERBURDEN  BEDROCK

C3 Outside Diameter  (cm / in.) C4 Casing Material  Steel  Plastic  Other  C5 Casing Wall Thickness  (cm / in.) C6 Casing Depth to:  (m / ft)

C7 Other Comments Regarding Casing

