

Well ID: 204140309
To be assigned by Dept. Of Environment

9#98

INSTRUCTIONS FOR COMPLETING THE FORM

1. Additional information is provided at the bottom of this form on page 2.
2. Question can be directed to Water Resources at 867 667-3171.
3. All well construction measurements shall be reported to 0.1 m or 0.3 ft.
4. Please print clearly in blue or black ink.
5. Completion and submission of this form is the responsibility of the drilling contractor.
6. Please specify metric or imperial units for all measurements.

WELL LOCATION AND OWNER'S INFORMATION

A1 Well Name: Optional (i.e. City Well No. 2)

A2 Drilled For: First Name Lienke Last Name Devries Company / Department / Organization

A3 Street Address of Well Location: Lot 1016, Shallow Bay

A4 Town / Village / Area / Lot #: Plan 53244 Quad 105D/14

A5 UTM Coordinates (using handheld GPS): NAD 83 Zone 08

Easting: 4930118 Northing: 67569519

A6 Elevation of Top of Casing: 636 (m) ft ASL

A7 Accuracy of GPS: 5 +/- (m) / ft

A8 Purpose of Wells

- Domestic Test Well Irrigation Environmental (Quality)
 Commercial Municipal Observation - Water Level Other (please identify use)
 Industrial Agricultural Public/Recreational

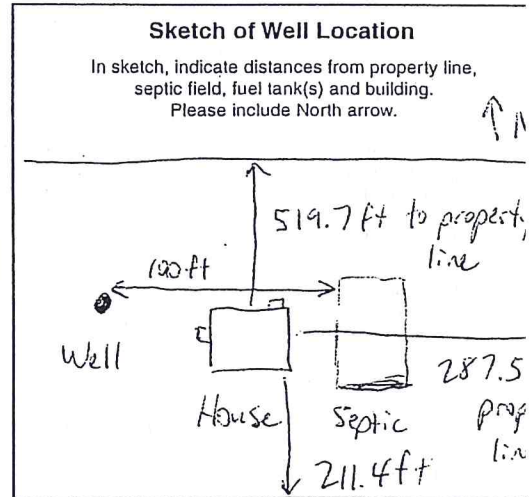

LOG OF OVERBURDEN AND BEDROCK MATERIALS (All depths are below ground surface, circle appropriate units, use descriptors provided)

| EXAMPLE ONLY | | (brown, grey, green, black, redish, beige, olive, yellowish) | CLAY, SILT, SAND, GRAVEL, COBBLES, BOULDERS, BEDROCK | "trace" <10% (i.e. SILT trace gravel) "some" 10-20% (i.e. SAND some gravel) "silty / sandy / gravelly" 20-30% (i.e. silty SAND) "and sand" or "and gravel" 35-50% | MOISTURE: dry / moist / saturated (wet) HARDNESS: soft / hard / very hard |
|----------------|-------|--|--|--|--|
| | | brown | SAND | trace gravel some silt | soft and saturated |
| Depth (m / ft) | | B4 General Colour | B5 Most Common Material | B6 Secondary Materials | B7 General Description |
| B2 From | B3 To | | | | |
| 0 | 20 | Brown | Sand | | wet |
| 20 | 185 | grey | clay | | |
| 185 | 99 | grey | clay | Silt gravel sand | 191-199 water |
| 199 | 220 | grey | clay | Silt | |
| 220 | 240 | grey | gravel | sand silt | water bearing |

B8 Permafrost Encountered: NO YES If yes, indicated depth (m / ft): from: to:

WELL CONSTRUCTION (Continues on Page 2)

Date Well Completed: 20100713
Y Y Y Y M M D D

Example: 2005 01 31

C1 Drilling Method: Air Rotary (Conventional) Dug Other (please specify)
 Reverse Air Rotary Cable Tool Dual Rotary
 Mud Rotary Auger (Hollow / Solid Stem)

C2 Well Type: In what geological material is water producing zone located?
 OVERBURDEN BEDROCK

Casing (depth below ground surface, please circle appropriate units)

C3 Outside Diameter: 6.50 (cm / in)
 C4 Casing Material: Steel Plastic Other
 C5 Casing Wall Thickness: 2.50 (cm / in)
 C6 Casing Depth to: 23.5 (m / ft)

C7 Other Comments Regarding Casing

D.R. Drive Shoe

Surface / Environmental Seal (depth below ground surface, please circle appropriate units)

C8 Seal Material Type: Bentonite (i.e. Bentonite)
C9 Diameter of Seal: 10" x 15 (cm / in)
C10 Seal Depth from: 0 (m / ft)
C11 Seal Depth to: 15' (m / ft)
C12 Volume Placed: 2 bags (m³ / ft³)

Gravel Pack (depth below ground surface, please circle appropriate units)

C13 Gravel Pack: [X] NO If yes, indicated depth (m / ft): from: to: Indicate diameter of material: (mm / inches) Material type: (i.e. silica)

Well Screen Information (depth below ground surface, please circle appropriate units)

C14 Outside Diameter: 6 (cm / in)
C15 Screen Material: [X] Stainless Steel
C16 Screen Type: [X] Continuous Wire Wrap
C17 Depth from: 238'8" (m / ft)
C18 Depth to: 234 (m / ft)
Slot Size / Perforation Dia: 20 Thou. / mm / inches
C19 Screen Comments: Installed 2' riser on top of screen

WELL DEVELOPMENT AND STATUS

D1 Well Developed by: [X] Air Jetting / Air Lifting
D2 Well Head Completion: [X] Pitless Adaptor
D3 Well Head Stick-up: 18" (m / ft)
D4 Static Water Level: 10 (m / ft)
D5 Well Yield Estimate: 20 (Lps / gpm)
D6 Final Well Status: [X] Water Supply (in use)
D7 Well Abandonment Status: Was the well properly decommissioned with bentonite grout? [X] YES
D8 Method Used to Estimate Well Yield: [X] Air Lifting

PUMPING TEST RECORD AND GROUNDWATER QUALITY

E1 Pumping Test Information
Pumping Test Start Date:
Static Water Level (SWL):
Pump Intake Set at:
Duration of pumping:
Final Water Level (FWL) at end of Pumping Test:
RECOMMENDATIONS
Recomm. Pump Depth:
Recomm. Pumping Rate:
If flowing, provide rate:

F1 Well Water Level Drawdown/Recovery DATA

Table with 4 columns: Time (min), Water Level (m / ft) for Drawdown, Time (min), Water Level (m / ft) for Recovery. Rows 0-60 minutes.

G1 GROUNDWATER QUALITY

Field Data
Date Measurements Taken:
Electrical Conductivity: uS
pH:
Temperature: °C
Turbidity/Sand Content
Well Disinfection
Briefly describe method of well disinfection.

Bacteria Testing

Was a sample taken? [X] YES [] NO
Date Sample Taken:
If yes, indicate the name of the laboratory.

Chemical Analysis of Water

Was a sample taken? [X] YES [] NO
Date Sample Taken:
If yes, indicate the name of the laboratory.

WELL CONTRACTOR

H1 Name of Contractor / Drilling Company: Impact Well Drilling
H2 Name of Driller(s): Brian Mac Dougal
H3 Address of Driller: Box 10254 White YT
Signature of Primary Driller: [Signature]
Date Submitted to Dept. Of Environment: 2009110110

CONSULTANT (if applicable)

I 1 Company Name:
I 2 Company Address:
I 3 Report Reference:
I 4 Report Date:

ADDITIONAL INSTRUCTIONS

Upon completing this form, please mail or fax it to:
Water Resources Section (V-310), Department of Environment, Government of Yukon Box 2703, Whitehorse, Yukon, Canada Y1A 2C6
Please feel free to contact us at:
Phone: (867) 667-3171, Toll free (in Yukon): (1-800) 661-0408, local 3171
Fax: (867) 667-3195 E-mail: Water.Resources@gov.yk.ca

Personal information contained on this form is collected under the authority of the Access to Information and Protection of Privacy (ATIPP) Act, Section 29 (c) and will be used to compile a public database of well and ground water information. For further information contact the Manager of Hydrology, Water Resources at (867) 667-3223, toll free within Yukon 1-800-661-0408 Ext 3223.

I have read the above clause and understand the purpose for collection of personal information. [Signature] Signature of Well Owner