

Well ID: **204140329**
To be assigned by Dept. Of Environment

INSTRUCTIONS FOR COMPLETING THE FORM

- Additional information is provided at the bottom of this form on page 2.
- Question can be directed to Water Resources at 867 667-3171.
- All well construction measurements shall be reported to 0.1 m or 0.3 ft.
- Please print clearly in blue or black ink.
- Completion and submission of this form is the responsibility of the drilling contractor.
- Please specify metric or imperial units for all measurements.

WELL LOCATION AND OWNER'S INFORMATION

A1 Well Name: Optional (i.e. City Well No.)

A2 Drilled For: First Name **JEAN MARC** Last Name **PITAMPAL** Company / Department / Organization

A3 Street Address of Well Location: **867-343-2077**
TAKHINI LODGE
PO BOX 21345 YT, Y1A-6R6

A4 Town / Village / Area / Lot #: **1370, QUAD 10SD/14, YT**
PLAN 99-0143

A5 UTM Coordinates (using handheld GPS): Zone **18 Q**
Easting **135047.8411** Northing **6015218.24**
4474753 **6749557**
30-100m

A6 Elevation of Top of Casing: **1.5** m (ft) **A.S.L.** **700m**
A.S.L.

A7 Accuracy of GPS: **30** +/- m (ft)

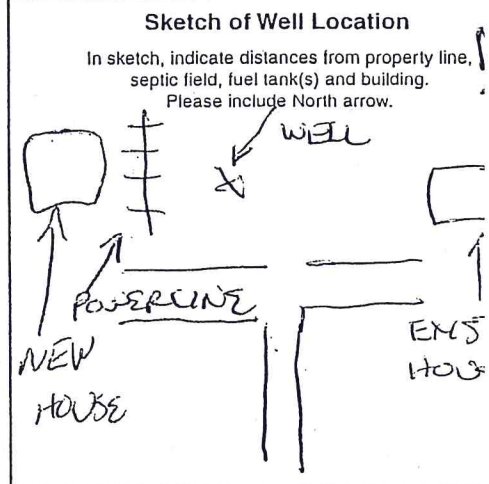

A8 Purpose of Wells

- Domestic Test Well Irrigation Environmental (Quality)
 Commercial Municipal Observation - Water Level Other (please identify use)
 Industrial Agricultural Public/Recreational

LOG OF OVERBURDEN AND BEDROCK MATERIALS (All depths are below ground surface, circle appropriate units, use descriptors provided)

EXAMPLE ONLY		(brown, grey, green, black, redish, beige, olive, yellowish)	CLAY, SILT, SAND, GRAVEL, COBBLES, BOULDERS, BEDROCK	"trace" <10% (i.e. SILT trace gravel) "some" 10-20% (i.e. SAND some gravel) "silty / sandy / gravelly" 20-30% (i.e. silty SAND) "and sand" or "and gravel" 35-50%	MOISTURE: dry / moist / saturated (HARDNESS: soft / hard / very hard)
B2 From	B3 To	brown	SAND	trace gravel some silt	soft and saturated
0	5	BRN	SILT		DRY
5	28	BRN/GY	CLAY		HARD
28	35	BRN	CLAY	TRACE FINE-MED	GRAVEL
35	35	BRN	CLAY		
35	300	GY	CLAY		HARD
300	385	GY	CLAY	SILTY SAND	SOFT
385	398	GY	FINE SILTY SAND		SOFT
398	505	GY	BEDROCK		GRANITE

B8 Permafrost Encountered: NO YES If yes, indicated depth (m / ft): from: to:

WELL CONSTRUCTION (Continues on Page 2)

Date Well Completed **20080922**
Y Y Y Y M M D D

Example: 2005 01 31

- C1 Drilling Method Air Rotary (Conventional) Dug Other (please specify)
 Reverse Air Rotary Cable Tool
 Mud Rotary Auger (Hollow / Solid Stem)
- C2 Well Type: In what geological material is the water producing zone located?
 OVERBURDEN BEDROCK

Casing (depth below ground surface, please circle appropriate units)

C3 Outside Diameter **6** (cm) (in)
C4 Casing Material Steel Plastic Other
C5 Casing Wall Thickness **.219** (cm) (in)
C6 Casing Depth to: **407** (m) (ft)

C7 Other Comments Regarding Casing
4.94 PVC LINS FROM 385-505 BOTTOM SOFT SI

Surface / Environmental Seal (depth below ground surface, please circle appropriate units)

C8 Seal Material Type: BENTONITE (i.e. Bentonite) CUTS
C9 Diameter of Seal: 4 (cm)
C10 Seal Depth from: 0 (m)
C11 Seal Depth to: 15 (m)
C12 Volume Placed: 11 BAGS (m³) 3.25

Gravel Pack (depth below ground surface, please circle appropriate units)

C13 Gravel Pack: NO
If yes, indicated depth (m / ft):
from: to: Indicate diameter of material: (mm / inches) Material type: (i.e. silica)

Well Screen Information (depth below ground surface, please circle appropriate units)

C14 Outside Diameter: 4.94 (cm)
C15 Screen Material: Steel
C16 Screen Type: Slotted
C17 Depth from: 485 (m)
C18 Depth to: 505 (m)
Slot Size / Perforation Dia: 2 IPCUT
Screen 1, 2, 3 details
C19 Screen Comments: 2 IPCUT VERTICAL SLOTS STAGGERED ALONG ENTIRE LENGTH LAST 20 FT

WELL DEVELOPMENT AND STATUS

D1 Well Developed by: Air Jetting / Air Lifting
D2 Well Head Completion: Pitless Adaptor
D3 Well Head Stick-up: 1.5 (m)
D4 Static Water Level: 46.5 (m)
D5 Well Yield Estimate: 2 (Lps / gpm)
D6 Final Well Status: Water Supply (in use)
D7 Well Abandonment Status: YES
D8 Method Used to Estimate Well Yield: Air Lifting

PUMPING TEST RECORD AND GROUNDWATER QUALITY

(All depths below ground, circle appropriate units)

E1 Pumping Test Information

Pumping Test Start Date:
Static Water Level (SWL):
Pump Intake Set at:
Duration of pumping:
Final Water Level (FWL) at end of Pumping Test:

RECOMMENDATIONS

Recomm. Pump Depth:
Recomm. Pumping Rate:
If flowing, provide rate:

F1 Well Water Level Drawdown/Recovery DATA

Table with 4 columns: Time (min), Water Level (m / ft) for Drawdown and Recovery. Rows from 0 (SWL) to 60 minutes.

G1 GROUNDWATER QUALITY

Field Data: Date Measurements Taken: 20080911
Electrical Conductivity:
pH:
Temperature:

Turbidity/Sand Content

Clear
Slightly turbid/cloudy
Moderately turbid/cloudy
Turbid/cloudy
Trace sand present
No sand present

Bacteria Testing

Was a sample taken? YES
Date Sample Taken: 20080922

Chemical Analysis of Water

Was a sample taken? YES
Date Sample Taken: 20080922

Well Disinfection

Was the well disinfected upon completion of the pump installation? YES

Briefly describe method of well disinfection.

1/2 GAL. 5% FREE TO KC INSTALL 1/2 GAL. AFTER

WELL CONTRACTOR

H1 Name of Contractor / Drilling Company: DUBBS D DRILLING LTD
H2 Name of Driller(s): ROB STANUCK
H3 Address of Driller: TERRACE B.C.
Signature of Primary Driller:
Date Submitted to Dept. Of Environment:

CONSULTANT (if applicable)

I 1 Company Name:
I 2 Company Address:
I 3 Report Reference:
I 4 Report Date:

ADDITIONAL INSTRUCTIONS

Upon completing this form, please mail or fax it to:

Please feel free to contact us at:
Phone: (867) 667-3171, Toll free (in Yukon): (1-800) 661-0408, local 3171
Fax: (867) 667-3195 E-mail: Water.Resources@gov.yk.ca

Water Resources Section (V-310),
Department of Environment,
Government of Yukon Box 2703,
Whitehorse, Yukon, Canada Y1A 2C6

Personal information contained on this form is collected under the authority of the Access to Information and Protection of Privacy (ATIP) Act, Section 29 (c) and will be used to compile a public database of well and ground water information.

I have read the above clause and understand the purpose for collection of personal information.

Signature of Well Owner