

WATER WELL DRILLERS FORM

Well Record Page 1 of 2

Well ID: [] To be assigned by Dept. Of Environment

INSTRUCTIONS FOR COMPLETING THE FORM

- 1. Additional information is provided at the bottom of this form on page 2.
2. Question can be directed to Water Resources at 867 667-3171.

- 3. All well construction measurements shall be reported to 0.1 m or 0.3 ft.
4. Please print clearly in blue or black ink.
5. Completion and submission of this form is the responsibility of the drilling contractor.
6. Please specify metric or imperial units for all measurements.

WELL LOCATION AND OWNER'S INFORMATION

A1 Well Name: [] Optional (i.e. City Well No. 2)

A2 Drilled For: First Name [BRYAN] Last Name [ALP] Company / Department / Organization []

A3 Street Address of Well Location: [LOT 1011-5-2 QUAD 105E03]

A4 Town / Village / Area / Lot #: [GRIZZLY VALLEY SUBDIVISION WHSE, Y7]

A5 UTM Coordinates (using handheld GPS): NAD [8] [3] Zone [08]

Easting [9] [15] [17] [5] [4] [8] Northing [6] [17] [6] [9] [4] [8] [16]

A6 Elevation of Top of Casing: [761 m] m / ft ASL

A7 Accuracy of GPS: [+/- 9 m] +/- m / ft

A8 Purpose of Wells

- Domestic [x] Test Well [] Irrigation [] Environmental (Quality) []
Commercial [] Municipal [] Observation - Water Level [] Other (please identify use) []
Industrial [] Agricultural [] Public/Recreational []

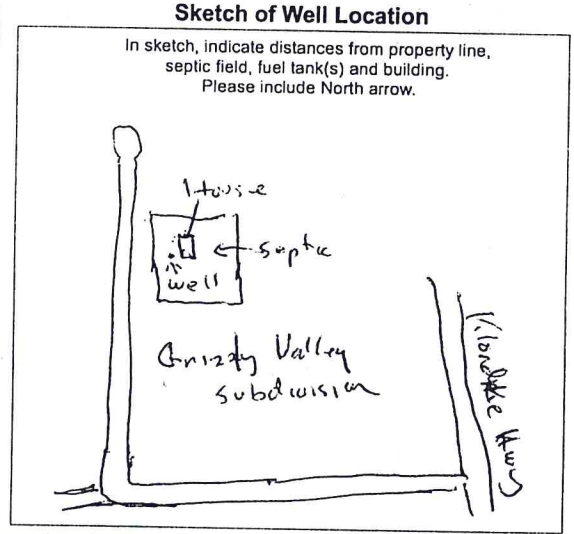

LOG OF OVERBURDEN AND BEDROCK MATERIALS (All depths are below ground surface, circle appropriate units, use descriptors provided)

EXAMPLE ONLY

Color key: brown, grey, green, black, redish, beige, olive, yellowish. Material key: CLAY, SILT, SAND, GRAVEL, COBBLES, BOULDERS, BEDROCK. Moisture/Hardness key: trace gravel, some silt, soft and saturated.

Table with 5 columns: Depth (m / ft), B4 General Colour, B5 Most Common Material, B6 Secondary Materials, B7 General Description. Includes handwritten entries for depth 0-7m, 7-58m, 58-59m.

B8 Permafrost Encountered: [x] NO [] YES If yes, indicated depth (m / ft): from: [] to: []

WELL CONSTRUCTION (Continues on Page 2)

Date Well Completed [0] [1] [0] [5] [2] [0] [0] [6]

Example: 31 01 2005

C1 Drilling Method: [x] Air Rotary (Conventional) [] Dug [] Reverse Air Rotary [] Cable Tool [] Mud Rotary [] Auger (Hollow / Solid Stem) [] Other (please specify) []

C2 Well Type: In what geological material is the water producing zone located? [x] OVERBURDEN [] BEDROCK

Casing (depth below ground surface, please circle appropriate units)

C3 Outside Diameter [6 5/8] (cm / in) C4 Casing Material [x] Steel [] Plastic C5 Casing Wall Thickness [250] (cm / in) C6 Casing Depth to: [55] (m / ft) C7 Other Comments Regarding Casing: []

Surface / Environmental Seal (depth below ground surface, please circle appropriate units)

C8 Seal Material Type: Bentonite (i.e. Bentonite)
 C9 Diameter of Seal: 10 (cm / in)
 C10 Seal Depth from: 0 (m / ft)
 C11 Seal Depth to: 15 (m / ft)
 C12 Volume Placed: _____ (m³ / ft³)

Gravel Pack (depth below ground surface, please circle appropriate units)

C13 Gravel Pack: NO If yes, indicated depth (m / ft): _____
 YES from: _____ to: _____ Indicate diameter of material: _____ (mm / inches)
 Material type: _____ (i.e. silica)

Well Screen Information (depth below ground surface, please circle appropriate units)

C14 Outside Diameter: 4.5 (cm / in)
 C15 Screen Material: Stainless Steel
 Steel
 Plastic
 N/A
 Other: _____
 C16 Screen Type: Continuous Wire Wrap
 Louver Screen
 Perforated
 Slotted
 Open Hole
 C17 Depth from: 55 (m / ft)
 C18 Depth to: 54 (m / ft)
 Slot Size / Perforation Dia: 03-30 Thou. / mm / inches
 Screen 1: _____ (m / ft) _____ (m / ft) _____ Thou. / mm / inches
 Screen 2: _____ (m / ft) _____ (m / ft) _____ Thou. / mm / inches
 Screen 3: _____ (m / ft) _____ (m / ft) _____ Thou. / mm / inches
 C19 Screen Comments: Sand blocker

WELL DEVELOPMENT AND STATUS

D1 Well Developed by: Surge Block
 Water Jetting
 Air Jetting / Air Lifting
 Bailing
 Pumping
 Other: _____
 D2 Well Head Completion: Well House
 Pitless Adaptor 7 (m / ft) Depth of adaptor:
 Well Pit (NOT PERMITTED)
 None (well not completed)
 D3 Well Head Stick-up (above ground surface): 18 inches (m / ft)
 (Use negative if below grade)
 D4 Static Water Level (below top of casing): 38 (m / ft)
 (Use negative if below grade)
 D5 Well Yield Estimate: 20 (Lps / gpm)
 D6 Final Well Status: Water Supply (in use) Not in use
 Stand by (Back-up) Deepened
 Observation Other: _____
 Abandoned Dry
 If well was abandoned, please give reason: _____
 Poor Quality Insufficient Yield
 D7 Well Abandonment Status: Was the well properly decommissioned with bentonite grout? YES NO
 If YES, Indicate Date: _____
 D8 Method Used to Estimate Well Yield: Air Lifting
 Bailing
 Pumping Test (If test conducted, complete Pumping Test Record)

PUMPING TEST RECORD AND GROUNDWATER QUALITY

(All depths below ground, circle appropriate units)

E1 Pumping Test Information

Pumping Test Start Date: _____
 Static Water Level (SWL): 38 (m / ft)
 Pump Intake Set at: _____ (m / ft)
 Duration of pumping: _____ hrs _____ min
 Final Water Level (FWL) at end of Pumping Test: _____ (m / ft)

RECOMMENDATIONS

Recomm. Pump Depth: _____ (m / ft)
 Recomm. Pumping Rate: _____ (Lps / gpm)
 If flowing, provide rate: _____ (Lps / gpm)

F1 Well Water Level Drawdown/Recovery DATA

Drawdown		Recovery	
Time (min)	Water Level (m / ft)	Time (min)	Water Level (m / ft)
0 (SWL)		0 (FWL)	
1		1	
2		2	
3		3	
4		4	
5		5	
10		10	
15		15	
20		20	
25		25	
30		30	
40		40	
50		50	
60		60	

G1 GROUNDWATER QUALITY

Field Data
 Date Measurements Taken: _____
 Electrical Conductivity: _____ uS
 pH: _____
 Temperature: _____ °C
Groundwater Type
 Salty
 Sulphur / Egg Odour
 Organic Taste / Odour
 Metallic Taste
 Other: _____

Turbidity/Sand Content
 Clear
 Slightly turbid/cloudy
 Moderately turbid/cloudy
 Turbid/cloudy
 Trace sand present
 No sand present

Well Disinfection
 Was the well disinfected upon completion of the pump installation? YES NO
 Briefly describe method of well disinfection: _____

Bacteria Testing

Was a sample taken? YES NO
 Date Sample Taken: 09 10 18 20 10 16
 If yes, indicate the name of the laboratory: Whitehorse

Chemical Analysis of Water

Was a sample taken? YES NO
 Date Sample Taken: 09 10 18 20 10 16
 If yes, indicate the name of the laboratory: ALS

WELL CONTRACTOR

H1 Name of Contractor / Drilling Company: MalDouglas Water R
 H2 Name of Driller(s): Brian Mac Poval
 H3 Address of Driller: Box 10254 Whse 4.T
B. H. O'Neil
 Signature of Primary Driller: _____
 Date Submitted to Dept. Of Environment: _____

CONSULTANT (If applicable)

I1 Company Name: _____
 I2 Company Address: _____
 I3 Report Reference: _____
 I4 Report Date: _____

ADDITIONAL INSTRUCTIONS

Upon completing this form, please mail or fax it to:

Water Resources Section (V-310), Department of Environment, Government of Yukon
 Box 2703, Whitehorse, Yukon, Canada Y1A 2C6

Please feel free to contact us at:
 Phone: (867) 667-3171, Toll free (in Yukon): (1-800) 661-0408, local 3171
 Fax: (867) 667-3195 E-mail: Water.Resources@nov.ca