



EAST  
ARM

FRANCES  
LAKE

105-H-11  
105-H-6

Boundary  
Line

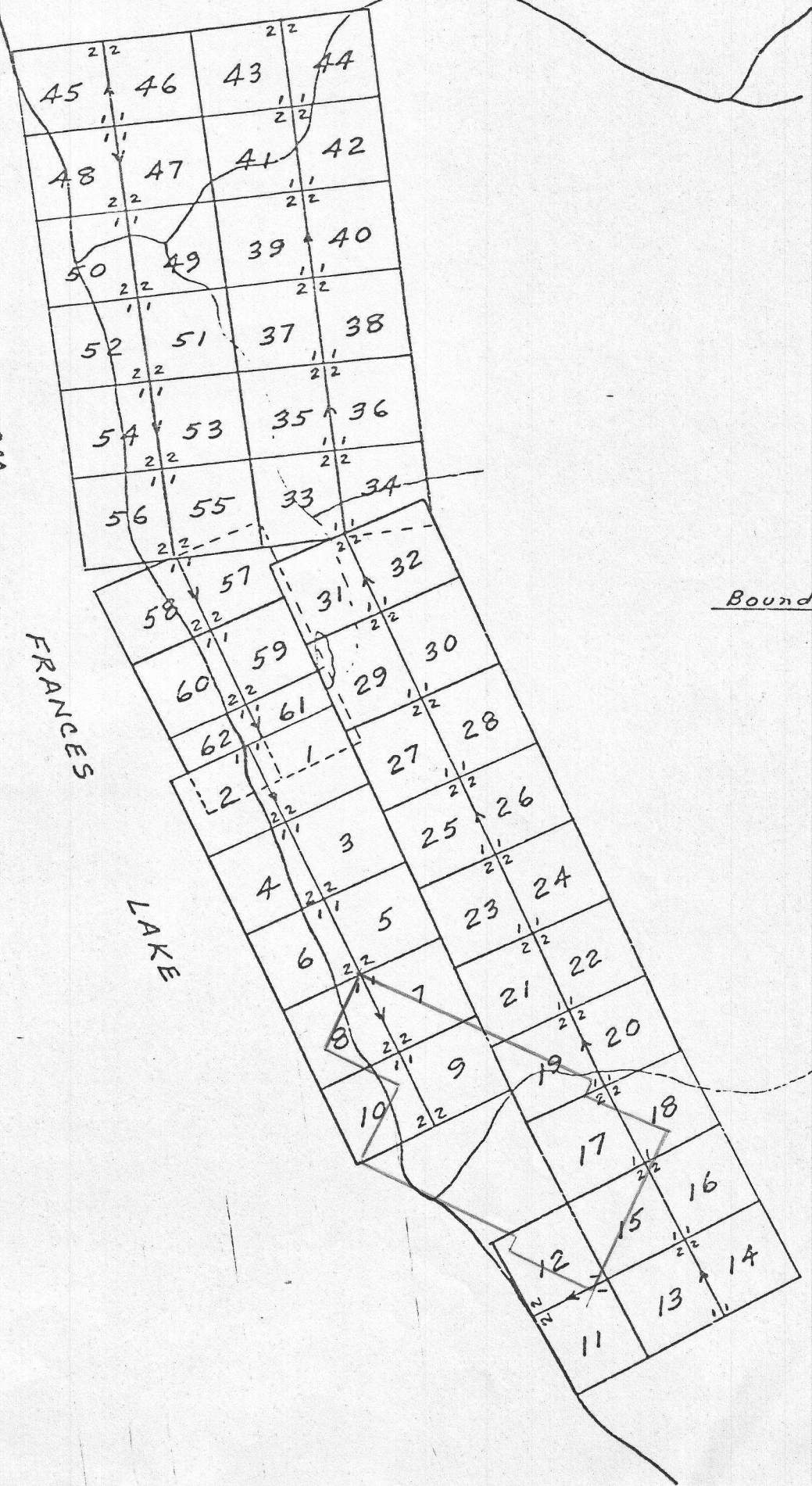

Mineral Claims  
ZINC 1-62  
Mineral Sheets  
105H-6, 105H-11  
Scale 1" = 1/2 mile

Brock000253

# NOTICE

THIS MAP IS ISSUED AS A PRELIMINARY GUIDE FOR WHICH THE DEPARTMENT OF INDIAN AFFAIRS AND NORTHERN DEVELOPMENT WILL ACCEPT NO RESPONSIBILITY FOR ANY ERRORS, INACCURACIES OR OMISSIONS WHATSOEVER.

SHE

DEPARTMENT OF INDIAN AFFAIRS AND NORTHERN DEVELOPMENT

FT. 1500

ISSUED UNDER

NORTHERN DEVELOPMENT

5 DEC 76  
 20 AUG 75  
 1 AUG 75  
 17 MAR 75  
 7 FEB 75  
 4 NOV 74  
 18 AUG 74  
 16 JULY 74  
 25 APRIL 74

4 JULY 77  
 28 MAR 77  
 27 JAN 76

WHITEHORSE 28 August 72  
 30 April 57 22/FEB 73

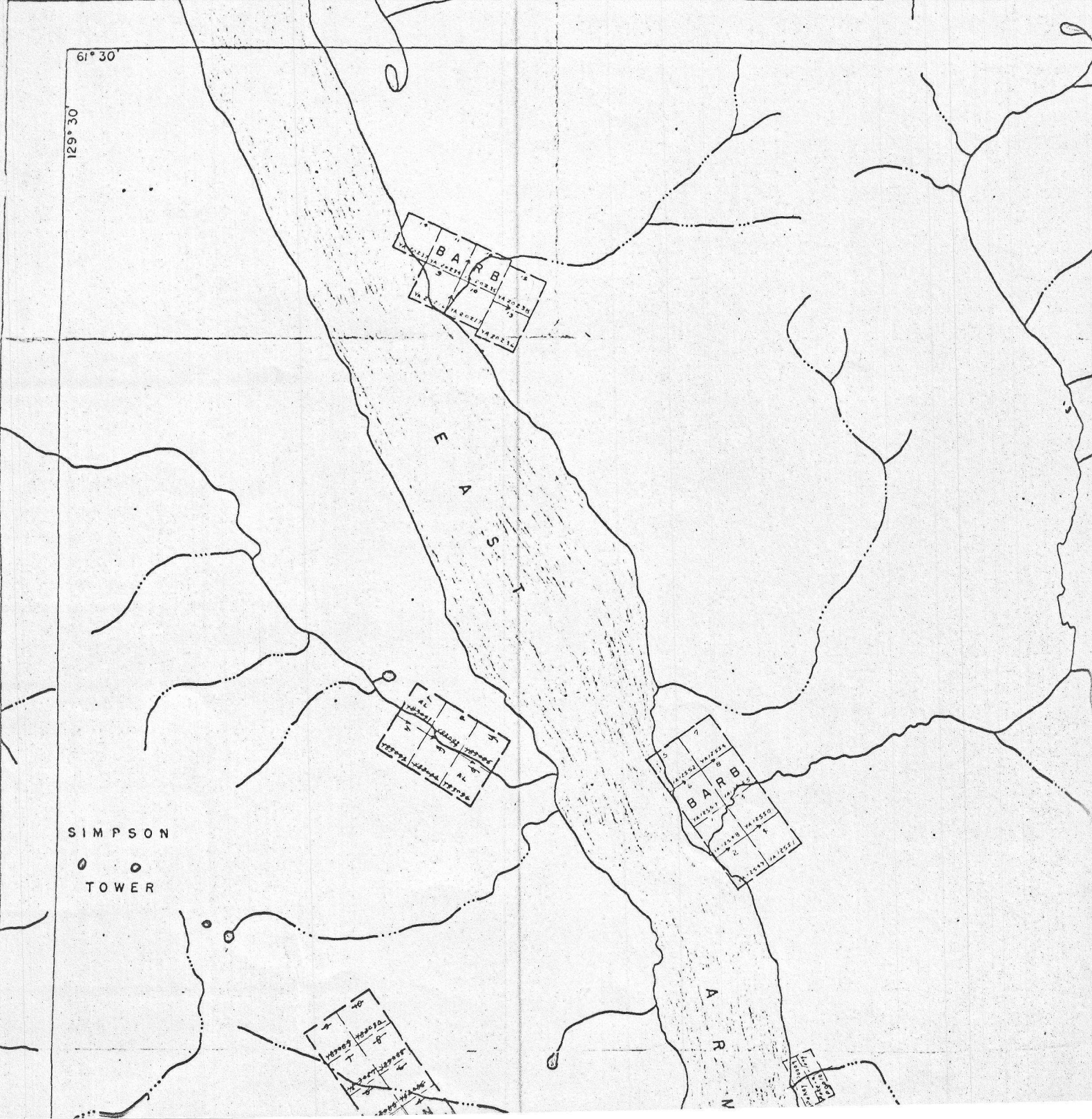

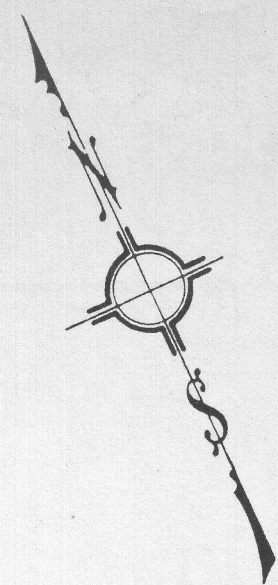

61° 28'

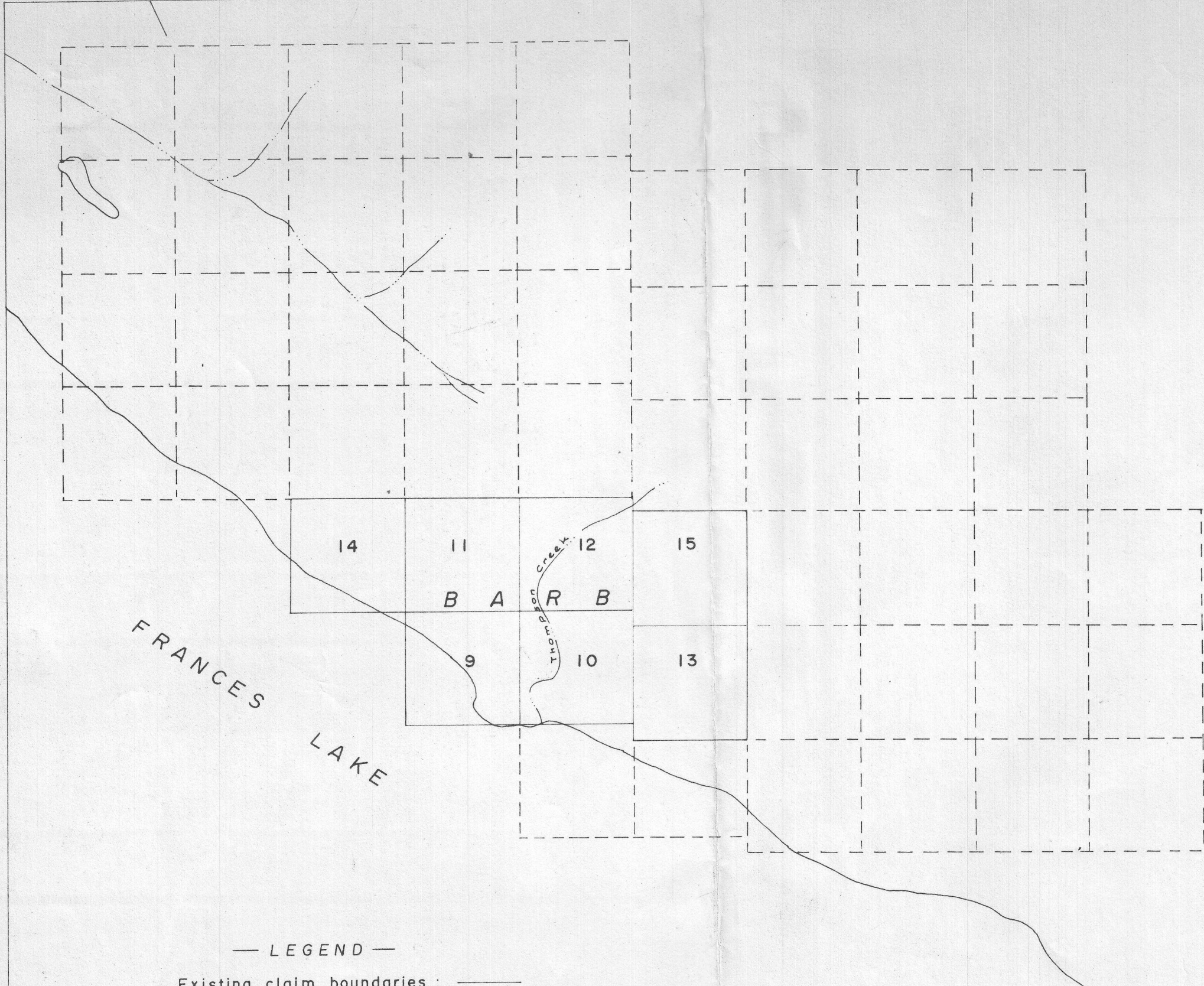

FRANCES LAKE

Thompson Creek

14

11

12

15

B A R B

9

10

13

— LEGEND —

- Existing claim boundaries : ———
- Additional claims proposed : - - - -
- Boundary of agreement area: - - - -

61° 28'

129° 25'

SOVEREIGN METALS CORPORATION (N.P.L.)

PROPOSED STAKING TO ADJOIN BARB 9 to 15  
MINERAL CLAIMS - FRANCES LAKE AREA

Watson Lake M.D., Yukon

Map 105 - H 6

Scale: 1" = 1500'

Nov. 2, 1977