

116+070 PANEL 2
 VERTICAL X-SECTION
 DDH-TRACES AND LITHOLOGY

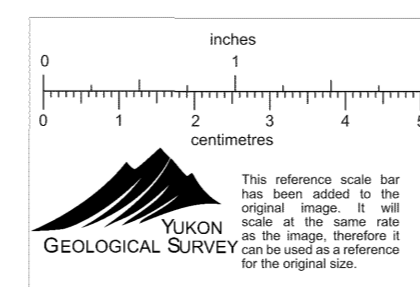
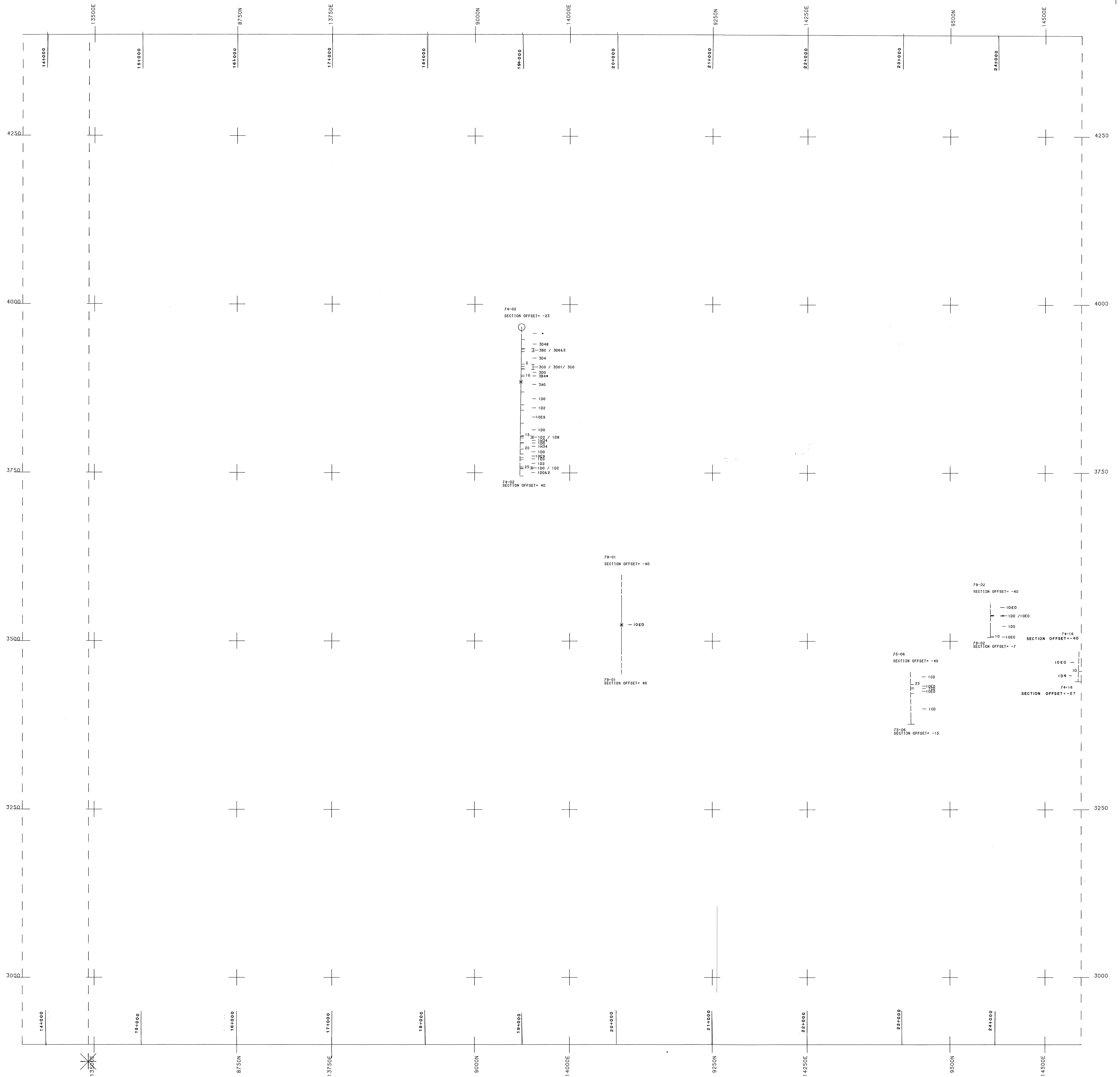

PLOT RATIO 1" = 600' UNITS: FEET DRAWN BY: PROGRAM DHD8 PLUNGE CORRECTION: NO 10 NOV 1986 5:04 PM COORDINATE SYSTEM: MINE SURVEY	PANEL NO: 2
--	----------------

CURRACH RESOURCES !THE IMPERIAL ANVIL! VERTICAL CROSS SECTION 116+070 315 DEG VIEW AZIMUTH 45 DEG PROFILE	
---	--

000242