

MEMORANDUM

000738

TO: M. O. Hampton  
FROM: P. M. Pettigrew  
DATE: March 7, 1972  
SUBJECT: ISOPACH MAPS OF THE FARO OREBODIES

Attached are isopach maps contouring the thicknesses of Faro sulphides and the overlying waste (non-sulphides) individually. Also attached is a map (generated from the isopach maps) contouring the ratio of overlying waste to underlying sulphide thickness of the same.

No attempt has been made to define (economic) ore in terms of depth, grade, and thickness in the above.

*P. M. Pettigrew*

P. M. Pettigrew  
Ore Control Geologist

PMP/mm

cc. Exploration

Attach.



ANVIL MINING CORP  
FARO

isopach map: Faro1-3, showing  
contours of equal thicknesses of  
overlying waste. Intervals: 50'  
scale: 1"=400'

72 dwg FX-7257  
pmp

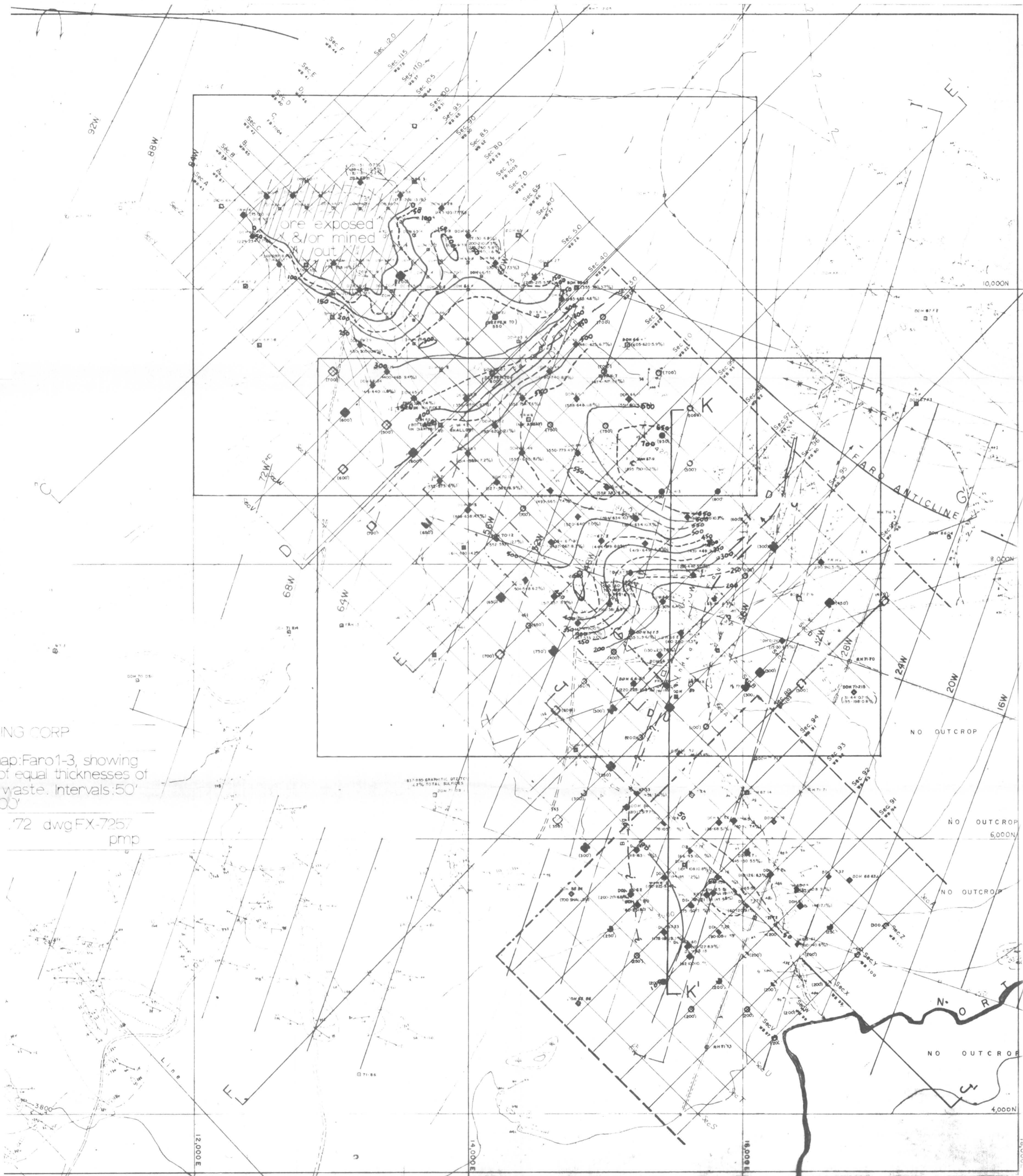
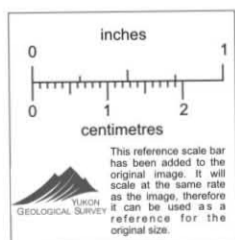

ANVIL MINING CORP.  
FARO  
isopach map Faro 1-3, showing  
contours of equal sulphide  
thicknesses, intervals 50'  
scale 1" = 400'

72 dwg FX-7255  
rmp

