

11,000 N

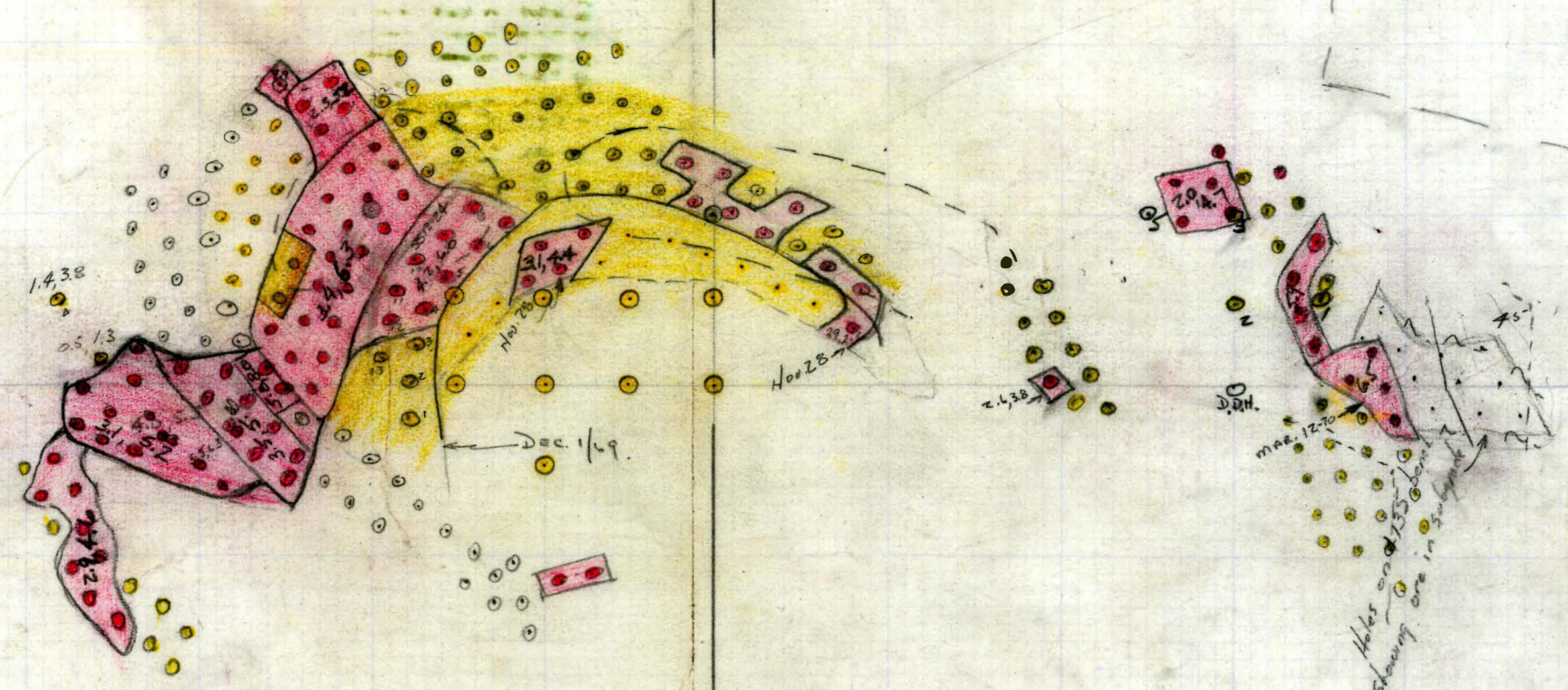

10,500 N

13000 E

002006

4100 BENCH.

4100 (WEST) BENCH - MAR. 13/70

13 000 E

SS-19

10,500 N

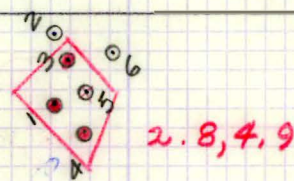

TP

#1 = 6110

10 000 N

4100 (EAST) BENCH - MAR. 11/70

13,000 E

AVER. ELEV.
= 4146

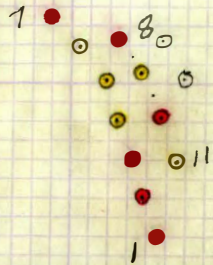

SS-30
SS-28

10,500 N

- #1 = 6092
- #7 = 6098
- #8 = 6099
- #11 = 6102

AVG = 5.75% comb.

70-19

4100 (WEST) BENCH - MAR. 5/70

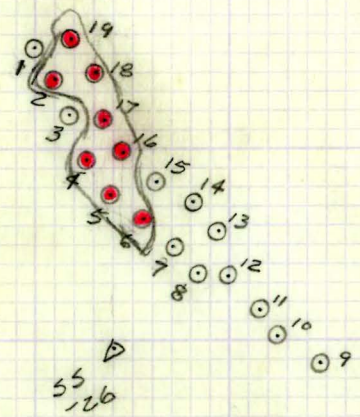

18,500 N

- #1 = 6034
- #8 = 6041
- #9 = 6042
- #19 = 6052

#17, 18 & 19
RESAMPLED

13,000 E

70 Δ
-18

4100 BENCH (EAST) - MAR. 4/70

AVER. ELEV.
= 4146

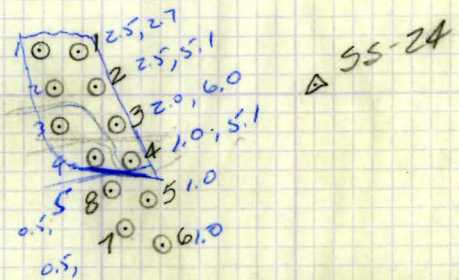

10,500 N

#1 = 6026
#8 = 6033

13,000 E

\triangle 70-13

4100 BENCH - DEC. 29/69

⊙ P15-1

13,000 E

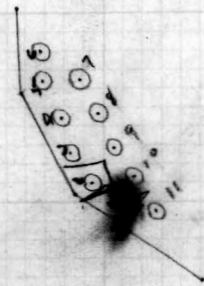

AVER. ELEV.
= 4138

69-44 ⊙

Hole #1: 5659
↳
Hole #11: 5669

- 59 -0.9
- 60 -6.4
- 61 0.8
- 62 2.2
- 63 3.1
- 64 2.3
- 65 4.2
- 66 1.4
- 67 0.7
- 68 0.8
- 69 0.8

10,000 N

4100 BENCH - DEC. 15/69

75-10

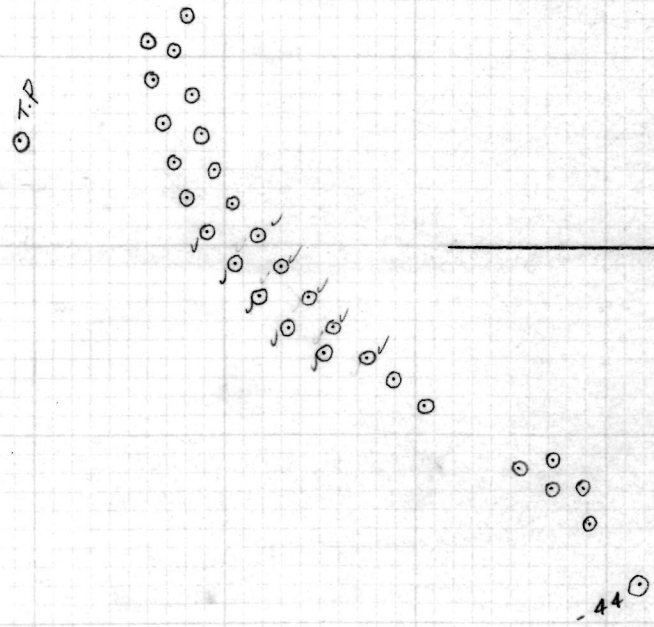

13,000 E

10,000 N

4100 BENCH - DEC. 8/69

AVER. ELEV. = 4138

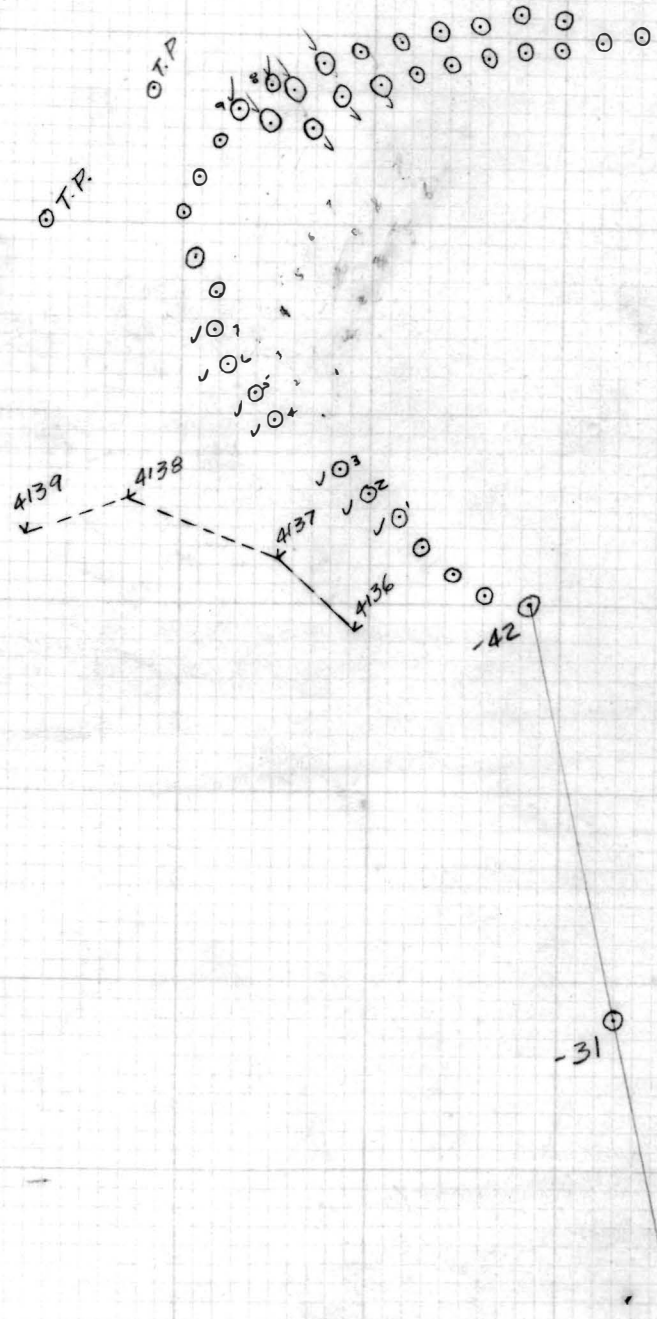

13,000 E

10,000 N

PTS 2

11,000 ft.



69-3

Nov 18/69

13000

4100

P.T.S-2

11,000 N

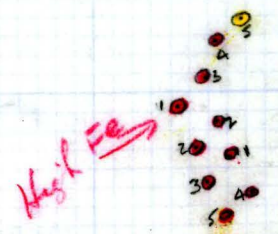
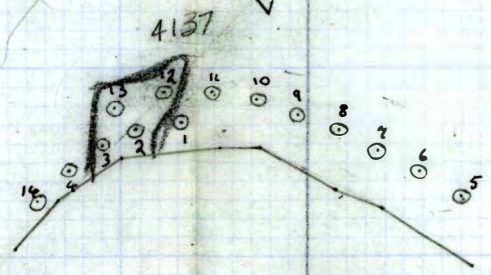
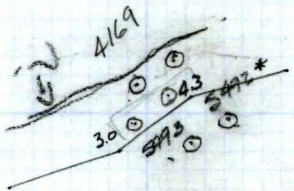

Nov 27/69

69-41

69-31

13,000 E

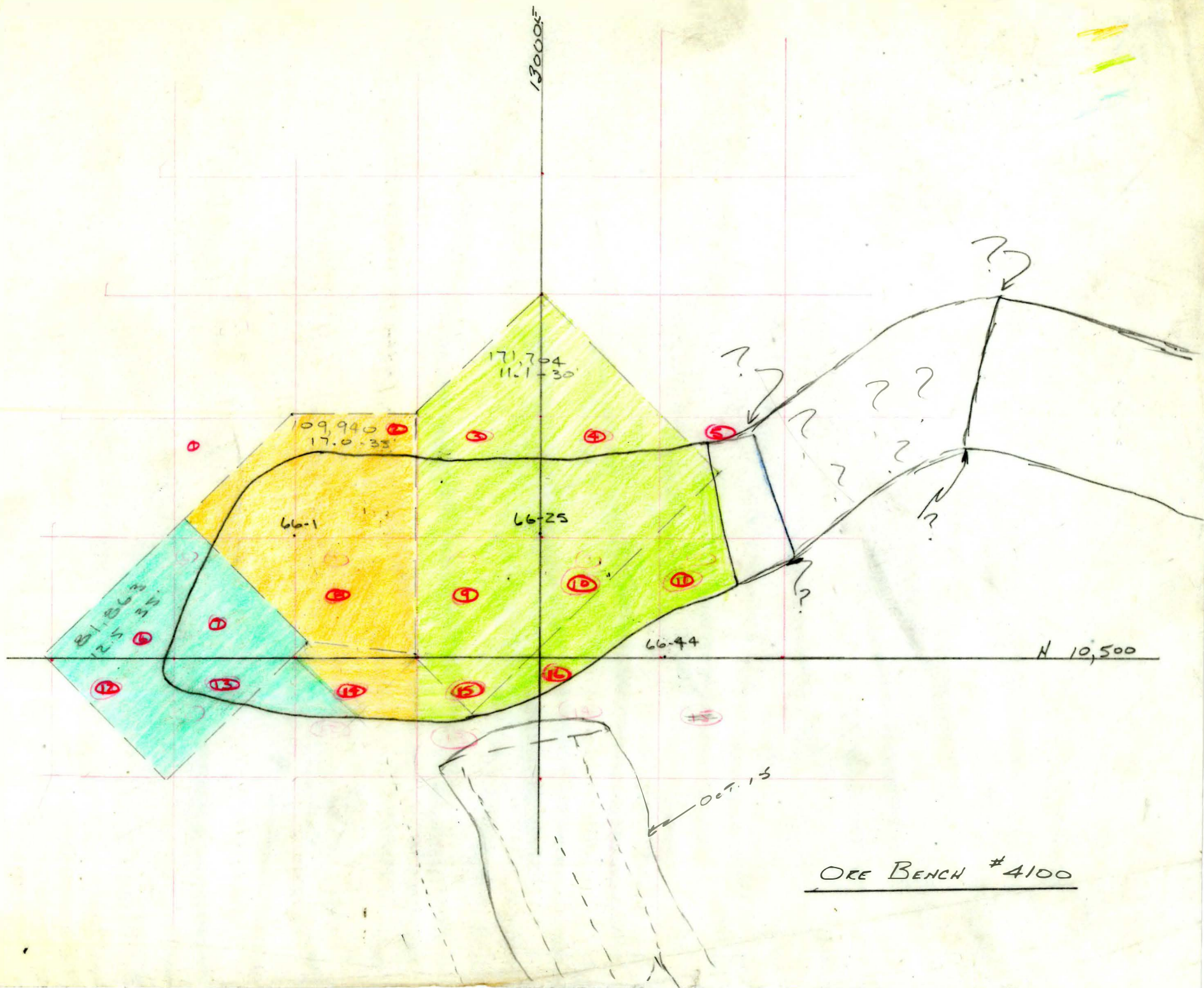

ORE BENCH #4100

BENCH # 4100 EAST SECTION

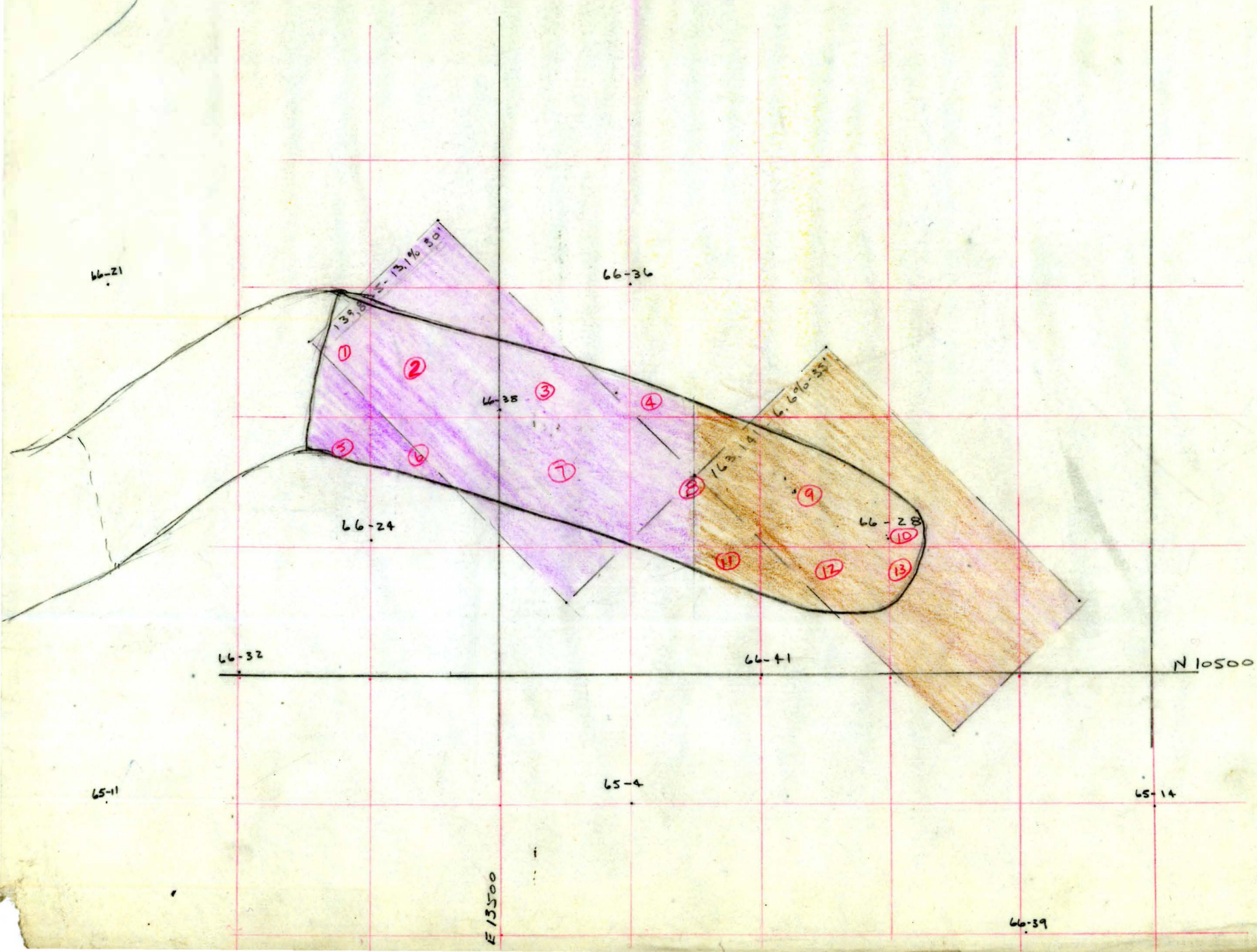

4100 BENCH

Axf = Tons ore (f=618,192)

TOTAL BLOCK = $\frac{A}{0.576} = 356,079$

		Area	Tons	Units	Area	Tons	Units	Area	Tons	Units
D-5	0.018									
1	0.036 - 0.018	0.018	11,127	189,159						
D-6	0.044									
2	0.090 - 0.045	0.045	27,819	472,923						
D-7	0.040									
3	0.086 - 0.043							0.043	26,582	295,060
D-8	0.044									
4	0.090 - 0.045							0.045	27,819	308,791
D-9	0.021							0.024	14,837	164,619
5	0.046 - {0.024, 0.023}							0.023	14,216	157,820
E-4	0.002									
6	0.003 - 0.002	0.002	1236	21,012						
E-5	0.057									
7	0.116 - 0.058	0.019	11746	199,682	0.039	24,109	301,363			
E-6	0.068									
8	0.134 - 0.0675	0.065	40,183	68,311	0.0020	1,236	15,450			
E-7	"									
9	" - 0.0675							0.067	41419	459,751
E-8	0.057									
10	0.116 - 0.058							0.058	35,855	397,991
E-9	0.020							0.010	6182	68,620
11	0.040 - {0.010, 0.020}							0.020	12365	137,252
F-9	0.002									
12	0.003 - 0.002				0.002	1236	15,450			
F-5	0.027									
13	0.051 - 0.026				0.026	16,073	200,913			
F-6	0.032									
14	0.067 - 0.033	0.024	14837	252,229	0.009	5,563	69,538			
F-7	0.030									
15	0.060 - 0.030							0.030	18546	205,861
F-8	0.005									
16	0.010 - 0.005							0.005	3,091	34310
		0.576	106,948	1,818,116	48217	602,714	200,914	2,230,075		
				17.0%					12.5%	11.1%

TOTAL.

Tons	Units.	
11,127	189,159	17.0
27819	472,923	17.0
26582	295,060	11.1
27,819	308,791	11.1
14,837	164,691	
14,218	157,820	11.1
1236	21,012	17.0
35,855	501,045	14.0
41419	698,561	16.9
41419	459,751	11.1
35855	397,991	11.1
6182	68,620	
12365	137,252	11.1
1236	15,450	12.5
16073	200,913	12.5
20400	321,767	15.8
18546	205,861	11.1
3091	34,310	11.1
356,079	4,650,977	13.1% comb. avg. grade.
	13.1%	

18547 205872

66-1 - 4100 bench

4329

COLLAP.
ELEV.

4329

4135
794

BENCH INTER. 194-229

190

AA	Pb	Zn			
			(2.5) ✓ 2.04	191.9 8.5, 12.5 4.4	194' - 4135
4.69	19.6	28.8	←		
2.3 6.39	28.2	46.5	←	✓ 1.36 6.0, 9.9 4.7	200
5.76	28.8	41.8	←	✓ 1.20 6.0, 8.7 4.8	
7.25	32.8	58.3	←	1.88 6.7, 11.9 4.9	6.8, 10.9, 1.95 35 210
6.60	37.5	58.0	←	1.32 7.5, 11.6 5.0	
5.76	32.4	54.0	←	1.28 7.2, 12.0 4.5	220
7.60	36.0	57.5	←	1.52 7.2, 11.5 5.0	
6.69	24.3	36.1	←	(3.8) 1.76 6.4, 9.5 4.8	229' - 4100 230
50.74	239.6	381.0			230
1.45oz	6.8	10.9	over 35'		

4321.21
 4135
 186.21

66-25

COLLAR ELEV = 4321.21

BENCH INTERSECTION = 186.2 to 221.2

#						
					180	
				4.0	186	
			4' cut			
12.90	22.0	28.0	2.58	44.5.6 5.0	190	
14.20	23.0	29.5	2.84	4.6, 5.9 5	200	
14.70	29.5	39.0	2.94	5.9, 7.8 5	43.5.8 35'	2.32
10.15	26.0	31.5	2.03	5.2, 6.3 5	210	
11.15	20.5	32.0	2.23	4.1, 6.4 5		
14.25	23.0	34.5	2.85	4.6, 6.9 5.0	220	
3.72	5.5,	6.8	(1)	3.72 5.5, 6.8 5.0	221	
					225	
81.07	149.5	201.3				
2.32	4.3	5.8	over 35'	10.1		
2.62	4.8	6.5	over 31'	11.3	11.3	

165.0
165.6
24

4310.6
4135
165.6

350
24
32.6

66-38 4100 Bench.

COLLAR ELEV 4310.6 BENCH INTER. 165.6 to 200.6

2.4	-	-	-			
5.0	0.06	Tr	0.1	0.30	-	0.5
5.0	0.18	0.1	1.3	.90	0.5	6.5
5.0	1.3	4.3	15.2	6.50	21.5	66.0
5.0	1.0	2.9	7.0	5.00	14.5	35.0
5	0.6	3.6	12.3	3.00	18.0	61.5
5	0.6	3.7	8.4	3.00	18.5	42.0
2.6	1.3	3.1	5.8	3.38	8.1	15.1
				22.08	81.1	226.6
				0.63	2.3	6.5 over 35'
				0.68	2.5	7.0 over 32.6'

66-28 4100 Bench.

4279.8
4135
144.8

Collar Elev. 4279.8 Bench INTERSECTION 144.8 to 179.8.

3.2	1.3	3.8	8.4	4.6	12.2	26.9
5.0	0.3	1.7	5.2	1.50	8.5	26.0
5	0.8	3.8	8.7	4.00	19.0	43.5
5	0.8	2.9	7.4	4.00	14.5	37.0
5	2.64	2.9	0.2	13.20	14.5	1.0
5	0.90	0.6	Tr	4.500	3.0	-
5	0.40	0.3	Tr	2.00	1.5	-
1.8	0.75	1.0	2.3	1.35	1.8	4.4
				34.71	75.0	175.8
				1.0	2.1	5.0 over 35'

1480
144.8
3.2