

4205 BENCH

11000 N

13000 E

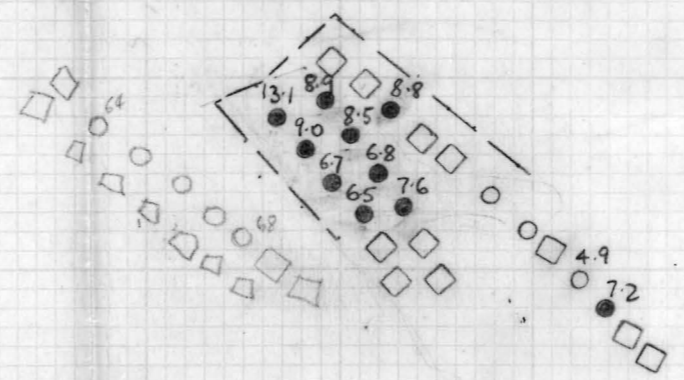

8-1

4205 BENCH

OCT. 1/69

11,000 N

69-21

Av. elev. = 4240

1 = 5256

69-20

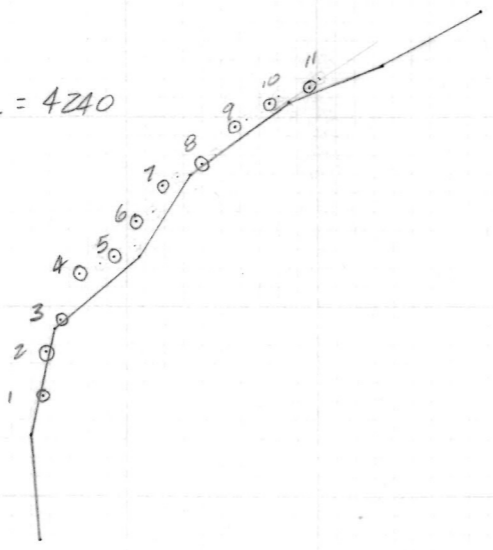

13,000 E

4205 BENCH - OCT. 8/69.

11.000 N

□ 69-13

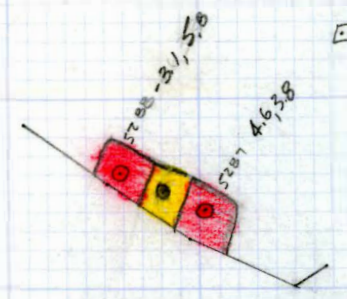

□ 69-27

AVER. ELEV. = 4237

14.000 E

AZ05-BENCH - DEC. 29/69

PTS-2

14,000 E

11,000 N

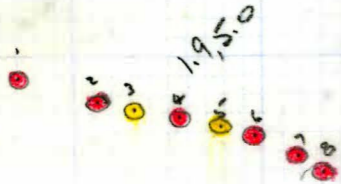

69-27

AVER. ELEV.
= 4238

4200

Hole #1 5670

Hole #8 5677

42031
5
4198

14800	3.9, 7.3	57,720	108,040
19,700	3.2, 6.0	63,040	118,200
3100	2.0, 7.1	6200	22,010
17,300	4.6, 7.2	79,580	124,560
54,900	<u>3.8</u> <u>6.8</u>	206,540	

2 - 5.7, 8.0 X
 5 4.0 8.2 X
 (10 3.8 8.0)
 9 4.1 8.4
 (11 4.0 7.6) 4.3 8.0 12.3%
 16 5.2 8.0

13,600
 45, 8.1 12.6%

30 5.0 8.2x
 { 34 5.1 8.5
 35 4.6 8.1 4.7, 8.3 13.0%
 36 4.4 8.3

8 5.1 8.2
 10 4.7 8.1 4.6, 7.6 12.2%
 (9 4.1 6.5)

4.8 7.8 12.6%

13 5.1 8.5
 15 5.0 8.3
 16 6.8 10.9 4.9, 8.1 13.0%
 (14 3.3, 5.6)
 (17 4.2 7.1)

6 6.6, 3.7 20 3.3, 6.5 30 5.0, 8.2
 # 7 4.0, 6.1 21 3.0 3.7 31 1.9, 4.0
 6 3.2, 6.9 22 3.1, 5.2
 5 4.0 8.2 23 2.6 4.3 TOTAL
 4 3.9, 6.5 27 1.7, 4.0
 3 2.4, 5.5 28 4.0, 6.7
 2 5.7, 8.0 29 2.1, 5.0

~~3.5, 5.9~~
 3.5, 5.9 = 9.4

4205 BENCH.

TOTAL = 0.043 + (1/2 x 0.014) = 0.050.

Block	AREA	Tons	Units
D2	0.002	1236 ✓	
	0.025		
D3	0.001	16,073	
	0.007		
D4	0.004	6,800	
E2	0.002	1236 ✓	
	0.007		
E3	0.002	5565	
	0.050	30910	10.690

4205

Sept 10 1964

0.057
0.113

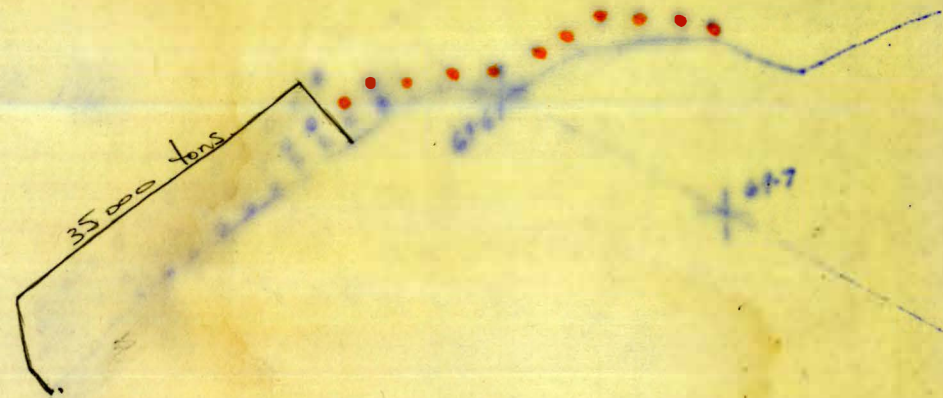

3,000 E

4205 BENCH

4341.9 / 4341.9
4240 / 4205

HOLE # 66-19

COLLAR EL. 4341.9

BENCH

INTER.

101.9 / 136.9

3.1	0.42	1.0	3.1	1.30	3.1	9.61
5.0	2.10	4.9	6.5	10.50	24.5	32.5
5.0	1.52	5.0	9.6	7.60	25.0	48.0
5.0	2.70	6.3	11.9	13.50	31.5	59.5
5.0	1.00	0.6	3.8	5.00	3.0	19.0
5.0	1.60	3.5	12.1	8.00	17.5	60.5
5.0	0.99	2.6	2.4	4.95	13.0	12.0
1.9	0.52	0.5	3.3	0.99	1.0	6.3

35.0 51.84 118.6 247.4

1.48 3.4 7.1

HOLE # 66-1

4329
4240

4329
4205

35
89
124

COLLAR. 4329

BENCH INT.

89 to 124

89 to 101	0	0	0	0	0	0
101 to 104	0.16	0.1	1.9	0.80	0.5	9.50
104 to 109	0.54	1.0	2.2	2.70	5.0	11.0
109 to 114	0.52	1.1	2.8	2.60	5.5	14.0
114 to 119	1.36	2.1	5.6	6.80	10.5	28.0
119 to 124	1.56	5.3	10.8	7.80	26.5	54.00
				<u>20.70</u>	<u>48.0</u>	<u>116.5</u>
				<u>14.60</u>	<u>37.0</u>	<u>82.0</u>
				7.80	26.5	54.0

35'	0.59	1.4	3.3
bottom 10'	1.46	3.7	8.2
bottom 5'	1.56	5.3	10.8

B

C

D

E

F

1

2

3

4

5

6

7

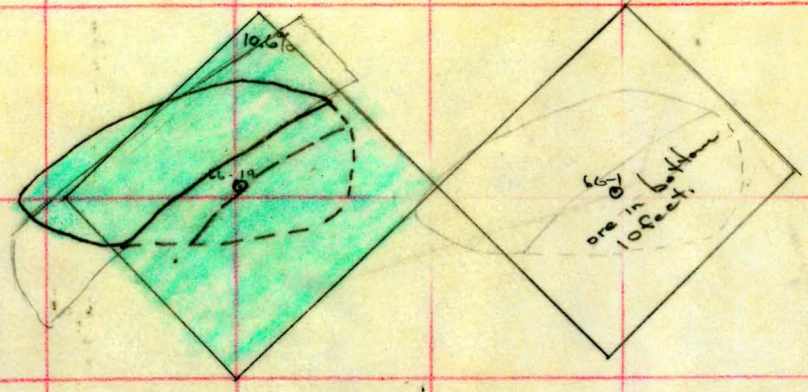

BENCH
4205

11,000 N

13,000 #

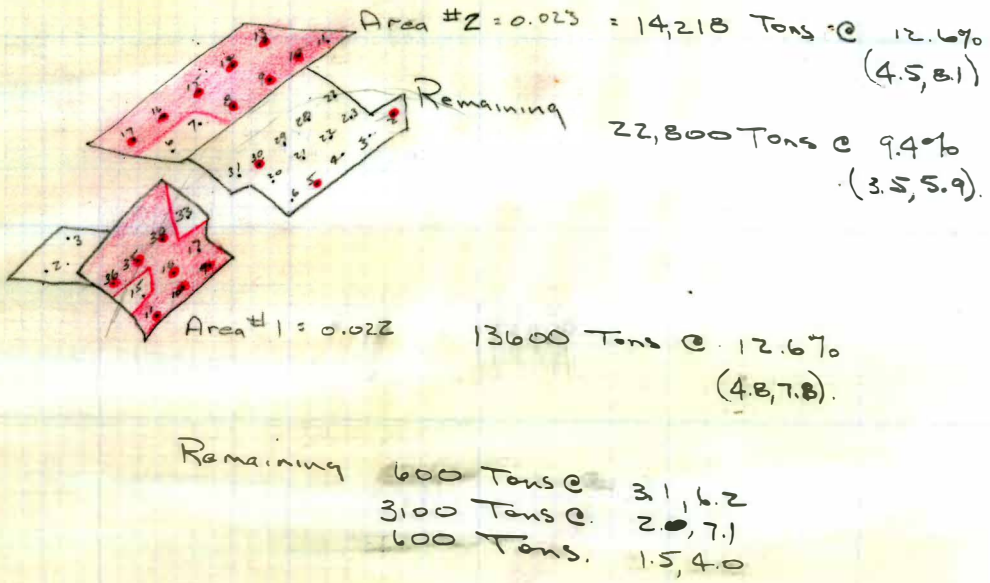

Area #2 = 0.023 = 14,218 Tons @ 12.6%
(4.5, 8.1)

Remaining 22,800 Tons @ 9.4%
(3.5, 5.9)

Area #1 = 0.022 13,600 Tons @ 12.6%
(4.8, 7.8)

Remaining 600 Tons @ 31,6.2
3100 Tons @ 20,7.1
600 Tons 1.5,4.0