

MARCH DEV. ORE (3750)
AS OF Feb 27, 1975 (4PM)

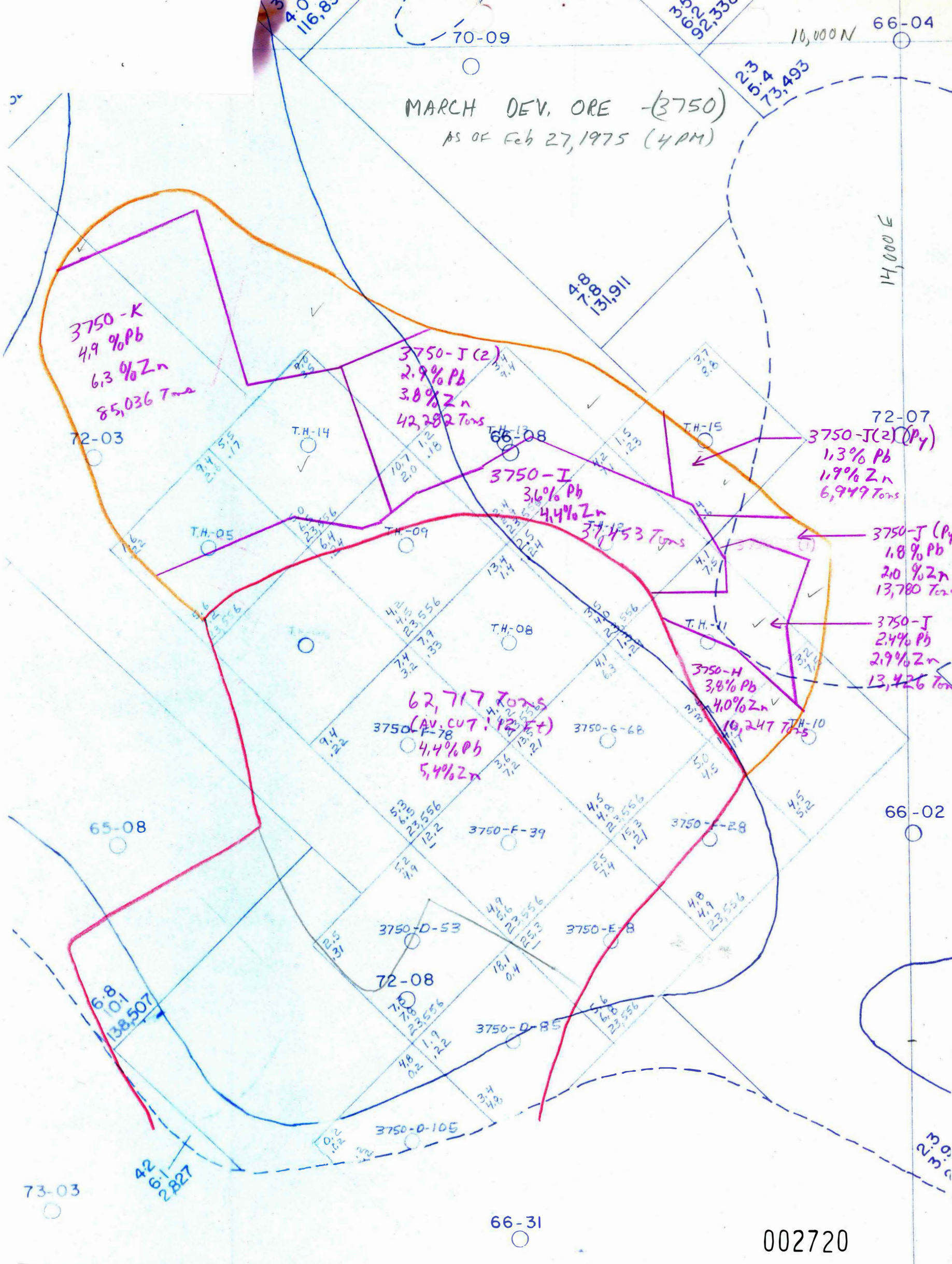

3750-K
4.9% Pb
6.3% Zn
85,036 Tons

3750-J (2)
2.9% Pb
3.8% Zn
42,282 Tons

3750-I
3.6% Pb
4.4% Zn
37,453 Tons

3750-J (2) (Py)
1.3% Pb
1.9% Zn
6,949 Tons

3750-J (Py)
1.8% Pb
2.0% Zn
13,780 Tons

3750-J
2.4% Pb
2.9% Zn
13,426 Tons

62,717 Tons
(AV. CUT: 12 Ft)
3750-F-78
4.4% Pb
5.4% Zn

3750-H
3.8% Pb
4.0% Zn
10,247 Tons