

003112

GRUM Data Base - T & R Data

L.C. Pigage

May 1984

GRUM DATABASE - T AND R DATA

L.C. PIGAGE

MAY 1, 1984

---

INTRODUCTION

This report is a summary description of the procedures used to select the collar locations and downhole deviations for the various drill holes in the vicinity of the GRUM deposit. This data corresponds to the T (drillhole collar location) and R (downhole survey) data subfiles in the GRUM database.

Table I contains a listing of the 459 rotary and diamond drill holes presently entered into the GRUM database. The area encompassed by the present version of the database is illustrated in figures 1 and 2. The database contains all the drillholes completed since 1965 (that CAMC Exploration is aware of). Additional drillholes should be brought to the attention of the author so that the database may be upgraded.

T-DATA

Anvil District Survey Control

In 1979 Northwest Survey Corporation (Yukon) Ltd. completed a new control survey of the Anvil District. The survey was undertaken to provide horizontal and vertical control for a new series of detailed orthophotos, to amalgamate all previous local control surveys to a common datum and to provide a basis for any future control surveys.

All survey control points used in earlier local surveys for Kerr Addison and CAMC were incorporated into the 1979 District survey. In addition, several new survey control points were established. Consequently, all the different deposit areas were tied into a common control grid and elevation datum.

The 1979 Anvil District control survey was then tied into the international UTM ( Universal Transverse Mercator) grid system using Canada Geodetic Survey control points in the Faro-Ross River areas. The locations of these control points were adjusted in mid 1979 using satellite control. The adjusted co-ordinates were incorporated into the Anvil District control survey.

The elevation datum in the UTM system is the geodetic surface based on the North American datum, 1927. This surface corresponds to mean sea level. The UTM grid is rotated  $1^{\circ}34'25''$  ( $1.5736^{\circ}$ ) in a clockwise direction relative to True North in the area of the GRUM deposit.

Because the 1979 Anvil District control survey was tied into the UTM grid system, all District surveys are reported in UTM co-ordinates. The UTM co-ordinates and elevations are also superimposed on all the 1979 detailed orthophotos. All drillhole collars for the GRUM database are referenced using the UTM grid and elevations established during the 1979 survey.

Pre-1965 Exploration Drillholes (Prospectors' Airways, Kerr Addison)

Several P-series and V-series drillholes were completed by Prospectors' Airways and Kerr Addison in the GRUM deposit area. Most of these drillholes are located in the FIRTH zone (NW) and CHAMP zone (SE) of the deposit. These drillholes have not been entered into the GRUM database at this time.

These drillholes were not entered for several reasons, largely related to CAMC Exploration not being fully comfortable with the information in files inherited from Kerr Addison. In many cases, field locations of drillhole collars is incompletely known. At this stage, no field checks of collar locations have been done. Drill core for many of these holes is missing or only incompletely saved. In most cases, it is difficult to translate the original field logs for these drillholes into the current Anvil District lithologic coding.

The P- and V- series drillholes should be added to the GRUM database as more information becomes available for these holes. This information should include surveyed collar locations, (Kerr Addison files?), field checks of collar locations, location and relogging of drill core, and "translation" of original field logs to current lithologic coding.

1965 - 1979 Exploration Drillholes (Anvil, CAMC, Dynasty)

Collar locations for these rotary and diamond drillholes have not been surveyed. In most cases, the collar locations were originally described relative to a local property geophysical and/or geochemical cut grid system.

For the GRUM database, the approximate collar locations were transferred to the 1979 1:5000 scale orthophoto from earlier regional maps, the earlier orthophoto, and air photos. Clearings and roads visible on the 1979 orthophoto were used to help locate the appropriate spot. As part of the Vangorda Plateau Re-mapping Project (1983- ) all the collar locations are being field checked to see if more exact locations can be pinpointed. In some instances, the original drill sites are marked with an unlabelled post or abandoned casing. In these cases, the collars have been located precisely on the 1979 orthophotos.

All UTM co-ordinates for the drillhole collars were measured from the 1979 1:5000 scale orthophoto. Elevations were interpolated from the orthophoto topography. For those drillholes located in the field, collar co-ordinates and elevations are precise to within  $\pm 5$  metres, and  $\pm 2.5$  metres respectively. For the drillholes which could not be located in the field, collar co-ordinates and elevations are considered precise to within  $\pm 10$  metres and  $\pm 5$  metres, respectively.

1973 - 1976 FAGA Drillholes (AEX, Kerr Addison)

In 1975, Kerr Addison established a N-S, E-W control survey grid for the GRUM, Vangorda and Swim Lakes areas. All surface FAGA drillhole collars were systematically surveyed using the control points established with the 1975 survey. Collar locations are reported by Kerr Addison using this local N-S, E-W grid. Drillhole collars for the FAGA drillholes are marked in the field with striped red and yellow posts.

The 1979 Anvil District survey incorporated all the 1975 survey control points used by Kerr Addison. Using the original field survey notes and the new UTM co-ordinates for the 1975 survey control points, Northwest Survey prepared a report listing FAGA collar locations in UTM co-ordinates.

The 1979 control survey established an elevation datum which is 10.61 metres lower than the 1975 control survey. Therefore, all reported Kerr Addison elevations are too high by 10.61 metres compared to the current datum.

Collar co-ordinates and elevations for the FAGA collars are reported in the GRUM database as decimal metres. In most instances, the co-ordinates and elevations reported by Northwest Survey in the 1979 re-interpretation of the original field surveys were incorporated into the database. In a few instances, CAMC Mine Surveyors have resurveyed the locations

of FAGA drillholes. The CAMC mine surveys were preferentially entered into the GRUM database. Precision for all FAGA collars is considered to be within + 1 metre for both UTM co-ordinates and elevation.

1975 - 1976 FAGU Drillholes (Kerr Addison)

Kerr Addison surveyed the underground workings and tied the underground surveys to the 1975 N-S, E-W local grid. Most of the underground FAGU drillhole collar locations were surveyed at this time and co-ordinates reported using the 1975 grid. For the FAGU collars which were not surveyed, Kerr Addison reported an approximate location.

Daryl Hanson (CAMC) reviewed the Kerr Addison underground surveys after CAMC acquired the GRUM deposit. Because of undetected survey errors in the original underground surveys, some of the Kerr Addison co-ordinates were incorrect. Daryl re-calculated the FAGU collars where necessary and provided a corrected set of co-ordinates and elevations relative to the 1975 control survey.

In 1982, Jim Marlon-Lambert derived a set of transformation equations for converting between the 1975 Kerr Addison grid co-ordinates and the 1979 Anvil District UTM co-ordinates in the area of the GRUM deposit. These equations are a least squares fit to a selected number of FAGU drillholes with collars reported both in 1975 grid co-ordinates and 1979 UTM co-ordinates. Appendix I contains a more detailed description of the conversion equations and their derivation.

Collar co-ordinates for the FAGU drillholes in the GRUM database were calculated from Daryl Hanson's revised 1975 grid co-ordinates using Jim Marlon-Lambert's conversion equations. Elevations reported in the database were calculated by subtracting 10.61 metres from the revised elevations reported by Daryl Hanson. All collar co-ordinates and elevations are reported in the GRUM database as decimal metres. Where the original collar location was surveyed precision is considered to be within + 1 metre. Unsurveyed collar co-ordinates have an unspecified precision; constraints on location probably restrict the collar location to within + 5 metres and + 2 metres for horizontal co-ordinates and elevation, respectively.

1979 - 1983 Surface Drillholes (CAMC)

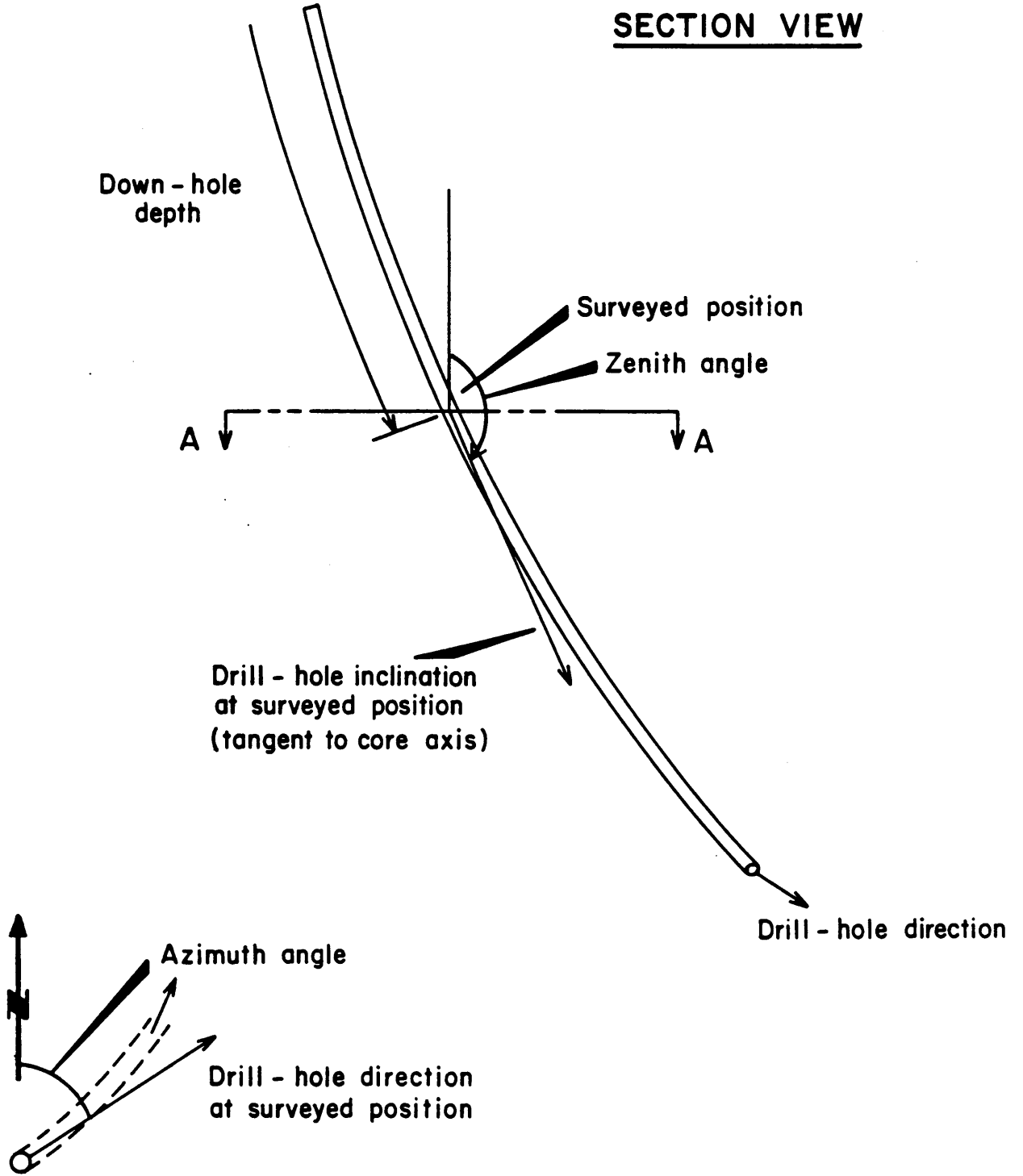
Diamond drillholes completed by CAMC between 1980 - 1983 include FAGA 200 - FAGA 241, FAGADL1 - FAGADL4, FA81AX1, and FA80C51 - FA80C62. Collar locations of these drillholes have all been surveyed by CAMC Mine Surveyors. Drillhole co-ordinates have been entered into the GRUM database as decimal metres. Precision of the surveys is within + 1 metre.

R-DATA

The R-data subfile in the GRUM database contains the orientation of each drillhole at the collar and at specified (measured) intervals down the drillhole. Downhole surveys at GRUM were completed using acid dip tests, Sperry Sun single shot measurements, or Tropari measurements. Table 2 contains a listing of all downhole surveys currently in the GRUM database.

The drillhole orientation data are reported using two angles (see figure 3). The azimuth angle ranges between  $0^{\circ}$  and  $360^{\circ}$ ; it measures the clockwise angle between the horizontal projection of the drillhole trace and True North. The zenith angle ranges from  $0^{\circ}$  to  $180^{\circ}$ ; it measures the inclination of the borehole trace in the vertical plane containing the azimuth. A zenith angle of  $0^{\circ}$  is vertically upward and a zenith angle of  $180^{\circ}$  is vertically downward. Therefore a drillhole inclined at  $-80^{\circ}$  would have a reported zenith angle of  $170^{\circ}$ .

In the GRUM database azimuth and zenith angles are reported in decimal degrees. For zenith angles of  $0^{\circ}$  and  $180^{\circ}$  the azimuth angle is undefined; in the database the azimuth angle for these two cases is recorded as  $0.0^{\circ}$ . Azimuth angles are all measured relative to True North. Instrument readings using magnetic north have been consistently corrected to True North by adding  $33^{\circ}$  to the instrument readings. Although reported in decimal degrees, azimuth and zenith data cannot be considered accurate or precise to better than  $\pm 2^{\circ}$ .



**PLAN VIEW A-A**

**Figure 4 - 3 DEFINITION OF DOWN - HOLE SURVEY ANGLES**

1965 - 1979 Exploration Drillholes (Anvil, CAMC, Dynasty)

Collar orientations for all drillholes are vertically downward (azimuth =  $0^{\circ}$ ; zenith =  $180^{\circ}$ ). No downhole surveys were completed on the rotary drillholes; in the database these drillholes do not contain any deviation from the vertically downward orientation.

For the diamond drillholes Sperry Sun instrument readings are reported in the database when measured. In one instance the downhole deviation was measured using acid dip surveys. In this case the zenith angle was taken from the acid test, and the azimuth was taken from a downhole Sperry Sun single shot test in a nearby drillhole. In a few cases no downhole surveys were completed. Where possible a fictitious set of downhole surveys was calculated by using averages of downhole surveys in nearby drillholes.

1973 - 1976 FAGA Drillholes (AEX, Kerr Addison)

Collar orientations for all drillholes are vertically downward (azimuth =  $0^{\circ}$ ; zenith =  $180^{\circ}$ ). Downhole surveys for many of the FAGA drillholes were originally measured using either Sperry Sun single shot of Tropari instruments. All instrument readings were checked against the logged lithology for the same downhole depth. If the lithology was magnetic (pyrrhotite or magnetite reported in significant amounts), the instrument reading was considered spurious and was deleted from the database.

For those drillholes which were surveyed using the Sperry Sun single shot instrument, Daryl Hanson re-read all the extant camera discs. For the most part Daryl's readings were entered into the database. In a few instances Dave Jennings and Gregg Jilson subsequently did spot checks of the camera discs; their readings were entered into the database to replace Daryl's earlier readings.

In many instances (especially for shorter drillholes) the FAGA drillholes did not have any downhole surveys completed. For these situations a downhole deviation was calculated by averaging the downhole survey readings from surrounding FAGA drillholes.

1975 - 1976 FAGU Drillholes (Kerr Addison)

Underground drillholes with downhole survey information were entered into the GRUM database in exactly the same manner as the FAGA drillholes. Daryl Hanson re-read all Sperry-Sun discs, and Dave Jennings and Gregg Jilson did spot checks of the same discs. Instrumental readings were deleted if the results were considered spurious because of magnetic lithologies in the immediate vicinity of the survey.

For short FAGU drillholes no downhole surveys were completed. Because of the short length and diverse orientations of the FAGU drillholes, averaged downhole surveys were not calculated for those drillholes which did not have reported instrument readings. In these instances, the drillhole was considered not to have deviated from the initial drillhole collar orientation.

Kerr Addison surveyed collar orientations for many of the FAGU drillholes. Daryl Hanson checked these surveyed orientations and re-calculated them where necessary. For those collars which were either lost or not surveyed the assumed initial orientations were along azimuth 044 or 224 . Zenith angles were either taken from the original drill log sheets or from the Kerr Addison cross-sections.

Collar orientations entered into the GRUM database were taken from the summary report of FAGU collar co-ordinate and orientation

information prepared by Daryl Hanson. All azimuth and zenith orientation data in the listing were reported as degrees, minutes, seconds. These measurements were converted to decimal degrees for entry into the database. For example, the orientation of FAGU004 was originally reported as azimuth =  $235^{\circ}47'$ , zenith =  $+72^{\circ}04'$ . In the GRUM database the appropriate converted orientation information is azimuth =  $235.8^{\circ}$ , zenith =  $17.9^{\circ}$ .

1979 - 1983 Surface Drillholes (CAMC)

Drillholes completed by CAMC during this interval were all initially vertically downward (except for FAGA224). Downhole surveys on the longer drillholes were completed using a Sperry Sun single shot instrument. For shorter drillholes the deviation from vertically downward was considered to be negligible. All downhole measurements were checked for possible magnetic interference before entry into the GRUM database.

SUMMARY

This report contains summary listings of drillhole collar locations (T-data; Table 1) and downhole survey information (R-data; Table 2) for all 459 rotary and diamond drillholes presently incorporated into the GRUM DDHDB. The area encompassed by the present database is illustrated in figures 1 and 2.

Collar locations are reported using the UTM co-ordinates grid established in the 1979 Anvil District Control Survey. Downhole survey orientations are all referenced to True North; instrument readings were corrected to True North from magnetic north by adding  $33^{\circ}$  to the instrument readings.

Sources of survey information and description of methods used to convert the original data are summarized for the different drillholes in this report.

FURTHER WORK

Vangorda Plateau Remapping Project (ongoing)

The Vangorda Plateau Remapping Project is an Exploration program to provide an internally consistent geological overview of the Vangorda Plateau area. This geological overview will include relogging of drill-holes peripheral to the mineral deposits. It is considered necessary to re-evaluate the importance of fault and fold patterns in the area as they relate to both exploration potential and production decisions.

As part of this project, the collar locations of all Exploration and Development drillholes completed since 1965 are being field checked and transferred to the 1979 1:5000 scale Anvil District orthophoto. UTM grid co-ordinates are being measured from the orthophoto and reported for each of these drillholes. Figures 1 and 2 provide an example of the number and density of peripheral drillholes in the Vangorda Plateau area. It can readily be seen that information from these drillholes is necessary for future planning. As an ongoing project, the Vangorda Plateau re-mapping is a means of making this information more accessible to all potential users within CAMC. This project should continue to re-evaluate the geology for the entire Vangorda Plateau area and incorporate geological information from peripheral drilling throughout the entire southern part of the Anvil District.

GRUM Database Expansion (area)

Figures 1 and 2 delineate the area encompassed within the current GRUM database. The figures illustrate that the area of dense deposit drilling (Cross-sections 60 - 88W) encompasses only about 1/5 of the database. The peripheral drillholes outside the deposit drilling area, however, provide important information for planning purposes. These drillholes obviously contain information needed for questions concerning possible waste dump areas, production buildings, stripping ratios, and road locations.

By including the peripheral drillholes in the GRUM database, the database has become a useful working tool for both geological and engineering purposes. This expansion of the database to include peripheral areas should be completed for all deposit areas. The various databases should be upgraded to more universal, accessible inventories of information.

In particular, the area encompassed by the GRUM database should be further expanded to the southwest and northeast to include the drillholes indicated in figures 1 and 2. These peripheral drillholes provide important geological information concerning the downdip and updip extensions of the stratigraphy containing the GRUM deposit. In addition, the information is potentially useful for planning purposes.

Finally, the GRUM database expansion also provides a useful inventory for drillhole information. CAMC Exploration previously proposed the development of an Anvil District Drillhole Database to provide an inventory of all drilling within the entire district. That proposal has been delayed indefinitely. As an interim measure, expansion of the individual deposit databases allows for at least an initial cataloguing of the drilling completed in the Vangorda Plateau area. By having the drillholes in the database, plotting and reporting of drilling results is facilitated at a number of different scales.

GRUM Database Expansion (future)

At present, the database contains only the drillholes specifically known to CAMC Exploration. In all probability several geotechnical drillholes have been completed which are not entered into the database. Provisions should be made to ensure that all past drilling be entered into the database. In addition, the database should be consistently upgraded to include all future drilling for geological and engineering purposes.

Engineering/Production Planning

Figures 1 and 2 indicate the locations of both rotary and diamond drillholes in the vicinity of the GRUM deposit. They also readily indicate the density of drillhole information presently available for production and planning purposes. This report should be used as the base for evaluating whether further drillhole information is needed in any particular area encompassed by the database.

A P P E N D I X

INTRODUCTION

The 1975 Kerr Addison control survey grid is an orthogonal grid oriented North-South and East-West. The origin for the grid is in the Anvil District area. The North direction was determined using astronomical observations. Units of measurement for the grid are metres.

The 1979 Anvil District control survey is an orthogonal grid which has been tied into the international UTM grid system. In the Anvil District area the UTM grid north is rotated in a clockwise direction from True North by  $1.5736111^{\circ}$ .

Because the survey is tied into the UTM system, the origin for the 1979 survey is located at Latitude  $0^{\circ}$ N (equator) and Longitude  $135^{\circ}$ W (= 500,000 E in UTM co-ordinates.)

The UTM grid is a rectilinear grid system with both N and E reference axes being measured in metres. However, the grid is a projection of the sea level spheroid, and distances are therefore slightly exaggerated by the projection process. Therefore, a scaling factor must be used to convert measured lengths to UTM lengths. The scaling factor is defined as  $\frac{\text{UTM length}}{\text{measured length}}$ .

Conversion equations between the two different grid systems will therefore involve the following three operations:

1. Translation (K-A grid origin is different from UTM grid origin)
2. Rotation (by  $1.5736111^{\circ}$ )
3. Scaling (to correct distances to the geodetic datum).

If these different operations are combined, the resulting conversion equations are:

A) Kerr Addison co-ordinates to UTM co-ordinates

$$1. N_{UTM} = N_0 + S \cdot (N_{KA} \cdot \cos \alpha + E_{KA} \cdot \sin \alpha)$$

$$2. E_{UTM} = E_0 + S \cdot (-N_{KA} \cdot \sin \alpha + E_{KA} \cdot \cos \alpha)$$

B) UTM co-ordinates to Kerr Addison co-ordinates

$$3. N_{KA} = [(N_{UTM} - N_0) \cdot \cos \alpha - (E_{UTM} - E_0) \cdot \sin \alpha] / S$$

$$4. E_{KA} = [(N_{UTM} - N_0) \cdot \sin \alpha + (E_{UTM} - E_0) \cdot \cos \alpha] / S$$

where  $N_{UTM}, E_{UTM}$  = UTM co-ordinates of a point

$N_{KA}, E_{KA}$  = Kerr Addison co-ordinates of a point

= clockwise offset angle between Kerr Addison and UTM grids

$$= 1.5736111^{\circ}$$

$$\cos \alpha = 0.9996229$$

$$\sin \alpha = 0.0274612$$

$S$  = scaling factor

$N_0, E_0$  = origin of Kerr Addison grid in UTM co-ordinates

$+S$  = 0.99950853 average value

$+N_0$  = 6894007.1169 least squares minimum

$+E_0$  = 584995.9084 least squares minimum

Inspection of equations 1 through 4 indicates that NUTM, EUTM,  $N_{KA}$ ,  $E_{KA}$ ,  $N_o$ ,  $E_o$ , and  $S$  are unknowns. Northwest Survey, however, as part of the 1979 District control survey calculated UTM co-ordinates for all Kerr Addison FAGA drillholes from the original survey notes. Consequently, for these drillholes both NUTM, EUTM and  $N_{KA}$ ,  $E_{KA}$  co-ordinates are known. For a selected number of drillholes the remaining unknowns are  $N_o$ ,  $E_o$ , and  $S$ .

In 1982 Jim Marlon-Lambert solved for  $N_o$ ,  $E_o$ , and  $S$  using a least squares approach. This solution is intended strictly for the GRUM deposit area. He selected twelve Kerr Addison FAGA drillholes containing co-ordinates in both the 1979 UTM and 1975 Kerr Addison grids. The drillholes selected were FAGA017, FAGA018, FAGA031, FAGA042, FAGA053, FAGA061, FAGA100, FAGA116, FAGA119, FAGA126, FAGA131, and FAGA137. These drillholes were selected to encompass the main area of the GRUM deposit.

He then determined scale factors between each drillhole by calculating the UTM grid and Kerr Addison grid distances between each of the drillholes. Since the Kerr Addison co-ordinates use measured distances, the scale factor for each two drillholes is defined by:

$$S = \frac{\text{map distance}}{\text{measured distance}} = \frac{\text{UTM distance}}{\text{Kerr Addison distance}}$$

An average scale factor  $S$  for the deposit was then calculated by averaging all the different scale factors. The average scale factor is:

$$S = 0.99950853$$

Using this average scale factor S, he then did a least squares fit to equations 1 - 4 to arrive at an optimal No. and So. The best values for the selected twelve drillholes was -

$$N_o = 6894007.1169$$

$$E_o = 584995.9084$$

These different values are incorporated into equations 1 - 4 to convert between Kerr Addison and UTM grid co-ordinates.

13APR84 GRUM

## DRILL HOLE COLLAR DATA (DH021)

DDH	UTM-N	UTM-E	UTM-ELEV	TOTAL DEPTH	SECTION	RFE	DIR	PLUNGE	ANGLE		
4567506	905,183.0	592,571.0	1,299.9	157.3	W 72	S2	230	11	312	1975 Exploration DDH	
4567507	905,138.0	592,530.0	1,299.9	288.3	W 72	S2	230	11	312		
4567509	905,787.0	591,302.0	1,303.0	524.2	W 116	S2	230	11	312		
EA65T01	906,080.0	590,838.0	1,268.0	128.0						1985 TIE Rotary Holes	
EA65T02	906,093.0	590,942.0	1,268.0	112.7							
EA65T03	905,960.0	590,612.0	1,276.0	67.0							
EA65T04	905,832.0	590,270.0	1,263.0	70.0							
EA71C34	905,850.0	591,207.0	1,301.0	19.5						1971 Overburden Rotary Holes	
EA71C35	905,690.0	590,960.0	1,308.0	26.8							
EA71C36	905,593.0	590,828.0	1,320.0	16.1							
EA71C37	905,535.0	590,675.0	1,322.0	17.8							
EA71C40	906,125.0	590,482.0	1,243.0	13.1							
EA71162	905,462.0	593,562.0	1,354.0	15.2							
EA71163	905,100.0	592,930.0	1,303.0	15.2							
EA71165	905,495.0	593,000.0	1,332.0	6.0							
EA71166	905,760.0	592,477.0	1,324.0	57.9							
EA71167	906,565.0	591,852.0	1,346.0	9.1							
EA71168	905,277.0	591,418.0	1,338.0	9.1							
EA71169	905,053.0	591,215.0	1,348.0	9.1							
EA71173	904,825.0	591,860.0	1,305.0	9.1							
EA71174	904,625.0	591,687.0	1,304.0	9.1							
EA71179	904,340.0	592,353.0	1,265.0	12.0							
EA71180	904,225.0	592,260.0	1,268.0	24.3							
EA71200	903,915.0	592,380.0	1,229.0	131.1							
EA71201	904,283.0	592,308.0	1,270.0	123.4							
EA76X11	904,375.0	591,980.0	1,278.0	732.7	W 68	S2	230	11	312	Exploration DDH	
EA79T01	905,890.0	590,885.0	1,292.0	288.8		S2	230	11	312		
FA80C51	904,775.0	593,430.0	1,295.0	54.9		S2	230	11	312	1980 Crusher Site DDH	
FA80C52	904,773.0	593,439.5	1,295.0	41.2		S2	230	11	312		
FA80C53	904,765.3	593,428.0	1,295.0	41.1		S2	230	11	312		
FA80C54	904,777.2	593,420.5	1,295.0	41.1		S2	230	11	312		
FA80C55	904,784.7	593,432.2	1,295.0	41.1		S2	230	11	312		
FA80C56	904,792.0	593,419.5	1,295.0	41.1		S2	230	11	312		
FA80C57	904,785.5	593,447.0	1,295.0	30.5		S2	230	11	312		
FA80C58	904,758.0	593,440.7	1,295.0	30.5		S2	230	11	312		
FA80C59	904,764.5	593,413.2	1,295.0	30.5		S2	230	11	312		
FA80C60	904,814.5	593,405.8	1,295.0	30.5		S2	230	11	312		
FA30C61	904,834.5	593,392.5	1,295.0	30.5		S2	230	11	312		
FA80C62	904,860.0	593,376.3	1,295.0	30.5		S2	230	11	312		
FA81AX1	904,653.2	592,906.1	1,270.8	303.8	W 52	S2	230	11	312		1981 Dumpsite DDH
FAGA001	904,778.4	592,022.4	1,296.8	312.6	W 76	S2	230	11	312		GRUM Deposit Surface DDH
FAGA004	904,922.3	592,170.2	1,286.8	314.8	W 76	S2	230	11	312		
FAGA005	904,990.7	592,214.3	1,293.2	180.5	W 76	S2	230	11	312		
FAGA006	905,267.0	592,451.0	1,299.9	145.4	W 76	S2	230	11	312		
FAGA008	905,349.0	592,220.7	1,308.9	232.6	W 84	S2	230	11	312		
FAGA009	905,103.2	592,322.4	1,302.3	232.0	W 76	S2	230	11	312		
FAGA010	905,029.6	592,175.1	1,298.9	264.6	W 78	S2	230	11	312		
FAGA011	904,901.2	592,217.0	1,281.4	249.9	W 74	S2	230	11	312		
FAGA012	905,198.1	592,078.6	1,312.7	364.5	W 84	S2	230	11	312		
FAGA013	904,776.5	592,358.7	1,277.1	186.0	W 68	S2	230	11	312		
FAGA014	904,874.3	592,111.1	1,290.2	334.6	W 76	S2	230	11	312		

17 APR 84

GRUP

## DRILL HOLE COLLAR DATA (DHC21)

DDH	UTM-N	UTM-E	UTM-ELEV	TOTAL DEPTH	SECTION	RFE	DIR	PLUNGE	ANGLE	
FAGA015	905,493.2	592,026.0	1,316.5	249.6	W 92 ✓	S2	230	11	312	not logged by CAMC
FAGA016	905,662.7	591,930.5	1,310.5	304.5	W 98 ✓	S2	230	11	312	not logged by CAMC
FAGA017	904,691.1	592,269.0	1,273.9	283.2	W 68	S2	230	11	312	
FAGAC18	905,312.8	591,855.9	1,322.4	448.4	W 92	S2	230	11	312	not logged by CAMC
FAGAC19	904,906.5	592,305.3	1,284.9	256.8	W 72	S2	230	11	312	
FAGAC20	905,240.4	592,119.0	1,311.1	406.6	W 84 ✓	S2	230	11	312	
FAGA021	904,951.1	592,346.0	1,291.1	260.8	W 72	S2	230	11	312	
FAGAC22	905,148.8	592,034.9	1,311.5	384.6	W 84 ✓	S2	230	11	312	
FAGAC23	904,825.6	592,395.7	1,277.9	306.0	W 68	S2	230	11	312	
FAGAC24	905,067.0	592,123.8	1,303.9	356.3	W 80 ✓	S2	230	11	312	
FAGAC25	905,751.4	592,096.9	1,301.3	315.1	W 96 ✓	S2	230	11	312	not logged by CAMC
FAGAC26	904,742.5	592,485.3	1,277.1	273.3	W 64	S2	230	11	312	
FAGA027	905,114.7	592,167.2	1,303.7	349.6	W 80 ✓	S2	230	11	312	
FAGA028	904,697.3	592,443.2	1,274.0	280.7	W 64	S2	230	11	312	
FAGA029	905,683.8	591,531.6	1,306.6	465.7	W 108 ✓	S2	230	11	312	
FAGAC30	905,046.7	592,270.2	1,303.3	389.5	W 76	S2	230	11	312	
FAGA031	904,617.2	592,533.0	1,267.6	217.6	W 60	S2	230	11	312	
FAGAC32	905,023.4	592,082.3	1,304.4	359.1	W 80	S2	230	11	312	
FAGAC33	904,490.0	592,581.3	1,262.5	219.2	W 56	S2	230	11	312	not logged by CAMC
FAGA034	905,689.5	591,708.8	1,304.7	273.8	W 104 ✓	S2	230	11	312	not logged by CAMC
FAGAC35	904,977.4	592,042.6	1,303.1	389.8	W 80	S2	230	11	312	
FAGA037	904,445.7	592,542.0	1,255.8	158.5	W 56	S2	230	11	312	not logged by CAMC
FAGAC38	904,932.4	592,002.5	1,301.9	363.3	W 80	S2	230	11	312	
FAGA039	904,400.3	592,500.2	1,251.6	234.1	W 56	S2	230	11	312	not logged by CAMC
FAGAC41	904,887.5	591,961.5	1,303.4	384.0	W 80	S2	230	11	312	
FAGAC42	904,354.6	592,459.5	1,254.1	136.6	W 56	S2	230	11	312	not logged by CAMC
FAGAC45	904,869.2	592,435.8	1,281.6	235.3	W 68	S2	230	11	312	
FAGA046	904,274.1	592,548.5	1,241.9	112.3	W 52	S2	230	11	312	not logged by CAMC
FAGAC49	904,327.9	592,762.8	1,248.4	219.5	W 48	S2	230	11	312	not logged by CAMC
FAGAC50	904,319.1	592,589.7	1,242.0	203.3	W 52	S2	230	11	312	not logged by CAMC
FAGA051	905,104.4	591,993.6	1,312.4	367.0	W 84	S2	230	11	312	
FAGA052	904,914.4	592,478.0	1,289.3	261.8	W 68	S2	230	11	312	
FAGA053	905,019.2	592,243.3	1,297.9	357.1	W 76	S2	230	11	312	
FAGA054	904,363.9	592,630.8	1,249.1	142.0	W 52	S2	230	11	312	not logged by CAMC
FAGAC55	904,788.2	592,525.9	1,277.6	217.9	W 64	S2	230	11	312	
FAGAC56	904,995.8	592,385.1	1,299.8	343.1	W 72	S2	230	11	312	
FAGA057	905,564.6	591,758.4	1,314.9	416.4	W 100 ✓	S2	230	11	312	not logged by CAMC
FAGAC58	904,832.0	592,568.5	1,282.6	187.5	W 64	S2	230	11	312	
FAGAC59	905,231.6	591,946.8	1,318.7	397.3	W 88 ✓	S2	230	11	312	
FAGAC60	904,862.0	592,265.4	1,278.8	361.5	W 72	S2	230	11	312	
FAGAC61	905,274.8	591,988.3	1,318.3	276.3	W 88 ✓	S2	230	11	312	
FAGA062	904,868.1	592,347.4	1,279.8	301.1	W 70	S2	230	11	312	
FAGAC63	904,525.2	592,450.3	1,260.7	180.0	W 60	S2	230	11	312	
FAGAC64	905,777.0	591,617.2	1,295.2	432.2	W 108 ✓	S2	230	11	312	
FAGA065	904,948.0	592,254.3	1,288.7	167.5	W 74	S2	230	11	312	
FAGA066	904,785.8	592,440.4	1,276.9	182.9	W 66	S2	230	11	312	
FAGAC67	905,118.4	592,251.7	1,303.3	406.8	W 78	S2	230	11	312	
FAGA068	905,076.7	592,298.2	1,304.1	389.1	W 76	S2	230	11	312	
FAGAC69	905,159.2	592,206.1	1,302.5	410.3	W 80 ✓	S2	230	11	312	
FAGAC70	904,909.9	592,390.5	1,286.1	108.2	W 70	S2	230	11	312	
FAGA071	904,990.3	592,300.3	1,297.0	177.4	W 74	S2	230	11	312	

17-0000

GMM

## DRILL HOLE COLLAR DATA (DHC21)

DDH	UTM-N	UTM-E	UTM-ELEV	TOTAL DEPTH	SECTION	RFE	DIR	PLUNGE	ANGLE
FAGA072	905,073.4	592,215.2	1,304.4	195.0	W 78	S2	23C	11	312
FAGA073	905,149.4	592,364.9	1,302.2	364.1	W 76	S2	23C	11	312
FAGAC74	904,732.8	592,313.3	1,272.9	323.1	W 69	S2	23C	11	312
FAGA075	905,208.1	592,328.4	1,301.2	347.8	W 78	S2	23C	11	312
FAGA076	905,203.8	592,247.0	1,301.8	407.1	W 80	S2	23C	11	312
FAGA077	904,654.3	592,402.2	1,267.6	305.3	W 64	S2	23C	11	312
FAGA078	905,254.9	592,375.8	1,301.1	310.8	W 78	S2	23C	11	312
FAGAC79	905,251.8	592,283.2	1,301.6	419.1	W 80	S2	23C	11	312
FAGAC80	905,299.8	592,418.7	1,300.0	346.3	W 78	S2	23C	11	312
FAGAC81	904,614.5	592,443.1	1,264.8	273.7	W 62	S2	23C	11	312
FAGA082	905,167.6	592,295.3	1,301.7	364.1	W 78	S2	23C	11	312
FAGAC83	904,813.0	592,224.7	1,278.5	360.8	W 72	S2	23C	11	312
FAGA084	904,984.3	592,128.6	1,297.3	456.6	W 78	S2	23C	11	312
FAGA085	905,154.8	592,120.3	1,307.6	431.0	W 82	S2	23C	11	312
FAGA086	905,870.7	591,697.1	1,290.8	616.2	W 108	S2	23C	11	312
FAGAC87	905,199.0	592,161.3	1,305.0	426.4	W 82	S2	23C	11	312
FAGAC88	905,035.3	592,341.9	1,303.4	337.6	W 74	S2	23C	11	312
FAGA089	905,250.1	592,201.2	1,304.4	378.0	W 82	S2	23C	11	312
FAGA090	905,083.2	592,382.9	1,302.1	316.3	W 74	S2	23C	11	312
FAGAC91	905,907.1	591,567.8	1,289.5	541.0	W 112	S2	23C	11	312
FAGA092	905,126.4	592,424.0	1,300.9	288.6	W 74	S2	23C	11	312
FAGAC93	905,290.3	592,243.9	1,302.8	350.5	W 82	S2	23C	11	312
FAGAC94	905,956.0	591,778.4	1,299.0	301.1	W 108	S2	23C	11	312
FAGA095	905,038.1	592,427.7	1,302.8	213.4	W 72	S2	23C	11	312
FAGA096	904,955.0	592,432.5	1,293.0	151.5	W 70	S2	23C	11	312
FAGA097	906,363.7	591,344.4	1,305.2	100.0	W 128	S2	23C	11	312
FAGA098	906,320.3	591,298.9	1,305.9	145.5	W 128	S2	23C	11	312
FAGAC99	904,870.5	592,518.2	1,285.8	189.5	W 66	S2	23C	11	312
FAGA100	905,000.0	592,473.4	1,298.6	250.5	W 70	S2	23C	11	312
FAGA101	906,232.2	591,388.7	1,304.4	269.7	W 124	S2	23C	11	312
FAGA102	904,790.4	592,612.2	1,279.3	183.4	W 62	S2	23C	11	312
FAGA103	904,746.4	592,570.1	1,277.7	214.0	W 62	S2	23C	11	312
FAGA104	905,235.0	592,158.7	1,309.6	420.3	W 84	S2	23C	11	312
FAGA105	904,563.4	592,403.9	1,263.1	199.5	W 62	S2	23C	11	312
FAGA106	904,954.0	592,515.0	1,293.0	190.5	W 68	S2	23C	11	312
FAGA107	904,700.6	592,529.6	1,275.9	216.7	W 62	S2	23C	11	312
FAGA108	904,434.3	592,494.5	1,259.4	189.5	W 58	S2	23C	11	312
FAGA109	904,915.4	592,559.0	1,229.5	190.8	W 66	S2	23C	11	312
FAGA110	904,570.7	592,493.3	1,262.8	198.0	W 60	S2	23C	11	312
FAGA111	905,191.1	591,991.9	1,315.6	394.1	W 86	S2	23C	11	312
FAGA112	904,875.7	592,609.4	1,287.2	172.5	W 64	S2	23C	11	312
FAGA113	905,236.3	592,032.5	1,315.9	474.6	W 86	S2	23C	11	312
FAGA114	904,469.8	592,423.4	1,259.2	221.6	W 60	S2	23C	11	312
FAGA115	905,145.2	591,949.7	1,316.2	448.1	W 86	S2	23C	11	312
FAGA116	904,961.0	592,599.3	1,294.0	181.5	W 66	S2	23C	11	312
FAGA117	904,734.3	592,401.2	1,275.8	214.3	W 66	S2	23C	11	312
FAGA118	905,277.1	592,074.0	1,314.6	468.5	W 86	S2	23C	11	312
FAGA119	904,659.6	592,573.5	1,273.6	172.8	W 60	S2	23C	11	312
FAGA120	905,322.3	592,113.6	1,313.1	453.2	W 86	S2	23C	11	312
FAGA121	904,829.6	592,478.0	1,282.5	263.0	W 66	S2	23C	11	312
FAGA122	904,655.0	592,486.6	1,270.2	232.6	W 62	S2	23C	11	312

--- not logged by CAMC

--- not logged by CAMC

## DRILL HOLE COLLAR DATA (DHC21)

DOH	UTM-N	UTM-E	UTM-ELEV	TOTAL DEPTH	SECTION	RFE	DIR	PLUNCE	ANGLE
FAGA123	905,319.3	592,029.7	1,317.9	464.8	W 88	S2	230	11	312
FAGA124	905,364.6	592,153.1	1,312.4	423.1	W 86	S2	230	11	312
FAGA125	905,363.6	592,070.9	1,316.9	429.8	W 88	S2	230	11	312
FAGA126	905,185.5	591,905.8	1,319.9	160.4	W 88	S2	230	11	312
FAGA127	905,406.1	592,108.5	1,316.2	468.2	W 88	S2	230	11	312
FAGA128	905,179.0	591,898.9	1,320.4	477.3	W 88	S2	230	11	312
FAGA129	904,835.1	592,652.4	1,283.2	152.6	W 62	S2	230	11	312
FAGA130	904,749.1	592,655.9	1,276.8	72.0	W 60	S2	230	11	312
FAGA131	904,704.6	592,614.7	1,276.4	165.5	W 60	S2	230	11	312
FAGA132	905,018.9	592,407.1	1,302.6	144.1	W 72	S2	230	11	312
FAGA133	904,980.2	592,455.5	1,296.8	144.1	W 70	S2	230	11	312
FAGA134	904,935.0	592,493.9	1,290.6	196.3	W 68	S2	230	11	312
FAGA135	904,892.7	592,539.3	1,287.1	175.9	W 66	S2	230	11	312
FAGA136	904,854.8	592,587.2	1,284.7	156.0	W 64	S2	230	11	312
FAGA137	904,898.9	592,628.0	1,289.6	136.1	W 64	S2	230	11	312
FAGA138	905,022.8	592,492.6	1,301.4	96.9	W 70	S2	230	11	312
FAGA139	904,938.2	592,578.8	1,292.3	150.6	W 66	S2	230	11	312
FAGA140	905,426.3	592,283.6	1,306.7	170.0	W 84	S2	230	11	312
FAGA141	905,103.4	592,402.7	1,301.7	93.2	W 74	S2	230	11	312
FAGA142	904,802.5	592,375.2	1,277.5	267.8	W 68	S2	230	11	312
FAGA143	904,977.1	592,534.5	1,295.7	168.0	W 68	S2	230	11	312
FAGA144	905,504.6	592,193.8	1,312.5	145.4	W 88	S2	230	11	312
FAGA145	904,754.2	592,331.0	1,275.4	86.0	W 68	S2	230	11	312
FAGA146	905,583.5	592,100.4	1,313.2	149.4	W 92	S2	230	11	312
FAGA147	904,848.1	592,416.6	1,278.2	184.4	W 68	S2	230	11	312
FAGA148	905,673.8	592,181.9	1,312.2	113.7	W 92	S2	230	11	312
FAGA149	904,811.5	592,546.6	1,284.6	198.4	W 64	S2	230	11	312
FAGA150	905,594.3	592,276.3	1,315.8	150.0	W 88	S2	230	11	312
FAGA151	905,457.2	592,155.3	1,313.1	145.4	W 88	S2	230	11	312
FAGA152	904,765.0	592,505.2	1,277.3	209.2	W 64	S2	230	11	312
FAGA153	904,890.9	592,454.8	1,286.6	218.5	W 68	S2	230	11	312
FAGA154	905,413.1	592,198.2	1,310.7	139.6	W 86	S2	230	11	312
FAGA155	905,171.5	592,385.9	1,300.4	94.5	W 76	S2	230	11	312
FAGA156	905,307.6	592,176.4	1,308.8	206.3	W 84	S2	230	11	312
FAGA157	904,715.7	592,378.1	1,273.9	155.4	W 66	S2	230	11	312
FAGA158	905,184.5	592,315.7	1,302.0	135.6	W 78	S2	230	11	312
FAGA159	904,796.9	592,288.5	1,276.8	148.4	W 70	S2	230	11	312
FAGA160	905,226.7	592,262.5	1,301.7	145.1	W 80	S2	230	11	312
FAGA161	905,186.2	592,316.0	1,301.9	122.2	W 78	S2	230	11	312
FAGA162	904,569.5	592,426.9	1,263.7	130.1	W 62	S2	230	11	312
FAGA163	905,299.6	592,327.3	1,302.1	119.5	W 80	S2	230	11	312
FAGA164	905,349.9	592,367.9	1,302.2	110.3	W 80	S2	230	11	312
FAGA200	904,847.9	592,455.5	1,280.5	283.8	W 67	S2	230	11	312
FAGA201	904,635.3	592,512.1	1,269.0	243.2	W 61	S2	230	11	312
FAGA202	904,807.8	592,503.6	1,278.8	288.6	W 65	S2	230	11	312
FAGA203	904,679.0	592,465.0	1,269.6	279.8	W 63	S2	230	11	312
FAGA204	904,769.8	592,548.2	1,277.9	254.8	W 63	S2	230	11	312
FAGA205	904,804.8	592,416.4	1,277.3	284.3	W 67	S2	230	11	312
FAGA206	904,718.6	592,419.6	1,275.3	318.1	W 65	S2	230	11	312
FAGA207	904,730.1	592,587.2	1,277.2	233.7	W 61	S2	230	11	312
FAGA208	904,826.9	592,313.9	1,278.1	224.6	W 70	S2	230	11	312

not logged by CAMC

not logged by CAMC

not logged by CAMC

not logged by CAMC

DRILL HOLE COLLAR DATA (DHC21)

DDH	UTM-N	UTM-E	UTM-ELEV	TOTAL DEPTH	SECTION	RFE	DIR	PLUNGE	ANGLE
FAGA209	904,682.7	592,550.8	1,274.9	235.0	W 61	S2	230	11	312
FAGA210	904,763.3	592,461.8	1,276.3	127.4	W 65	S2	230	11	312
FAGA211	904,722.8	592,506.7	1,276.7	261.2	W 63	S2	230	11	312
FAGA212	904,768.9	592,446.8	1,276.8	311.1	W 65	S2	230	11	312
FAGA213	904,755.1	592,376.7	1,277.0	307.1	W 67	S2	230	11	312
FAGA214	905,321.7	592,344.8	1,302.0	492.8	W 80	S2	230	11	312
FAGA215	905,057.3	592,358.7	1,302.8	394.3	W 74	S2	230	11	312
FAGA216	904,709.2	592,288.5	1,273.8	429.1	W 68	S2	230	11	312
FAGA217	904,772.2	592,677.5	1,278.0	187.4	W 60	S2	230	11	312
FAGA218	904,619.9	592,618.6	1,271.4	246.1	W 58	S2	230	11	312
FAGA219	904,623.1	592,704.0	1,272.5	252.0	W 56	S2	230	11	312
FAGA220	904,556.7	592,641.0	1,266.2	291.7	W 56	S2	230	11	312
FAGA221	904,596.2	592,597.2	1,268.5	291.7	W 58	S2	230	11	312
FAGA222	904,535.0	592,622.2	1,264.8	291.7	W 56	S2	230	11	312
FAGA223	904,512.6	592,601.9	1,263.8	262.4	W 56	S2	230	11	312
FAGA224	904,552.6	592,557.6	1,264.0	215.5	W 58	S2	230	11	312
FAGA225	904,637.2	592,553.5	1,270.3	217.9	W 60	S2	230	11	312
FAGA226	904,497.2	592,752.8	1,262.8	217.9	W 52	S2	230	11	312
FAGA227	905,275.0	592,303.5	1,301.3	205.1	W 80	S2	230	11	312
FAGA228	905,332.1	592,286.3	1,303.2	194.8	W 82	S2	230	11	312
FAGA229	905,377.2	592,327.0	1,304.0	159.5	W 82	S2	230	11	312
FAGA230	905,394.9	592,262.3	1,307.0	221.6	W 84	S2	230	11	312
FAGA231	905,457.5	592,240.4	1,308.9	185.9	W 86	S2	230	11	312
FAGA232	905,435.2	592,217.7	1,310.0	206.3	W 86	S2	230	11	312
FAGA233	905,371.6	592,242.4	1,306.9	197.8	W 84	S2	230	11	312
FAGA234	905,353.1	592,307.8	1,303.0	165.0	W 82	S2	230	11	312
FAGA235	905,308.9	592,266.6	1,303.2	175.8	W 82	S2	230	11	312
FAGA236	905,266.9	592,225.9	1,304.0	439.2	W 82	S2	230	11	312
FAGA237	905,328.5	592,198.5	1,308.2	215.5	W 84	S2	230	11	312
FAGA238	905,227.0	592,355.1	1,300.7	132.0	W 78	S2	230	11	312
FAGA239	905,193.4	592,405.4	1,299.7	109.1	W 76	S2	230	11	312
FAGA240	904,931.7	592,408.7	1,289.5	111.3	W 70	S2	230	11	312
FAGA241	904,846.8	592,497.7	1,284.8	161.8	W 66	S2	230	11	312
FAGACL1	905,088.3	592,714.1	1,300.0	99.7	W 66	S2	230	11	312
FAGADL2	905,260.8	592,139.7	1,309.8	111.8	W 84	S2	230	11	312
FAGADL3	904,904.8	592,056.6	1,296.0	102.7	W 78	S2	230	11	312
FAGACL4	904,474.8	592,423.4	1,259.6	61.6	W 60	S2	230	11	312
FAGUC01	904,987.4	592,385.1	1,144.0	62.5	W 72	S2	230	11	312
FAGUC02	904,988.6	592,384.9	1,144.0	50.2	W 72	S2	230	11	312
FAGUC03	904,924.3	592,323.8	1,144.7	82.2	W 72	S2	230	11	312
FAGUC04	904,927.5	592,326.6	1,145.0	53.3	W 72	S2	230	11	312
FAGUC05	904,927.7	592,327.3	1,141.0	99.0	W 72	S2	230	11	312
FAGUC06	904,927.2	592,327.6	1,145.0	36.6	W 72	S2	230	11	312
FAGUC07	904,954.5	592,347.1	1,141.2	73.2	W 72	S2	230	11	312
FAGUC08	904,954.5	592,347.1	1,145.3	50.2	W 72	S2	230	11	312
FAGUC09	904,973.9	592,365.6	1,141.4	64.0	W 72	S2	230	11	312
FAGUC10	904,973.9	592,365.6	1,145.3	64.0	W 72	S2	230	11	312
FAGUC11	904,990.4	592,387.8	1,143.1	24.3	W 72	S2	230	11	312
FAGUC12	904,892.4	592,296.5	1,142.3	79.7	W 72	S2	230	11	312
FAGUC13	904,891.9	592,296.1	1,142.3	182.9	W 72	S2	230	11	312
FAGUC14	904,891.3	592,298.6	1,147.1	51.8	W 72	S2	230	11	312

1979 Geotechnical DDH

GRUM Deposit Underground DDH

DDH	UTM-N	UTM-E	UTM-ELEV	TOTAL DEPTH	SECTION	RFE	DIR	PLUNGE	ANGLE
FAGU015	904,908.7	592,226.9	1,155.6	185.9	W 74	S2	230	11	312
FAGU016	904,934.6	592,334.6	1,141.2	106.7	W 72	S2	230	11	312
FAGUC17	904,934.7	592,334.4	1,141.2	125.0	W 72	S2	230	11	312
FAGU018	904,892.5	592,296.5	1,142.4	88.4	W 72	S2	230	11	312
FAGU019	904,890.4	592,294.7	1,144.7	59.4	W 72	S2	230	11	312
FAGU020	904,891.5	592,295.7	1,142.3	74.7	W 72	S2	230	11	312
FAGU021	904,924.0	592,323.8	1,145.0	76.2	W 72	S2	230	11	312
FAGU022	904,927.5	592,327.0	1,141.1	99.0	W 72	S2	230	11	312
FAGU023	904,928.1	592,327.9	1,141.1	70.0	W 72	S2	230	11	312
FAGUC24	904,934.2	592,335.3	1,144.6	59.4	W 72	S2	230	11	312
FAGUC25	904,934.2	592,335.3	1,144.6	114.3	W 72	S2	230	11	312
FAGU026	904,986.3	592,382.5	1,146.2	76.2	W 72	S2	230	11	312
FAGUC27	904,990.0	592,387.0	1,146.8	106.1	W 72	S2	230	11	312
FAGU028	904,913.5	592,234.2	1,155.9	64.0	W 74	S2	230	11	312
FAGU029	904,913.9	592,233.9	1,156.6	68.5	W 74	S2	230	11	312
FAGUC30	904,913.8	592,233.7	1,159.0	36.6	W 74	S2	230	11	312
FAGU031	904,907.6	592,230.7	1,156.2	61.0	W 74	S2	230	11	312
FAGU032	904,907.7	592,228.3	1,155.8	121.9	W 74	S2	230	11	312
FAGU033	904,905.1	592,225.9	1,158.8	21.8	W 74	S2	230	11	312
FAGUC34	904,973.6	592,282.9	1,134.0	126.5	W 74	S2	230	11	312
FAGU035	904,974.1	592,283.2	1,134.0	147.8	W 74	S2	230	11	312
FAGU036	904,838.2	592,376.2	1,157.3	19.8	W 69	S2	230	11	312
FAGU037	904,839.5	592,377.0	1,157.1	53.3	W 69	S2	230	11	312
FAGUC38	904,838.8	592,376.6	1,157.2	85.2	W 69	S2	230	11	312
FAGUC39	904,973.3	592,282.2	1,134.0	110.3	W 74	S2	230	11	312
FAGU040	904,973.1	592,282.1	1,134.0	108.8	W 74	S2	230	11	312
FAGU041	904,975.2	592,284.4	1,134.0	97.5	W 74	S2	230	11	312
FAGU042	904,973.8	592,283.9	1,138.0	53.3	W 74	S2	230	11	312
FAGUC43	904,973.3	592,283.3	1,138.1	45.7	W 74	S2	230	11	312
FAGU044	904,973.8	592,281.1	1,138.2	45.7	W 74	S2	230	11	312
FAGUC45	905,038.6	592,339.0	1,132.6	62.5	W 74	S2	230	11	312
FAGU046	905,038.6	592,339.0	1,132.6	83.7	W 74	S2	230	11	312
FAGU047	905,038.6	592,339.0	1,132.6	80.7	W 74	S2	230	11	312
FAGUC48	905,034.2	592,337.4	1,132.7	120.7	W 74	S2	230	11	312
FAGU049	905,033.4	592,335.2	1,133.9	82.2	W 74	S2	230	11	312
FAGU050	905,033.1	592,336.0	1,133.9	91.4	W 74	S2	230	11	312
FAGUC51	905,033.5	592,335.1	1,135.4	70.0	W 74	S2	230	11	312
FAGUC52	905,033.9	592,335.3	1,136.7	57.9	W 74	S2	230	11	312
FAGUC53	905,034.6	592,335.8	1,136.9	60.9	W 74	S2	230	11	312
FAGU054	905,037.0	592,337.4	1,137.5	150.9	W 74	S2	230	11	312
FAGUC55	905,033.5	592,335.3	1,134.4	36.4	W 74	S2	230	11	312
FAGUC56	905,033.5	592,335.3	1,135.5	61.0	W 74	S2	230	11	312
FAGUC57	905,033.4	592,335.2	1,133.2	53.3	W 74	S2	230	11	312
FAGUC58	905,002.4	592,227.5	1,125.7	106.7	W 76	S2	230	11	312
FAGUC59	905,002.7	592,227.9	1,124.8	127.2	W 76	S2	230	11	312
FAGU060	905,003.9	592,228.8	1,124.4	122.0	W 76	S2	230	11	312
FAGU061	905,003.7	592,228.6	1,124.4	120.5	W 76	S2	230	11	312
FAGUC62	905,002.6	592,227.8	1,125.0	109.7	W 76	S2	230	11	312
FAGUC63	905,002.6	592,227.8	1,126.8	106.6	W 76	S2	230	11	312
FAGU064	905,004.1	592,230.0	1,128.2	57.9	W 76	S2	230	11	312
FAGUC65	905,004.2	592,228.9	1,128.4	59.4	W 76	S2	230	11	312

— not logged by CAMC

— not logged by CAMC

PORT HOLE COLLAR DATA (DHC21)

DRH	UTM-N	UTM-E	UTM-ELEV	TOTAL DEPTH	SECTION	RFE	DIR	PLUNGE	ANGLE
FAGUC66	905,002.3	592,229.4	1,126.3	99.0	W 76	S2	230	11	312
FAGUC67	905,046.1	592,185.5	1,116.0	76.2	W 78	S2	230	11	312
FAGUC68	905,045.2	592,185.3	1,117.2	53.3	W 78	S2	230	11	312
FAGUC69	905,046.4	592,186.2	1,119.6	38.1	W 78	S2	230	11	312
FAGUC70	905,047.5	592,187.1	1,119.4	39.6	W 78	S2	230	11	312
FAGUC71	905,047.8	592,187.3	1,119.3	45.7	W 78	S2	230	11	312
FAGUC72	905,046.2	592,186.8	1,114.0	137.3	W 78	S2	230	11	312
FAGUC73	905,044.5	592,186.6	1,115.4	121.9	W 78	S2	230	11	312
FAGUC74	904,808.5	592,427.3	1,164.3	107.9	W 67	S2	230	11	312
FAGUC75	905,046.9	592,187.2	1,114.0	170.5	W 78	S2	50	11	312
FAGUC76	904,807.9	592,426.6	1,164.3	65.5	W 67	S2	230	11	312
FAGUC77	905,047.9	592,188.1	1,114.3	167.5	W 78	S2	50	11	312
FAGUC78	904,809.0	592,427.9	1,164.4	106.7	W 67	S2	230	11	312
FAGUC79	905,045.3	592,186.2	1,114.5	97.5	W 78	S2	50	11	312
FAGUC80	904,985.3	592,381.4	1,144.2	76.2	W 67	S2	230	11	312
FAGUC81	905,040.5	592,262.3	1,127.2	38.1	W 76	S2	230	11	312
FAGUC82	904,984.8	592,380.4	1,144.1	45.7	W 72	S2	230	11	312
FAGUC83	905,040.7	592,262.7	1,131.5	38.1	W 76	S2	230	11	312
FAGUC84	904,989.3	592,380.9	1,142.6	76.2	W 72	S2	230	11	312
FAGUC85	905,039.6	592,262.1	1,131.6	44.2	W 76	S2	230	11	312
FAGUC86	904,991.3	592,386.5	1,143.4	94.5	W 72	S2	230	11	312
FAGUC87	905,038.7	592,260.3	1,127.2	61.0	W 76	S2	230	11	312
FAGUC88	904,960.5	592,427.3	1,145.4	65.2	W 70	S2	230	11	312
FAGUC89	905,025.9	592,251.3	1,130.7	38.1	W 76	S2	230	11	312
FAGUC90	904,962.9	592,427.5	1,145.4	79.2	W 70	S2	230	11	312
FAGUC91	905,132.2	592,261.0	1,114.7	97.5	W 78	S2	230	11	312
FAGUC92	904,959.4	592,424.5	1,146.4	73.2	W 70	S2	230	11	312
FAGUC93	905,131.0	592,262.3	1,116.3	76.2	W 78	S2	50	11	312
FAGUC94	905,168.2	592,066.8	1,089.2	26.2	W 84	S2	230	11	312
FAGUC95	905,132.0	592,262.0	1,113.9	121.9	W 78	S2	230	11	312
FAGUC96	904,959.5	592,424.9	1,147.4	121.9	W 70	S2	230	11	312
FAGUC97	905,131.7	592,262.1	1,114.1	62.5	W 78	S2	50	11	312
FAGUC98	904,959.2	592,425.8	1,145.5	52.1	W 70	S2	230	11	312
FAGUC99	905,141.0	592,272.4	1,113.8	184.5	W 78	S2	50	11	312
FAGU100	904,958.8	592,425.7	1,148.4	121.9	W 70	S2	230	11	312
FAGU101	905,142.3	592,272.6	1,113.3	175.3	W 78	S2	230	11	312
FAGU102	904,959.7	592,425.9	1,150.0	47.2	W 70	S2	230	11	312
FAGU103	905,142.1	592,272.9	1,113.8	129.5	W 78	S2	230	11	312
FAGU104	904,961.4	592,427.3	1,150.0	31.4	W 70	S2	230	11	312
FAGU105	905,143.2	592,274.5	1,115.1	38.1	W 78	S2	230	11	312
FAGU106	904,962.3	592,428.5	1,146.6	137.1	W 70	S2	230	11	312
FAGU107	905,142.3	592,272.6	1,117.0	70.0	W 78	S2	230	11	312
FAGU108	904,961.6	592,429.0	1,145.6	72.5	W 70	S2	230	11	312
FAGU109	905,142.6	592,274.4	1,117.5	116.7	W 78	S2	230	11	312
FAGU110	905,101.6	592,317.6	1,122.4	90.7	W 76	S2	230	11	312
FAGU111	904,959.2	592,425.8	1,145.5	122.8	W 70	S2	230	11	312
FAGU112	905,100.5	592,316.6	1,122.4	45.7	W 76	S2	230	11	312
FAGU113	904,961.1	592,428.1	1,146.0	102.7	W 70	S2	230	11	312
FAGU114	905,098.9	592,315.4	1,123.6	45.7	W 76	S2	230	11	312
FAGU115	904,959.3	592,427.0	1,145.4	74.0	W 70	S2	230	11	312
FAGU116	905,098.8	592,315.4	1,125.8	68.5	W 76	S2	230	11	312

not logged by CAMC

not logged by CAMC

17 APR 84

GRUP

## DRILL HOLE COLLAR DATA (DHC21)

DDH	UTM-N	UTM-E	UTM-ELEV	TOTAL DEPTH	SECTION	RFE	DIR	PLUNGE	ANGLE
FAGU117	905,040.2	592,343.4	1,133.1	61.0	W 74	S2	230	11	312
FAGU118	905,099.7	592,316.8	1,127.6	76.2	W 76	S2	230	11	312
FAGU119	904,864.0	592,347.5	1,150.0	103.6	W 70	S2	230	11	312
FAGU120	905,102.8	592,318.6	1,123.6	61.0	W 76	S2	230	11	312
FAGU121	904,863.0	592,346.6	1,150.0	65.5	W 70	S2	230	11	312
FAGU122	905,102.7	592,318.5	1,122.4	91.4	W 76	S2	230	11	312
FAGU123	904,865.9	592,349.5	1,150.0	118.9	W 70	S2	230	11	312
FAGU124	905,069.7	592,288.8	1,127.4	91.4	W 76	S2	230	11	312
FAGU125	904,958.6	592,425.8	1,146.0	92.2	W 70	S2	230	11	312
FAGU126	905,068.7	592,288.2	1,127.4	144.8	W 76	S2	230	11	312
FAGU127	904,866.2	592,349.8	1,151.2	45.7	W 70	S2	230	11	312
FAGU128	905,069.5	592,289.1	1,127.4	83.7	W 76	S2	230	11	312
FAGU129	905,055.9	592,276.3	1,127.0	142.3	W 76	S2	230	11	312
FAGU130	905,069.1	592,238.4	1,132.1	45.7	W 76	S2	230	11	312
FAGU131	904,863.0	592,346.8	1,151.2	45.7	W 70	S2	230	11	312
FAGU132	905,102.4	592,318.9	1,127.4	134.1	W 76	S2	230	11	312
FAGU133	904,865.6	592,349.3	1,149.9	126.5	W 70	S2	230	11	312
FAGU134	905,013.2	592,237.1	1,123.5	99.0	W 76	S2	230	11	312
FAGU135	905,182.9	592,228.6	1,103.4	190.5	W 80	S2	230	11	312
FAGU136	904,863.8	592,347.6	1,152.9	76.2	W 70	S2	230	11	312
FAGU137	904,866.3	592,348.2	1,153.4	61.0	W 70	S2	230	11	312
FAGU138	905,012.8	592,237.3	1,123.3	122.2	W 76	S2	230	11	312
FAGU139	904,865.0	592,347.8	1,153.4	76.2	W 70	S2	230	11	312
FAGU140	905,183.0	592,228.7	1,103.4	123.4	W 80	S2	230	11	312
FAGU141	904,787.4	592,442.5	1,167.8	96.2	W 66	S2	230	11	312
FAGU142	905,180.9	592,226.2	1,103.7	152.4	W 80	S2	230	11	312
FAGU143	904,790.7	592,445.9	1,166.9	132.6	W 66	S2	230	11	312
FAGU144	905,183.2	592,229.3	1,106.9	73.2	W 80	S2	230	11	312
FAGU145	904,791.1	592,445.3	1,167.9	121.9	W 66	S2	230	11	312
FAGU146	905,181.9	592,227.9	1,108.1	73.7	W 80	S2	230	11	312
FAGU147	904,788.0	592,443.1	1,170.2	76.2	W 66	S2	230	11	312
FAGU148	905,052.5	592,191.7	1,114.3	68.5	W 78	S2	50	11	312
FAGU149	905,143.1	592,191.8	1,106.3	182.9	W 80	S2	230	11	312
FAGU150	905,082.4	592,136.0	1,105.0	152.4	W 80	S2	230	11	312
FAGU151	905,081.3	592,134.2	1,108.2	76.2	W 80	S2	230	11	312
FAGU152	905,142.7	592,191.5	1,111.0	61.0	W 80	S2	230	11	312
FAGU153	905,081.1	592,134.4	1,105.6	61.0	W 80	S2	230	11	312
FAGU154	905,100.1	592,155.5	1,109.4	61.0	W 80	S2	230	11	312
FAGU155	904,788.5	592,443.3	1,166.8	61.0	W 66	S2	230	11	312
FAGU156	905,100.1	592,155.4	1,105.6	76.2	W 80	S2	230	11	312
FAGU157	904,739.1	592,443.8	1,166.8	132.6	W 66	S2	230	11	312
FAGU158	905,131.9	592,099.0	1,097.7	74.3	W 82	S2	230	11	312
FAGU159	904,789.1	592,445.3	1,170.9	76.2	W 66	S2	230	11	312
FAGU160	905,131.3	592,098.6	1,095.3	73.2	W 82	S2	230	11	312
FAGU161	904,787.2	592,442.6	1,166.8	59.4	W 66	S2	230	11	312
FAGU162	905,131.5	592,099.0	1,094.4	153.9	W 82	S2	230	11	312
FAGU163	904,740.0	592,481.2	1,174.9	112.0	W 64	S2	230	11	312
FAGU164	905,132.6	592,099.6	1,099.2	50.0	W 82	S2	230	11	312
FAGU165	904,740.3	592,481.2	1,174.3	53.3	W 64	S2	230	11	312
FAGU166	905,223.5	592,182.4	1,094.9	182.9	W 82	S2	230	11	312
FAGU167	904,740.3	592,481.4	1,176.9	61.8	W 64	S2	230	11	312

DRILL HOLE COLLAR DATA (DH021)

DDH	UTM-N	UTM-E	UTM-ELEV	TOTAL DEPTH	SECTION	RFE	DIR	PLUNGE	ANGLE
FAGU168	905,221.3	592,182.3	1,094.9	166.5	W 82	S2	230	11	312
FAGU169	904,697.0	592,522.8	1,182.5	45.7	W 62	S2	230	11	312
FAGU170	905,222.9	592,099.4	1,089.2	96.2	W 84	S2	230	11	312
FAGU171	904,693.6	592,519.8	1,182.3	30.5	W 62	S2	230	11	312
FAGU172	905,220.7	592,181.9	1,095.2	121.9	W 82	S2	230	11	312
FAGU173	904,693.9	592,520.2	1,182.2	57.9	W 62	S2	230	11	312
FAGU174	905,223.8	592,182.4	1,098.7	28.0	W 82	S2	230	11	312
FAGU175	904,696.7	592,522.7	1,181.7	58.3	W 62	S2	230	11	312
FAGU176	905,254.8	592,131.7	1,090.1	170.0	W 84	S2	230	11	312
FAGU177	904,696.6	592,522.5	1,184.5	65.5	W 62	S2	230	11	312
FAGU178	905,255.0	592,132.2	1,094.3	79.5	W 84	S2	230	11	312
FAGU179	904,694.7	592,520.5	1,185.1	51.8	W 62	S2	230	11	312
FAGU180	905,222.8	592,099.5	1,093.4	30.5	W 84	S2	230	11	312
FAGU181	904,832.2	592,401.6	1,161.4	68.5	W 68	S2	230	11	312
FAGU182	905,181.6	592,069.5	1,088.2	153.6	W 84	S2	230	11	312
FAGU183	904,832.2	592,401.5	1,160.6	76.2	W 68	S2	230	11	312
FAGU184	905,178.7	592,066.1	1,088.2	167.5	W 84	S2	230	11	312
FAGU185	904,810.7	592,422.4	1,164.8	91.4	W 67	S2	230	11	312
FAGU186	905,180.7	592,007.9	1,092.5	61.0	W 84	S2	230	11	312
FAGU187	904,811.2	592,422.1	1,164.2	91.4	W 67	S2	230	11	312
FAGU188	905,135.0	592,102.4	1,095.6	83.7	W 82	S2	230	11	312
FAGU189	904,814.4	592,425.4	1,164.2	123.4	W 67	S2	230	11	312
FAGU190	905,133.9	592,101.2	1,094.4	106.7	W 82	S2	230	11	312
FAGU191	904,812.5	592,423.8	1,168.3	61.0	W 67	S2	230	11	312
FAGU192	904,991.4	592,259.1	1,129.6	121.9	W 75	S2	230	11	312
FAGU193	904,842.0	592,368.7	1,155.6	76.2	W 69	S2	230	11	312
FAGU194	904,990.8	592,258.4	1,130.9	128.0	W 75	S2	230	11	312
FAGU195	904,845.3	592,372.1	1,155.7	91.4	W 69	S2	230	11	312
FAGU196	904,989.9	592,257.5	1,129.6	129.5	W 75	S2	230	11	312
FAGU197	904,842.8	592,369.5	1,158.2	35.1	W 69	S2	230	11	312
FAGU198	904,912.1	592,165.0	1,162.2	153.9	W 75	S2	230	11	312
FAGU199	904,884.3	592,325.6	1,146.4	132.6	W 71	S2	230	11	312
FAGU200	904,880.6	592,336.5	1,147.6	45.7	W 71	S2	230	11	312
FAGU201	904,926.2	592,329.6	1,142.2	54.9	W 72	S2	230	11	312
FAGU202	904,926.2	592,329.7	1,142.2	45.7	W 72	S2	230	11	312
FAGU203	904,933.5	592,335.2	1,142.2	73.2	W 72	S2	230	11	312
FAGU204	904,976.7	592,409.3	1,144.2	36.6	W 71	S2	230	11	312
FAGU205	904,979.7	592,410.2	1,144.9	106.7	W 71	S2	230	11	312
FAGU206	904,975.9	592,409.7	1,149.0	106.7	W 71	S2	230	11	312
FAGU207	905,019.5	592,366.3	1,139.8	45.7	W 73	S2	230	11	312
FAGU208	905,018.6	592,365.9	1,138.7	140.1	W 73	S2	230	11	312
FAGU209	905,018.4	592,365.0	1,138.6	99.0	W 73	S2	230	11	312
FAGU210	905,017.3	592,363.7	1,138.5	120.4	W 73	S2	230	11	312
FAGU211	904,949.4	592,302.5	1,138.9	114.3	W 73	S2	230	11	312
FAGU212	904,950.4	592,303.1	1,138.9	70.2	W 73	S2	230	11	312
FAGU213	904,951.3	592,304.3	1,138.9	121.9	W 73	S2	230	11	312
FAGU214	905,067.8	592,328.3	1,128.5	30.5	W 75	S2	230	11	312
FAGU215	905,066.4	592,327.0	1,127.3	138.6	W 75	S2	230	11	312
FAGU216	905,065.5	592,324.6	1,127.4	138.6	W 75	S2	230	11	312
FAGU217	904,910.8	592,163.4	1,162.2	123.6	W 76	S2	230	11	312
FAGU218	905,156.6	592,071.3	1,089.9	45.7	W 83	S2	230	11	312

→ not logged by CAMC  
 → not logged by CAMC  
 → not logged by CAMC

DRILLHOLE	DEPTH(METRES)	ZENITH(DEG)	AZIMUTH(DEG)
4567506	.0	180.0	.0
	61.0	175.5	32.0
	121.9	166.0	93.0
			Calculated from FAGA 092
4567507	.0	180.0	.0
	61.0	175.5	32.0
	121.9	166.0	93.0
	182.9	160.0	85.0
	262.1	155.0	83.0
			Calculated from FAGA 092
4567509	.0	180.0	.0
	182.9	174.0	138.0
	304.8	167.0	135.0
	524.3	177.0	142.0
			Acid Azimuths from FAGA 064
EA65T01	.0	180.0	.0
EA65T02	.0	180.0	.0
EA65T03	.0	180.0	.0
EA65T04	.0	180.0	.0
EA71034	.0	180.0	.0
EA71035	.0	180.0	.0
EA71036	.0	180.0	.0
EA71037	.0	180.0	.0
EA71040	.0	180.0	.0
EA71162	.0	180.0	.0
EA71163	.0	180.0	.0
EA71165	.0	180.0	.0
EA71166	.0	180.0	.0
EA71167	.0	180.0	.0
EA71168	.0	180.0	.0
EA71169	.0	180.0	.0
EA71173	.0	180.0	.0
EA71174	.0	180.0	.0

DRILLHOLE	DEPTH(METRES)	ZENITH(DEG)	AZIMUTH(DEG)
EA71179	.0	180.0	.0
EA71180	.0	180.0	.0
EA71200	.0	180.0	.0
EA71201	.0	180.0	.0
EA76X11	.0	180.0	.0
	22.3	178.8	99.0
	113.7	171.8	58.0
	189.9	165.0	55.0
	266.1	160.8	50.0
	342.3	161.0	55.0
	418.5	164.0	60.0
	498.7	157.5	38.0
	574.9	157.3	40.0
	651.1	158.8	41.0
	727.3	158.2	43.0
EA79T01	.0	180.0	.0
FA80C51	.0	180.0	.0
FA80C52	.0	180.0	.0
FA80C53	.0	180.0	.0
FA80C54	.0	180.0	.0
FA80C55	.0	180.0	.0
FA80C56	.0	180.0	.0
FA80C57	.0	180.0	.0
FA80C58	.0	180.0	.0
FA80C59	.0	180.0	.0
FA8CC60	.0	180.0	.0
FA80C61	.0	180.0	.0
FA80C62	.0	180.0	.0
FA81AX1	.0	180.0	.0
	68.9	166.0	28.0
	117.6	174.2	58.0
	178.6	170.0	61.0
	239.6	172.5	54.0

Sperry Sun

Sperry Sun

DRILLHOLE	DEPTH(METRES)	ZENITH(DEG)	AZIMUTH(DEG)	
FA81AX1	300.5	170.0	35.0	
FAGA001	.0	180.0	.0	
	64.0	180.0	.0	
	91.4	176.8	84.0	Calculated from FAGA 004
	152.4	173.5	37.0	
	213.4	174.5	43.0	
	259.1	173.2	321.0	
FAGA004	.0	180.0	.0	
	64.0	180.0	.0	
	91.4	176.8	84.0	Sperry Sun
	152.4	173.5	37.0	
	213.4	174.5	43.0	
	259.1	173.2	321.0	
FAGA005	.0	180.0	.0	
	48.5	179.0	85.0	
	69.8	179.0	36.0	Calculated from FAGA 053 & FAGA 004
	83.5	177.9	88.0	
	107.9	176.9	69.8	
	138.4	175.3	46.3	
FAGA006	.0	180.0	.0	
	61.6	177.3	144.6	Calculated from FAGA 080
	122.5	176.0	129.5	
FAGA008	.0	180.0	.0	
	61.0	173.5	128.0	
	152.4	167.5	133.5	Calculated from FAGA 093 & FAGA 124
	189.0	164.9	139.0	
FAGA009	.0	180.0	.0	
	61.0	175.9	137.0	
	121.9	170.2	123.0	Sperry Sun
	182.9	168.8	114.0	
	219.5	170.0	93.0	
FAGA010	.0	180.0	.0	
	61.0	175.2	69.0	
	121.9	172.8	78.0	Sperry Sun
	182.9	174.5	74.0	
	243.8	177.8	140.0	
FAGA011	.0	180.0	.0	
	61.0	175.3	67.0	
	121.9	172.2	74.0	Sperry Sun
	182.9	171.7	53.0	
	237.7	170.0	83.0	
FAGA012	.0	180.0	.0	

DRILLHOLE	DEPTH(METRES)	ZENITH(DEG)	AZIMUTH(DEG)	
FAGA012	61.0	173.4	124.0	
	121.9	171.3	108.0	
	182.9	171.0	100.0	Calculated from FAGA 022 & FAGA 113
	234.7	167.1	108.5	
	289.6	169.4	123.5	
	344.4	171.4	148.5	
FAGA013	.0	180.0	.0	
	48.8	176.8	54.0	Sperry Sun
	109.7	170.8	88.0	
	164.6	167.6	93.0	
FAGA014	.0	180.0	.0	
	64.0	180.0	.0	
	91.4	176.8	84.0	Calculated from FAGA 004
	152.4	173.5	37.0	
	213.4	174.5	43.0	
	259.1	173.2	321.0	
FAGA015	.0	180.0	.0	
	61.0	174.1	122.0	Calculated from FAGA 127
	121.9	165.8	135.0	
	182.9	162.1	162.0	
	243.8	163.0	173.0	
FAGA016	.0	180.0	.0	
	61.0	175.0	140.0	Calculated from Z FAGA 064 & FAGA 127
	121.9	168.4	144.0	
	182.9	162.7	150.0	
	243.8	158.0	159.0	
	304.5	161.5	146.5	
FAGA017	.0	180.0	.0	
	61.6	175.0	111.5	Calculated from FAGA 074
	122.5	172.0	71.9	
	183.5	168.0	60.5	
	244.5	163.0	59.5	
FAGA018	.0	180.0	.0	
	30.5	174.6	113.0	
	91.4	171.0	98.0	
	213.4	167.9	138.0	Sperry Sun
	274.3	167.0	135.0	
	329.2	164.7	123.0	
	438.9	167.0	95.0	
FAGA019	.0	180.0	.0	
	70.2	176.9	118.5	Calculated from FAGA 060 & FAGA 021
	97.6	174.9	98.9	
	154.7	172.4	98.0	
	200.5	173.0	118.0	

DRILLHOLE	DEPTH(METRES)	ZENITH(DEG)	AZIMUTH(DEG)	
FAGA019	212.6	172.5	112.0	
FAGA020	.0	180.0	.0	
	30.5	179.0	65.0	
	91.4	180.0	.0	
	152.4	172.0	66.5	Sperry Sun
	225.6	174.0	119.0	
	286.5	170.0	52.0	
	365.8	172.0	68.5	
FAGA021	.0	180.0	.0	
	61.0	178.7	158.0	Sperry Sun
	115.8	174.8	118.0	
	207.3	175.9	158.0	
FAGA022	.0	180.0	.0	
	61.0	172.4	118.0	
	121.9	171.6	103.0	Sperry Sun
	182.9	171.0	102.0	
	243.8	166.3	104.0	
	353.6	170.2	154.0	
FAGA023	.0	180.0	.0	
	51.8	178.0	283.0	Sperry Sun
	91.4	179.7	133.0	
	146.3	179.2	113.0	
FAGA024	.0	180.0	.0	
	61.0	175.0	54.0	
	121.9	174.3	88.0	Sperry Sun
	182.9	172.0	65.0	
	256.0	176.8	78.0	
FAGA025	.0	180.0	.0	
	61.0	174.1	122.0	
	121.9	165.8	135.0	
	182.9	162.1	162.0	Calculated from FAGA 127
	243.8	163.0	173.0	
	304.8	167.0	158.0	
FAGA026	.0	180.0	.0	
	121.9	179.0	72.0	
	207.3	177.0	81.0	Tropari
	243.8	178.0	92.0	
	273.4	178.0	92.0	
FAGA027	.0	180.0	.0	
	61.0	176.0	113.0	
	121.9	172.5	84.0	Sperry Sun
	182.9	174.0	96.0	
	243.8	174.7	134.0	

DRILLHOLE	DEPTH (METRES)	ZENITH (DEG)	AZIMUTH (DEG)
FAGA027	303.9	172.0	223.C
FAGA028	.0	180.0	.C
	85.3	175.4	49.C
	115.8	176.0	95.0
	195.1	166.0	86.C
	243.8	165.0	74.C
FAGA029	.0	180.0	.C
	61.0	175.9	158.0
	121.9	171.0	153.0
	182.9	163.2	138.0
	243.8	153.0	145.C
	304.8	156.0	135.C
	350.5	161.3	142.2
FAGA030	.0	180.0	.C
	61.0	171.2	123.0
	121.9	166.1	111.C
	182.9	171.9	97.C
	262.1	174.0	122.C
FAGA031	.0	180.0	.C
	61.0	176.3	112.5
	118.9	168.4	65.0
	170.7	164.5	61.5
FAGA032	.0	180.0	.C
	61.0	176.0	45.C
	121.9	177.0	103.0
	182.9	178.0	48.0
	243.8	174.6	64.C
	353.6	176.4	94.C
FAGA033	.0	180.0	.C
	61.0	178.5	96.5
	121.9	172.5	59.0
	176.8	170.3	54.3
FAGA034	.0	180.0	.C
	61.0	175.9	158.C
	121.9	171.0	153.0
	182.9	163.2	138.0
	243.8	153.0	145.0
FAGA035	.0	180.0	.C
	61.0	176.0	45.C
	121.9	177.0	103.0
	182.9	178.0	43.0
	243.8	174.6	64.C
	353.6	176.4	94.0

Sperry Sun

Calculated from FAGA 064

Sperry Sun

Calculated from FAGA 110 &amp; FAGA 119

Sperry Sun

Calculated from FAGA 110 &amp; FAGA 108

Calculated from FAGA 064

Calculated from FAGA 032

DRILLHOLE	DEPTH(METRES)	ZENITH(DEG)	AZIMUTH(DEG)
FAGA037	.0	180.0	.0
	61.0	179.0	40.0
	121.9	176.0	51.0
			Calculated from FAGA 108
FAGA038	.0	180.0	.0
	61.0	176.0	45.0
	121.9	177.0	103.0
	182.9	178.0	43.0
	243.8	174.6	64.0
	353.6	176.4	94.0
FAGA039	.0	180.0	.0
	61.0	179.5	40.0
	115.8	175.5	53.0
	170.7	174.5	44.5
	195.1	171.5	27.3
FAGA041	.0	180.0	.0
	61.0	176.0	45.0
	121.9	177.0	103.0
	182.9	178.0	43.0
	243.8	174.6	64.0
	353.6	176.4	94.0
FAGA042	.0	180.0	.0
	61.0	179.5	40.0
	115.8	175.5	53.0
FAGA045	.0	180.0	.0
	61.0	179.0	33.0
	121.9	176.0	61.0
	195.1	176.8	93.0
			Sperry Sun
FAGA046	.0	180.0	.0
	61.0	179.5	40.0
FAGA049	.0	180.0	.0
	61.0	179.5	40.0
			Calculated from FAGA 108 & FAGA 114
FAGA050	.0	180.0	.0
	61.0	179.5	40.0
	115.8	175.5	53.0
	170.7	174.5	44.5
	195.1	171.5	27.3
FAGA051	.0	180.0	.0
	61.0	173.7	87.0
	91.4	173.3	77.5
	152.4	171.3	101.0
	182.9	172.5	95.0
	243.8	169.3	104.0
	329.2	169.4	128.5
			Calculated from FAGA 022 & FAGA 115

DRILLHOLE	DEPTH(METRES)	ZENITH(DEG)	AZIMUTH(DEG)
FAGA051	359.7	169.4	127.5
FAGA052	.0	180.0	.C
	61.0	179.5	33.C
	121.9	175.7	68.C
	182.9	169.0	84.C
	237.7	164.0	83.C
FAGA053	.0	180.0	.C
	32.9	178.0	85.0
	75.6	179.0	92.C
	124.4	177.0	55.5
FAGA054	.0	180.0	.0
	61.0	179.5	40.0
	115.8	175.5	53.3
FAGA055	.0	180.0	.0
	61.0	173.9	68.0
	121.9	168.0	63.C
	195.1	165.5	58.C
FAGA056	.0	180.0	.C
	61.0	179.8	165.C
	121.9	171.5	128.0
	182.9	171.0	116.C
	243.8	173.0	163.0
FAGA057	.0	180.0	.C
	61.0	175.9	158.0
	121.9	171.0	153.C
	182.9	163.2	138.0
	243.8	153.0	145.C
	304.8	156.0	135.0
	350.5	161.3	142.2
FAGA058	.0	180.0	.C
	73.2	177.0	53.C
	121.9	173.0	54.0
	170.7	169.0	54.C
FAGA059	.0	180.0	.C
	61.0	175.0	92.C
	121.9	174.0	101.C
	182.9	172.0	113.C
	243.8	165.5	103.C
	304.8	167.0	135.C
	365.8	170.0	173.C
FAGA060	.0	180.0	.C
	79.2	175.0	79.C

Sperry Sun

Troparl

Calculated from FAGA 108 &amp; FAGA 114

Sperry Sun

Sperry Sun

Calculated from FAGA 064

Troparl

Sperry Sun

Troparl

DRILLHOLE	DEPTH(METRES)	ZENITH(CEG)	AZIMUTH(CEG)	
FAGA06C	126.5	172.0	76.0	Tropari
	193.5	170.0	78.0	
	217.9	169.0	66.0	
FAGA061	.0	180.0	.0	Calculated from FAGA 059 & FAGA 123
	45.7	173.5	105.0	
	76.2	173.0	100.5	
	106.7	172.5	105.0	
	137.2	173.6	115.5	
	167.6	172.6	121.5	
	198.1	172.2	107.5	
	228.6	168.9	102.5	
	259.1	169.4	105.5	
FAGA062	.0	180.0	.0	Sperry Sun
	61.0	176.5	122.0	
	121.9	170.0	106.0	
	182.9	169.0	114.0	
	225.6	163.0	101.0	
FAGA063	.0	180.0	.0	Calculated from FAGA 108 & FAGA 105 & FAGA 110
	61.0	178.3	128.7	
	121.9	174.6	72.0	
	176.8	173.2	55.8	
FAGA064	.0	180.0	.0	Sperry Sun
	61.0	175.9	158.0	
	121.9	171.0	153.0	
	182.9	163.2	138.0	
	243.8	153.0	145.0	
	304.8	156.0	135.0	
	350.5	161.3	142.2	
FAGA065	.0	180.0	.0	Tropari
	167.6	175.0	157.0	
FAGA066	.0	180.0	.0	Tropari
	57.9	178.0	110.3	
	115.8	178.0	94.0	
	176.8	170.0	103.6	
FAGA067	.0	180.0	.0	Tropari
	122.5	176.0	340.8	
	244.4	175.0	96.8	
	378.6	175.0	103.6	
FAGA068	.0	180.0	.0	Tropari
	121.9	167.0	117.0	
	237.7	173.5	107.5	
	389.2	173.0	120.0	

DRILLHOLE	DEPTH(METRES)	ZENITH(DEG)	AZIMUTH(DEG)	
FAGA069	.0	180.0	.0	Tropari
	122.5	172.0	133.8	
	244.5	176.0	133.6	
	366.4	175.0	173.0	
FAGA070	.0	180.0	.0	Tropari
	49.1	176.0	123.0	
	103.9	174.0	143.9	
FAGA071	.0	180.0	.0	Tropari
	86.0	167.0	102.3	
	168.2	171.0	102.5	
FAGA072	.0	180.0	.0	Tropari
	92.0	172.0	97.5	
	177.4	170.5	106.5	
FAGA073	.0	180.0	.0	Tropari
	64.6	179.0	102.0	
	122.5	180.0	91.5	
	183.5	163.0	95.5	
	244.4	161.0	106.5	
305.4	159.0	99.9		
FAGA074	.0	180.0	.0	Tropari
	61.6	175.0	111.5	
	122.5	172.0	71.9	
	183.5	168.0	60.5	
	244.5	163.0	59.5	
FAGA075	.0	180.0	.0	Tropari
	61.6	178.0	280.5	
	134.7	177.0	70.2	
	201.8	175.0	14.0	
	262.7	173.0	37.5	
	323.7	170.0	81.5	
FAGA076	.0	180.0	.0	Tropari
	61.6	179.0	130.5	
	122.5	174.0	138.5	
	183.5	169.7	146.4	
	244.5	179.0	142.5	
	305.4	173.0	154.4	
	387.7	173.0	136.5	
FAGA077	.0	180.0	.0	Tropari
	52.4	177.0	69.5	
	104.2	173.0	78.8	
	165.2	169.0	72.5	
	226.2	169.0	71.6	
	287.1	167.0	72.9	

DRILLHOLE	DEPTH(METRES)	ZENITH(DEG)	AZIMUTH(DEG)	
FAGA078	.0	180.0	.0	
	61.6	179.0	107.0	
	122.5	170.5	122.5	Tropari
	183.5	163.0	118.7	
	244.4	160.0	114.8	
	299.3	159.5	28.0	
FAGA079	.0	180.0	.0	
	61.0	179.0	166.6	
	121.9	177.0	140.3	
	182.9	175.0	137.6	Tropari
	243.8	176.0	146.5	
	378.0	171.0	106.4	
FAGA080	.0	180.0	.0	
	61.6	177.3	144.6	
	122.5	176.0	129.5	Tropari
	183.5	161.6	128.8	
	244.4	158.8	119.8	
	305.4	154.6	110.5	
FAGA081	.0	180.0	.0	
	65.8	175.0	23.0	
	126.8	170.0	61.0	Sperry Sun
	187.8	169.2	77.0	
	248.7	169.0	67.0	
FAGA082	.0	180.0	.0	
	61.6	175.0	149.5	
	122.5	169.0	147.0	
	183.5	166.0	148.5	
	238.4	167.0	133.5	Tropari
	293.2	168.0	119.5	
	360.3	167.0	120.5	
FAGA083	.0	180.0	.0	
	53.6	176.6	114.0	
	120.1	170.2	113.0	
	181.1	166.2	105.0	Sperry Sun
	242.0	168.0	85.0	
	303.0	169.0	67.0	
	357.8	168.4	18.0	
FAGA084	.0	180.0	.0	
	85.3	175.0	94.5	
	146.3	172.0	120.5	
	207.3	175.0	112.5	Tropari
	268.2	175.0	80.5	
	329.2	175.0	76.0	
	396.2	179.0	39.0	

DRILLHOLE	DEPTH(METRES)	ZENITH(DEG)	AZIMUTH(DEG)
FAGA085	.0	180.0	.C
	61.0	177.5	79.C
	121.9	174.0	107.C
	182.9	173.0	106.C
	243.8	173.2	138.0
	304.8	172.2	183.C
	384.0	172.4	183.C
	402.3	172.2	183.0
FAGA086	.0	180.0	.G
	36.6	179.0	238.0
	97.5	179.0	289.5
	182.9	171.0	130.0
	243.8	165.0	156.5
	304.8	161.0	142.5
	384.0	166.0	133.5
	426.7	164.0	141.5
506.0	161.0	139.5	
FAGA087	.0	180.0	.C
	121.9	171.4	133.C
	176.8	170.0	138.C
	243.8	173.0	129.C
	304.5	172.2	155.C
	353.6	171.0	158.0
FAGA088	.0	180.0	.C
	61.0	179.0	120.5
	121.9	176.0	49.5
	182.9	177.5	123.0
	256.0	173.0	55.C
	317.0	169.0	106.C
FAGA089	.0	180.0	.0
	61.0	180.0	.0
	109.7	176.0	99.5
	189.0	175.0	214.5
FAGA090	.0	180.0	.C
	61.0	179.0	60.5
	121.9	169.0	110.5
	182.9	162.0	92.C
	243.8	165.0	93.5
	304.8	159.0	79.5
FAGA091	.0	180.0	.C
	30.5	177.4	73.C
	91.4	176.0	83.C
	213.4	171.0	85.C
	335.3	168.0	113.0
	396.2	166.0	105.0

Sperry Sun

Tropari

Sperry Sun

Tropari

Tropary

Tropary

Sperry Sun

DRILLHOLE	DEPTH (METRES)	ZENITH (DEG)	AZIMUTH (DEG)
FAGA091	518.2	173.0	60.C
FAGA092	.0	180.0	.0
	61.0	175.5	32.C
	121.9	166.0	93.0
	182.9	160.0	85.0
	262.1	155.0	83.0
FAGA093	.0	180.0	.0
	61.0	175.0	113.C
	121.9	169.0	113.0
	195.1	163.8	124.0
	262.1	162.8	117.C
	335.3	168.0	58.0
FAGA094	.0	180.0	.0
	30.5	177.0	73.0
	91.4	173.5	83.0
	152.4	173.0	98.C
	213.4	171.0	87.0
	274.3	173.0	193.0
FAGA095	.0	180.0	.C
	73.2	178.0	83.0
	134.1	165.7	104.C
	195.1	159.2	88.0
FAGA096	.0	180.0	.0
	58.1	176.0	36.5
	112.9	173.5	103.0
FAGA097	.0	180.0	.0
FAGA098	.0	180.0	.C
	24.4	179.0	358.0
	61.0	176.6	2.C
	121.9	176.0	303.C
FAGA099	.0	180.0	.0
	61.0	175.0	73.C
	115.8	165.0	77.0
	176.8	162.0	76.0
FAGA10C	.0	180.0	.0
	67.1	176.0	310.C
	121.9	173.0	62.0
	182.9	163.0	82.0
	225.6	161.0	78.0
FAGA101	.0	180.0	.C
	61.0	176.0	18.0

Sperry Sun

Sperry Sun

Sperry Sun

Sperry Sun

Calculated from FAGA 070 &amp; FAGA 100

Sperry Sun

Sperry Sun

Sperry Sun

Sperry Sun

DRILLHOLE	DEPTH(METRES)	ZENITH(DEG)	AZIMUTH(DEG)
FAGA101	121.9	171.0	52.C
	213.4	174.0	41.C Sperry Sun
	256.0	175.2	17.C
FAGA102	.0	180.0	.0
	67.1	175.0	73.C
	128.0	166.8	68.0 Sperry Sun
	170.7	169.8	56.C
FAGA103	.0	180.0	.0
	51.8	177.4	288.0
	112.8	173.3	78.0 Sperry Sun
	182.9	171.3	73.0
FAGA104	.0	180.0	.C
	61.0	172.4	144.C
	121.9	172.5	128.C
	182.9	170.8	133.C
	262.1	167.0	143.C Sperry Sun
	323.1	169.6	153.0
	396.2	166.0	146.C
FAGA105	.0	180.0	.C
	61.0	178.0	193.0
	121.9	179.0	98.C Tropary
	182.9	176.0	66.C
FAGA106	.0	180.0	.0
	97.5	174.0	75.0 Sperry Sun
	170.7	168.7	77.C
FAGA107	.0	180.0	.0
	73.2	179.0	288.0
	128.0	177.5	48.C Sperry Sun
	207.3	166.0	44.0
FAGA108	.0	180.0	.C
	61.0	179.0	40.0 Tropary
	121.9	176.0	51.C
	170.7	176.0	48.5
FAGA109	.0	180.0	.0
	61.0	179.0	270.0
	121.9	173.0	34.0 Sperry Sun
	182.9	170.2	355.0
FAGA110	.0	180.0	.0
	61.0	178.0	153.C
	121.9	169.0	67.C Sperry Sun
	182.9	164.5	60.0

DRILLHOLE	DEPTH(METRES)	ZENITH(DEG)	AZIMUTH(DEG)
FAGA111	.0	180.0	.0
	61.0	174.0	293.0
	121.9	175.0	31.0
	243.8	172.0	66.0
	365.8	175.0	92.0
			Sperry Sun
FAGA112	.0	180.0	.0
	85.3	178.0	327.0
	164.6	170.0	348.0
			Sperry Sun
FAGA113	.0	180.0	.0
	61.0	174.3	126.0
	121.9	171.0	113.0
	182.9	171.0	98.0
	225.6	167.8	113.0
	335.3	172.5	143.0
	378.0	170.0	166.0
	457.2	172.6	135.0
			Sperry Sun
FAGA114	.0	180.0	.0
	61.0	180.0	.0
	109.7	175.0	55.5
	170.7	173.0	40.5
	219.5	170.0	14.0
			Tropary
FAGA115	.0	180.0	.0
	61.0	175.0	52.0
	182.9	174.0	88.0
	243.8	172.2	104.0
	304.8	168.5	103.0
	365.8	168.5	101.0
			Sperry Sun
FAGA116	.0	180.0	.0
	73.2	178.0	58.0
	146.3	168.0	53.0
			Sperry Sun
FAGA117	.0	180.0	.0
	61.0	172.8	45.0
	121.9	172.0	43.0
	161.5	170.2	42.0
			Sperry Sun
FAGA118	.0	180.0	.0
	61.0	169.9	124.0
	182.9	167.5	121.0
	243.8	168.5	135.0
	335.3	168.0	146.0
	396.2	167.7	145.0
	426.7	167.0	145.0
			Sperry Sun
FAGA119	.0	180.0	.0
	61.0	174.5	72.0
			Sperry Sun

DRILLHOLE	DEPTH(METRES)	ZENITH(DEG)	AZIMUTH(DEG)	
FAGA119	115.8	167.7	63.C	Sperry Sun
	158.5	164.5	63.0	
FAGA120	.0	180.0	.C	Sperry Sun
	61.0	174.5	127.C	
	121.9	172.8	131.C	
	182.9	173.5	153.0	
	243.8	171.5	148.C	
	304.8	168.0	138.0	
FAGA121	.0	180.0	.0	Sperry Sun
	61.0	175.9	95.0	
	134.1	173.2	83.0	
	207.3	170.0	91.0	
	249.9	167.0	98.C	
FAGA122	.0	180.0	.C	Sperry Sun
	61.0	176.0	94.0	
	91.4	174.8	88.C	
	152.4	173.5	78.C	
	228.6	167.3	73.0	
FAGA123	.0	180.0	.0	Sperry Sun
	30.5	172.0	118.0	
	91.4	171.0	109.0	
	152.4	173.2	130.0	
	213.4	172.3	102.0	
	274.3	173.3	108.0	
	378.0	165.2	145.C	
FAGA124	.0	180.0	.0	Sperry Sun
	61.0	171.9	143.0	
	121.9	169.8	135.C	
	182.9	166.0	154.C	
	243.8	168.2	157.C	
	304.8	165.0	149.0	
	365.8	165.2	131.C	
FAGA125	.0	180.0	.0	Sperry Sun
	61.0	173.0	112.0	
	121.9	172.0	118.0	
	182.9	171.1	149.0	
	243.8	168.5	161.0	
	335.3	166.0	160.0	
FAGA126	.0	180.0	.C	Calculated from FAGA 128
	121.9	176.0	56.C	
FAGA127	.0	180.0	.C	Sperry Sun
	61.0	174.0	122.0	

DRILLHOLE	DEPTH(METRES)	ZENITH(DEG)	AZIMUTH(DEG)
FAGA127	121.9	165.8	135.0
	182.9	162.1	162.0
	243.8	163.0	173.0
	304.8	167.0	158.0
	365.8	167.3	147.0
FAGA128	.0	180.0	.0
	121.9	178.0	56.0
	182.9	170.8	101.0
	243.8	170.0	102.0
	304.8	165.4	105.0
365.8	164.2	90.0	
FAGA129	.0	180.0	.0
	103.6	176.0	209.0
	149.4	175.8	191.0
FAGA130	.0	180.0	.0
	64.1	174.8	72.5
Calculated from FAGA 119 & FAGA 102			
FAGA131	.0	180.0	.0
	91.4	177.0	42.0
	165.5	172.0	62.0
FAGA132	.0	180.0	.0
	91.4	178.0	153.0
	143.3	175.0	124.0
FAGA133	.0	180.0	.0
	67.1	176.0	310.0
	121.9	173.0	62.0
Calculated from FAGA 100			
FAGA134	.0	180.0	.0
	135.6	175.9	69.0
Sperry Sun			
FAGA135	.0	180.0	.0
	67.0	177.0	32.0
	155.4	167.7	83.0
Sperry Sun			
FAGA136	.0	180.0	.0
	73.2	177.0	53.0
	121.9	173.0	54.0
Calculated from FAGA 058			
FAGA137	.0	180.0	.0
	68.9	176.2	2.5
	136.2	167.2	26.5
Calculated from FAGA 112 & FAGA 139			
FAGA138	.0	180.0	.0
	67.1	176.0	310.0
Calculated from FAGA 100			
FAGA139	.0	180.0	.0

DRILLHOLE	DEPTH(METRES)	ZENITH(DEG)	AZIMUTH(DEG)	
FAGA139	52.4 113.4	174.3 166.4	38.0 65.C	Sperry Sun
FAGA14C	.0 84.7 145.7	180.0 171.7 164.0	.0 124.C 124.C	Sperry Sun
FAGA141	.0 61.0	180.0 177.3	.0 46.3	Calculated from FAGA 090 & FAGA 092
FAGA142	.0 88.4 149.4 189.0 231.7	180.0 177.0 174.7 174.0 170.0	.C 90.C 88.0 102.C 74.0	Sperry Sun
FAGA143	.0 76.2 137.2	180.0 173.0 163.5	.0 64.C 73.0	Sperry Sun
FAGA144	.0 61.0 121.9	180.0 174.1 165.8	.0 122.0 135.0	Calculated from FAGA 127
FAGA145	.0 55.2	180.0 175.9	.0 82.8	Calculated from FAGA 013 & FAGA 074
FAGA146	.0 61.0 121.9	180.0 174.1 165.8	.0 122.0 135.0	Calculated from FAGA 127
FAGA147	.0 107.3 151.2	180.0 174.8 172.0	.0 70.0 79.0	Sperry Sun
FAGA148	.0 61.0	180.0 174.1	.0 122.0	Calculated from FAGA 127
FAGA149	.0 67.1 112.8 160.0 190.5	180.0 176.8 171.5 171.0 169.0	.C 63.0 58.0 53.0 58.C	Sperry Sun
FAGA15C	.0 61.0 121.9	180.0 174.1 165.8	.0 122.C 135.0	Calculated from FAGA 127
FAGA151	.0 61.0 121.9	180.0 174.1 165.8	.0 122.C 135.C	Calculated from FAGA 127

DRILLHOLE	DEPTH(METRES)	ZENITH(DEG)	AZIMUTH(DEG)
FAGA152	.0 70.1 154.8	180.0 176.5 169.5	.0 52.0 91.0
			Sperry Sun
FAGA153	.0 82.3 164.6	180.0 168.0 177.0	80.0 82.0 32.0
			Sperry Sun
FAGA154	.0 61.0 121.9	180.0 171.9 169.8	.0 143.0 135.0
			Calculated from FAGA 124
FAGA155	.0 64.6	180.0 179.0	.0 102.0
			Calculated from FAGA 073
FAGA156	.0 121.9	180.0 176.0	.0 120.0
			Sperry Sun
FAGA157	.0 61.0 121.9	180.0 177.2 175.9	.0 123.0 83.0
			Sperry Sun
FAGA158	.0 114.0	180.0 174.2	.0 92.0
			Sperry Sun
FAGA159	.0 68.9 114.6 137.2	180.0 171.0 169.0 164.0	.0 106.3 87.5 108.0
			Calculated from FAGA 208 & FAGA 074
FAGA160	.0 61.3 122.2	180.0 179.0 175.5	.0 148.6 139.4
			Calculated from FAGA 076 & FAGA 079
FAGA161	.0 24.4 42.7 93.6	141.0 143.0 140.8 143.0	44.0 47.0 45.0 54.0
			Sperry Sun
FAGA162	.0 95.1	180.0 173.0	.0 41.0
			Sperry Sun
FAGA163	.0 82.9	180.0 174.2	.0 104.0
			Sperry Sun
FAGA164	.0 82.9	180.0 174.2	.0 104.0
			Calculated from FAGA 163
FAGA20C	.0 66.4 96.9	180.0 175.9 174.8	353.0 353.0 23.0
			Sperry Sun

DRILLHOLE	DEPTH(METRES)	ZENITH(DEG)	AZIMUTH(DEG)	
FAGA20C	127.4	174.0	34.0	
	157.9	173.5	63.0	
	188.4	172.5	94.0	
	218.8	171.5	80.0	Sperry Sun
	249.3	168.5	75.0	
	279.8	167.5	81.0	
FAGA201	.0	180.0	.0	
	83.2	179.0	213.0	
	113.7	177.8	251.0	
	144.2	177.2	130.0	Sperry Sun
	174.6	174.5	105.0	
	205.1	173.9	98.0	
235.6	173.8	63.0		
FAGA202	.0	180.0	.0	
	68.0	177.8	53.0	
	98.5	174.2	80.0	
	128.9	171.2	68.0	
	159.4	169.7	65.0	
	189.9	168.8	61.0	Sperry Sun
	220.4	167.8	57.0	
	250.8	167.0	56.0	
281.3	168.0	51.0		
FAGA203	.0	180.0	.0	
	62.2	178.0	48.0	
	92.7	177.5	59.0	
	123.1	176.0	73.0	
	153.6	175.5	59.0	Sperry Sun
	184.1	172.5	76.0	
	214.6	170.5	70.0	
	245.1	170.0	90.0	
275.5	167.0	63.0		
FAGA204	.0	180.0	.0	
	66.8	178.5	113.0	
	97.2	176.0	87.0	
	127.7	172.0	81.0	
	158.2	172.0	73.0	Sperry Sun
	188.7	172.0	67.0	
	219.1	172.5	55.0	
249.6	172.5	54.0		
FAGA205	.0	180.0	.0	
	65.8	178.0	336.0	
	96.3	177.5	1.0	Sperry Sun
	245.3	173.0	123.0	
	278.9	172.0	133.0	
FAGA206	.0	180.0	.0	

DRILLHOLE	DEPTH(METRES)	ZENITH(DEG)	AZIMUTH(DEG)
FAGA206	71.0	175.5	77.0
	101.5	175.5	85.0
	132.0	175.0	90.0
	162.5	172.7	90.0
	192.9	171.0	86.0
	223.4	169.5	90.0
	253.9	168.0	83.0
	284.4	166.0	88.0
	314.8	166.0	85.0
FAGA207	.0	180.0	.0
	70.1	175.0	65.0
	100.6	174.0	78.0
	131.1	173.0	187.0
FAGA208	.0	180.0	.0
	76.2	167.0	101.0
	106.7	166.0	103.0
	137.2	164.0	108.0
	167.6	162.0	110.0
	198.1	162.0	89.0
FAGA209	.0	180.0	.0
	75.9	177.3	100.0
	106.4	175.5	97.0
	136.9	173.0	93.0
	167.3	172.0	80.0
	197.8	173.0	51.0
FAGA210	228.3	172.5	33.0
	.0	180.0	.0
	61.0	177.5	11.0
	100.6	178.0	61.0
FAGA211	.0	180.0	.0
	61.9	176.0	32.0
	98.5	176.0	48.0
	125.9	174.0	63.0
	162.5	174.0	53.0
	189.9	172.0	53.0
	226.5	170.5	55.0
	253.9	170.0	49.0
FAGA212	.0	180.0	.0
	62.2	177.0	42.0
	92.7	177.0	40.0
	123.1	176.5	63.0
	153.6	175.0	67.0
	184.1	173.0	61.0
	214.6	170.5	72.0
	245.1	167.0	76.0

DRILLHOLE	DEPTH(METRES)	ZENITH(DEG)	AZIMUTH(DEG)
FAGA212	275.5	165.0	75.0
	306.0	164.0	75.C Sperry Sun
FAGA213	.0	180.0	.0
	53.6	178.0	5.0
	84.1	176.0	60.0
	114.6	175.0	65.0
	145.1	175.0	70.0
	177.7	171.5	62.0 Sperry Sun
	208.2	170.0	64.0
	238.7	169.0	65.C
	269.1	165.5	78.0
302.7	167.5	72.C	
FAGA214	.0	180.0	.0
	69.5	176.0	203.0
	120.4	171.0	111.0
	181.4	168.5	117.C
	242.3	165.0	110.5 Sperry Sun
	303.3	163.0	124.0
	364.2	162.0	119.C
	425.2	161.0	110.C
	486.2	160.0	111.0
FAGA215	.0	180.0	.0
	64.9	174.5	123.0
	144.2	169.5	105.C
	205.1	167.5	105.0 Sperry Sun
	266.1	167.0	103.0
	327.1	164.5	93.0
	388.9	163.5	89.C
FAGA216	.0	180.0	.0
	61.0	176.5	70.0
	121.9	173.5	57.C Sperry Sun
	304.8	167.5	75.0
	365.8	167.0	87.0
	426.7	168.0	66.C
FAGA217	.0	180.0	.0
	93.9	178.0	259.0 Sperry Sun
	121.3	177.5	259.0
	182.3	174.0	10.C
FAGA218	.0	180.0	.0
	99.0	169.5	48.0 Sperry Sun
	117.3	169.5	58.0
FAGA219	.0	180.0	.0
	80.5	177.5	23.0 Sperry Sun
	125.9	173.5	36.0

DRILLHOLE	DEPTH(METRES)	ZENITH(DEG)	AZIMUTH(DEG)	
FAGA219	186.8	170.0	55.0	
	247.8	168.5	15.0	
FAGA22C	.0	180.0	.0	
	67.4	175.5	30.0	
	103.6	173.0	55.0	
	164.6	170.5	58.0	Sperry Sun
	225.5	166.5	57.0	
	286.5	164.0	30.0	
FAGA221	.0	180.0	.0	
	54.9	179.0	68.0	
	103.6	177.0	96.0	
	161.5	175.8	57.0	Sperry Sun
	225.5	170.2	33.0	
	286.5	167.5	46.0	
FAGA222	.0	180.0	.0	
	65.8	175.5	114.5	
	102.4	176.0	60.0	
	163.4	172.8	78.0	Sperry Sun
	224.3	169.5	86.0	
	285.3	168.0	58.0	
FAGA223	.0	180.0	.0	
	53.0	177.5	24.0	
	74.4	175.5	64.0	
	135.3	173.0	48.0	Sperry Sun
	196.3	171.0	68.0	
	257.3	166.5	46.0	
FAGA224	.0	161.0	43.0	
	37.2	161.0	43.0	
	51.8	161.0	54.0	Sperry Sun
	88.4	162.0	61.0	
	149.3	162.0	59.0	
	210.3	162.0	41.0	
FAGA225	.0	180.0	.0	
	90.8	175.5	88.0	
	151.8	173.0	93.0	Sperry Sun
	212.7	171.0	57.0	
FAGA226	.0	180.0	.0	
	56.1	178.0	105.0	
	117.0	174.2	73.0	Sperry Sun
	178.0	170.0	77.0	
FAGA227	.0	180.0	.0	
	19.2	179.0	303.0	Sperry Sun
	74.1	178.0	133.0	

DRILLHOLE	DEPTH(METRES)	ZENITH(CEG)	AZIMUTH(CEG)
FAGA227	135.0	177.8	143.0
	196.0	175.0	133.0 Sperry Sun
FAGA228	.0	180.0	.C
	67.7	175.5	149.0
	128.7	171.5	141.0 Sperry Sun
	189.6	169.0	127.0
FAGA229	.0	180.0	.0
	50.0	177.0	130.0
	100.0	170.0	130.0 Sperry Sun
	150.0	167.0	130.0
FAGA230	.0	180.0	.0
	16.5	177.5	123.0
	34.7	176.0	139.0 Sperry Sun
	95.7	172.2	128.0
	156.7	170.5	127.0
	217.6	164.2	141.0
FAGA231	.0	180.0	.0
	16.2	178.2	65.0
	58.8	177.0	123.0
	119.8	168.0	129.0 Sperry Sun
	180.7	165.0	123.0
FAGA232	.0	180.0	.0
	18.9	177.5	128.0
	76.8	169.0	135.0 Sperry Sun
	137.8	165.5	133.0
	198.7	165.0	140.0
FAGA233	.0	180.0	.0
	13.1	179.5	123.0
	71.0	173.0	147.0 Sperry Sun
	132.0	170.0	148.0
	192.9	168.5	146.0
FAGA234	.0	180.0	.0
	36.9	177.0	143.0 Sperry Sun
	97.8	164.5	129.0
	158.8	161.0	113.0
FAGA235	.0	180.0	.0
	49.4	176.0	128.0
	71.6	174.0	128.0 Sperry Sun
	171.3	170.5	136.0
FAGA236	.0	180.0	.0
	24.7	176.0	123.0 Sperry Sun
	67.4	169.5	128.0

DRILLHOLE	DEPTH(METRES)	ZENITH(DEG)	AZIMUTH(DEG)
FAGA236	128.3	169.0	127.C
	189.3	165.0	120.C
	250.2	168.0	133.C Sperry Sun
	311.2	169.0	122.C
	372.2	167.5	111.C
	433.1	166.5	104.C
FAGA237	.0	180.0	.C
	26.5	176.5	113.0 Sperry Sun
	87.5	174.0	124.0
	148.4	169.5	138.C
	209.4	168.5	139.C
FAGA238	.0	180.0	.0
	39.6	178.0	85.0 Sperry Sun
	79.2	175.0	123.0
	125.0	172.0	119.C
FAGA239	.0	180.0	.0
	55.8	174.3	112.0 Sperry Sun
	101.5	171.3	112.0
FAGA240	.0	180.0	.0
	45.7	175.0	91.0 Sperry Sun
	103.6	172.2	122.C
FAGA241	.0	180.0	.C
	48.8	174.0	340.0
	94.5	175.0	16.0 Sperry Sun
	155.4	171.5	61.0
FAGADL1	.0	180.0	.0
FAGADL2	.0	160.0	230.0
FAGADL3	.0	180.0	.0
FAGADL4	.0	180.0	.0
FAGU001	.0	87.0	110.1
FAGU002	.0	86.8	56.3
FAGU003	.0	53.0	225.1
FAGU004	.0	17.9	235.8
FAGU005	.0	180.0	.C
	65.5	180.0	.C Sperry Sun
FAGU006	.0	8.3	45.0

DRILLHOLE	DEPTH(METRES)	ZENITH(DEG)	AZIMUTH(CEG)	
FAGU007	.0	150.0	44.0	
FAGU008	.0	14.4	218.4	
FAGU009	.0	145.0	44.0	
FAGU010	.0	10.4	233.6	
FAGU011	.0	131.4	26.2	
FAGU012	.0	160.0	43.8	
FAGU013	.0 152.4	173.0 171.3	43.8 43.0	Sperry Sun
FAGU014	.0	30.9	233.1	
FAGU015	.0 91.4 182.9	150.0 158.0 164.0	44.0 43.0 65.0	Sperry Sun
FAGU016	.0	125.3	46.0	
FAGU017	.0	150.0	43.8	
FAGU018	.0	136.0	44.0	
FAGU019	.0	59.0	223.8	
FAGU020	.0	170.0	223.8	
FAGU021	.0	41.4	227.0	
FAGU022	.0	137.0	227.0	
FAGU023	.0	158.0	47.0	
FAGU024	.0	55.5	47.4	
FAGU025	.0	56.0	47.4	
FAGU026	.0	21.0	235.3	
FAGU027	.0	28.1	48.4	
FAGU028	.0	129.2	48.7	
FAGU029	.0	103.8	46.2	
FAGU030	.0	46.6	51.8	

DRILLHOLE	DEPTH(METRES)	ZENITH(DEG)	AZIMUTH(DEG)	
FAGU031	.0	105.8	92.6	
	8.5	106.3	77.0	Sperry Sun
	61.0	114.0	120.0	
FAGU032	.0	162.8	222.6	
	33.5	169.0	218.0	Sperry Sun
	67.1	172.0	226.0	
	97.5	175.0	253.0	
FAGU033	.0	45.0	224.0	
FAGU034	.0	176.3	153.2	
FAGU035	.0	153.4	57.6	
	61.0	165.8	44.0	Sperry Sun
	108.2	168.4	60.0	
FAGU036	.0	82.3	138.7	
FAGU037	.0	80.8	95.4	
FAGU038	.0	80.3	105.7	
FAGU039	.0	163.3	230.4	
	30.5	165.0	243.0	Sperry Sun
	56.4	165.0	241.0	
FAGU040	.0	143.8	225.3	
	45.7	149.0	235.0	Sperry Sun
	91.4	149.1	251.0	
FAGU041	.0	136.3	44.4	
	30.5	136.0	69.0	
	61.0	139.0	62.0	Sperry Sun
	89.9	142.0	33.0	
FAGU042	.0	21.7	45.5	
FAGU043	.0	.8	206.6	
FAGU044	.0	29.2	236.0	
FAGU045	.0	170.0	44.0	
FAGU046	.0	140.0	44.0	
FAGU047	.0	170.0	224.0	
FAGU048	.0	145.6	214.6	
	76.2	152.5	203.0	Sperry Sun
	118.9	158.5	209.0	

DRILLHOLE	DEPTH(METRES)	ZENITH(DEG)	AZIMUTH(CEG)	
FAGU049	.0	89.2	222.7	
FAGU050	.0	89.4	189.0	
FAGU051	.0	42.0	224.0	
FAGU052	.0	24.8	229.4	
FAGU053	.0	7.1	255.0	
FAGU054	.0	30.2	33.2	
	30.5	28.0	35.0	
	61.5	26.2	34.0	Sperry Sun
	91.5	21.8	22.0	
	122.0	18.0	8.0	
FAGU055	.0	62.9	233.7	
FAGU056	.0	62.0	223.7	
FAGU057	.0	118.2	220.3	
FAGU058	.0	88.3	223.7	
	76.2	92.0	230.0	Sperry Sun
	106.7	92.0	228.0	
FAGU059	.0	135.4	227.1	
	30.5	137.3	230.0	
	61.0	137.0	231.0	Sperry Sun
	91.4	147.5	239.0	
	121.9	152.4	243.0	
FAGU060	.0	180.0	.0	
FAGU061	.0	160.0	224.0	
	45.7	162.8	232.0	Sperry Sun
	91.4	169.0	232.0	
	120.3	171.5	232.0	
FAGU062	.0	111.0	222.3	
	30.5	114.2	224.0	
	61.0	121.0	232.0	Sperry Sun
	100.6	125.0	224.0	
FAGU063	.0	57.5	222.2	
FAGU064	.0	26.2	221.4	
FAGU065	.0	1.8	339.3	
FAGU066	.0	67.1	176.4	

DRILLHOLE	DEPTH(METRES)	ZENITH(DEG)	AZIMUTH(CEG)	
FAGU067	.0	89.1	225.5	
FAGU068	.0	57.1	223.4	
FAGU069	.0	29.9	226.9	
FAGU070	.0	4.2	14.1	
FAGU071	.0	25.0	41.7	
FAGU072	.0	146.2	224.2	
	45.7	161.5	224.C	Sperry Sun
	112.8	172.0	224.C	
FAGU073	.0	88.7	196.3	
FAGU074	.0	81.6	149.8	
	45.7	87.0	149.C	Sperry Sun
	76.2	88.7	149.0	
	106.7	91.0	149.C	
FAGU075	.0	165.4	39.7	
	61.0	174.0	18.0	
	106.7	176.0	308.C	Sperry Sun
	152.4	175.9	234.0	
FAGU076	.0	84.3	171.3	
FAGU077	.0	145.6	41.7	
	30.5	149.8	44.0	
	61.0	158.0	41.C	Sperry Sun
	96.0	162.0	34.0	
	166.1	174.0	71.0	
FAGU078	.0	81.2	135.8	
	45.7	85.8	137.0	
	76.2	88.0	136.0	Sperry Sun
	106.7	90.0	134.C	
FAGU079	.0	119.8	218.4	
	45.7	124.8	228.0	
	96.0	131.0	229.0	Sperry Sun
FAGU080	.0	79.9	154.8	
FAGU081	.0	180.0	.C	
FAGU082	.0	80.4	186.1	
FAGU083	.0	.0	.C	

DRILLHOLE	DEPTH(METRES)	ZENITH(DEG)	AZIMUTH(DEG)
FAGU084	.0	145.1	49.4
FAGU085	.0	24.9	227.0
FAGU086	.0 94.5	121.2 136.8	41.2 49.0 Sperry Sun
FAGU087	.0	143.1	223.7
FAGU088	.0	180.0	.0
FAGU089	.0	35.7	201.4
FAGU090	.0	151.9	38.9
FAGU091	.0 96.0	98.4 89.0	230.4 232.0 Sperry Sun
FAGU092	.0	89.9	221.5
FAGU093	.0	59.5	225.7
FAGU094	.0	87.0	347.5
FAGU095	.0 61.0 106.7	139.6 145.9 150.0	224.9 228.0 Sperry Sun 227.0
FAGU096	.0 83.8 120.4	70.6 72.5 75.0	223.3 226.0 Sperry Sun 229.0
FAGU097	.0	121.0	219.0
FAGU098	.0	156.7	216.0
FAGU099	.0 61.0 106.7 152.4 182.9	150.3 158.0 163.0 165.8 169.0	217.3 221.0 224.0 Sperry Sun 223.0 214.0
FAGU100	.0 61.0 120.4	54.9 57.0 53.2	222.5 224.0 Sperry Sun 234.0
FAGU101	.0 160.0	175.0 170.0	44.0 103.0 Sperry Sun

DRILLHOLE	DEPTH(METRES)	ZENITH(DEG)	AZIMUTH(CEG)
FAGU102	.0	24.6	222.7
FAGU103	.0	136.7	42.3
	61.0	149.8	57.0
	99.1	151.5	61.0
	129.5	153.0	68.0
FAGU104	.0	26.5	43.3
FAGU105	.0	90.8	43.3
FAGU106	.0	89.8	44.4
	111.3	91.0	46.0
FAGU107	.0	.0	.0
FAGU108	.0	121.0	44.5
FAGU109	.0	36.3	38.7
	35.0	32.0	34.0
	65.5	28.0	32.0
	96.0	25.0	32.0
FAGU110	.0	180.0	.0
FAGU111	.0	180.0	.0
	45.7	179.0	223.0
	91.4	176.8	123.0
	122.8	173.0	123.0
FAGU112	.0	149.4	220.3
FAGU113	.0	148.0	44.0
FAGU114	.0	89.5	222.1
FAGU115	.0	155.3	226.0
FAGU116	.0	45.1	225.1
FAGU117	.0	90.0	44.0
FAGU118	.0	15.5	248.4
FAGU119	.0	180.0	.0
	103.6	178.0	54.0
FAGU120	.0	90.2	40.1
FAGU121	.0	150.0	224.0

Sperry Sun

Sperry Sun

Sperry Sun

Sperry Sun

Sperry Sun

DRILLHOLE	DEPTH(METRES)	ZENITH(DEG)	AZIMUTH(DEG)	
FAGU122	.0	145.0	44.0	
FAGU123	.0	135.0	44.0	
FAGU124	.0	180.0	.0	
FAGU125	.0	120.1	227.6	
FAGU126	.0	150.0	224.0	
	112.8	158.0	228.0	Sperry Sun
	144.8	158.0	227.0	
FAGU127	.0	88.5	45.8	
FAGU128	.0	150.0	44.0	
FAGU129	.0	145.0	224.0	
	79.9	151.0	227.0	
	110.3	152.5	227.0	Sperry Sun
	140.8	154.0	228.0	
FAGU130	.0	5.3	250.8	
FAGU131	.0	90.9	225.5	
FAGU132	.0	27.0	44.0	
FAGU133	.0	150.0	44.0	
	103.6	155.0	55.0	Sperry Sun
FAGU134	.0	118.8	42.2	
FAGU135	.0	175.0	44.0	
	89.9	173.0	114.0	
	137.2	173.0	112.0	Sperry Sun
	182.9	172.0	125.0	
FAGU136	.0	42.0	224.0	
FAGU137	.0	26.0	43.9	
FAGU138	.0	138.9	47.3	
	45.7	142.2	43.0	
	91.4	149.0	42.0	Sperry Sun
	121.9	152.0	44.0	
FAGU139	.0	15.0	224.0	
FAGU140	.0	148.8	50.2	
FAGU141	.0	89.7	227.1	

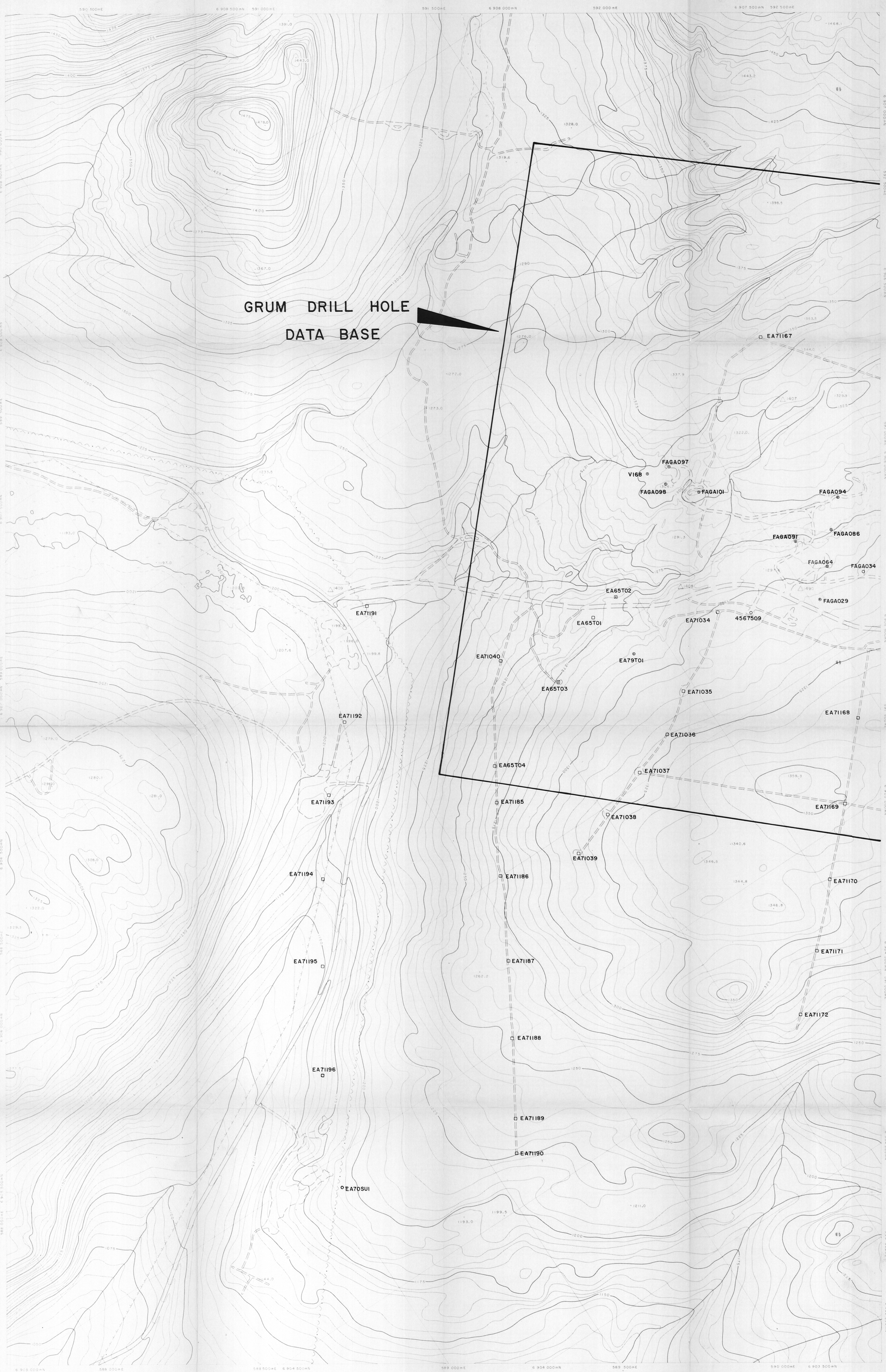
DRILLHOLE	DEPTH(METRES)	ZENITH(DEG)	AZIMUTH(DEG)
FAGU141	42.7 94.5	91.0 90.0	234.0 239.0 Sperry Sun
FAGU142	.0 56.4 140.2	119.6 122.0 136.0	223.0 226.0 Sperry Sun 221.0
FAGU143	.0 67.1 121.9	115.0 124.0 134.0	44.0 48.0 Sperry Sun 55.0
FAGU144	.0	39.8	45.1
FAGU145	.0 45.7 91.4	155.0 157.5 162.0	44.0 59.0 Sperry Sun 68.0
FAGU146	.0	1.4	224.0
FAGU147	.0	43.9	229.2
FAGU148	.0	126.4	47.4
FAGU149	.0 106.7 152.4	180.0 174.0 173.0	.0 198.0 Sperry Sun 193.0
FAGU150	.0 61.0 121.9	163.5 165.5 174.5	218.3 217.0 Sperry Sun 203.0
FAGU151	.0	47.0	224.0
FAGU152	.0	2.6	141.3
FAGU153	.0	107.2	223.4
FAGU154	.0	7.5	200.2
FAGU155	.0	146.0	224.0
FAGU156	.0	180.0	.0
FAGU157	.0 56.4 117.4	180.0 174.0 169.5	.0 108.0 Sperry Sun 80.0
FAGU158	.0	45.0	224.0
FAGU159	.0	23.1	32.4

DRILLHOLE	DEPTH(METRES)	ZENITH( DEG)	AZIMUTH( DEG)	
FAGL160	.0	105.0	224.0	
FAGU161	.0	121.9	225.1	
FAGU162	.0	155.0	224.0	
	38.1	158.0	228.0	
	77.5	161.0	216.0	Sperry Sun
	123.4	166.0	193.0	
FAGL163	.0	91.0	224.1	
	61.0	90.0	229.0	Sperry Sun
FAGU164	.0	18.0	224.0	
FAGU165	.0	128.6	226.1	
FAGU166	.0	180.0	.0	
	62.5	174.0	218.0	
	108.2	173.0	193.0	Sperry Sun
	152.4	173.5	150.0	
FAGU167	.0	47.1	224.4	
FAGU168	.0	150.0	224.0	
	68.6	161.0	211.0	
	100.6	164.0	204.0	Sperry Sun
	131.1	165.0	193.0	
	161.5	166.5	179.0	
FAGU169	.0	90.2	44.0	
FAGU170	.0	178.6	7.6	
FAGU171	.0	89.7	223.0	
FAGU172	.0	114.0	224.0	
	45.7	118.0	222.0	Sperry Sun
	91.4	130.5	219.0	
FAGL173	.0	143.0	224.0	
FAGU174	.0	.0	.0	
FAGU175	.0	125.2	42.5	
FAGU176	.0	160.0	224.0	
	76.2	162.0	205.0	Sperry Sun
	152.4	160.0	183.0	
FAGU177	.0	47.6	51.7	

DRILLHOLE	DEPTH(METRES)	ZENITH(CEG)	AZIMUTH(CEG)	
FAGU178	.0	13.2	56.3	
FAGU179	.0	36.7	224.9	
FAGU180	.0	2.7	332.2	
FAGU181	.0	87.0	224.0	
FAGU182	.0 88.1 149.1	180.0 172.0 171.0	.0 203.0 223.0	Sperry Sun
FAGU183	.0	119.9	229.6	
FAGU184	.0 103.6 164.6	145.0 152.0 161.0	224.0 209.0 200.0	Sperry Sun
FAGU185	.0	88.4	222.3	
FAGU186	.0	17.5	228.3	
FAGU187	.0	125.6	224.5	
FAGU188	.0	90.4	43.1	
FAGU189	.0	133.9	51.5	
FAGU190	.0 73.2 103.6	160.0 171.0 175.0	44.0 73.0 109.0	Sperry Sun
FAGU191	.0	1.5	256.4	
FAGU192	.0 118.9	158.5 171.0	52.9 46.0	Sperry Sun
FAGU193	.0	88.3	226.2	
FAGU194	.0 61.0 118.9	175.8 175.0 176.0	132.5 273.0 255.0	Sperry Sun
FAGU195	.0	88.3	49.0	
FAGU196	.0 61.0 100.6	153.7 163.0 165.0	216.7 230.0 247.0	Sperry Sun
FAGU197	.0	49.7	233.4	

DRILLHOLE	DEPTH(METRES)	ZENITH(DEG)	AZIMUTH(DEG)	
FAGU198	.0	147.0	32.0	
	10.7	146.0	34.0	
	56.4	150.0	34.0	Sperry Sun
	102.1	156.0	34.0	
	150.9	161.0	24.0	
FAGU199	.0	89.3	228.3	
	67.1	90.0	228.3	Sperry Sun
	125.0	91.0	228.3	
FAGU200	.0	89.3	44.2	
FAGU201	.0	90.5	163.7	
FAGU202	.0	90.4	122.4	
FAGU203	.0	90.6	81.5	
FAGU204	.0	180.0	.0	
FAGU205	.0	88.7	41.4	
	82.3	96.0	42.0	Sperry Sun
FAGU206	.0	2.6	162.0	
FAGU207	.0	90.0	49.0	
FAGU208	.0	160.7	62.1	
	65.5	164.0	62.0	Sperry Sun
	126.5	161.0	67.0	
FAGU209	.0	179.0	156.0	
	88.4	176.0	3.0	Sperry Sun
FAGU210	.0	157.0	220.9	
	109.1	167.0	217.0	Sperry Sun
FAGU211	.0	154.0	222.0	
	62.5	155.0	222.0	Sperry Sun
	108.2	161.0	218.0	
FAGU212	.0	175.8	58.1	
FAGU213	.0	155.0	46.0	
	73.2	158.0	43.0	Sperry Sun
	118.9	163.0	63.0	
FAGU214	.0	91.7	50.7	
FAGU215	.0	155.2	64.3	
	89.9	161.0	57.0	Sperry Sun

DRILLHOLE	DEPTH(METRES)	ZENITH(DEG)	AZIMUTH(DEG)	
FAGU215	135.6	165.0	33.0	
FAGU216	.0	171.4	225.4	
	61.0	172.5	206.0	Sperry Sun
	121.9	172.5	155.0	
FAGU217	.0	172.0	244.0	
	12.2	172.0	288.0	Sperry Sun
	73.2	177.0	.0	
	118.9	178.2	83.0	
FAGU218	.0	113.1	231.4	



**GRUM DRILL HOLE  
DATA BASE**

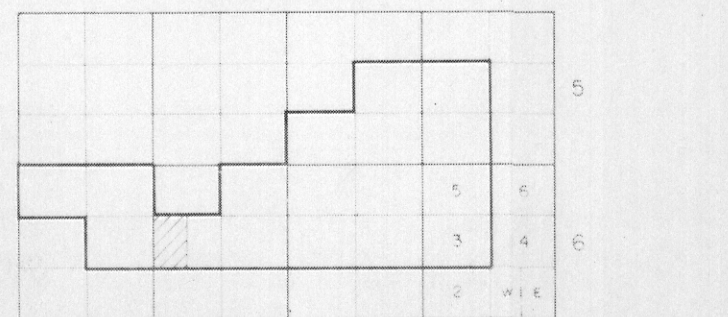
CYPRUS ANVIL MINING CORPORATION

**ANVIL AREA**

Scale 1:5000  
Contour Interval 5 Metres

- ◉ Diamond Drill Hole
  - ◐ Rotary Drill Hole
- located in field
- ◉ Diamond Drill Hole
  - ◐ Rotary Drill Hole
- not located in field

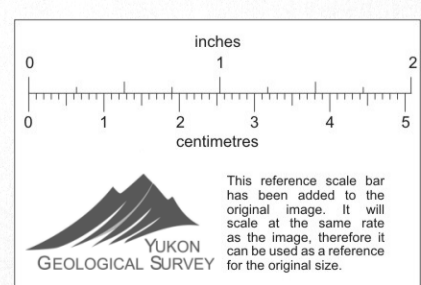
NORTH WEST SURVEY CORPORATION INTERNATIONAL LTD.  
SHEET INDEX

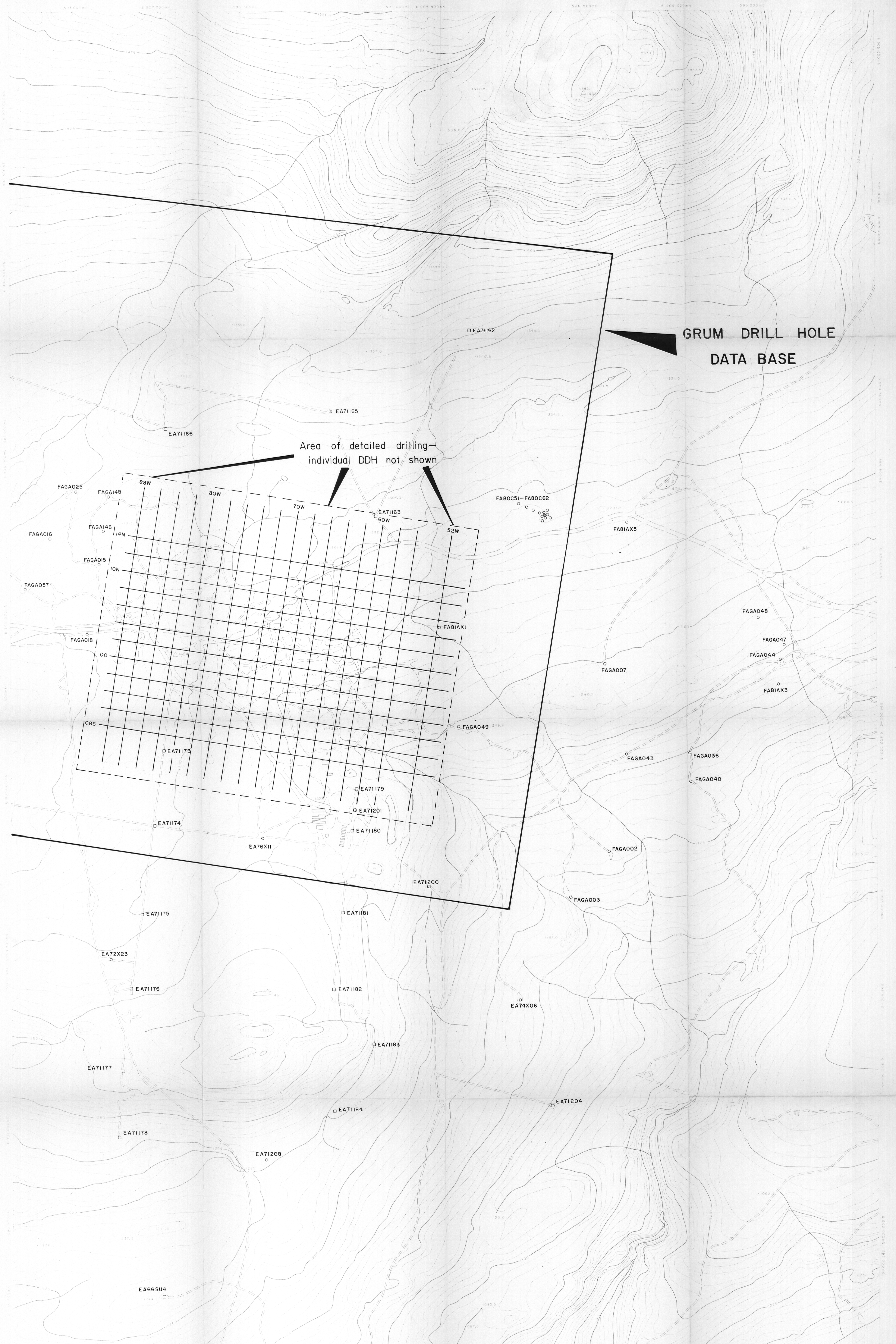


**Figure 1** May 1984

Orthophoto map compiled from aerial photography taken in August, 1979 by North West Survey Corporation International Ltd.  
Coordinates shown are U.T.M. coordinates based on Clarke's Spheroid of 1866 and are computed for Zone 3.  
Elevations shown are Geodetic elevations based on the North American Datum, 1927.  
Horizontal and vertical control survey was performed by Hosford, Impney, Welter & Associates Ltd. and North West Survey Corporation (Yukon) Ltd. in the summer of 1979 for Cyprus Anvil Mining Corporation and is included in a report of the same date.  
Any conflict between contour numbers and planimetric detail is due to planimetric detail being added at a later date.

Sheet No. F-6-3 (W 1/2)





**GRUM DRILL HOLE  
DATA BASE**

Area of detailed drilling -  
individual DDH not shown

CYPRUS ANVIL MINING CORPORATION

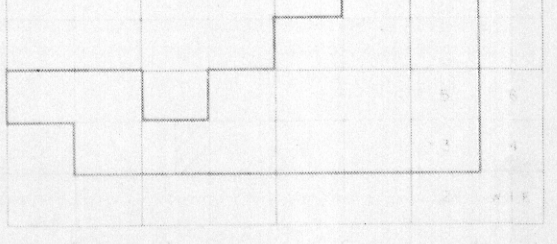
**ANVIL AREA**

Scale 1:5000  
Contour Interval 5 Metres

- ◻ Diamond Drill Hole
  - ◻ Rotary Drill Hole
- located in field
- ◻ Diamond Drill Hole
  - ◻ Rotary Drill Hole
- not located in field

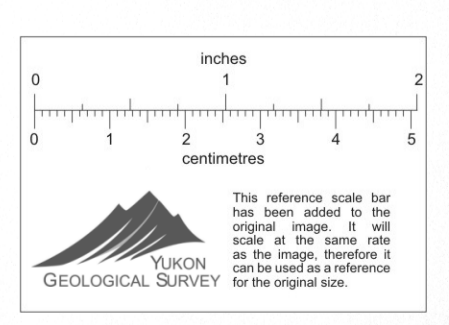
NORTH WEST SURVEY CORPORATION INTERNATIONAL LTD.

SHEET INDEX



Orthophoto map compiled from aerial photography taken in August, 1979 by North West Survey Corporation International Ltd. Coordinates shown are U.T.M. coordinates based on Clarke's Spheroid of 1866 and are computed for Zone 8. Elevations shown are Geodetic elevations based on the North American Datum, 1927. Horizontal and vertical control survey was performed by Hosford, Impey, Weller & Associates Ltd. and North West Survey Corporation (Yukon) Ltd. in the summer of 1979 for Cyprus Anvil Mining Corporation and is included in a report of the same date. Any conflict between contour numbers and planimetric detail is due to planimetric detail being added at a later date.

Sheet No. F-6-3 (E 1/2)



**Figure 2**

May 1984