

E-300-1000-002

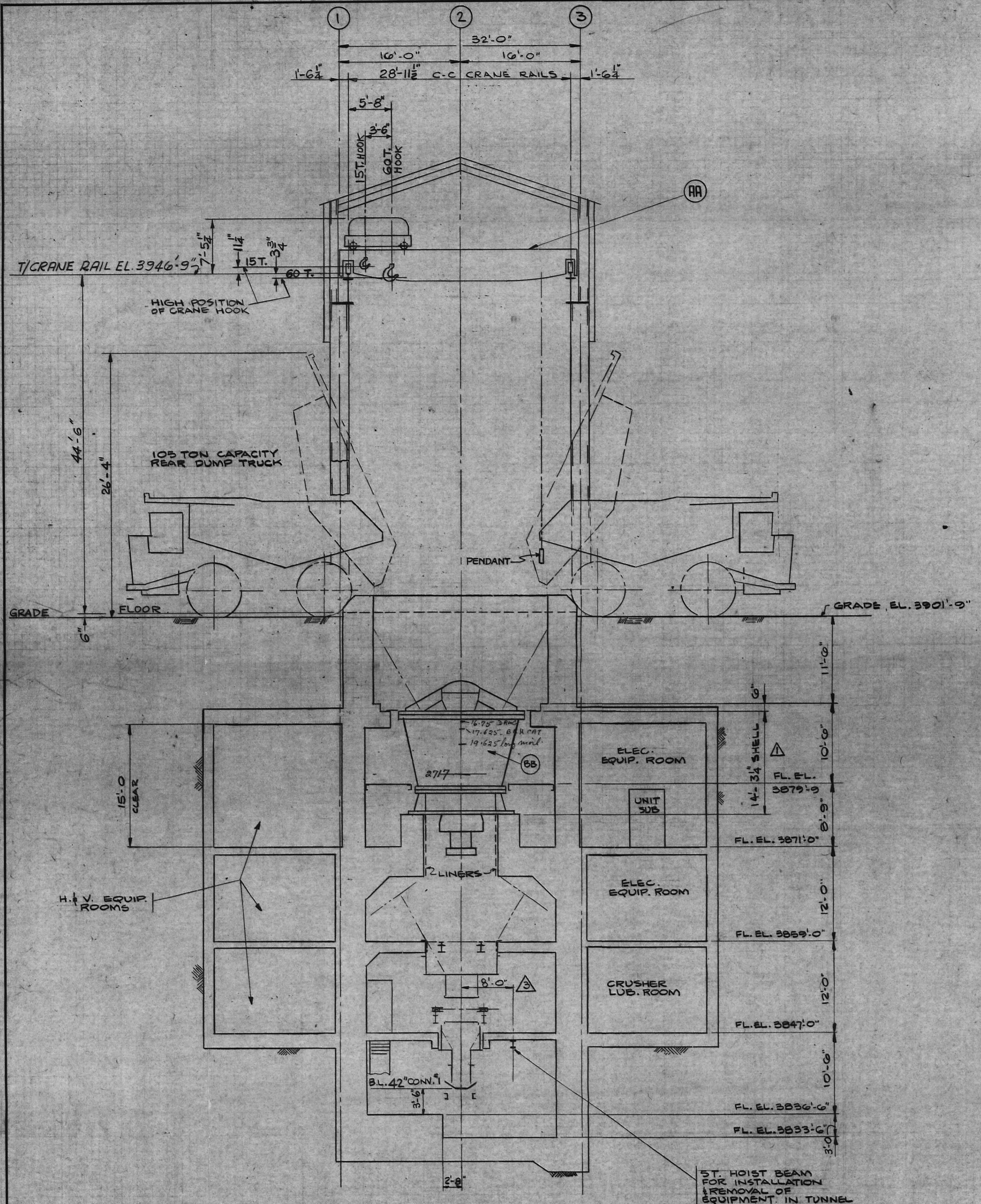

SECTION A-A
LOOKING NORTH
DWG. 300-1001

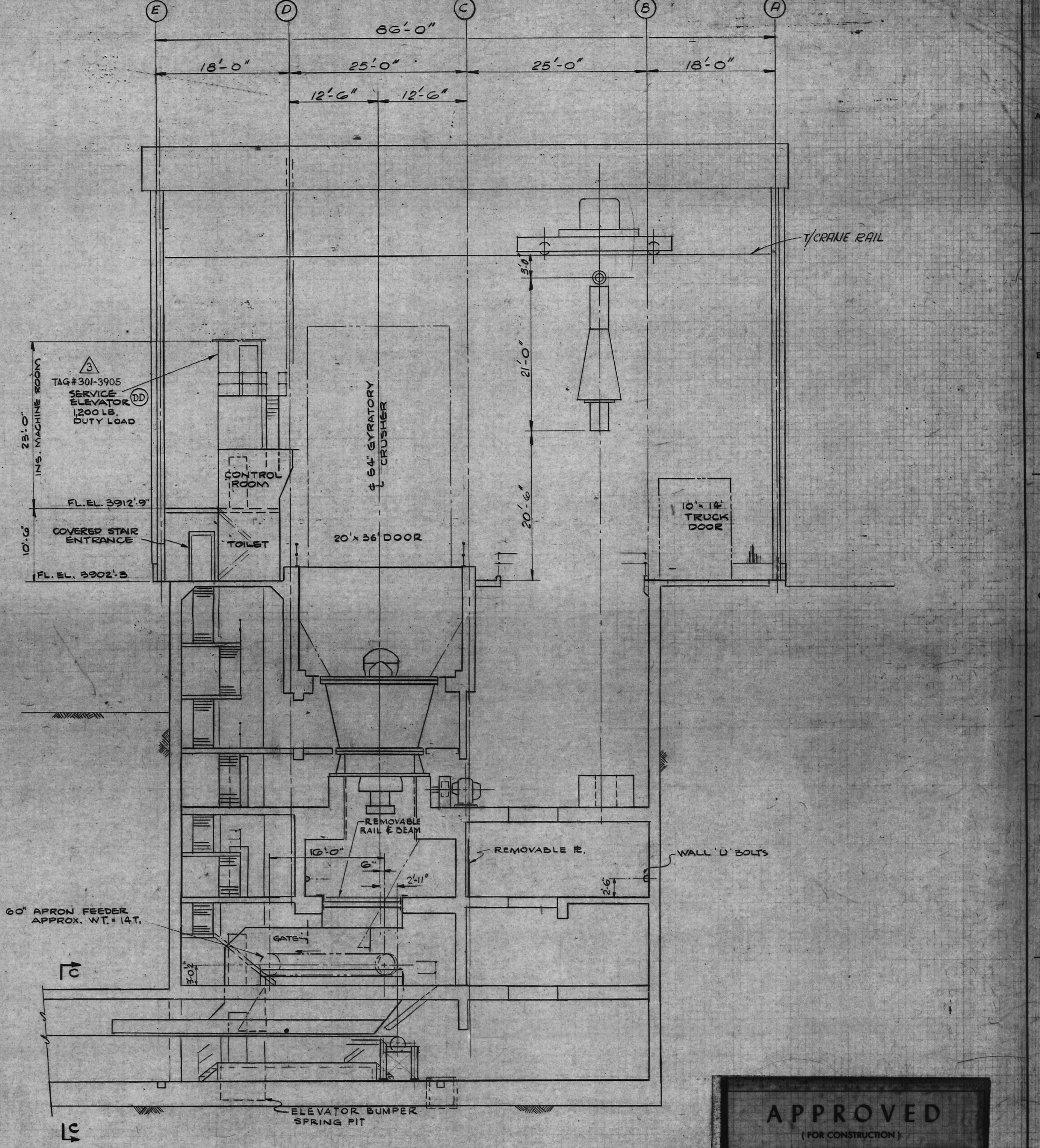

SECTION B-B
LOOKING WEST
DWG. 300-1001

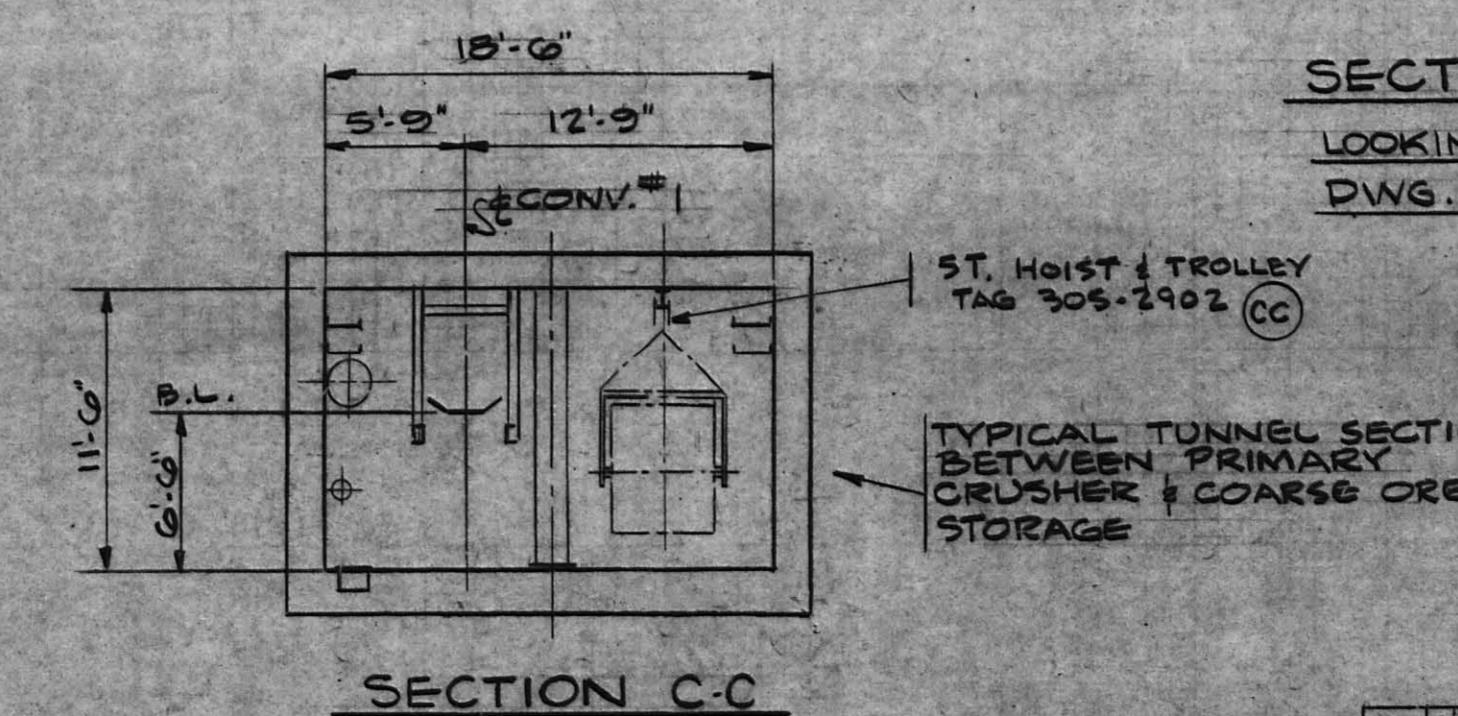

SECTION C-C

APPROVED
(FOR CONSTRUCTION)

TRG NO.	ITEM	NO.	REG.	DESCRIPTION	MAT'L	LOCATION	MARK NO.	DETAILED ON DWG.	REQ'N
301-3905	4	1		ELECTRIC TRACTION SERVICE ELEVATOR			DD		PR-3008
305-2902	3	1		5T. CHAIN HOIST & TROLLEY 7 FT. LIFT			CC		PR-1901
305-2101	2	1		54-74 STD. GYRATORY CRUSHER			BB		PR-2103
305-2901	1	1		60/15 TON TRAVELING CRANE			AA		PR-2901

BILL OF MATERIAL

ANVIL MINING CORPORATION LIMITED
THE ANVIL PROJECT
FARO NUMBER 1 ORE BODY

WHITE HORSE YUKON TERRITORY

PRIMARY CRUSHING
PRIMARY CRUSHING PLANT
MECHANICAL
GENERAL ARRANGEMENT SECTIONS

SCALE: 1/8" = 1'-0"

300-1002

JOB NO. 3748-G REV. NO. 3

NO.	BY	CHK.	APP.	APP.	CLIENT	DATE	DESCRIPTION
1	J.M.	J.M.	J.M.	J.M.	J.M.	12-1-67	REV. CRUSHER DIM. TRUCK DIM. ADDED B.M.
2	J.M.	J.M.	J.M.	J.M.	J.M.	4-26-68	ADDED HOIST TO B.M.
3	J.M.	J.M.	J.M.	J.M.	J.M.	1-19-69	ADDED ELEVATOR TO B.M.; RELOC. LADDER & HOIST B.M.

THE RALPH M. PARSONS CONSTRUCTION CO.
OF CANADA, LTD.
ENGINEERS & CONSTRUCTORS
8 KING ST. EAST TORONTO, ONTARIO