

## MEMORANDUM

DATE: October 8, 1995

TO: Dick Arndt

FROM: Harry Woo

SUBJECT: Evaluation of showing provided by Art John of Ross River.

CC: Kurt Forgaard, file

---

Several weeks ago, Kurt Forgaard asked Dick Arndt to check with Mike Rawlings at Ross River about a high grade lead-silver sample (thought to be approximately 20 pounds) found in the area. Arrangements were made with Trans North Air to fly to the site by helicopter. On Saturday, October 7, 1995, Dick Arndt and Harry Woo travelled to Ross River to meet with Art John, a local native prospector who found the lead-silver showing.

The showing is located along the Pelly River escarpment, roughly 4 kilometres directly south of the Swim deposit claim boundary held by Anvil Range Mining Corp. Access was by a short helicopter ride, flying 10 minutes north-west of Ross River and landing on a gravel bar on a Pelly River meander. The actual showing can be accessed by foot at low water. See accompanying map.

Seven samples were collected from the site. Most of the samples were highly iron-stained quartzite to meta-quartzites, overlain by a 15 to 20 foot thick zone of rubbly, highly weathered light brown metasediments which in turn covered by 20 feet of till. The meta-quartzite material along the edge of the river was where Art took his original grab sample and most of our samples were in the same area. The seven samples were collected in an attempt to replicate his sample and assay (which I believe is impossible). See attached assay. The meta-quartzite did not contain any evidence of Pb or Ag or massive sulphide mineral other than the iron stains. The samples will be sent to Northern Analytical Laboratories Ltd in Whitehorse to be analysed for possible gold and silver content instead. They will be instructed to keep the reject samples for two months in case there are favourable results. Being so close to the Swim deposit, this might give us more information to complement that prospect.

None of the negative or disappointing thoughts we had about the showing were conveyed to the prospector at the time of sampling. We did not want to discourage future potential prospect introductions from native prospectors in this area. We told Art that we would keep him informed of the results from the samples and encouraged him to bring other findings.

In the future, any prospect proposals should be presented with a representative raw rock/mineral sample along with the analytical results in order to verify the source of the analysis. I asked Kathlene Suza our Aboriginal Employment Manager to inform other prospectors in the area of such procedure. In the case of this proposal, the sample had to be pure galena to duplicate the results on the assay sheet. This prospect did not contain such material.

Sample inventory:

- Artj-1 to Artj-6....meta-quartzite, iron-stained
- Artj-7.....weathered metasediments, yellow-brown

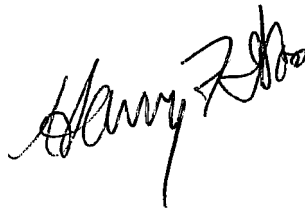
A handwritten signature in black ink, appearing to read "Harry Ross". The signature is written in a cursive, somewhat stylized font.

## PROPERTY EXAMS-WD

Job V 95-0275R

CM EXPEDITING SHOWING

Report date 14 SEP 1995

LAB NO	FIELD NUMBER	Pb(1) %	Ag(1) g/t
R9510656 CM 01		74.63	2311

I=insufficient sample X=small sample E=exceeds calibration C=being checked R=revised  
If requested analyses are not shown, results are to follow

## ANALYTICAL METHODS

Pb(1) Assay

Ag(1) Fire Assay, Lead Collection / Gravimetric Finish (ore grade) 1/2 or 1 A.T.

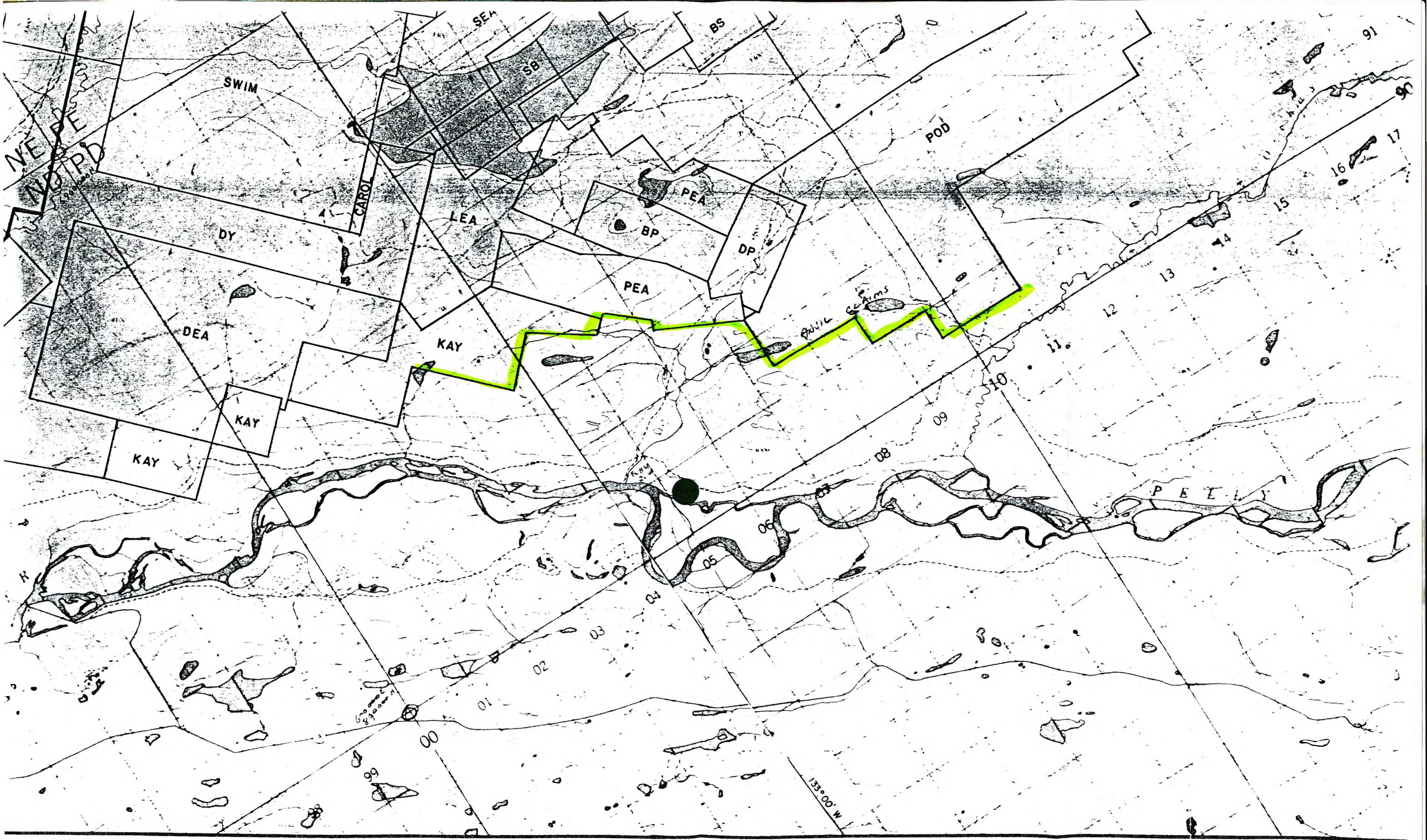

● PROSPECT LOCATION

1:50,000  
AN-AN-88-001  
93/02/03 P.T.A.