

Holes drilled already, but considered to be too short.

232.4 - 259.4 = 27m  
w 4AC @ 32%  
incl 3pm @ 8.13%  
mostly in 1.5m @ 13.78%  
@ ~ 250m

STOPPED IN 4A

206.6 - 228.2 INTERMIT 4AC 0-5%  
228.2 - 267.7 = 4AC @ 3-4%  
267.7 - 298.1 = INTERMIT 4AC @ 1-5%  
298.1 - 321.2 = 4AC @ 1-13%  
incl 3.0 @ 10.4%  
3.1 @ 8.9%

262.4 - 270.6m = 8.2m @ 6.17%

311.2 - 317.9 = 6.6m @ 15.36%  
322.2 - 324.9 = 2.7m @ 13.64%  
336.0 - 359.0 = 23.0m @ 14.45%  
420.5 - 425.8 = 5.3m @ 9.98%

138.1m -  
14.9m @ 8.24%  
incl 3.0 @ 10.0%  
153m -  
167.6 - 189.9 = 19.3m  
@ 5.5%  
incl 3.0m @ 9.18%

NO CRE

STOPPED IN 4AC @ 32%  
194.6 - 204.7 = 10.1m @ 14.03%

355.1 - 360.9 = 5.8m @ 10%  
363.3 - 366 = 2.7m @ 12%

110 - 133 = 4A @ 70%

236.9  
DECO + 15%  
- 392.4  
@ 14%

244.0 - 253.0 = 9.0m @ 12%  
273.1 - 274.6 = 1.5m @ 17%  
279.3 - 277.5 = 1.8m @ 11%  
357.2 - 378.9 = 21.7m @ 15%  
402.8 - 405.1 = 2.3m @ 9%

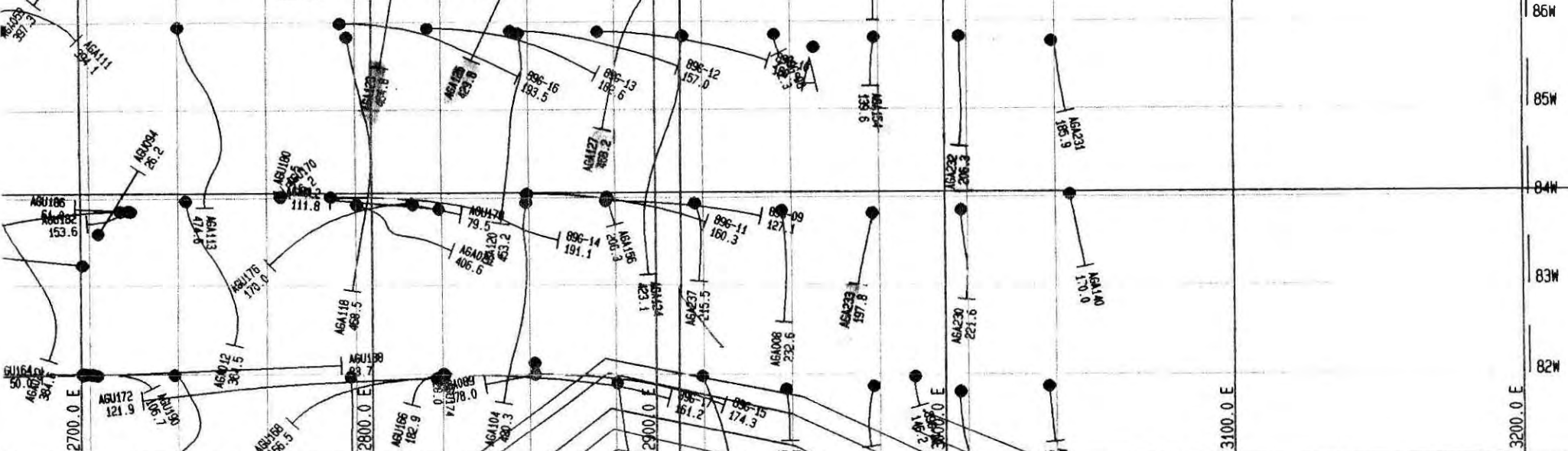

Faro Mine  
P.O. Box 1000  
Faro, YT  
Y0B 1K0

Anvil Range Mining Corporation

SURFACE MAP  
PROPOSED DRILLING - GRUM  
PIT OUTLINE = STAGE I

DATE: 06/28/96	TIME: 14:47:28
1	
2	
3	
4	
5	

004044

SCALE (HORIZONTAL) 1:2000 SCALE (VERTICAL) 1:200