

YUKON MINERALS
CORPORATION

PERREX RESOURCES
INCORPORATED

JOINT VENTURE

AREA C

YUKON MINERALS - PERREX JV.

KETZA PROJECT
GROUNDHOG CREEK, YUKON TERRITORY
LAT. 61° 37' N., LONG. 132° 52' W., NTS 105 F/10

To Accompany Report By B.P. FOWLER, P. Geol.
Compilation Of Work Done On Property During
APRIL To NOVEMBER, 1988.

Data Compiled By: B.P. FOWLER, P. Geol.
Project Manager
POLARIS CONSULTING
Reg Harding

Dated: DECEMBER 31, 1988

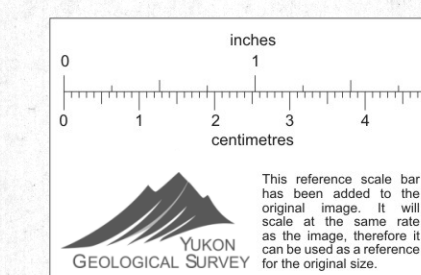

004449

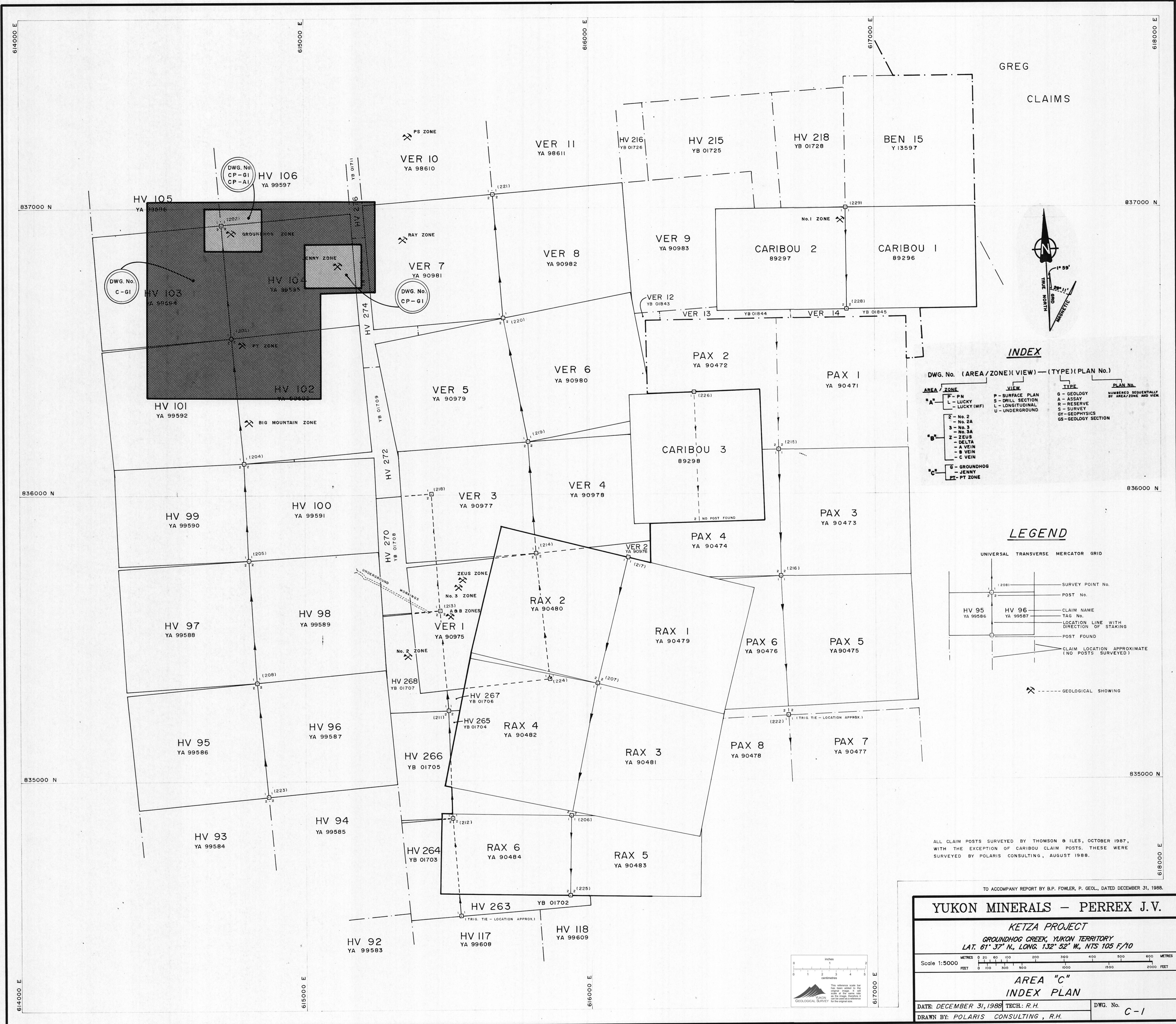

GREG CLAIMS

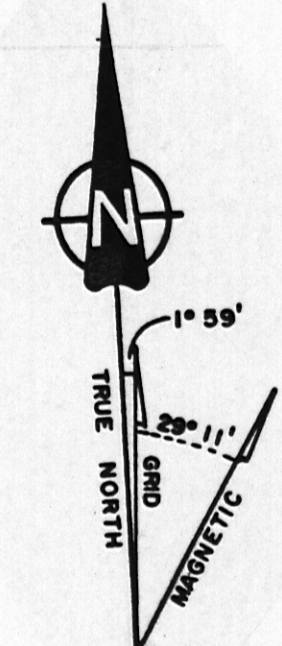

INDEX

DWG. No. (AREA / ZONE) (VIEW) - (TYPE) (PLAN No.)	VIEW	TYPE	PLAN No.
"A"	F - PLAN	G - GEOLOGY	NUMBERED SEQUENTIALLY BY AREA / ZONE AND VIEW
	L - LUCKY	A - ASSAY	
	L - LUCKY (MF)	R - RESERVE	
"B"	2 - No. 2	S - SURVEY	CY - GEOPHYSICS GS - GEOLOGY SECTION
	3 - No. 3	U - UNDERGROUND	
	3A - No. 3A		
	2 - ZEUS		
"C"	- DELTA		
	- A VEIN		
	- B VEIN		
	- C VEIN		
	G - GROUNDHOG		
	- JENNY		
	- PT - PT ZONE		

LEGEND

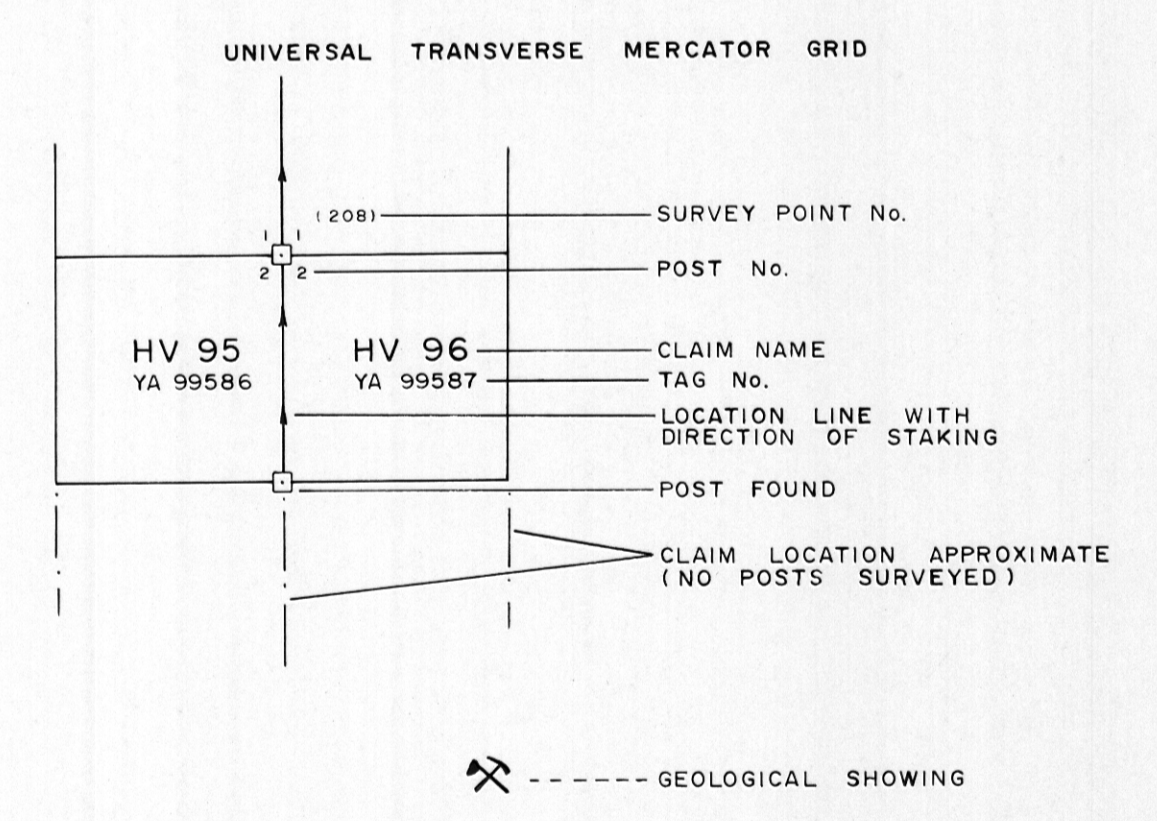

ALL CLAIM POSTS SURVEYED BY THOMSON & FLES, OCTOBER 1987, WITH THE EXCEPTION OF CARIBOU CLAIM POSTS. THESE WERE SURVEYED BY POLARIS CONSULTING, AUGUST 1988.

TO ACCOMPANY REPORT BY B.P. FOWLER, P. GEOL., DATED DECEMBER 31, 1988.

YUKON MINERALS - PERREX J.V.

KETZA PROJECT

GROUNDHOG CREEK, YUKON TERRITORY
LAT. 61° 37' N., LONG. 132° 52' W., NTS 105 F/10

Scale 1:5000

METRES 0 20 40 60 80 100 120 140 160 180 200
FEET 0 100 200 300 400 500 600 700 800 900 1000

AREA "C" INDEX PLAN

DATE: DECEMBER 31, 1988 TECH.: R.H. DWG. No. C-1
DRAWN BY: POLARIS CONSULTING, R.H.

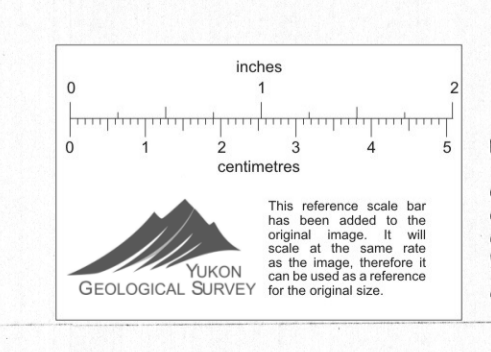

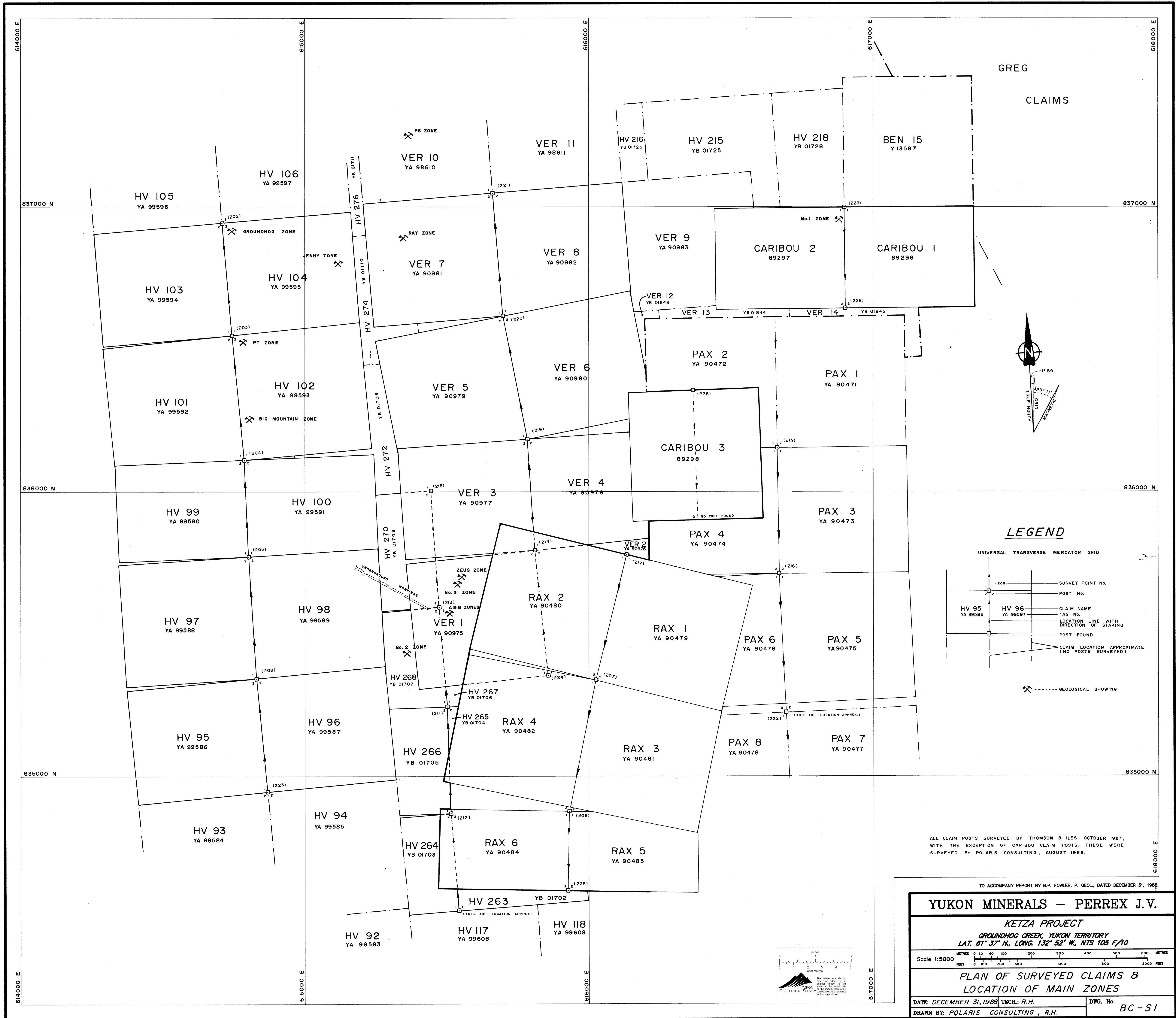

GREG
CLAIMS

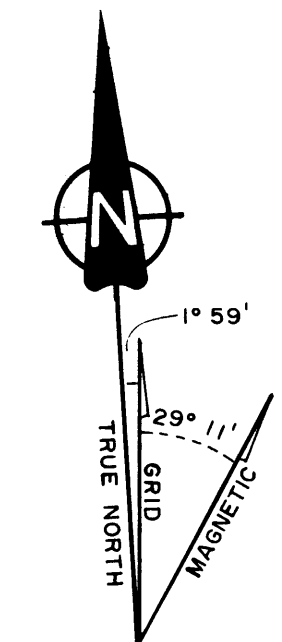

LEGEND

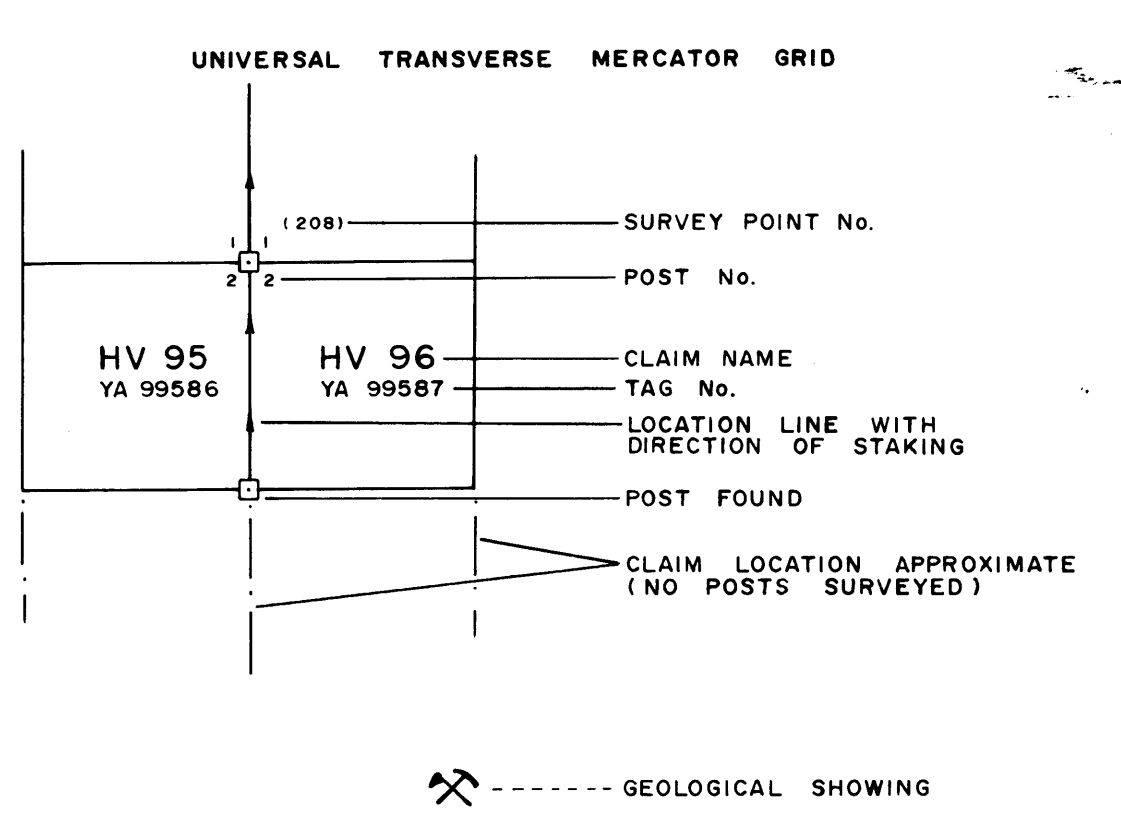

ALL CLAIM POSTS SURVEYED BY THOMSON & ILES, OCTOBER 1987, WITH THE EXCEPTION OF CARIBOU CLAIM POSTS. THESE WERE SURVEYED BY POLARIS CONSULTING, AUGUST 1988.

TO ACCOMPANY REPORT BY B.F. FOWLER, P. GEOL., DATED DECEMBER 31, 1988.

YUKON MINERALS - PERREX J.V.	
<i>KETZA PROJECT</i>	
GROUNDHOG CREEK, YUKON TERRITORY	
LAT. 61° 37' N., LONG. 132° 52' W., NTS 105 F/10	
Scale 1:5000	
PLAN OF SURVEYED CLAIMS & LOCATION OF MAIN ZONES	
DATE: DECEMBER 31, 1988	TECH: R.H.
DRAWN BY: POLARIS CONSULTING, R.H.	DWG. No. BC-S1

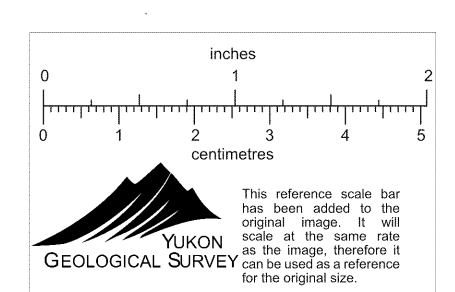

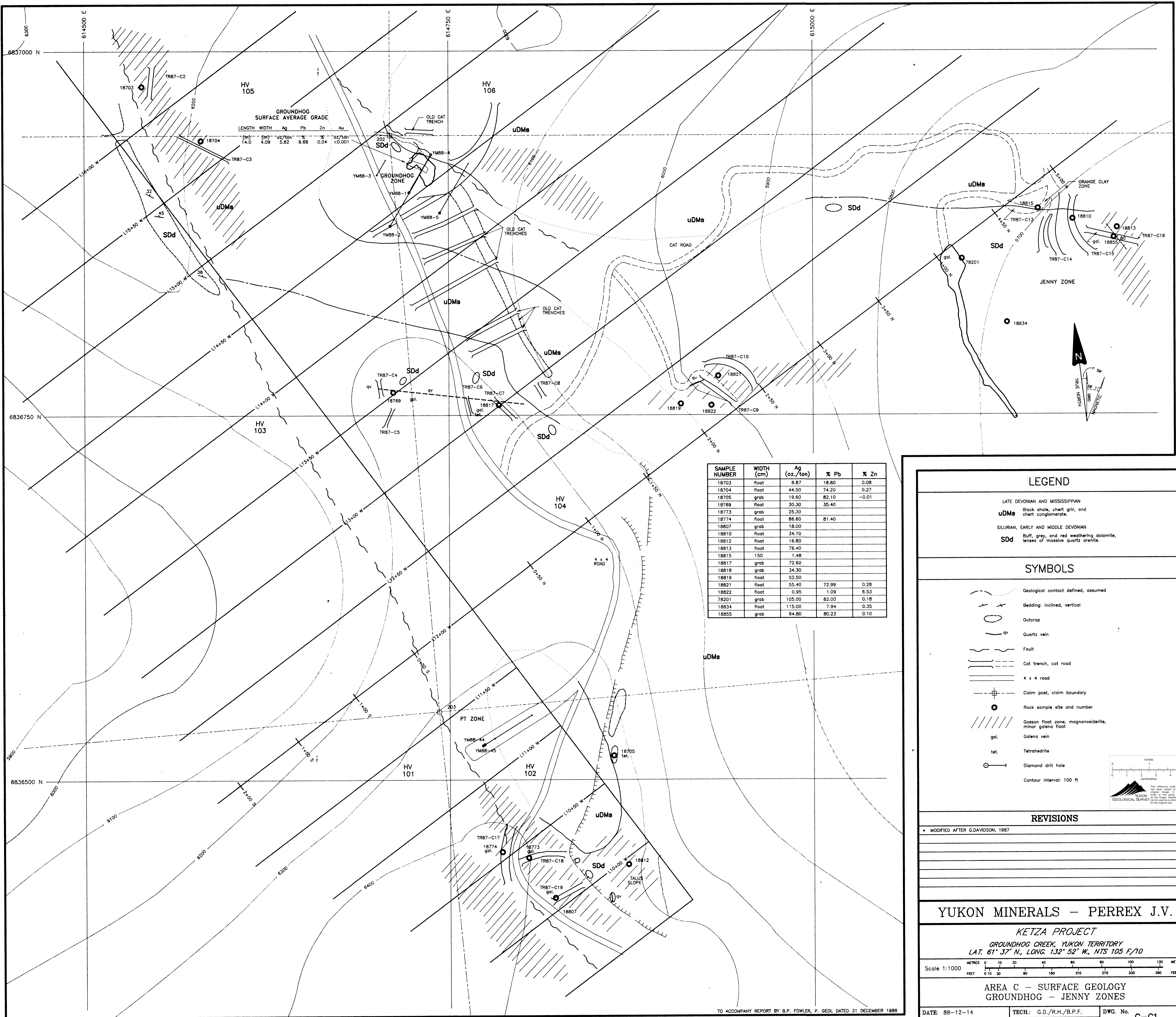

GROUNDHOG SURFACE AVERAGE GRADE

LENGTH (m)	WIDTH (m)	Ag (%)	Pb (%)	Zn (%)	Au (%)
14.0	4.09	5.62	9.68	0.04	<0.001

SAMPLE NUMBER	WIDTH (cm)	Ag (oz./ton)	% Pb	% Zn
18703	float	6.87	18.80	0.08
18704	float	44.50	74.20	0.27
18705	grab	19.60	82.10	-0.01
18769	float	30.30	35.40	
18773	grab	25.30		
18774	float	86.60	81.40	
18807	grab	18.00		
18810	float	34.70		
18812	float	16.80		
18813	float	76.40		
18815	150	1.48		
18817	grab	72.60		
18818	grab	34.30		
18819	float	52.50		
18821	float	55.40	72.99	0.28
18822	float	0.95	1.09	6.53
78201	grab	105.00	82.00	0.18
18834	float	115.00	7.94	0.35
18855	grab	64.80	80.23	0.10

LEGEND

LATE DEVONIAN AND MISSISSIPPIAN
 uDMs Black shale, chert griv, and chert conglomerate.

SILURIAN, EARLY AND MIDDLE DEVONIAN
 SDd Buff, grey, and red weathering dolomite, lenses of massive quartz arenite.

SYMBOLS

- Geological contact defined, assumed
- Bedding: inclined, vertical
- Outcrop
- Quartz vein
- Fault
- Cat trench, cat road
- 4 x 4 road
- Claim post, claim boundary
- Rock sample site and number
- Gossan float zone, magnanosiderite, minor galena float
- Galena vein
- Tetrahedrite
- Diamond drill hole
- Contour interval: 100 ft

REVISIONS

No.	Description
1	MODIFIED AFTER G.DAVIDSON, 1987

YUKON MINERALS - PERREX J.V.

KETZA PROJECT
 GROUNDHOG CREEK, YUKON TERRITORY
 LAT. 61° 37' N., LONG. 132° 52' W., NTS 105 F/10

Scale 1:1000

AREA C - SURFACE GEOLOGY
GROUNDHOG - JENNY ZONES

DATE: 88-12-14 TECH: G.D./R.H./B.P.F. DWG. No. C-G1
 DRAWN BY: NEW CONCEPT DRAFTING LTD.

TO ACCOMPANY REPORT BY B.P. FOWLER, P. GEOL DATED 31 DECEMBER 1988

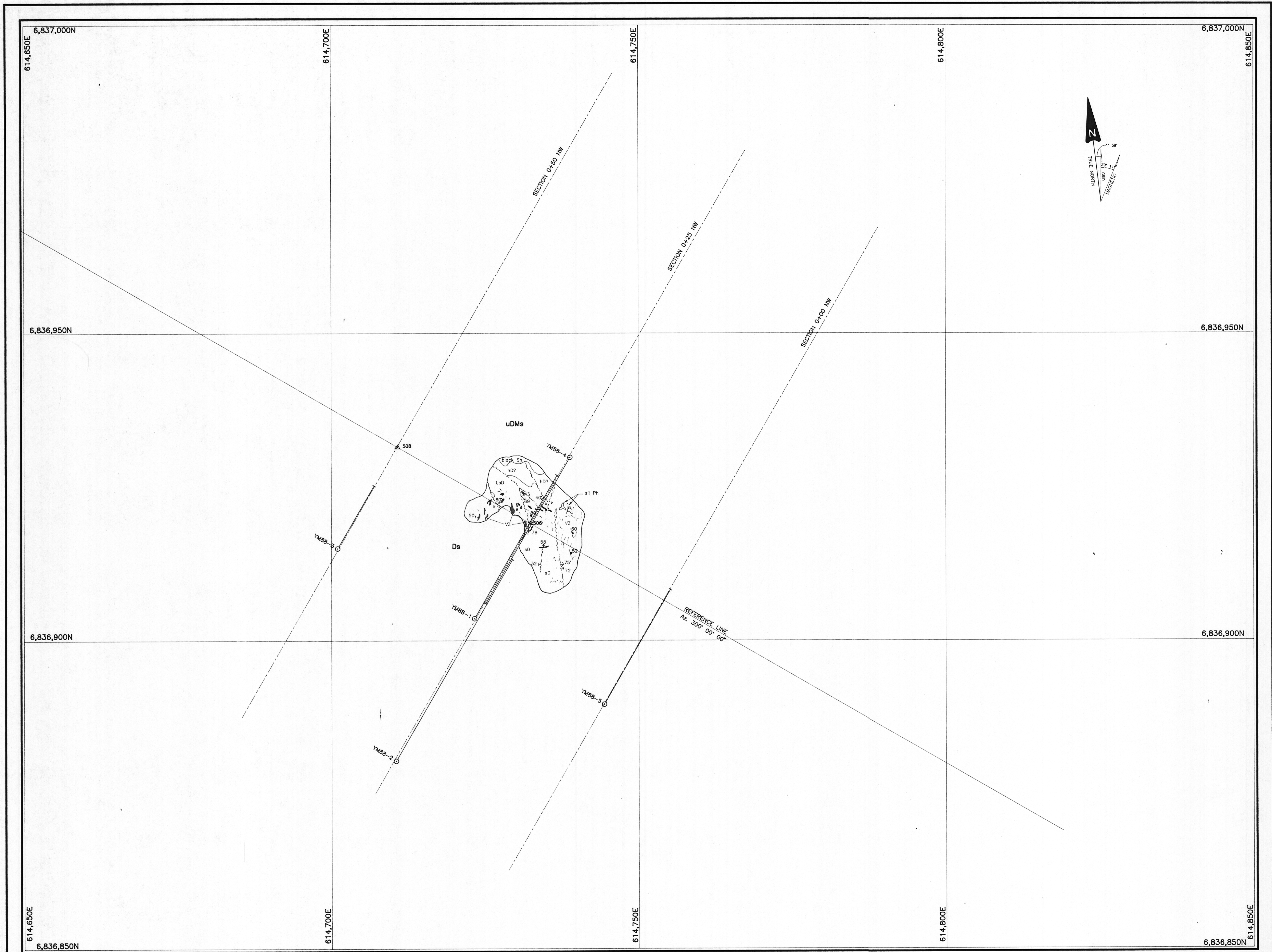

REVISIONS	LITHOLOGY	MINOR COMPONENTS	MINERALIZATION	STRUCTURE	STRATIGRAPHY
	C1 CHERT D DOLOSTONE M MUDSTONE SN SHALE Ph PHYLLITE SL SILTSTONE QZ QUARTZITE/ARENITE C CONGLOMERATE A ANDESITE S SYENITE	d DOLOMITIC (f) FOSSILIFEROUS s SILIFIED a ANKERITIC c CALCAREOUS CLAY/DOUSE b BLEACHED m MANGANESE h HEMATITE l LIMONITE ph PHYLLITIC st SILTY cb CARBONACEOUS	▲ GALENA +/- SPHALERITE +/- TETRAHEDRITE IN BRECCIA ● GALENA +/- SPHALERITE +/- TETRAHEDRITE REPLACEMENT, FRACTURE FILLING ■ GALENA +/- SPHALERITE +/- TETRAHEDRITE - MASSIVE Sp SPHALERITE py PYRITE VZ VEIN ZONE, massive, clotted, galena, +/- tetrahedrite +/- sphaerite +/- chalcopryite +/- pyrite +/- ascorite +/- malachite +/- azurite +/- quartz/non carbonate gangue OZ OXIDE ZONE, gangue/breccia zone with >30% limonite matrix +/- massive clotted galena, sphaerite, pyrite GZ GALENA ZONE, >1% clotted, disseminated galena +/- sphaerite; <30% limonite SZ SPHALERITE ZONE, >1% clotted, disseminated sphaerite +/- galena; <30% limonite PZ PYRITE ZONE, massive, clotted pyrite QV QUARTZ VEIN; (no visible sulfides)	△ BRECCIA ▽ FAULT WITH SENSE OF DISPLACEMENT, DOWN BLOCK ▹ FAULT WITH DIP & DIP DIRECTION 30° FOLIATION & ANGLE TO CORE AXIS 30° BEDDING & ANGLE TO CORE AXIS J JOINTING - - GEOLOGICAL CONTACT - OBSERVED, INFERRED lam LAMINATED	QUATERNARY Overburden, glacial drift CRETACEOUS AND (?) EARLY TERTIARY Dark green, fine grained mafic dyke LATE DEVONIAN AND MISSISSIPPIAN Fine to medium grained syenite dyke ORDOVICIAN AND SILURIAN Black shale, chert grit, and chert conglomerate SILURIAN, EARLY AND MIDDLE DEVONIAN Silicified dolostone with bands of black quartzite, grey quartzite & cross bedded siltstone or phyllite Carbonaceous dolostone, black, fine grained minor phyllite EARLY CAMBRIAN Grey calcareous mica schist and marble (modified after Templeman-Kluit, 1977)

YUKON MINERALS - PERREX J.V.

KETZA PROJECT
 GROUNDHOG CREEK, YUKON TERRITORY
 LAT. 61° 37' N, LONG. 132° 52' W, NTS 105 F/10

Scale 1:250

GROUNDHOG ZONE
SURFACE GEOLOGY

DATE: DECEMBER 31, 1988	TECH: R.H. B.P.F.	DWG. No.
DRAWN BY: NEW CONCEPT DRAFTING LTD.		CP-G1

NOTE:
Elevations are Geodetic.
All distances and elevations
are in metres unless noted.

TO ACCOMPANY REPORT BY B.P. FOWLER, P. GEOL DATED 31 DECEMBER 1988

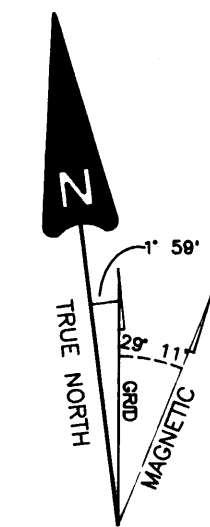
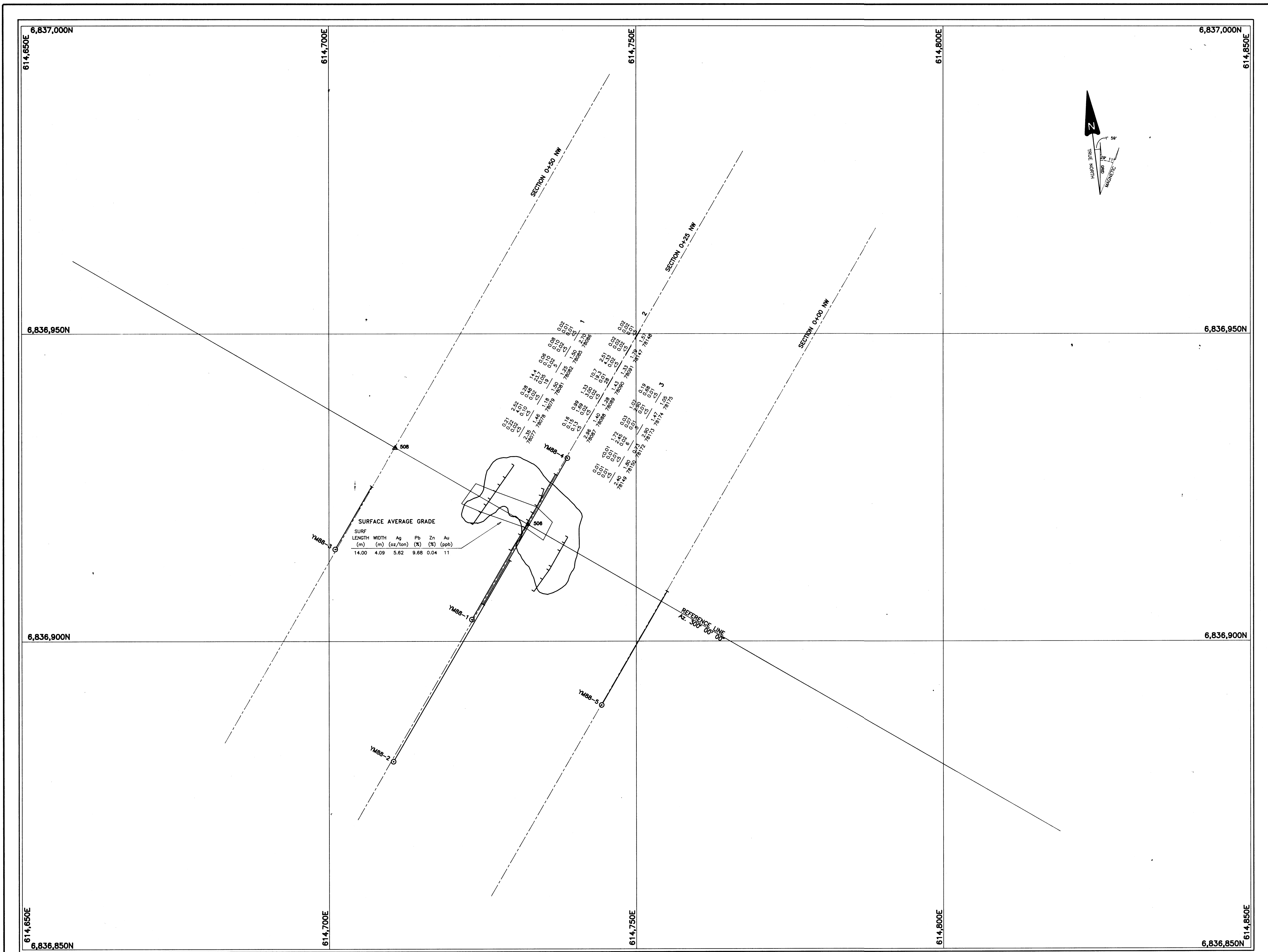

REVISIONS

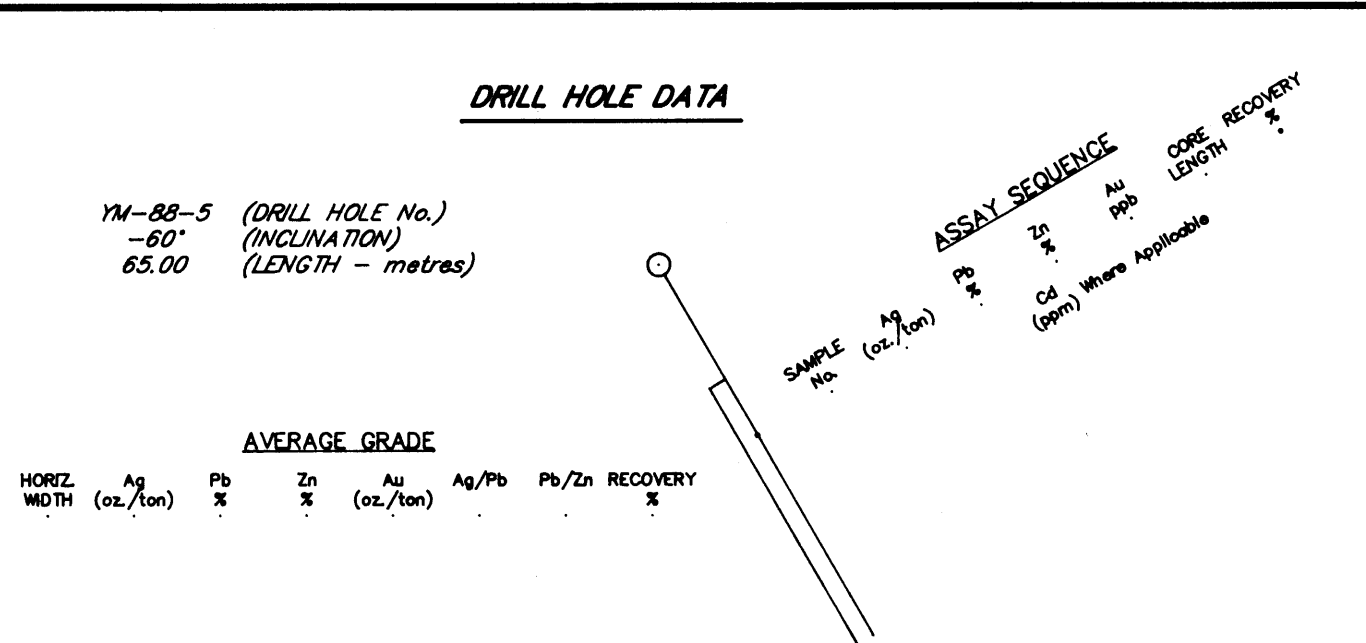

LEGEND

CHANNEL SAMPLE DATA

Ag (oz./ton)
 Pb (%)
 Zn (%)
 Au (ppb)

SAMPLE WIDTH (m)
 SAMPLE No.

NOTE:
 Elevations are Geodetic.
 All distances and elevations are in metres unless noted.

YUKON MINERALS - PERREX J.V.

KETZA PROJECT
 GROUNDHOG CREEK, YUKON TERRITORY
 LAT. 61° 37' N, LONG. 132° 52' W, NTS 105 F/10

Scale 1:250

GROUNDHOG ZONE SURFACE ASSAY PLAN

DATE: DECEMBER 31, 1988 TECH.: R.H., B.P.F. DWG. No. CP-A1

DRAWN BY: NEW CONCEPT DRAFTING

TO ACCOMPANY REPORT BY B.F. FOWLER, P. GEOL DATED 31 DECEMBER 1988

TO ACCOMPANY REPORT BY B.P. FOWLER, P. GEOL., DATED DECEMBER 31, 1988.

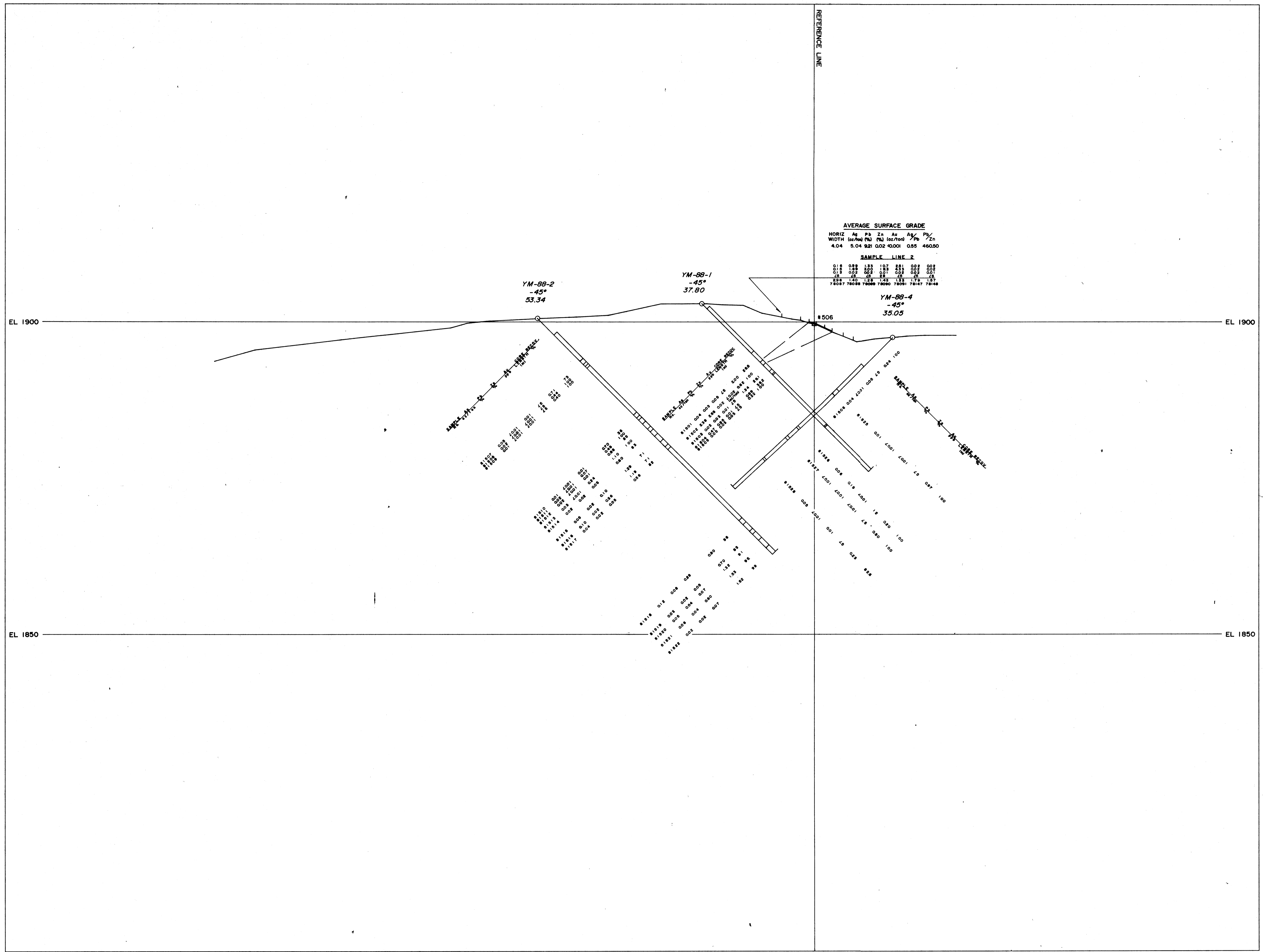

REVISIONS

No.	Description

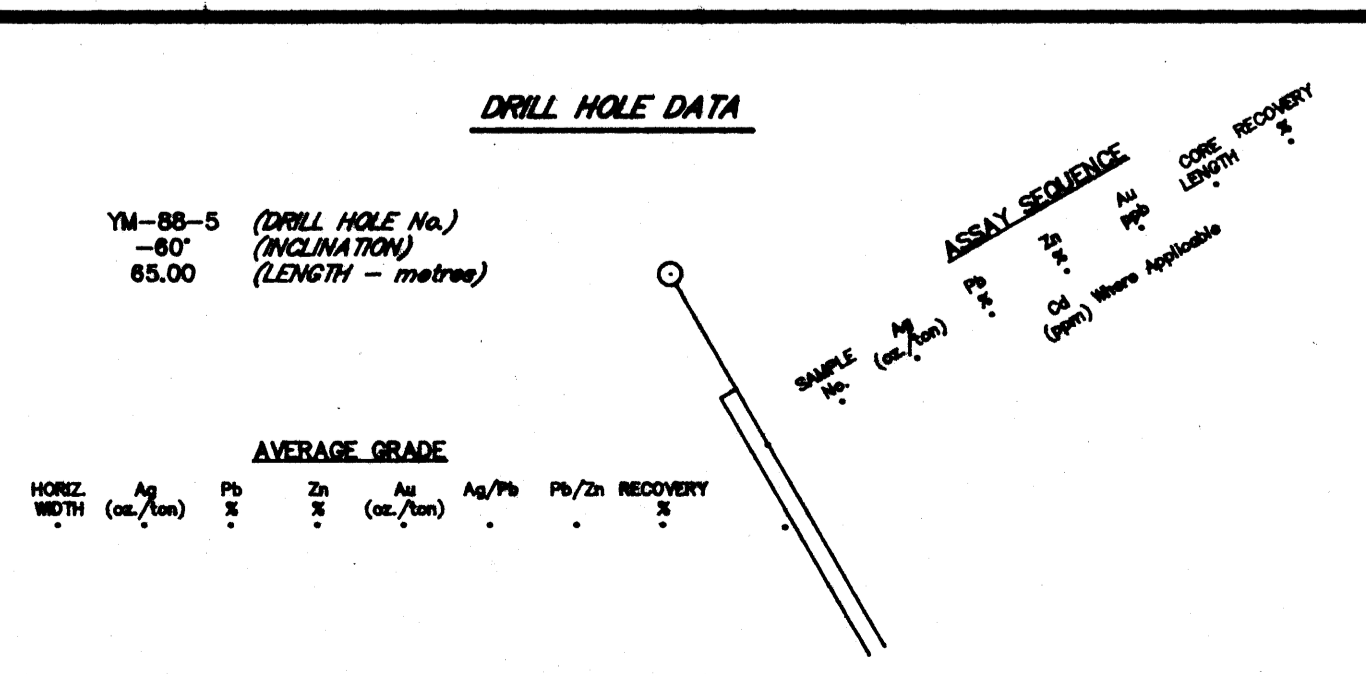

LEGEND

CHANNEL SAMPLE DATA

Ag	(oz./ton)						
Pb	(%)						
Zn	(%)						
Au	(ppb)						
SAMPLE WIDTH (m)	SAMPLE No.						
018	018	008	008	008	008	008	008
018	038	008	008	008	008	008	008
018	008	008	008	008	008	008	008
018	008	008	008	008	008	008	008
018	008	008	008	008	008	008	008

NOTE:
Elevations are Geodetic.
All distances and elevations are in metres unless noted.

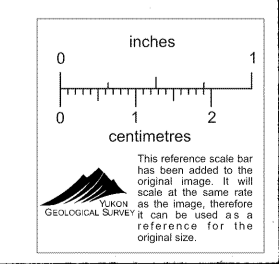

YUKON MINERALS - PERREX J.V.

KETZA PROJECT
GROUNDHOG CREEK, YUKON TERRITORY
LAT. 61° 37' N., LONG. 132° 52' W., NTS 105 F/10

Scale 1:250

GROUNDHOG ZONE
VERTICAL CROSS SECTION - 0 + 25 NW ASSAY
LOOKING N 60° W

DATE: DECEMBER 8, 1988 TECH: B.F. DWG. No. GS-A2

DRAWN BY: POLARIS CONSULTING, J.B.

