

File 105 h

Ernstson :- fountain of Pichblende

Glen Lyon fountain

004965 Jan 21 1955

105.L.

PROSPECTORS AIRWAYS COMPANY, LIMITED

SUITE 1616
44 KING STREET WEST
TORONTO 1
EMPIRE 6-7951

January 21st, 1955.

Fred Endvolson, Esq.,
Dawson, Y. T.,

Dear Fred,

You may recall that I visited you in 1953 while in Dawson and had a chat about various prospects in the Yukon.

Recently a minister down here Rev. Mr. Swanson told a mutual friend that you had once mentioned to him that you knew where there was a "mountain of pitchblende" in the Glenlyon Mountains.

As we are exploring in that section I wonder if you could give me any more information on where this locality is.

You may rest assured that I would treat it most confidentially and should anything come of it I would protect your interests.

If you do not care to write regarding this I will be up to Dawson this spring and if you wish will call in and see you. Let me hear from you in any event.

Best regards for now.

Yours very truly

PROSPECTORS AIRWAYS COMPANY LIMITED



E. O. Chisholm
Chief Geologist

EOC:JC

Ed died about Xmas time !!

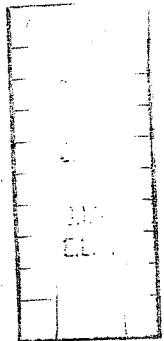

A		N
✓	C.L.C.	✓
✓	G.C.A.	✓
✓	G.E.	✓
✓	E.O.C.	✓
	R.D.S.	
	J.I.K.	
	E.L.D.	