

DONALD CLAIMS 106D
PROSPECTORS AIRWAYS COMPANY, LIMITED

SUITE 1616
44 KING STREET WEST
TORONTO 1
EMPIRE 6-7951

004995

3/3
Blue File
-106D

Donald Gordon

Y 3/22

June 15th/55

Mr. C. L. Coleman
Managing Director

Dear Charlie:

Regarding your letter of June 6th to Gordon F. Dickson I personally delivered it two days ago and made out transfers from the company to Dickson of the Donald claims 9 to 80. He has the grants for the original claims in the Bank and I presume will take them out of escrow now that we have dropped the option. I advised him to file his own assessment work at Mayo as he would possibly have more success in getting it passed right away. He was also advised that we would not pay to have the transfer of the Donald claims 9-72 registered in his name. My understanding of the agreement is that we are not liable for this. The recording fee involves about \$80.00.

As far as we are concerned this cleans up the Donald deal and it is now off our books.

Regards,

E. O. Chisholm

P.F. DICKSON
DONALD CLAIMS

y 3/22

A		12
	CLC.	
✓	G.C.A.	✓
✓	G.E.	✓
✓	E.O.C.	✓
✓	R.D.S.	✓
	J.I.K.	
	ELD.	

Ted

- (a) I made no mention of the recording of the work, and who is going to do it!
- (b) The balance of the 72 claims is in our name and I suppose you have discussed with Charlie whether all of them are to be handed over to Gordon Dickson.

313

*D'Arge's report
required for recording
no copy on file*

G. Ehrlich.

Extract from letter from E. O. Chisholm to C. L. Colema
Dated September 2, 1954

106D

DONALD GROUP

KATHLEEN LAKES AREA, MAYO DISTRICT

Seventy two claims have been staked in this location and eight more are being staked at the present time. Claims Donald 1-8 were staked by G. F. Dixon, originally and have been granted. The grants and transfers are in the hands of Victor Wylie's Office and will be placed in escrow against our agreement when he returns from Holidays within two weeks time. The down payment of \$5,000.00. has been made to Dixon. The records of claims Donald 9-16 have not been completed at this date but will be mailed out from the property about September 10th on the next plane. Claims Donald 17 to 72 have been recorded in Mayo and transferred to the company. The transfers will be sent to this office when the grants have been issued. These transfers should also be placed in escrow against our agreement, a copy of which should have reached Toronto office by this time. If this agreement has not been sent to you by Wylie I think a letter should be sent to his office from you as I have noticed considerable laxity there of recent weeks. The Quill Creek assessment delay should not have happened if he had been on his toes and I find that nothing had been done about Mr. Erlic's letter of August 27th on the White River claims until I took the matter up with the recording office yesterday. If they are going to charge the same fees as city lawyers they should prepare to give the same service.

Enclosed find a rough sketch of the Donald Group with pertinent staking data for Mr. Ehrlic's files. Please have Mr. Finch prepare six copies for this office.

Lomer D'Aigle is on the ground with a crew of seven men from Dawson completing the staking and trenching the ground and mapping. He will stay on the property until the snow gets too deep for work and will get as much information as possible this year, so that we may base our future program.

Due to the acquisition of the above ground and that in the Clarke Peak area the flying bills will no doubt exceed my earlier estimate for the season by a considerable amount. I have tried to cut down the trips to the Vangorda property somewhat by taking as much as possible down the Canol but it is too slow for fresh stuff and personnel.

Regarding the Dixon Showing I showed a piece of the black gossan from the showing to Hugh Bostock and he said it resembled very closely the manganiferous siderite gossan of the Kenor Camp.

Extract from Letter from E. O. Shisholm to C. L. Coleman
Dated September 10, 1954.

106D

DONALD GROUP

D'Aigle reports from the Donald Group that he now has staked 80 claims and will complete the work of mapping and trenching for the season on Sept. 20th. I postponed my trip in there until around that date due to other work. Twenty five trenches were dug across the gossan zone at 50 foot intervals over a length of approx. 1500 feet. Permafrost was encountered at a depth of 3 to five feet. Samples will be taken shortly. D'Aigle thinks the mineral is related in some way to a fault between the contact of an overlying shaley limestone and an underlying limestone. There appears to be a carbonate breccia zone along this break, of considerable width. No massive mineralization has been encountered to date due to the oxidized nature of the host rock. Another gozzan zone of a similar nature was encountered on the claims about two miles east of the main zone. Small parallel showings of lead-zinc mineralization in limestone have been encountered 1000 feet below the main showing and parallel to it.

The zone is being mapped at 400 feet to the inch and soil profiles are being run across the zone to guide future exploration. At this range it would appear that some drilling will be necessary in the Spring to test the mineral content of the gossan zone. If the grade of the fresh rock is satisfactory the property appears to have considerable potential. This years sampling of the gozzan will be an indication only.

106D

Extract of letter from E. O. Chisholm to C. I. Coleman, dated Sept. 25, 1954

Donald Option

Due to the inaccessibility of the area it has been impossible to obtain detailed information from D'Aigle before now. He is at present making up a preliminary report on the ground which will be forwarded in a few days time. A short summary of this report is enclosed.

At this range I would say there is a large zone of lead-zinc mineralization outlined and a very favorable structural condition exists. The trenching done on the main zone should be indicative of the mineral content of the zone. Due to the heavy black nature of the oxidation it would not be safe to predict this content until the assays are returned. Approximately ninety bags of samples have been forwarded to Bell for assay.

A total of 80 claims have been staked in one group and 72 of these transferred to the company. The grants and transfers for these will be forwarded this week. The original eight claims have been transferred and placed in escrow in the Bank of Commerce against our agreement.

file y 3/22

A		N
	C.L.C.	
	G.C.A.	
	G.E.	
	E.O.C.	
	R.D.S.	
	J.I.K.	
	E.L.D.	

31B

June 6th, 1955.

Mr. Gordon F. Dickson,
P. O. Box 557,
Whitehorse, Y. T.

Dear Sir:

We beg to refer to the agreement of August 11th, 1954 between you and this Company regarding Donald Claims 1 to 8 situated three (3) miles north of the Survey Monument at Kathleen Lake, in the Mayo Mining District, Yukon Territory.

We are informing you herewith that in view of the exploration results obtained in our work of last season that we do not intend to carry out any further work on these claims and the above mentioned agreement is now terminated. We will instruct the Whitehorse Branch of the Canadian Bank of Commerce to deliver, to you, the transfer for the above claim, which is being held in escrow there in accordance with the terms of the agreement.

Yours truly,

PROSPECTORS AIRWAYS COMPANY, LIMITED

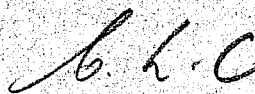

C. L. Coleman,
Managing Director.

GH:AW

DONALD GROUP

106 D

Trenching

1. On Claim Donald 3

<u>Trench No.</u>	<u>L Feet</u>	<u>W Feet</u>	<u>D Feet</u>	<u>Class 2 Cu. yds.</u>	<u>Class 3 Cu. yds.</u>
1	5	2.5	4.5	2.08	
2	11	3	5	6.11	
3	5	3	4.5	2.50	
4	6	2.75	4	2.44	
5	5	2.5	4	1.85	
6	4	2	4	1.19	
7	17	4	3	7.56	
8	4	2	4.5	1.33	
9	5	2	4.5	1.67	
10	4.5	2.5	2.5	1.04	
11	4.5	2	2	0.67	
12	4	2.5	4	1.48	
13	4	3	2	0.89	
14	5	2.5	4	1.85	
15	4	2.5	1.5	0.56	
16	6	2.5	3.5	1.94	
17	6	3	7.0	4.67	
18	6	3	2	1.33	
19	8	2.5	4.5	3.33	
20	4	3	4.5	2.00	
21	4	3	2	0.89	
22	4.5	3	4.5	2.25	
23	3	3	2	0.67	
24	5	3	4	2.22	
25	8	2.5	3	2.22	
26	7	2.5	1.5	0.97	
27	8	2.5	1.5	1.11	
28	4	2.5	2	0.74	
29	3.5	2.5	2	0.65	
30	3	2	0.5	0.11	
31	6	3	2		1.33
32	10	3	2		2.22
33	3	3	1.5		0.50
34 a	15	4	3.0		6.66
34 b	3	2.5	1.0	0.28	
35	4	3.5	2.0		1.04
36	4	2.5	2.5		.93
Total				56.38	12.68

On Claim Donald 72

37	4	3	3	1.33	
38	4	3	3	1.33	
Total				2.66	

On Claim Donald 20

39	10	4	5		7.41
Total					7.41

Donald Claims - Trenching cont'd.

106D

Assessment Value of Trenching

Class 2 of Schedule of Representation

"Trenching, Stripping, through Rock requiring Pick and Shovel only."

Value: 8 cubic yards,
equivalent \$100.00.

Class 3

"Trenching in solid rock on frozen matter requiring rock drilling and explosives"

Value: 4 cubic yards,
equivalent \$100.00.

Summary

On Claim Donald 3

Class 2: 56.38 cu. yds.	:	8 equivalent	\$704.80
Class 3: 12.68 cu. yds.	:	4 equivalent	<u>317.00</u>
			\$1021.80

On Claim Donald 72

Class 2: 2.66 cu. yds.	:	8 equivalent	33.30
------------------------	---	--------------	-------

On Claim Donald 20

Class 3: 7.41 cu. yds.	:	4 equivalent	<u>185.30</u>
------------------------	---	--------------	---------------

Total			<u><u>\$1240.40</u></u>
-------	--	--	-------------------------

AW
5cc.

J 3/22

DICKSON OPTION

DONALD CLAIMS, KATHLEEN LAKE

A	C.L.C.	N
✓	G.C.A.	✓
✓	G.E.	
✓	E.O.C.	
	R.D.S.	
	J.I.K.	
	E.L.D.	

313

(1) CLAIMS

<u>Claim Nos.</u>	<u>In the Name of</u>	<u>Grant Nos.</u>	<u>Recording Date</u>
Donald 1 - 8	Dickson	?	? August 1954
"	Prospectors Airways	M.C. 62510 - 517	11 September 1954
" 17 - 24	" "	M.C. 62446 - 453	7 September 1954
" 25 - 32	" "	M.C. 62454 - 461	7 September 1954
" 33 - 40	" "	M.C. 62462 - 469	7 September 1954
" 41 - 48	" "	M.C. 62470 - 477	7 September 1954
" 49 - 56	" "	M.C. 62478 - 485	7 September 1954
" 57 - 64	" "	M.C. 62486 - 493	7 September 1954
" 65 - 72	" "	M.C. 62494 - 501	7 September 1954
" 73 - 80	" "	M.C. 62502 - 509	11 September 1954

Grant numbers and recording date of Donald 1 - 8 not known: Grants were to be placed in escrow by Mr. Wylie.

(2) EXPENDITURES DURING 1954

Claims Staking	\$ 2,797.63
Geological Work	2,486.57
Stripping & Trenching	3,684.65
Prospecting	737.60
Whitehorse Office	161.16
TOTAL	\$ 9,867.61

(3) TRENCHING

A detailed list of the dimensions of 39 Trenches was submitted by Lormer D'Aigle. The following is a summary of this work:-

Trenching	Donald # 3 - 58.60 cu. yds. in rock
	12.68 cu. yds. in rock using explosives
	Donald # 20 - 7.41 cu. yds. in rock using explosives
	Donald # 72 - 2.66 cu. yds. in rock

8 cu. yds. of rock trenching has a value of \$100.00.
 4 cu. yds of rock trenching using explosives has a value of \$100.00

Value of Trenching

Donald # 3 - 58.60 : 8 = 7.325 or	\$ 732.50
12.68 : 4 = 3.17 or	317.00
	<u>\$ 1049.50</u>

one copy to E.O.C

Donald # 20	-	7.41 : 4	=	1.853	or	\$	185.30
Donald # 72	-	2.66 : 8	=	0.333	or		<u>33.30</u>
Total						\$	1268.10

It should be noted that the book cost of trenching is \$3684.65, but we would only get a credit of \$1268.10 according to the Yukon Schedule of Representation Work. 313

(4) ASSESSMENT WORK CREDIT.

In addition to the Trenching, we could claim credit for geological work and prospecting. According to the accounts \$3224.17 was spent for Prospecting & Geological work. How much credit we can get is of course not known at present.

(5) The next payment of \$30,000.00 is due on or before October 1st, 1955.

If it is decided to drop the option, this should be done in time, so that Dickson could record the work himself, leaving it to him which of the 80 claims he wants to retain. If we decide to carry on, some more work would have to be done and recorded before the first anniversary of the recording dates. The work done to date is not sufficient to keep all 80 claims in good standing (see clause 7 of the option agreement), unless we pay \$100.00 per claim for all claims, for which no assessment work credit can be obtained.

January 19th, 1955

G. Ehrlich

GE:JC

COPY

106D

WYLIE AND BATE
BARRISTERS AND SOLICITORS

P. O. DRAWER 1000
WHITEHORSE, Y. T.

Our File: 2-P-4

Prospectors Airways Company, Limited
Suite 1616,
44 King Street, West,
Toronto 1, Ontario.
Our Pl.

Attention: Mr. G. Ehrlich

Dear Sir:

Please refer to your letters of January 19th and 25th respectively. The information you requested is as follows:

Donald 1 - 8

Grant Nos. 62372 - 62379 inclusive
Located: July 23, 1954.
Recorded: At Mayo, August 12, 1954.

Re Seely Agreement - Rex 1 - 8

Grant Nos. 62565 - 62572
Located: By Robert Auston - December 2, 1954
Recorded: December 16, 1954.

Rex 9 - 16

Grant Nos. 62573 - 62580 inclusive.
Located: By Walter David - December 4, 1954.
Recorded: December 16, 1954.

Rex 17 - 24

Grant Nos. 62581 - 62588 inclusive.
Located: By Alan Kulan - December 5, 1954.
Recorded: December 16, 1954.

I trust this information is what you require.

Yours very truly,

WYLIE AND BATES,

Per: (signed N.V. K. Wylie.)

*file
3/22a*

file
y 3/22

A		N
✓	AD.	✓
✓	J.I.	✓
✓	G.C.A.	✓
✓	GE.	✓
✓	CLC.	✓
	...	
	P.P.S.	

313

August 25th, 1954.

Wylie and Bate,
Barrister,
Box 597,
Whitehorse, Y. T.

Attention: Mr. N. V. K. Wylie

Dear Sirs:

We understand from Mr. Ghisholm that you are or will be preparing option agreements in respect to the properties which have been acquired by him.

Attached hereto you will find our cheque in the amount of \$5,500.00 in order that you may effect the option payments which will be made under the agreements.

Yours truly,

PROSPECTORS AIRWAYS COMPANY, LIMITED

Secretary.

CCA:AJ
Enc.

4500 for
Dixon
1000
Luffe Johnson

August 16th, 1955

1 cc

313

YUKON EXPLORATION

While speaking to Charlie Coleman at North Hatley on the phone today he advised me that he had received a call from Chisholm confirming the closing of a deal on some claims in the Mayo District on the strength of a discovery by Gordon Dixon. Apparently it is a large gossan zone, presumably lead-zinc, and looks sufficiently impressive to make a down payment of \$5,000. The vendor wanted additional cash payments between now and next spring, but Charlie objected on the grounds that we could do very little work this season and there would be no further payments until October, 1955. This has apparently been consented to and Chisholm is staking additional claims surrounding the original eight staked by Dixon.

The terms of the deal are that any additional claims staked will eventually be incorporated in a company formed to acquire the ground.

Charlie said he spoke to Bill Row about this last week on the telephone but at the time the deal was only in course of discussion.



J. INGRAM

JI:JK

Stayed the night in Mayo and Sent Kulan back to organize a proper staking bee. Next day ment Dixon in Mayo and took off for his showing at Kathleen Lake. If its not a mine it should be. Heavy black siderite gossan for 1500 feet by three hundred and good quantity of sphalerite and galena float here and there at the foot of the gossan. The enclosed map is self explanatory. Stayed overnight at Kathleen and flew in the Mayo and then drove to Whitehorse same day. The rest I explained over the phone.

Yesterday after receipt of your wire I got Dixon to agree to your terms but could not reach you on the phone so signed him up. Wylie is mailing a copy of the agreement. I paid \$500.00 down and the balance when the grants come through possibly in a weeks time. Under the agreement I am to stake 72 claims in addition to the eight already staked and turn them into the deal. I then organized Dixon to this and he left yesterday to get ment from Dawson and carry out the work. I will send D'Aigle in to help him shortly.

Wylie and Bate
Barristers and Solicitors

N. Victor H. Wylie
Alan Bate

P. O. Box 597
Whitehorse, Y.T.

A		
	A.D.	
	J.I.	
	G.C.A.	A
	G.E.	
	C.L.G.	
	R.H.F.	
	R.D.S.	

Our File: 2-B-3.

August 25, 1954.

Mr. G. C. Andrews,
Secretary,
Prospectors Airways Company, Limited,
Suite 1616 - 44 King Street, West,
Toronto 1, Ont.



Dear Mr. Andrews:

I am enclosing Option Agreement between Gordon F. Dickson and Prospectors Airways Company Limited dated the 11th day of August, 1954. I understand from Mr. Chisholm that the staking of the additional seventy-two (72) claims is proceeding satisfactorily. When the additional 72 claims are staked and recorded it is our intention to have them transferred directly to the Company and then a Transfer to be signed by the Company to Gordon F. Dickson to be held in escrow until the Option is fully exercised or otherwise.

I will have to wait for Mr. Dickson's return to town before placing copy of the agreement in escrow, together with the grants for Donald 1 to 8, which are in my possession now. I also have a signed Transfer from Mr. Dickson to the Company, which will be placed in escrow with a copy of the Option Agreement and the grants.

The writer expects to be in Toronto during the second week in September and will endeavour to call at your office in the event that there may be matters which can be discussed.

Yours very truly,

WYLIE & BATE,

PER;

ENCL.
NVKW/OJ.

J 3/226

Report: re Donald Claims.

Kathleen Lake, Nava Mining District, I. T.

By

Lemar B'Aigle
January 1955.

Introduction:

The property, comprising 80 optioned claims, is located approximately 9 1/2 miles north of Kathleen Lake and approximately 41 air miles northeast of Keno Hill.

The staking, which was exceptionally well done, was supervised by Gordon Dickson, the vendor. All location lines were measured by tape, and picket line control was used through heavy buck-brush. A compass and tape survey of the entire group was also made. A map of this survey on a scale of 800 feet to 1 inch accompanies this report. Eight men were employed on various phases of the operation for a period of 39 days.

Picket lines were set up over a length of 800 feet at intervals of 300 feet, for control in mapping. The location line (claim line) which is a picket line across this claim, was used as a base-line and the section lines turned off this. Picket lines were also run on five adjacent claims at 500-foot intervals to give control for mapping.

Thirty-nine trenches in all were completed. Thirty-seven of these are along strike of the central gossan zone on claim Donald No. 3. Only two trenches were dug on the eastern gossan zone. These trenches vary in size but average about 5 x 4 x 3 feet in dimension. Bedrock containing highly oxidized sulphides was reached in nearly all trenches. Permafrost was encountered at a depth of four feet and the ground had thawed out to the maximum extent where this work was done. Unoxidized sphalerite and galena mineralization was reached in one trench only. The accompanying plan shows the location of the trenches and sampling on a scale of 100 feet to 1 inch.

cont'd

106D

Approximately ninety samples were taken for assay, which represents from two to four from each trench. Nearly all were from highly oxidized sulphide zones and no sample exceeds three feet in length. The results are tabulated in Appendix II.

Overburden was stripped in several localities to ascertain the dip of the mineralized shale horizon. A profile was made from an altimeter survey conducted in the immediate area of the central gossan showing.

Approximately 25 claims were mapped on a scale of 800 feet to 1 inch. The discovery claim was mapped on a scale of 100 feet to 1 inch around the gossan showing. Both maps accompany this report.

Geology and Structure

The claims are underlain by shale, limestone and ferruginous carbonate. It is believed that tight folding of the limestone and shale resulted in the formation of an intensely brecciated zone of shale which lies above the limestone and inside the fold. The brecciation is most intense around the apex of the fold and is cemented with calcite, followed by replacement with galena and sphalerite mineralization.

Some shearing and drag folding are observed locally in both the shale and limestone.

From bottom to top the sequence of formations is as follows: (1) shale; (2) limestone and shale; (3) ferruginous carbonate and shale. The breccia zone occurs at the apex of the fold in the top shale member.

No evidence of strong faulting was observed on the ground but some movement is indicated between the top shale and lower limestone members by the variable strikes and dips in the top shale. For this reason, thrust faulting is believed to have taken place between formations.

The dips in the uppermost shale horizon along the northeast limb of the fold are nearly all between 20 and 50 degrees. Because most of this formation along the southwest limb is obscured by overburden, very few dips and strikes could be taken. Some exposures along this limb, however, gave dips to the northeast. The structure is therefore described as a synclinal fold plunging to the southeast in the direction of the fold axis.

con't

The strike of the mineralization around the nose of the fold is resolved in two directions. One direction is along the northeast limb at nearly 70 degrees and the other is along the southwest limb at nearly 110 degrees. The dip of the mineralized zone along the northeast limb is probably very nearly 40 degrees to the southwest while that of the mineralized zone along the southwest limb is believed to be much flatter at about 20 degrees to the northeast.

Mineralization

Some specimens showing massive galena and sphalerite were obtained from the surface of the central gossan showing. An attempt to trench where these specimens were found was unsuccessful because of the slope and the broken nature of the rock. Oxidation extends well below the 4-foot depth reached in all trenches. Unoxidized samples of galena and sphalerite were obtained from one trench only and at two surface exposures.

Two grab samples of massive galena and sphalerite which ran 19 and 50 ounces respectively in silver were obtained within 100 feet of the contact. An assay of 0.6% cadmium was obtained in the sphalerite. A rusty specimen of limestone containing no visible mineralization, also taken near the contact, ran 0.44% Pb and 0.41% Zn. The mineralization may also extend into the limestone. Trenches 35 and 36 are the closest to the contact at approximately 100 feet and the values here are much better.

The gossan zones are composed of a continuous layer of coarse to medium-sized dark-brown pebbles. Trenching proved this material to be in place. The pebbly nature of the surface layer is the result of frost-heaving of the highly brecciated shale. Calcite is the cementing mineral and calcite mineralization is widespread in the shale member and can be traced for two claim lengths. One sample taken from near the eastern gossan zone shows a little chalcocite mineralization.

Conclusion

The results of the sampling indicate a lengthy zone of mineralization lying approximately 200 feet from the contact which contains values of around 3% zinc with low values in lead, silver and manganese.

The contact zone is completely covered with overburden, and it was not possible to put down trenches across it. Nearly all trenching was done on the gossan zones lying parallel to the contact and at a distance of around 200 feet from it.

HAILEYBURY, ONT., October 20th 1954 106D

BELL-WHITE ANALYTICAL LABORATORIES LTD.
~~**BELL-WHITE LABORATORIES**~~

ASSAYERS AND ANALYTICAL CHEMISTS

Certificate of Analysis

No. 6226

We have assayed 89 samples of Rock

Received October 15th and submitted by Prospectors Airways Company

Toronto, Ont. Limited.

with the following results:

A		✓
	A.D.	
	J.I.	✓
	G.C.A.	✓
	G.E.	✓
	C.L.C.	✓
	W.H.F.	
	R.D.S.	

Sample No.	oz. Au ton	oz. Ag ton	%Pb	%Zn
1000	-	.16	Nil	1.65
1001	-	-	Trace	3.71
1002	-	-	Nil	3.25
1003	-	-	.22	5.73
1004	-	-	Nil	3.55
1005	-	-	Nil	2.45
1006	-	.26	.01	2.55
1007	-	-	Nil	2.32
1008	-	Trace	Nil	2.22
1009	-	-	Nil	.30
1010	-	-	.27	.50
1011	-	-	.28	.40
1012	-	Trace	.84	.30
1013	-	-	.89	.35
1014	-	-	.35	.40
1015	-	.18	.05	.81
1016	-	-	.02	1.70
1017	-	-	.05	.05
1018	-	-	.31	Nil
1019	Nil	.48	.02	2.88
1020	Nil	.28	Trace	1.85
1021	Nil	1.02	.01	6.53
1022	Nil	1.70	.01	3.83
1023	Nil	1.24	.46	2.60
1024	-	-	Nil	.40
1025	-	-	Nil	.31
1026	-	-	Nil	Nil
1027	-	-	Nil	Nil
1028	-	-	Trace	Nil
1029	-	-	Nil	Nil
1030	-	-	Nil	Nil
1031	-	-	Nil	Nil
1032	-	-	.01	Nil
1033	-	-	Nil	Nil

Gold reported at \$.....per oz.

J. H. White
Assayer

HAILEYBURY, ONT., October 20th 1954.

BELL-WHITE ANALYTICAL LABORATORIES LTD.
~~BELL-WHITE LABORATORIES~~

106D

ASSAYERS AND ANALYTICAL CHEMISTS

Certificate of Analysis

No. 6226

We have assayed 89 samples of Rock

Received October 15th and submitted by Prospectors Airways Company Limited.
Toronto, Ont. with the following results:

Page - 2 -

Sample No.	oz. Au ton	oz. Ag ton	%Pb	%Zn
1034	-	-	Nil	.50
1035	-	-	Trace	1.03
1036	-	Trace	Nil	Nil
1037	-	-	Nil	Nil
1038	-	-	Nil	Nil
1039	-	-	Nil	Nil
1040	-	Trace	Nil	Nil
1041	-	-	Nil	Nil
1042	-	-	.03	Nil
1043	Nil	.50	Nil	4.93
1044	Nil	.66	.02	7.80
1045	Nil	.36	.02	5.33
1046	Nil	.80	.41	7.60
1047	-	-	.05	1.85
1048	-	Trace	Nil	.51
1049	-	-	Nil	Nil
1050	-	Trace	Nil	.40
1051	-	Trace	Nil	.41
1052	-	-	.60	2.88
1053	-	-	.04	1.13
1054	-	-	Nil	Nil
1055	-	-	Nil	.31
1056	-	-	Nil	.51
1057	-	.20	.04	.20
1058	-	-	Nil	.31
1059	-	-	1.53	2.16
1060	-	-	.88	1.54
1061	-	Trace	Nil	.31
1062	-	Trace	.03	Nil
1063	-	Trace	Nil	.51
1064	-	-	Nil	Nil
1065	-	Trace	Nil	Trace
1066	-	-	.05	1.02

Gold reported at \$.....per oz.

 Assayer

HAILEYBURY, ONT., October 20th 1954

BELL-WHITE ANALYTICAL LABORATORIES LTD.
~~BELL-WHITE LABORATORIES~~

106D

ASSAYERS AND ANALYTICAL CHEMISTS

Certificate of Analysis

No. 6226.....

We have assayed.....89.....samples of.....Rock.....

Received October 15th.....and submitted by.....Prospectors Airways Company
Toronto, Ont......Limited.
.....with the following results:

Page - 3 -

<u>Sample No.</u>	<u>oz. Au ton</u>	<u>oz. Ag ton</u>	<u>%Pb</u>	<u>%Zn</u>
1067	-	.96	1.15	Nil
1068	-	-	.85	Trace
1069	-	-	Nil	1.64
1070	-	-	Nil	.80
1071	-	-	Nil	3.18
1072	-	4.56	6.22	4.10
1073	-	-	.02	4.10
1074	-	-	.30	.41
1075	-	-	Trace	1.74
1076	-	-	Nil	.51
1077	-	3.96	3.11	22.60
1078	-	-	.44	25.78
1079	-	3.92	2.65	16.61
1080	-	-	Nil	.10
1081	-	Trace	Nil	Nil
1082	-	-	Nil	Nil
1083	-	Trace	Nil	Nil
1084	-	-	Nil	Nil
1085	-	-	Nil	.72
1086	-	Trace	.19	Nil
1087	-	2.84	7.77	Nil
D-1	-	-	.44	.41

Gold reported at \$.....per oz.

[Signature].....Assayer

106A

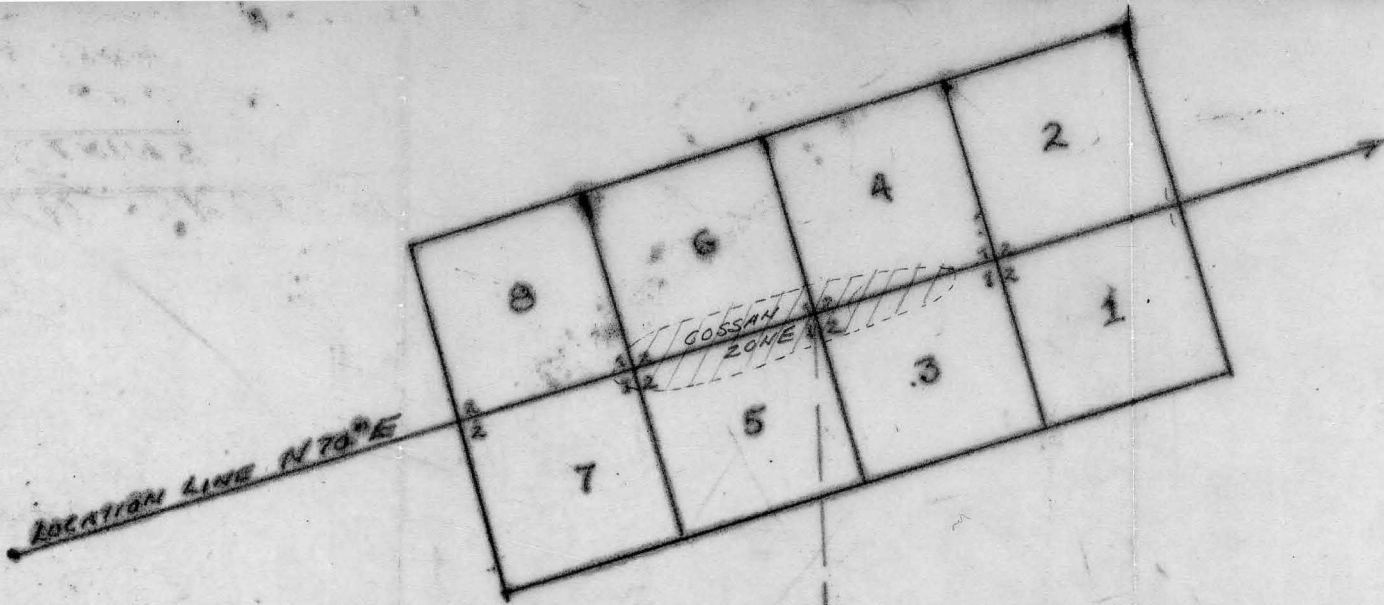

LOCATION SKETCH
DONALD CLAIMS
SHOWN BY G.F. DIXON
JULY 23, 1954.
LOCATION MAYO DISTRICT T.T.