

MINING CLAIM DONALD No 6

MINING CLAIM DONALD No 4



SAMPLING			
SAMPLE NUMBER	Pb %	Zn %	Ag OZ/TON
138	TRACE	4	TRACE
139	TRACE	1.4	TRACE
140	TRACE	51.7	24.2
141	29.7	23.2	8.6
142	TRACE	2.2	TRACE

MINING CLAIM DONALD No 7

MINING CLAIM DONALD No 3

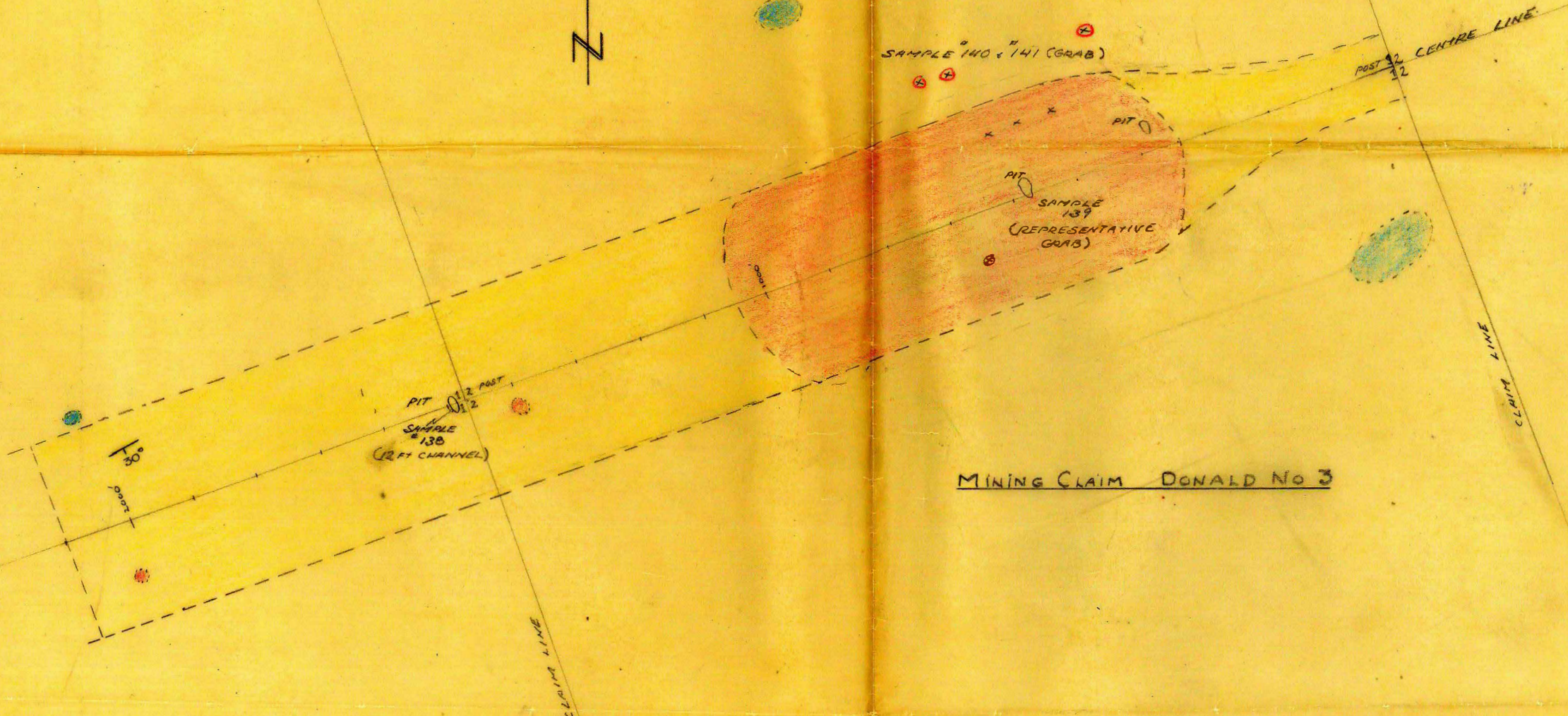

PROSPECTORS AIRWAYS CO. LTD.

DIXON OPTION - MAYO DIST. Y.T.

SCALE 1 IN = 200 FT

LEGEND

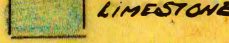
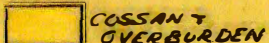
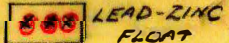
 EXPOSED GOSSAN	 LIMESTONE
 COSSAN OVERBURDEN	 LEAD-ZINC FLOAT

E-OCHISHOLM PENG. AUG 12, 1954.

005009

DIXON OPTION

The option on the eight Donald Claims located at Kathleen Lakes, 60 miles north of Mayo was signed by G.F. Dixon, Whitehorse and myself on behalf of the company, on August 11th. Our solicitor Vic Wylie drew up the option as outlined by the company solicitors in our Vangorda option. A copy will be mailed to you. Briefly the terms are as follows: \$500 cash on signing, \$4,500 when grants are issued (sometime within a week); \$30,000 Oct. 1st, 1955; \$65,000 Oct. 1st, 1956; \$100,000 Oct. 1st, 1957, and 12 percent of the vendors consideration. Seventy two additional claims are to be staked by us and included in the deal, making a total of 80 claims.

The location of these additional claims was laid out by me and Dixon has a party in there at present staking them. He should be finished on Friday and I will meet him in Mayo and send Daigle in to make a preliminary survey of the claims and try for some samples. We are supplying the operation by air from Dawson which is the nearest plane base. Pat Gallison operates from there. I have established credit at NC Co. in Dawson for supplies. For George's information I will charge everything in connection with this group to the Donald Claims. Daigle will be in charge of this.

I have nothing to add about the property further to my sketch and notes in my letter of August 12th with the exception of the fact that the gangue appears to be predominantly siderite. The blowpipe gives no trace of manganese in the oxidation although it appears very black. I am sending under separate cover a sample of the high grade float that ran 24 oz. of silver.

Please advise George to be ready to meet the \$4,500 payment due shortly on this property and the \$1,000 payment due on the Little Salmon option. My trust account will not stand the burden of these payments as well as current staking expenses. Both payments could be sent to Wylie and Bates against the transfers being placed in escrow or perhaps through the Bank of Commerce Directly in Whitehorse.