

105 D

005247

BOLD CONSTRUCTION LTD'S SUBMISSION,

AU PROPERTY NEAR WHITEHORSE, YT.

AUGUST 1982

AUG 3 1982

SM
pls send copy to Siroda
Drill
C.C. Shall be sent w. Siroda
Drill
mailed 8/3/82

BOLD CONSTRUCTION LTD.

302 Hawkins Street, Whitehorse, Yukon, Canada.
Phone: (403) 667-4373



TO WHOM IT MAY CONCERN:

BOLD CONSTRUCTION LTD. has an option on 50 mineral claims eleven miles N.W. of Whitehorse, accessible by two-wheel drive.

I recommend that a 380' adit at 3880' elevation be driven to intersect a gold-bearing vein which was intersected by diamond drill hole KT7 and KT3. No further diamond drilling is recommended at this stage because gold-bearing veins are narrow and high grade. The mineral claims are in very broken ground and drilling might destroy the veins and thus kill the property.

I have worked in the mining field for over 30 years in such occupations as diamond driller, underground miner, heavy equipment operator, mine electrician, mechanic, prospector, supervisor, exploration, etc.

I would option the property out, or work with someone. I have all the necessary underground equipment and cats, and this would enable the adit to be completed in 30 days. Work should be commenced before the snow flies!

If interested, please call or write.

Total cost for 380 feet of adit \$127,400

Mike Nichiporick
Mike Nichiporick

*For sale
surplus underground equipment
open pit*

4 Engersal Bond drill masters 6" hole

00N

100N

200N

300N

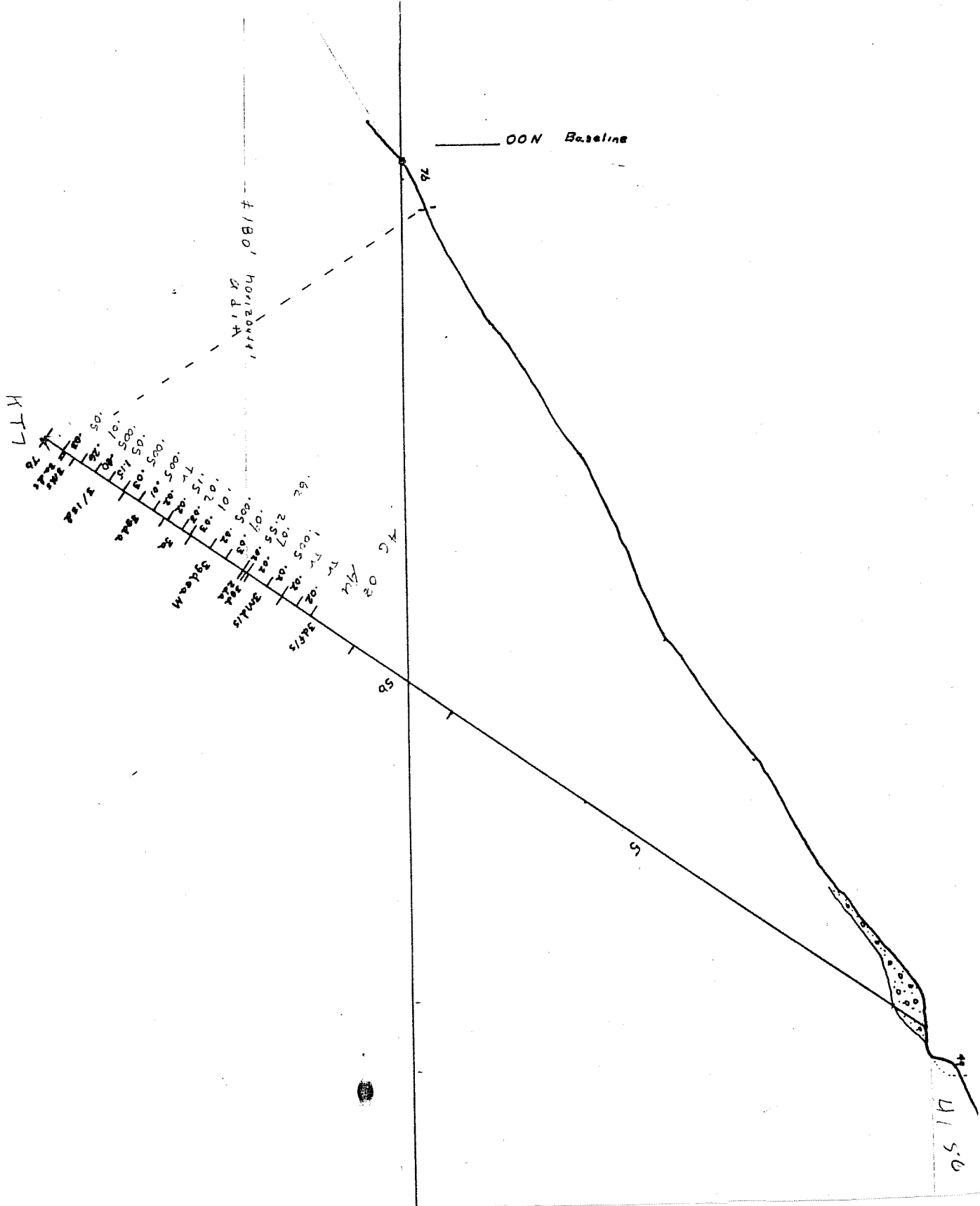

SUMMARY LOGS (Cont'd.)

<u>KT-2</u>	Lithology:	0	-	9	O.B.
		9	-	86.9	Limestone
		86.9	-	87.4	Actinolite skarn
		87.4	-	88.2	Grey marble
		88.2	-	89.1	Quartz magnetite skarn
		89.1	-	91	Diopside skarn
		91.0	-	104.4	Skarnified limestone
		104.4	-	105.6	Diopside skarn
		105.6	-	108.9	Skarnified limestone
		108.9	-	167.4	Silicate skarn
		167.4	-	168.2	Skarnified Limestone
		168.2	-	255.5	Limestone
		255.5	-	255.7	Magnetite skarn
		255.7	-	271	Skarnified quartzite

This hole intersected a considerable amount of skarn, but there were only traces of copper mineralization.

<u>KT-3</u>	Location:	8+00E	2+35N
	Bearing:	220°	
	Inclination:	-55°	
	Depth:	271'	
	Purpose:	To test magnetic high feature centered at 8E - 1N.	

Lithology:	0	-	11	O.B.
	11	-	138	Limestone
	138	-	139.6	Copper bearing actinolite skarn
	139.6	-	140.8	Skarnified limestone
	140.8	-	145.6	Limestone
	145.6	-	149	Serpentine skarn
	149	-	170	Limestone
	170	-	174.5	Actinolite skarn
	174.5	-	180.9	Limestone
	180.9	-	187	Magnetite skarn with traces chalcopyrite
	187.0	-	197	Copper bearing green skarn
	197	-	201.6	Green skarn
	201.6	-	212.5	Silicate skarn
	212.5	-	216.5	Skarnified quartzite
	216.5	-	218.2	Granodiorite
	218.2	-	224.8	Skarnified quartzite
	224.8	-	271	Granodiorite
	138	-	139.6	8.36% Cu 19.92 oz./ton Ag
	180.9	-	201.0	20.1' averaging 5.60% Cu, 7.9 oz./ton Ag, .26% WO ₃ , .03 oz./ton Au, .20% Zn
	180.9	-	187	1.03% Cu, 3.16 oz./ton Ag
	187	-	192	7.87% Cu, 8.96 oz./ton Ag
	192	-	197	11.55% Cu, 16.28 oz./ton Ag
	197	-	201	2.28% Cu, 3.44 oz./ton Ag

This intersection is probably from a pod of rich ore. It strongly suggests that the area should be further tested by diamond drilling.

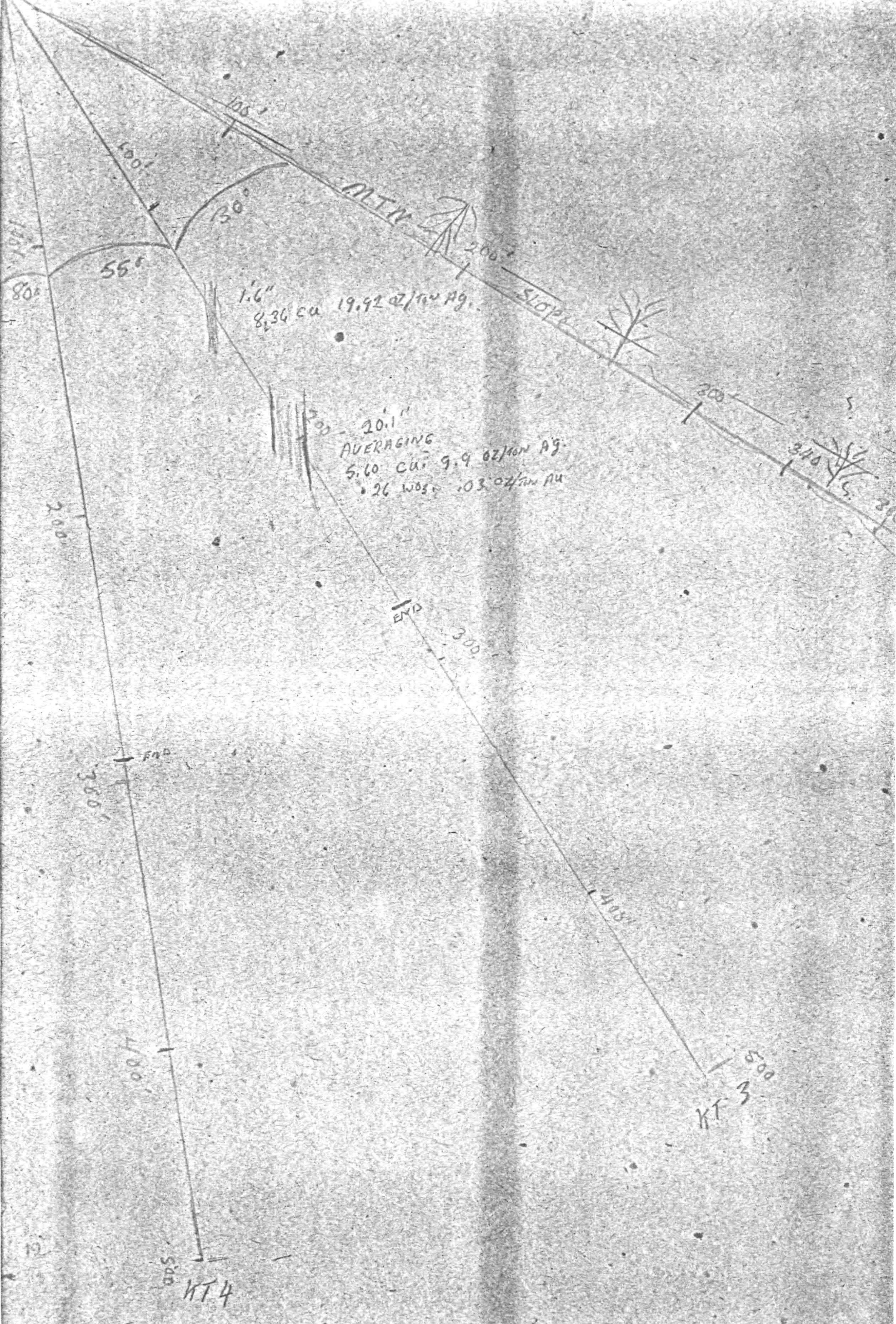

1.6"
8.36 cu 19.92 @/100 Ag.

20.1"
AVERAGING
5.60 cu 9.9 @/100 Ag.
• 26 nos. 103.04/100 Au

SCALE = 40' TO 1 INCH
M. NICHIPORICH

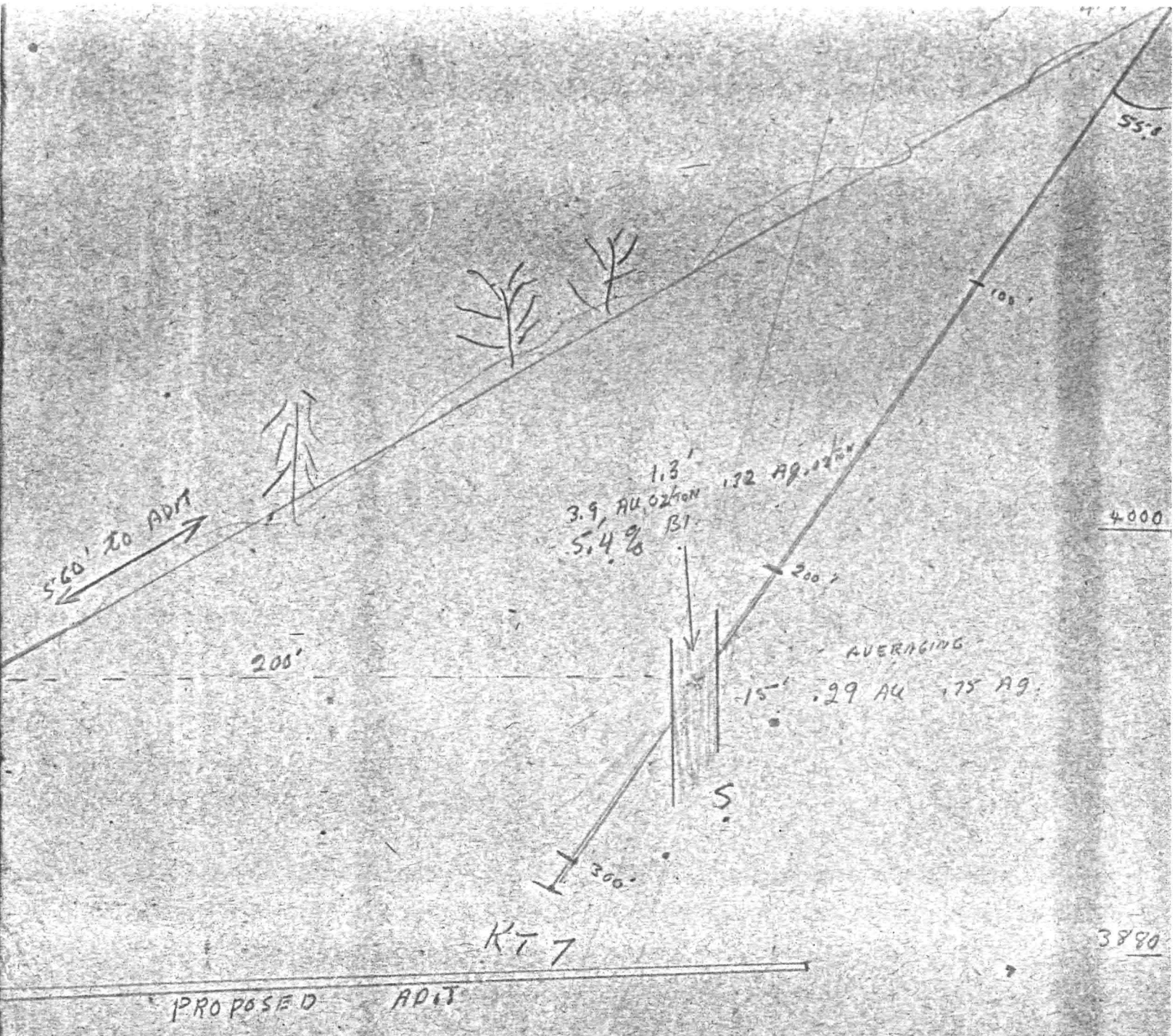

SCALE 40' TO 1 INCH

M. WICKP. RICH

MT 7

Sample No.	Hole No.	Footage		Length	Rec.	% Cu	Zn	Au/Ag	Pb	W03	Remarks
		from	to								
6710	MT7	218	222	5	5	.02	TV	TV	.02		
1			228	5	5	.02	TV	TV	.02		
2			233	5	5	.02	TV	.009	.12		
3		233	240.2	7.2	7.2	.02	TV	.01	.13		.35
4			241.5	1.3	1.3	.02	TV	2.55	.62		5.80
5			248	6.5	6.5	.03	TV	.09	.14		.15
6			253	5	5	.02	.01	.05	.02		.012
7			260.2	7.2	7.2	.03	.02	.01	.09		.105
8			263	2.8	2.8	.03	TV	.02	TV		1.90
9		263	268	5	5	.02		.15	TV		.63
6720			273	5	5	.02		TV	TV		.016
1			278	5	5	.01		.005	.03		.012
2			283.5	5.5	5.5	.03	TV	.005	.01		.012
3		283.5	288.5	5	5	1.15	.12	.05	1.39		.300
4			293.5	5	5	.40	.06	.005	.18		.015
5			298.5	5	5	.26	.03	.01	.24		.087
6726		298.5	304.8	6.3	6.3	.03	.02	.05	.09		.105
		233	248	15'	15'			.27	.18		.75
		283.5	298.5	15'	15'	.60					

* WHECM ASSAYS

TV
+
CUAG MINE WHSE

T
+
CUAG MINE WHSE

CHEMEX VCR
RWIMYAZTN ANDY BUREAU
GSFULTS 00ZJP 03 09 0714 -

PERCENT -
BI 5.40 TE 0.011 MO 0.16

OZ/TON
AG 0.32 AU 3.90

LLOYD TWAITES
CHEMEX LABS
NORTH VANCOUVER

SEPT 8/76 11.04AM