

**ROCK CODES**

20	2ACD	ribbon banded graphitic quartzite
21	2ACD	ribbon banded graphitic quartzite/basal horizon
22	2ACD	ribbon banded graphitic quartzite/middle horizon
23	2ACD	ribbon banded graphitic quartzite/upper horizon
30	2BCD	pyritic quartzite
31	2BCD	pyritic quartzite/basal horizon
32	2BCD	pyritic quartzite/middle horizon
33	2BCD	pyritic quartzite/upper horizon
40	2EC	semi-massive quartzose pyritic sulphides
50	2EF	pyritic massive sulphides
60	2EG	massive baritic/pyritic sulphides
70	2H	pyrrhotitic massive sulphides
80	1H/2ABCDEF	altered metabasite interbanded with ore
100	1D0/1C0/1CD	schist and phyllite waste
110	1D2/1E0	graphitic schist and phyllite
120	2L/1D1	altered schist and phyllite (HME)
130	1H/1F	altered metabasite
150	3A	basal graphitic unit of 3D Calc-silicate
160	3D	Calc-silicate
170	3D	BXA Calc-silicate breccia
180	10E	Biotite hornblende quartz diorite

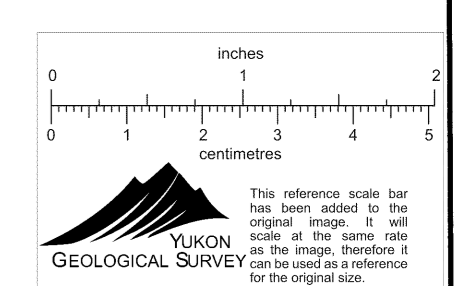
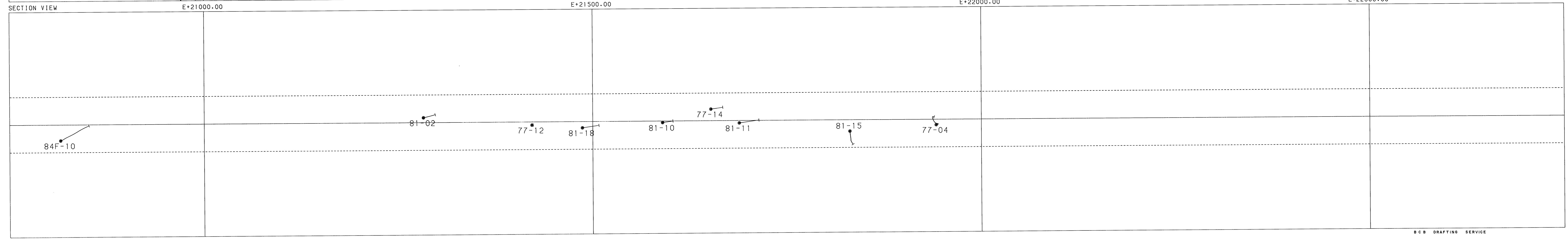

**CURRAGH RESOURCES**  
 FARO DEPOSIT  
 F0805 MODEL  
 VERTICAL X-SECTION 129+000  
 GEOLOGICAL INTERPRETATION  
 PLOTTED BY PC-XPLOR VERSION 1.00  
 FARO DRILL HOLES  
 GRADE HISTOGRAMS INDICATE % Pb + Zn  
 SECTION LOOKING NW  
 DATE : 21/ 8/1989 SCALE 1: 500