

CO-ORDINATE : Lat. 62° 22' N  
 Long. 133° 23' W

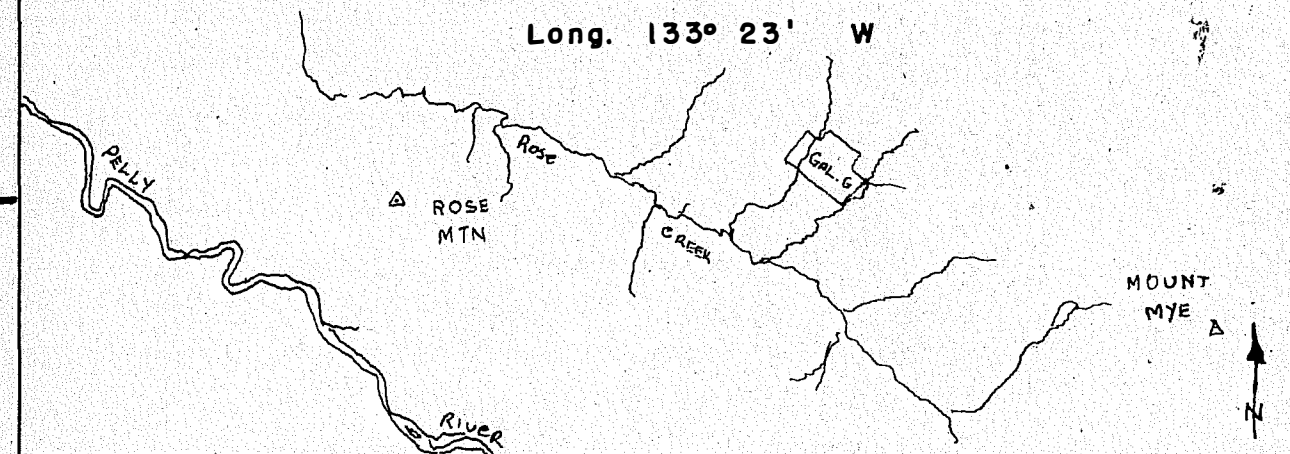

**PROSPECTORS AIRWAYS CO. LTD.**

GAL CLAIM GROUP

SCALE: 1" = 1500'  
 DATE : JULY 30, 1956.

105K/6  
 005814

COVERED BY  
 GEOCHEM. SURVEY

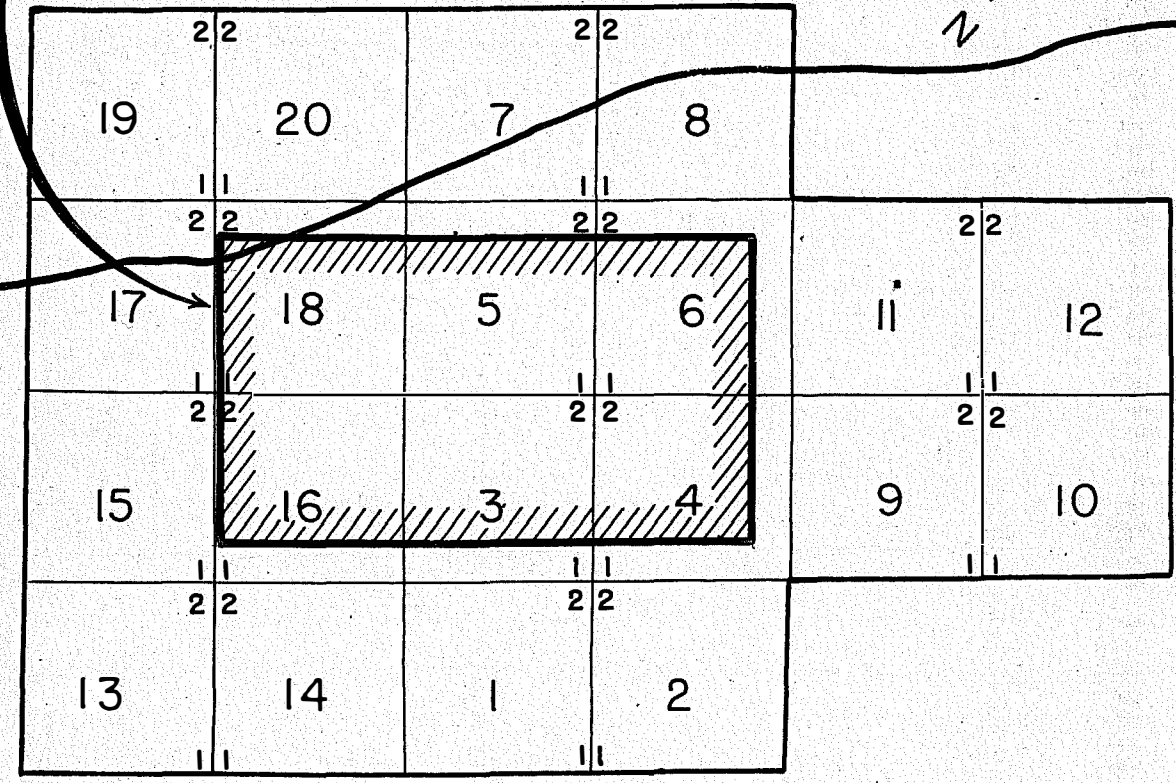

← 2 Miles to Rose Creek