

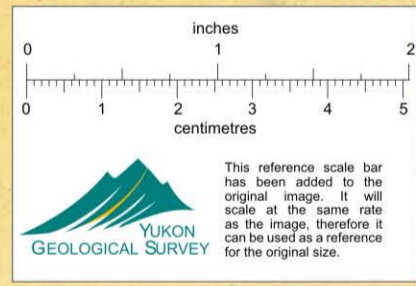

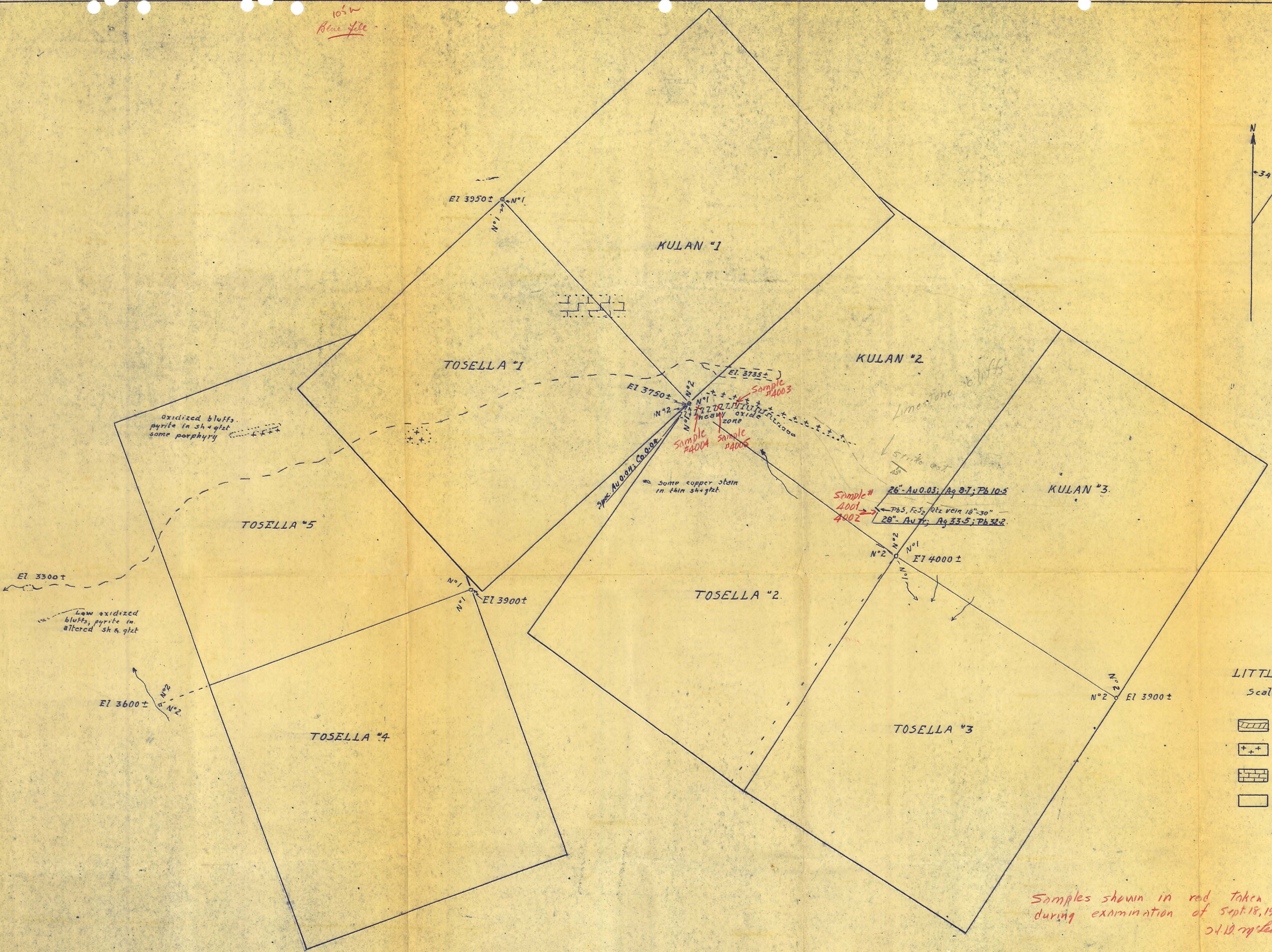

Little Salmon
105 W
Blue file

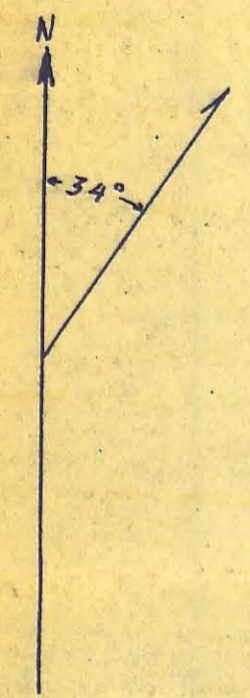

KULAN GROUP
LITTLE SALMON LAKE AREA, Y.T.
Scale 1" = 300' May 30, 1953

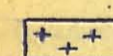
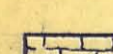
-  Heavy oxide zone
-  quartz porphyry
-  Limestone
-  Metamorphosed shale + fine qtz

Note: Compass & chain survey. Local magnetic variation corrections adjacent to oxide zone did not cancel out. Accept survey subject to this correction.

Samples shown in red taken during examination of Sept. 18, 1953
C.H. Wood