

*Pelly File*

006001

**KERR ADDISON MINES LIMITED**

(FOR INTER-OFFICE USE ONLY)

Mr. D.A. Lowrie

From W.M. Sirola

Regional Exploration Manager

Subject FINLAYSON LAKE PROJECT - Pelly Claims

Date September 29th, 1978

Accompanying this Memorandum are the following:

1. Plan showing anomalies encountered in the course of the recent Aerborne EM Survey.
2. Results of Aerborne Magnetic Survey.
3. Sketch showing Crone EM coverage to date.
4. Copy of Drill Log for KP78-1.

Regarding Aerborne EM Survey, please note that the red circles denote only those anomalies with amplitudes greater than ten and note that line #1 indicates high amplitude anomalies on the Shale Claims west of our west boundary. It is a little difficult to know how to connect the aerborne stuff but I understand from Fred Chow that most of the conductors located by ground survey are oriented approximately northwest-southwest, or eastwest in some cases.

The Aerborne Mag Survey indicates that the Permian lavas are located largely to the north of our claims but do appear to encroach on the northeast corner. There is a small magnetic feature at the intersection of line 5 and the EW tie line which we will have to investigate. There is also an EM feature (9 over 17) at this point and think it is close to the point where Alex Po located a high geochem reading in seep, and a subsequent soil sample in that vicinity ran Zn 1120 ppm; Pb 750 ppm.

In reading the Diamond Drill Log, it becomes obvious that the core recovery was abysmally poor, and it would appear that the rocks are very highly sheared and/or faulted. The section from 6.7 to 9 meters does contain 10% weathered brick-brown rusty spots which could have contained lead or zinc or both at one time. We are having these rocks analysed.

\_\_\_\_\_  
W.M. Sirola

COPY

Fred Chow

W.M. Sirola,  
Regional Exploration Manager

PELLY RIVER CLAIMS - Continuing Explorations

September 19th, 1978

We have reviewed the results of the Aerodat air-borne survey on the Pelly Claims including the new block recently staked on the east side. It would appear that the graphite units begin to proliferate and are probably very flat lying on the northwest portion of the claims and this poses some problems in connection with our continuing work program.

We could pursue EM anomalies on the ground until Hell freezes over, but I think it is vastly more important to complete the geochemistry over the known anomalies. I know that it was your intent to personally excavate some profile pits on the "B" anomaly and that the information from that work would be the guide for future soil samples. I do not know if you have managed to do this but I must stress again the importance of having this work done as quickly as possible. I realize that you have been very busy in recent time and our intent is to have Wayne Murton come up and give you a hand as soon as he has completed transferring the Aerodat data from the tapes to plan maps. What you should do in the meantime is advise me as to whether the profile sampling has been done and get samples in to the Lab as quickly as possible. Also, as I have stressed in the past, we are getting inquiries from Dave Lowrie on a daily basis regarding progress on the property. This means that you in turn are going to have to communicate more often with me, and it is usually easier for you to reach this office than it is for me to reach you. At one time the Whitehorse Radio Operations were very co-operative about relaying messages and advising when the channel was clear but that is no longer the case, and consequence, while a drilling program is going on you should call every day regardless of whether you have anything important to convey or not.

Not knowing what you have had the EM crews doing in recent time, I am forwarding two maps showing the extra Crone fill in work that should be done on the original Pelly Claims. These lines are shown in green on the enclosed maps.

.....2

COPY

Page 2.

I assume from some of the core angles that you have been reporting in the first drill hole that there are some fairly steeply dipping F1 layers which follow a serpentine track down the drill hole. Also, because the Crone EM work indicates a gentle dip to the north, I am assuming that much of the F1 has been transposed into F2 producing an overall gently dipping conductor. Conceivably, the EM17 work is picking up individual conductive bands of F1 but I do not know that for sure.

As the gravity work progresses, please let me know if anything interesting shows up. I assume that it will take Doug McQuarrie and his crew approximately one week to finish the work on the Pelly Claims.

Best regards.

---

W.M. Sirola

WMS:lg

Encls.

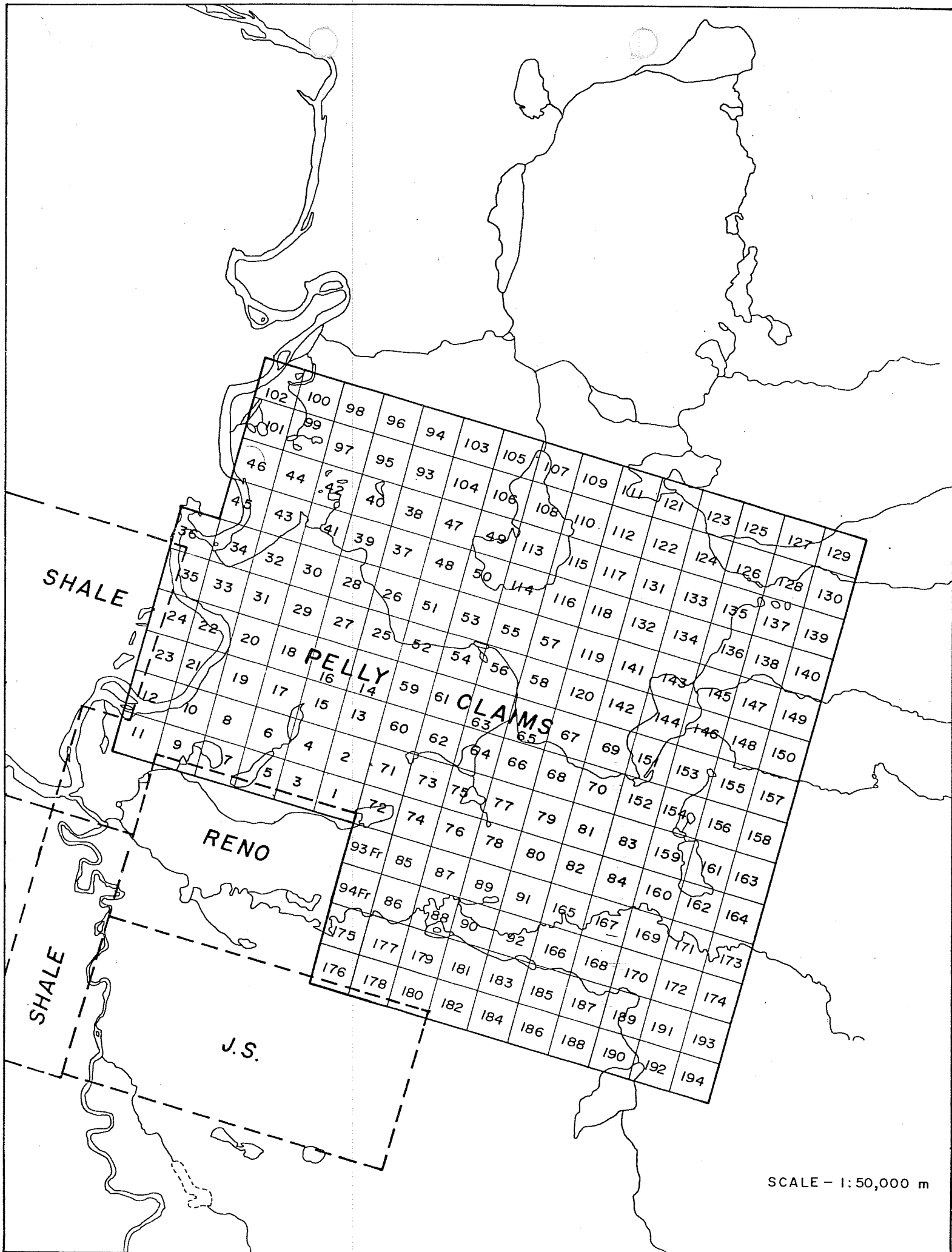

SCALE - 1:50,000 m

PELLY CLAIMS 93 to 120

101	102	103	104	105	106	107	108	109	110	111	112	113	114	115	116	117	118	119	120
101	101	86	96	48	103	107	109	109	110	111	112	113	114	115	116	117	118	119	120

PELLY CLAIMS



PELLY RIVER

MAP 105 G 14

CAMPBELL HWYWAY



BY \_\_\_\_\_ DATE \_\_\_\_\_  
CHKD. BY \_\_\_\_\_ DATE \_\_\_\_\_

SUBJECT \_\_\_\_\_

SHEET NO. \_\_\_\_\_ OF \_\_\_\_\_  
JOB NO. \_\_\_\_\_

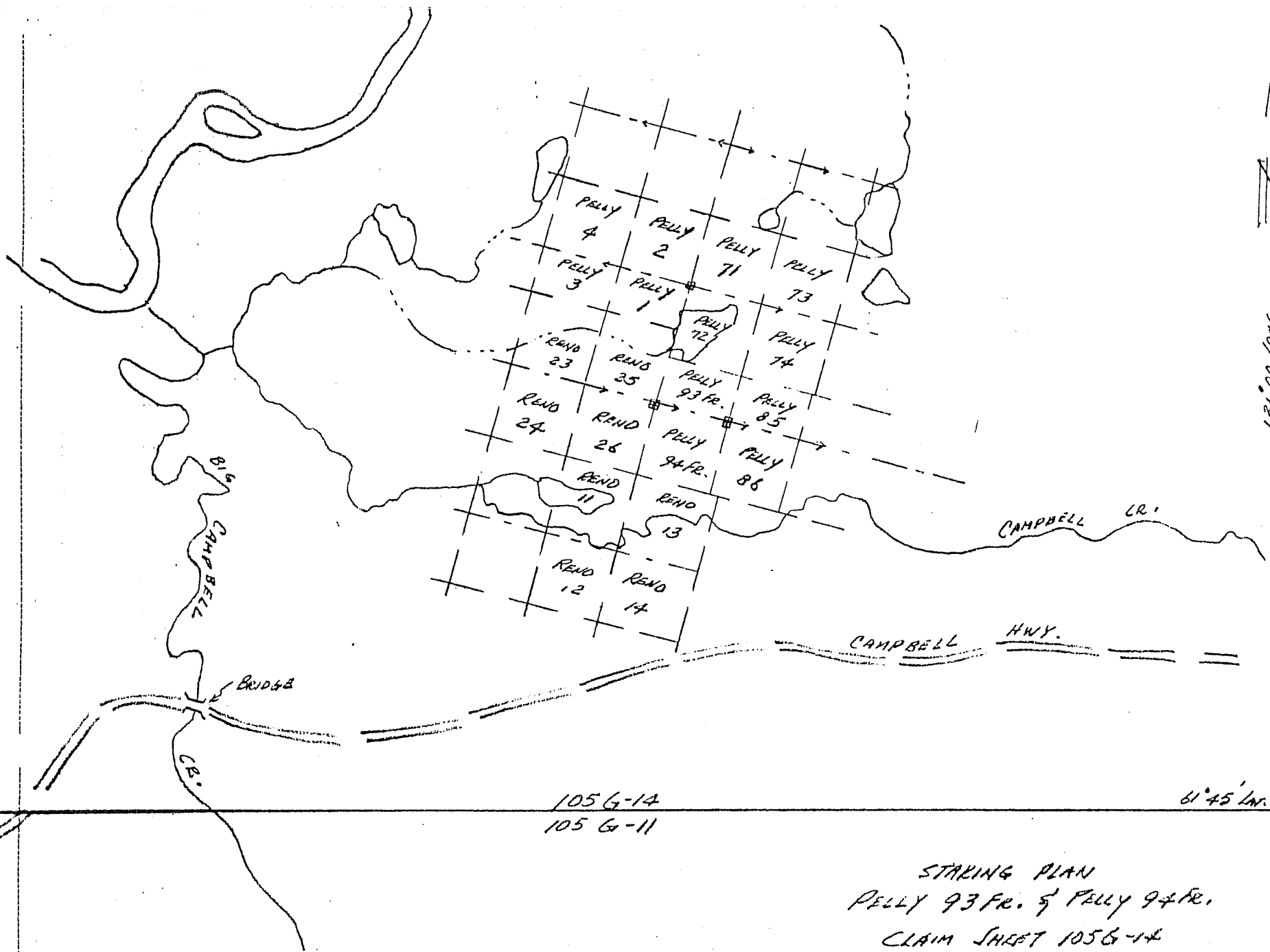

STAKING PLAN  
PELTY 93 FR. & PELTY 94 FR.  
CLAIM SHEET 1056-14  
WATSON LAKE MINING DISTRICT, Y.T.  
SCALE: 1" = 1/2 MI.  
JUNE 29, 1978 F. CHOW.

PELLEY RIVER

PELLEY CLAIMS

MAP 105 G 14

PELLEY CLAIMS 93 to 120

101	102
99	100
97	98
95	96
93	94
103	104
105	106
107	108
109	110
111	112

113	114
115	116
117	118

119	120
-----	-----



CAMPBELL HWY

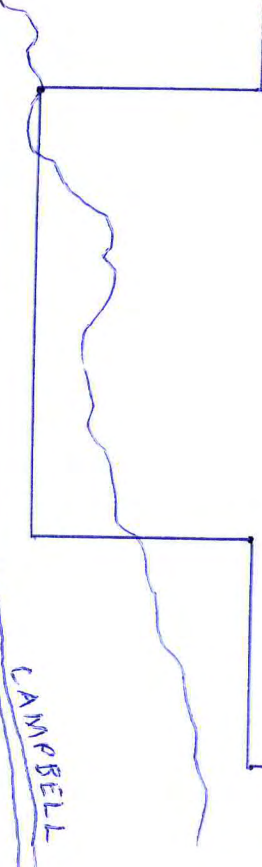

PELLY CLAIMS - # 121 to 194  
 Staked Aug 28th + Aug 29th

PREVIOUSLY STAKED  
 PELLY CLAIMS

REND  
 CLAIMS

121	122	123	124	125	126	127	128	129	130	131	132	133	134	135	136	137	138	139	140	141	142	143	144	145	146	147	148	149	150	151	152	153	154	155	156	157	158	159	160	161	162	163	164	165	166	167	168	169	170	171	172	173	174	175	176	177	178	179	180	181	182	183	184	185	186	187	188	189	190	191	192	193	194
-----	-----	-----	-----	-----	-----	-----	-----	-----	-----	-----	-----	-----	-----	-----	-----	-----	-----	-----	-----	-----	-----	-----	-----	-----	-----	-----	-----	-----	-----	-----	-----	-----	-----	-----	-----	-----	-----	-----	-----	-----	-----	-----	-----	-----	-----	-----	-----	-----	-----	-----	-----	-----	-----	-----	-----	-----	-----	-----	-----	-----	-----	-----	-----	-----	-----	-----	-----	-----	-----	-----	-----	-----	-----



CAMPBELL HIGHWAY

105 G 14  
 105 G 11

105 G 15  
 105 G 10

PELLY CLAIMS 93 to 120

101 ✓	102 ✓	99 ✓	100 ✓	97 ✓	98 ✓	95 ✓	96 ✓	93 ✓	94 ✓	103 ✓	104 ✓	105 ✓	106 ✓	107 ✓	108 ✓	109 ✓	110 ✓	111 ✓	112 ✓	113 ✓	114 ✓	115 ✓	116 ✓	117 ✓	118 ✓	119 ✓	120 ✓
-------	-------	------	-------	------	------	------	------	------	------	-------	-------	-------	-------	-------	-------	-------	-------	-------	-------	-------	-------	-------	-------	-------	-------	-------	-------

PELLY CLAIMS



PELLY RIVER

MAP 105 G 14

CAMPBELL HWYWAY