

106/10

006050

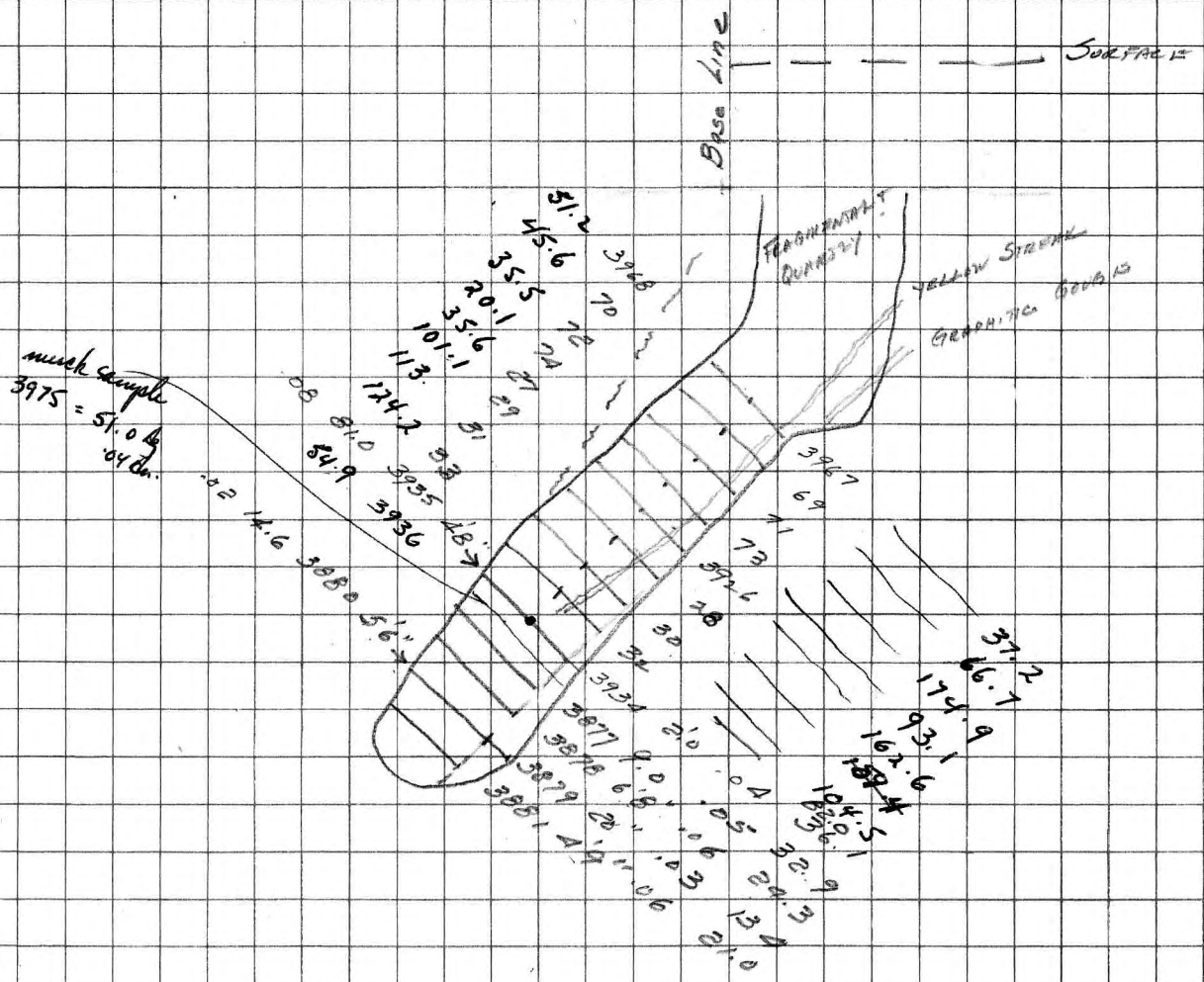

PESO SHAFT  
 N.E. WALL  
 1" = 10'

Peso Silver

	<u>Acc</u>	<u>Ag</u>	<u>Average</u>
{ 3967	.06	37.2	44.2
{ 3968	.06	51.2	
{ 3969	.12	66.7	56.2
{ 3970	.04	45.6	
3971	.10	174.9	105.2
3972	.04	35.5	
3973	.14	93.1	56.6
3974	.01	20.1	
3926	.10	162.6	99.1
3927	.06	35.6	
3928	.10	159.4	130.2
3929	.08	101.1	
3930	.10	104.5	108.7
3931	.08	113.0	
3932	.08	82.0	103.1
3933	.14	124.2	
3934	.04	36.1	58.6
3935	.08	81.0	
3936	.06	54.9	
3877	.05	32.9	
3878	.06	24.3	6'8"
<del>3879</del>		14.2	7'
3881	.06	21.	4'9"

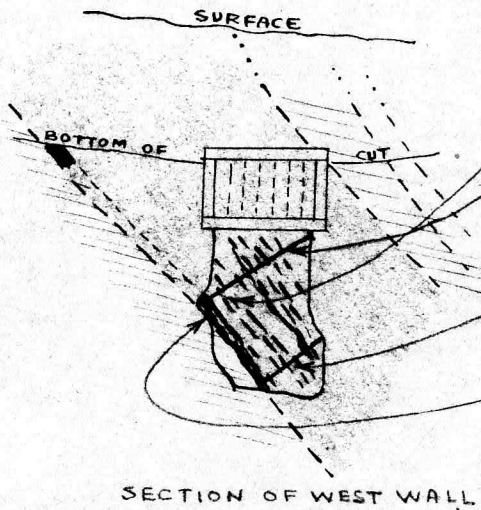



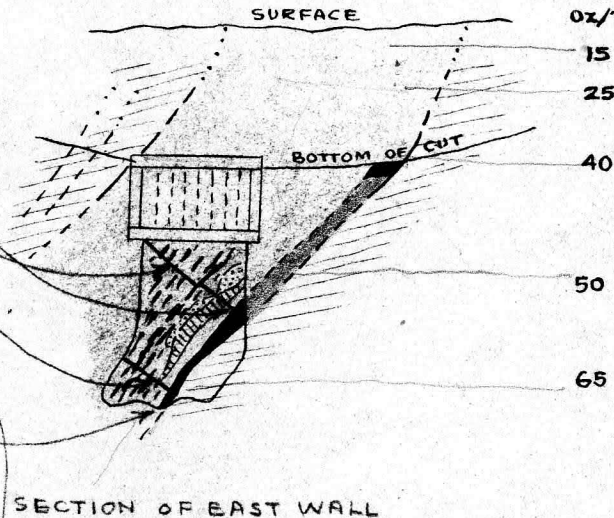

WIDTH FT.	GOLD oz/TON	SILVER oz/TON	LEAD %	ANTIMONY %
4	.04	74.0	2.29	2.04
3	.04	60.7	0.84	1.60
3	.06	34.3	4.74	2.16
3.5	.04	28.2	0.74	0.64
3.5	.08	79.3	3.19	2.43
4.5	.04	53.9	0.82	1.66
GRAB	.20	72.3	6.04	5.13
"	.30	91.0	4.30	3.59
"	.20	169.4	11.91	4.48



AVERAGE SILVER oz/TON

15
25
40
50
65

-  VEIN
-  HIGH GRADE OXIDES
-  QUARTZ
-  SCHIST

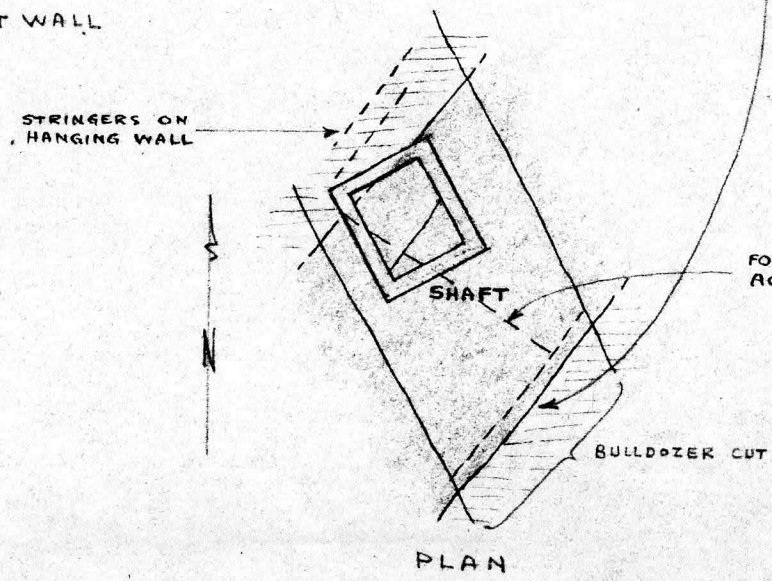

FORMER SAMPLING 40 OZ SILVER ACROSS 11 FT @ BOTTOM OF CUT

**NO. 1 SHAFT  
PESO SILVER MINES**

1 IN. = 10 FT.  
JULY 27, 1961 A.E. AHO

*a/201*