

Box 4940
Whitehorse, Yukon
Y1A 4S2

November 16, 1985

Dave Arscott
Kerr Addison Mines Limited
703 - 1112 West Pender St.
Vancouver, B.C. V6E 2S1

Dear Dave:

Just a short note re the following:

The enclosed samples taken by Mike Phillips may be of interest to you. Although the values are low, I consider it a new find and will pursue it further next spring.

I also found some very live quartz in a trench I put down just above the road on ETZEL #35 (not assayed yet).

Also staked two very interesting claims (Wedge 16 and 17) straddling the upper part of Discovery Creek. The claim inspector was out and put the okay on both claims.

Trust I will see you and Ray at the Whitehorse Geoscience Forum December 2nd, 3rd and 4th. There are more than 25 papers, mostly on the Yukon.

Best regards,

Gordon F. Dickson

GFD:jld
Encl.

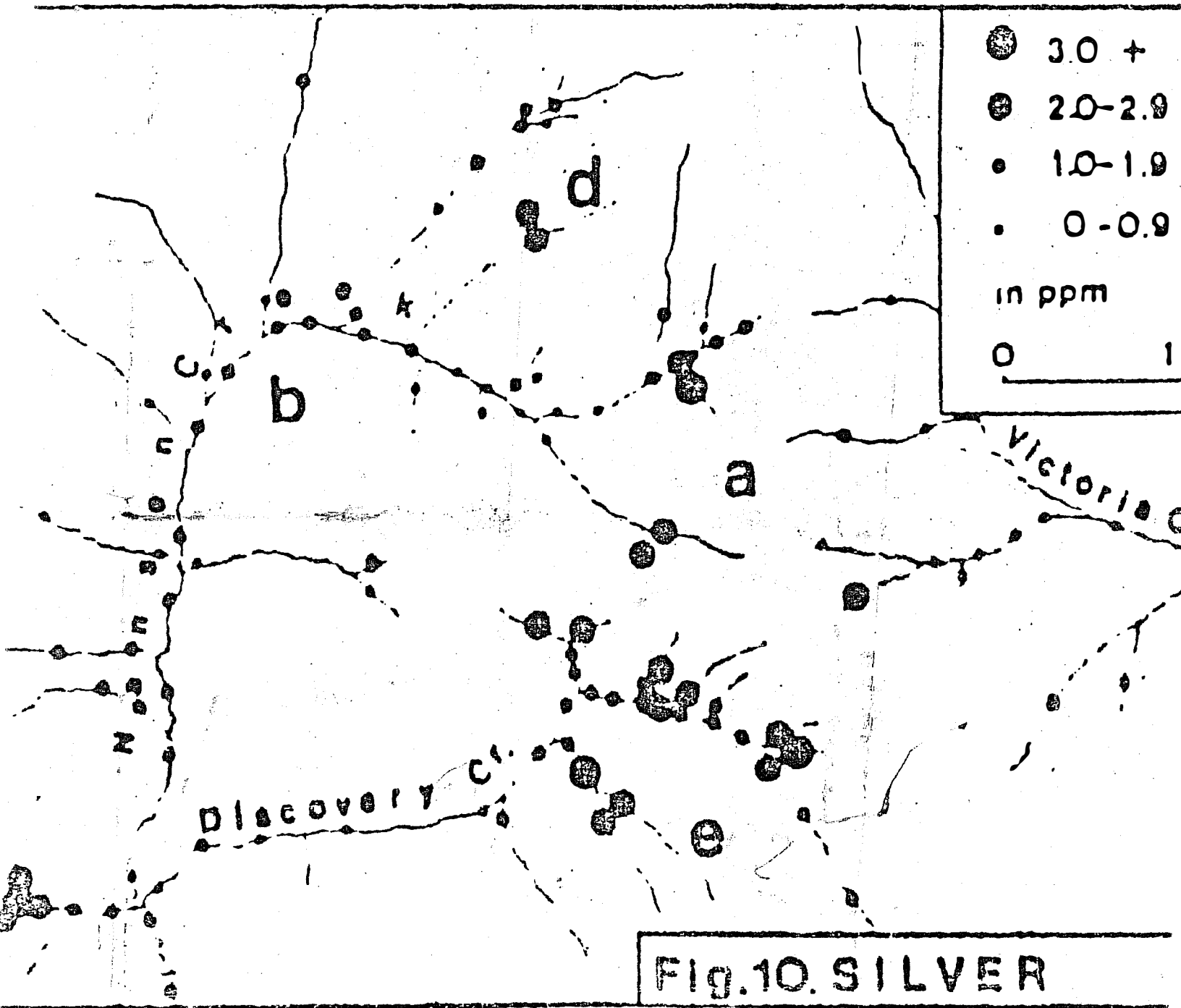
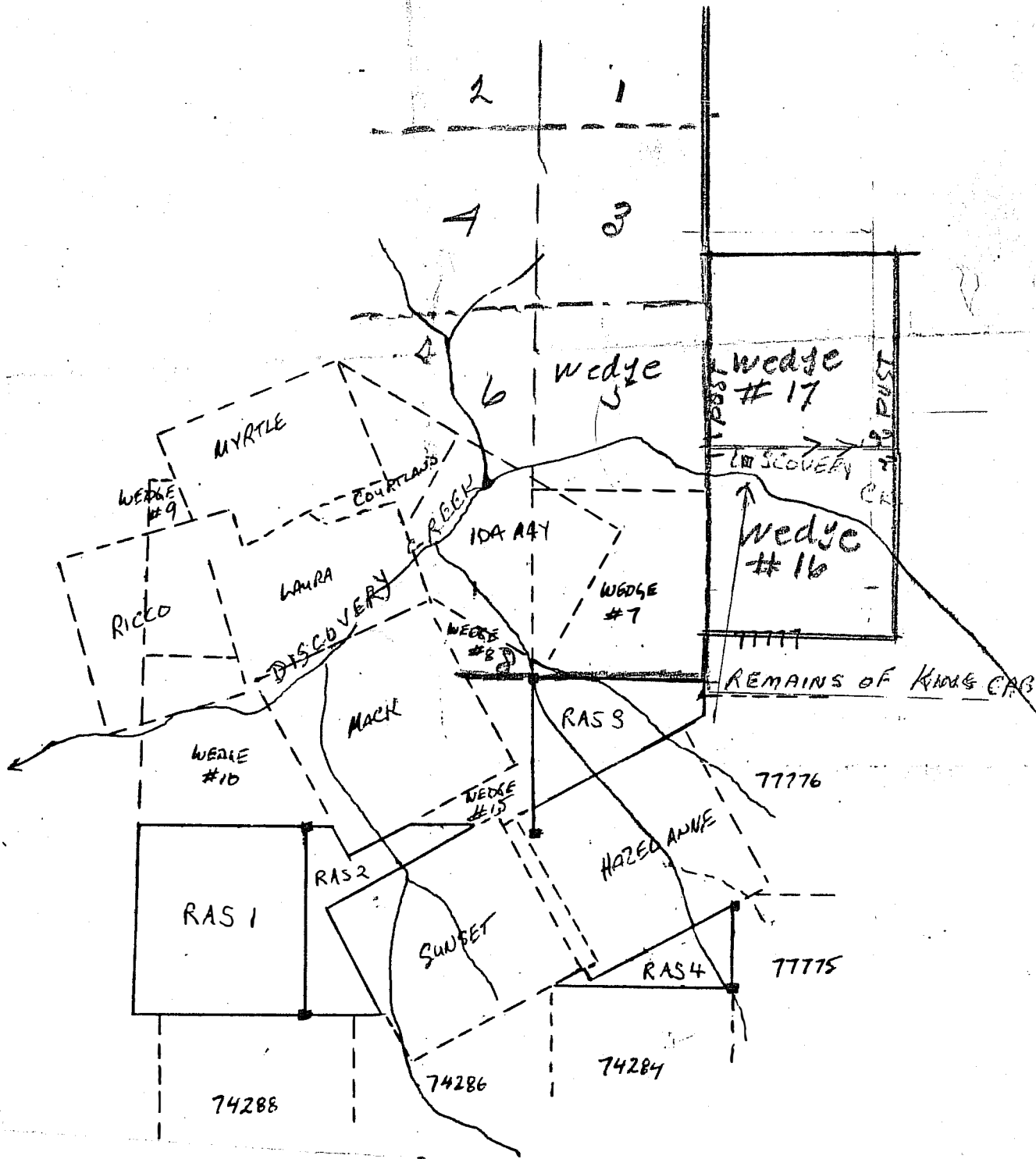

FIG.10. SILVER



RE: WEDGE NO. 16 AND 17.
 CLAIMS STAKED AS SHOWN ON SKETCH OF
 "ME" GROUP BY WILLIAM DUNN, MINING ENGINEER
 ACCOMPANIED WITH AFFIDAVIT FOR CERTIFICATE
 OF WORK, AUGUST 10, 1973.

Etsel 25 claim (Sec 50K, plan)

Dickson has cut a number of long trenches in this area. Most did not reach bedrock because of permafrost. Dickson interest in this particular area was ^{sparked by} quartz vein float which he found in a drainage ditch which runs from the Klaza River to East Fork Nansen Creek. The ditch is up to 6 ft deep where I saw it. He cut a ~ 20 metre trench next to the ditch where he found the quartz vein float. This trench was into bedrock. Bedrock is a 3 metre wide altered zone striking about 345° cutting hornblende biotite granite. In the field I thought the altered zone was an altered porphyry dyke but subsequent binocular examination suggests the altered zone may not be a porphyry. The altered rock shows soft white to light gray quartz sericite alteration with variable patchy secondary silica. Vein like quartz up to 3cm wide is occasionally seen. The rock is vuggy and up to 3% fine disseminated limonite is common. Traces of arsenopyrite in fresher rocks is sometimes seen. The alteration quartz flooding & quartz-sericite is similar to that seen on the Webber. I have sent 4 samples to Clamey by Special Delivery for gold, silver analysis. Details on these samples is as follows

oz/t Au.	oz/t Ag.	Sample No	Details
446 .010	.05	H 43446	Quartz vein float found in drainage ditch by Dickson; Gray vitreous quartz, minor vuggy & occ quartz crystal lined. 1-2% disseminated limonite (arsenopyrite?) and < 1% fine disseminated arsenopyrite
447 .028	.80	H 43447 & 448	Porphyry? - altered granodiorite - strong quartz sericite alteration with ~ 20% blue silica. 1-3% disseminated limonite. Blue silica with strong limonite on fracture, arsenopyrite
448 .022	.14		
449 .010	.07	H 43449	3 cm wide gray vitreous quartz; weakly wavy quartz sericite alteration on one edge of Fair fracture limonite

I did NOT find the TRUE QUARTZ VEIN I WAS LOOKING FOR. (see photo)