

313

PRO RATA TO 7 CLAIMS OF REX GROUP

WHITE RIVER

WHITE RIVER

TO ALASKA
HIGHWAY (APPROXIMATE) 3 MILE FROM
WHITE RIVER BRIDGE TO DISCOVERY.

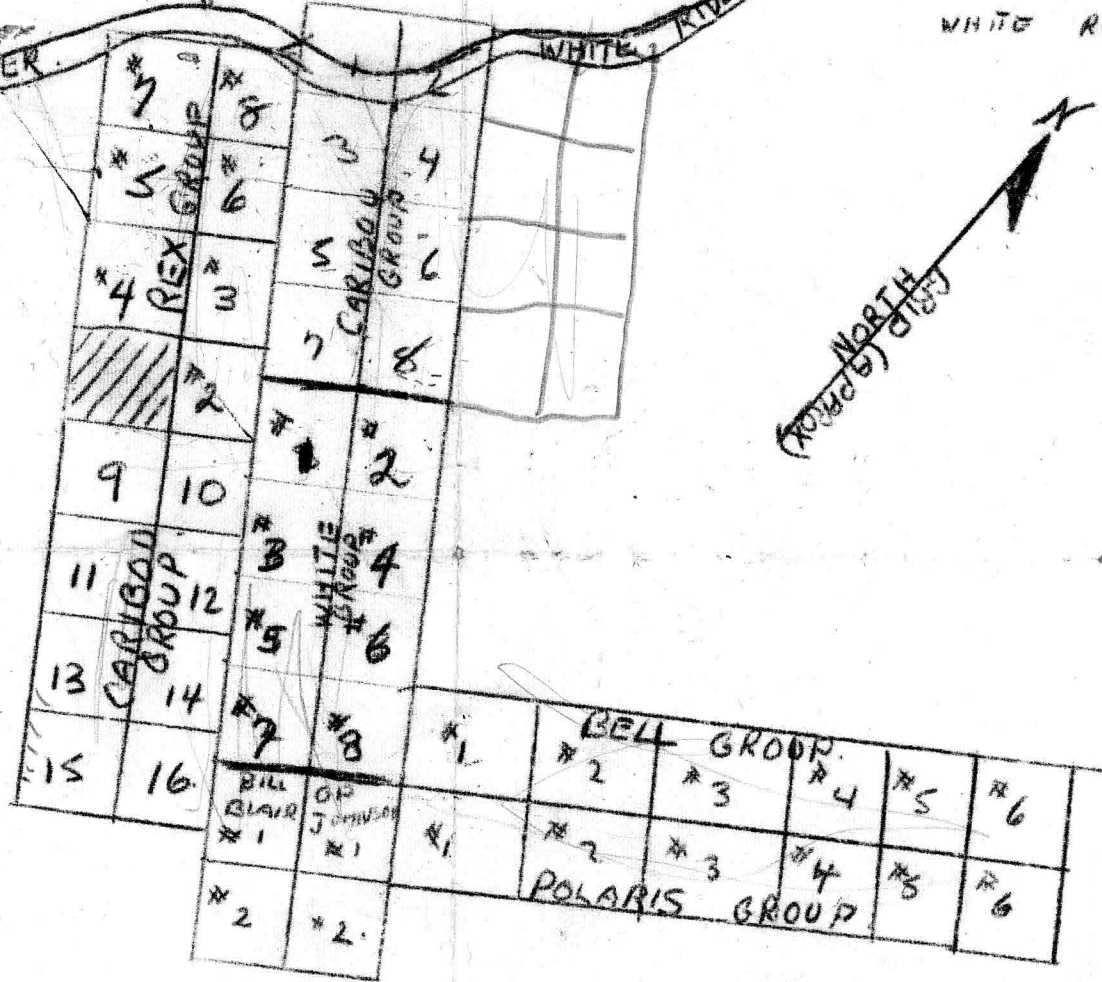

DEAL		
4,000	CASH	1400
12,000	OCT 1/53	4200
1	OCT 1/54	6300
2,000	OCT 1/55	7700
24,000	OCT 1/56	8400

84,000 + 1090 VENDORS PRO RATA
ON 49 CLAIMS

T.H. ANDERSON
BOX 303
WHITEHORSE.

REX GROUP (2 CLAIMS)
Geo. KARENS

BELL GROUP (6 CLAIMS)
JOE PARADIS

POLARIS GROUP (6 CLAIMS)
DON TAYLOR
(INSPECTOR)

39
12
51