

COPY

D. A. Lowrie

W. M. Sirola

006673

Won Property, Dawson Mining District 11541-13

March 25, 1980

Herewith Tom Neeland's compilation of all of the data on the Won property. There are certain enigmas to be resolved in any future work that might be considered:

I.P. surveys indicate a northsouth trending zone in Triassic volcanics. Since the normal trend of the volcanics would be northwesterly, the I.P. results are disconformable with normal structure. The high P.F.E.'s are probably caused by pyrite and pyrrhotite on foliation planes in a possible shear zone.

Tom mentions the "Won Stock" in his report. This should not be construed to represent a separate intrusion because the Triassic batholith in which it occurs may have a variable composition on the Won Claims. This does not rule out the possibility of a separate stock but simply points out that it "ain't necessarily so".

Restivity measurements do not unfortunately indicate a large altered zone within the intrusive rocks and this to some extent militates against the possibility of a large porphyry-molybdenite deposit.

On the plus side of the ledger 2 drill holes (2 and 4) collared in biotite granodiorite indicate increasing molybdenum values with depth. This is to some degree an encouraging sign.

I will call Walter Sellmer at the Amax office and whoever is in charge of the Amoco office to determine their degree of interest in this project.

WMS/tv

Encl.:

BY _____ DATE _____
 CHKD. BY _____ DATE _____

SUBJECT Won claim group
Dawson Mining District Y.T.

SHEET NO. _____ OF _____
 JOB NO. _____
NTS 115-1-13



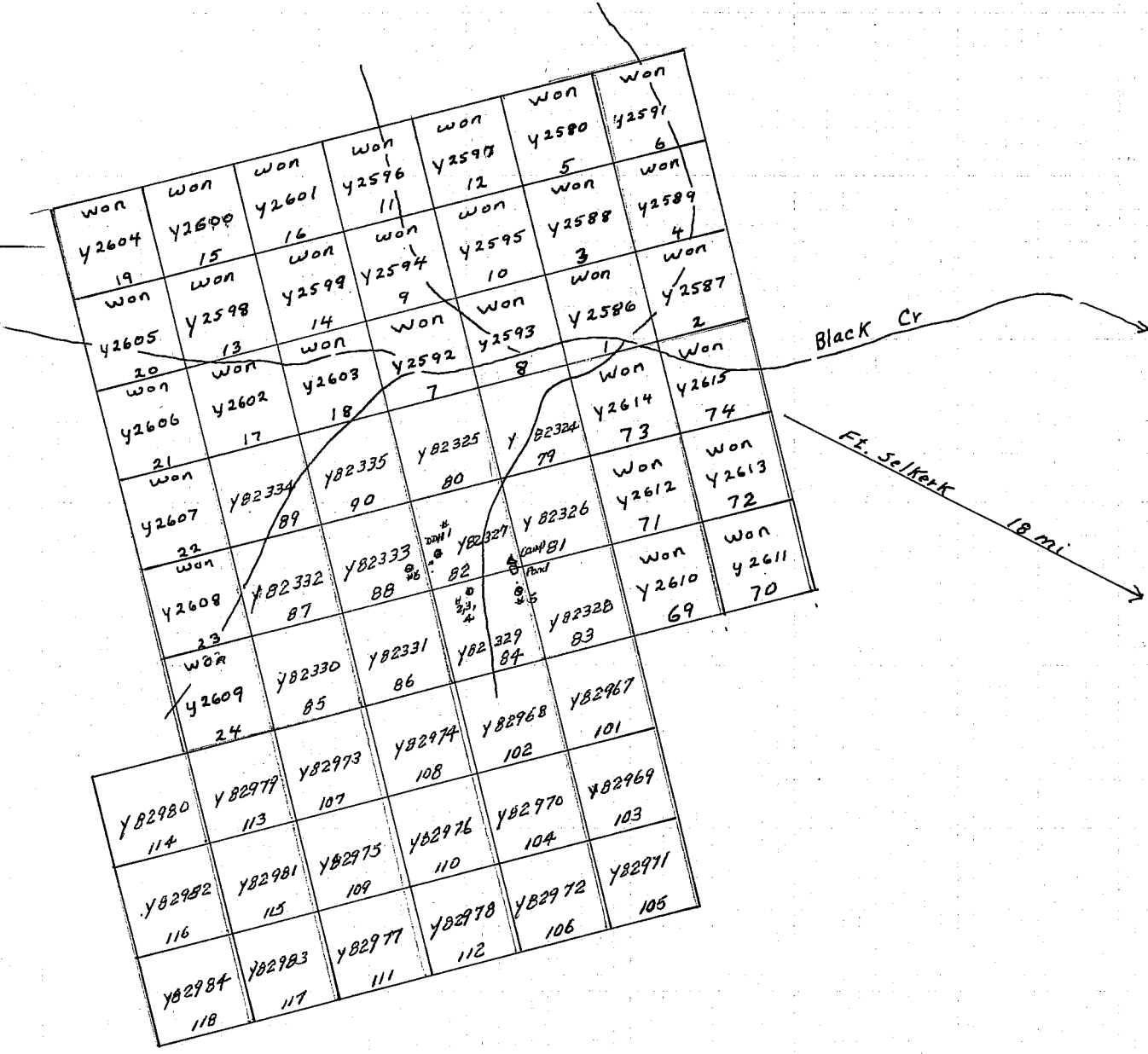

137° 55' 00"

62° 53' 00"



Scale 1" = 1/2 mi.

Revised Feb. 2/80 J.C.

-  Cu Anomaly
-  Mo Anomaly
-  D.P. Hole
-  Mag High (ground)
-  Mag Low (ground)

137° 55' 00"

62° 53' 00"

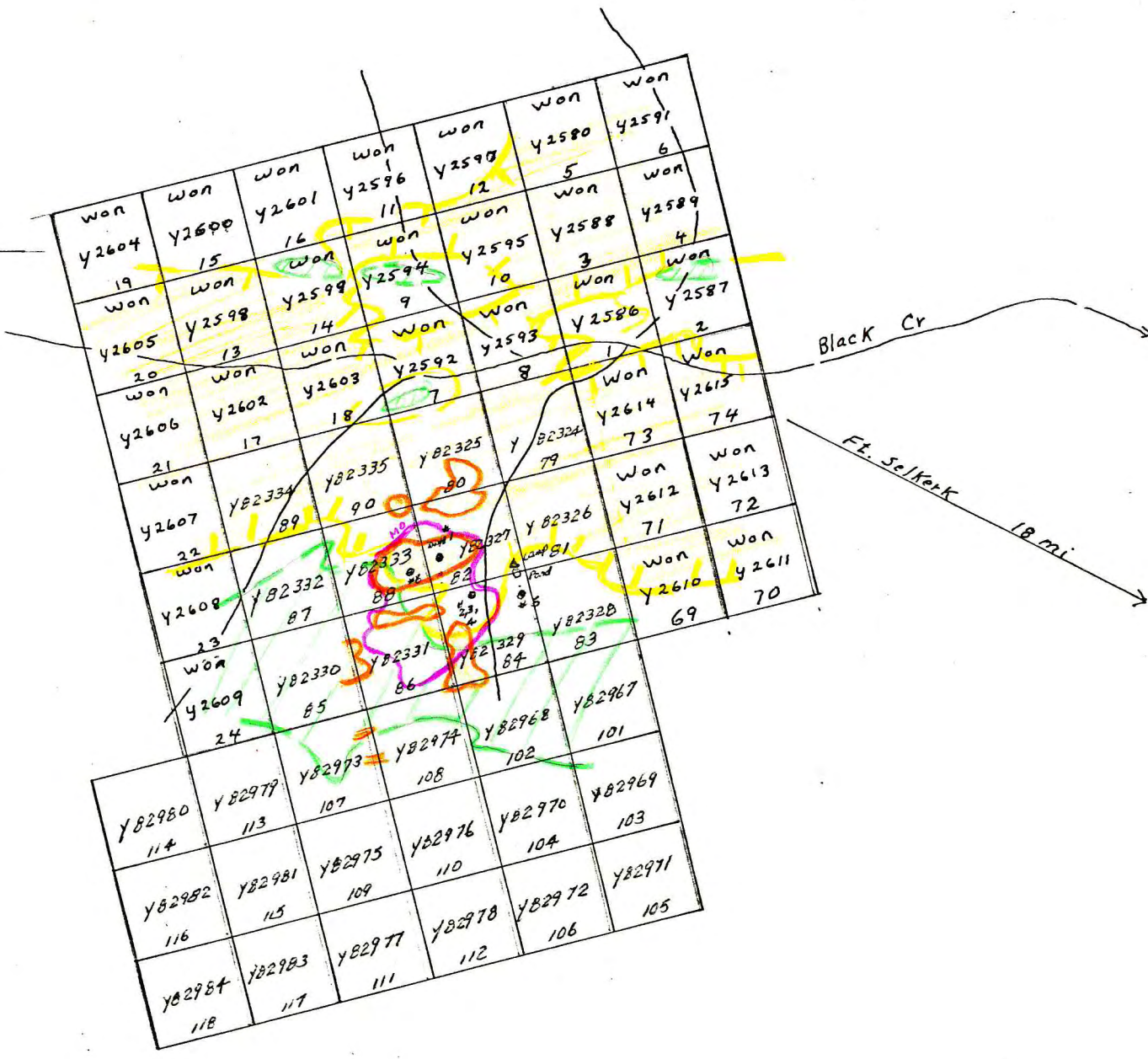

Scale 1" = 1/2 mi
 Revised & Drawn Feb 1980 JLB

22

137° 55' 00"

62° 53' 00"



Scale 1" = 1/2 mi

Revised Draft Feb 7/80 22

WON GROUP, Minto Project, Y.T.

Feb. 8/80 JHW

Re. Assess Won Moly-Copper Property

OBJECT : ① Potential or Value if any.
② Further Work by Ken recommended?
③ if ②-No, ①=yes, Option to other party?

Dead Line : ① Won claims (colored light blue on sketch)
expiring May 14/80 (anniv date 30Apr/80)

RECOMMEND :

Data Available :

1. Fed. Gov't. Aerial mag.
2. Ken's ground mag
3. " I.P. :
4. " soil + silt geochem.
5. " D. Drilling

COPY

Glen M. Hogg

W. M. Sirola

Minto and Yukon River Projects 1974
Review of Werner Gruenwald Report

31st December 1974

Werner has done a very good job on the Minto project which includes the Won claim group, but has not documented the Yukon River project too well. By "documented", I mean that he only has one map in the back of the report on which he shows the streams that were silted. He should have at least one other map which would show all of the sample locations, and the values thereof, regardless of whether these were anomalous or not. As we get time, we will assemble such a map for inclusion in the report.

On the Won claim group, we have a situation wherein the soils are anomalous in both molybdenum and copper and these soil anomalies are superimposed on a magnetic low which, in turn, probably indicates an altered intrusive. It is unlikely that we are dealing with a satellitic intrusion, but more probably we are dealing with a large intrusion, lightly capped by Triassic volcanics.

I see little alternative to drilling a few holes into the geochemical highs and equipment for this work could probably be hauled in with a Cat, some time in March.

WMS:1mp

enc:

Dec 23/74.

Bill:

Here is a 1"=4mi map showing two possible routes that could be taken by a cat or Abdiwell to the Won claim anomaly.

I trust there are not too many errors in the writing of the report - I was a bit rushed for time.

Werner.

P.S. Have a happy holiday.

"Where everything is"

Dec 23, 1974.

1. T.P. instrument is at Sabre Electronics (all set to go whenever needed).
2. Claim tags for Won #101-118, airphotos for Win, Won & Yukon River project are on top of airphoto cabinet.
3. All originals and copies of the 1974 report (Minto & Y.R.) are in the Minto project flat file.
4. All other pertinent data for this summers project is in the appropriate cabinet.
5. Rock samples are in front of John's office.
6. The defective generator (Honda) and two PRT-20's are labelled in warehouse.
7. All tents used during the summer are put away as is most of the base camp kitchen gear.
8. Confirmation of assessment work and transfers are still being awaited from the Mining Recorder in Dawson.
- 9.