

MAC 1-8 - N. ISAAC  
 MAC 9-12 }  
 and } - H. BIERSTEDT  
 25-28 }  
 MAC 29-36 - C.L. SMITH

MAC  
GROUP

FOR:  
ALFRED  
MYRA

6 1/2 MI. TO  
 KALZB. MT.  
 MAC #13, #14, #15, #16,  
 #17, #18, #19, #20  
 TO BE STAKED  
 BY A.J. MYRA  
 MAC #21, #22, #23, #24  
 TO BE STAKED  
 BY S. SCURVY  
 MAC #37, #38, #39, #40  
 TO BE STAKED BY  
 S. SCURVY  
 MAC #41, #42, #43, #44  
 #45, #46, #47, #48  
 TO BE STAKED IN  
 NAME OF  
 T. BOLSTON

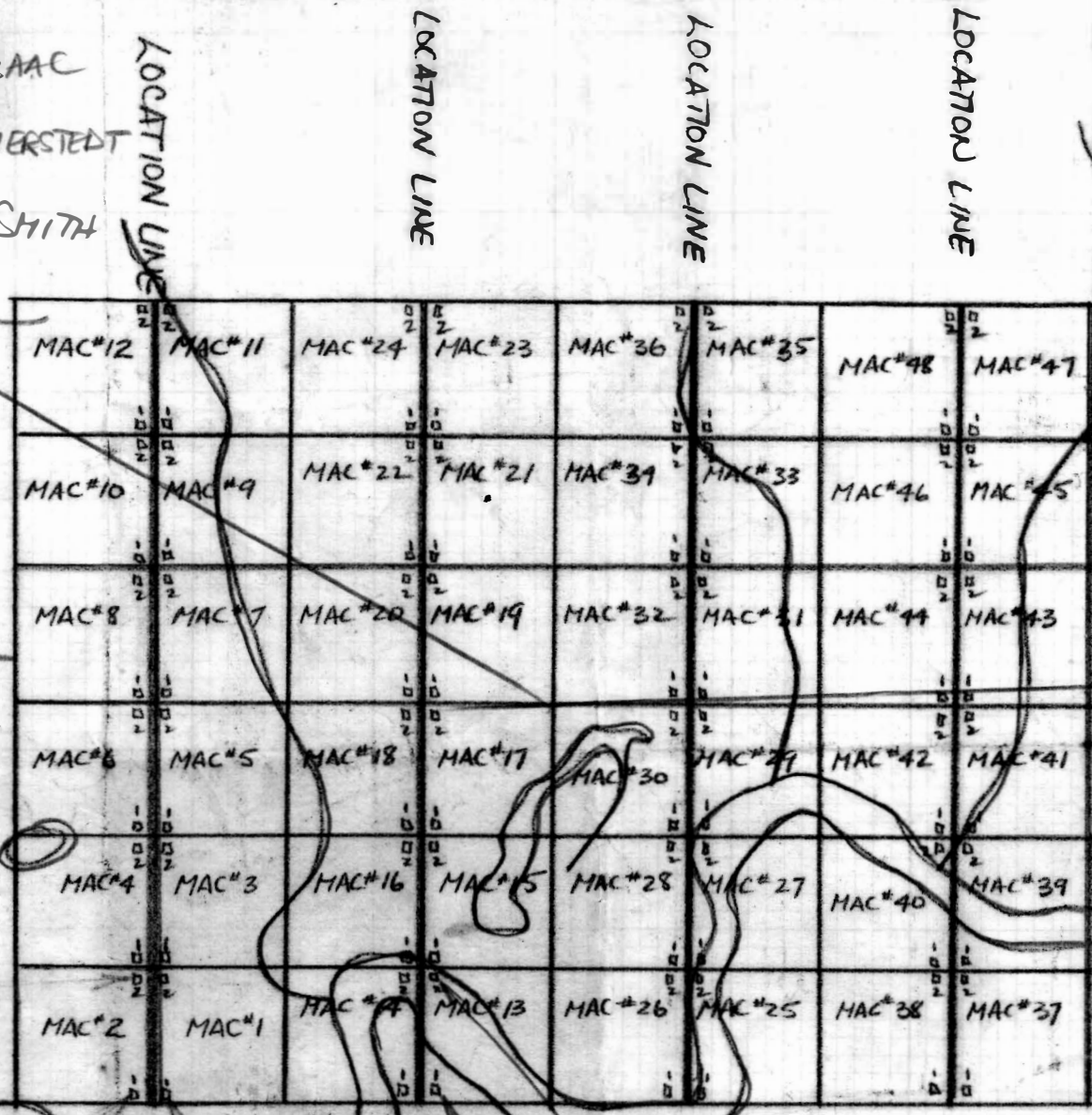

6 MI. TO  
 LONE MT.

NO. 2  
 MAC #2  
 MAR. 19, 1966  
 N. ISAAC

NO. 1  
 MAC #2  
 N.  
 O.L.  
 1500'R  
 MAR. 19, 1966  
 N. ISAAC

NO. 1  
 MAC #1  
 N.  
 1500'R  
 O.L.  
 MAR. 19, 1966  
 N. ISAAC

NO. 1  
 MAC #13  
 N.  
 1500'R  
 O.L.  
 MAR. 19, 1966  
 A.J. MYRA

NO. 2  
 MAC #13  
 MAR. 19, 1966  
 A.J. MYRA

MAC #29-36  
 C.L. SMITH

SCALE: 1" = 2000'

TRUE  
 NORTH

TRUE  
 NORTH

007325

COPYED BY CLARENCE TOLSON