

Sept 6/83  
SHEET 105-M-13

LATITUDE 63° 45' To 64° 00'  
LONGITUDE 135° 30' To 136° 00'

MOUNT HALDANE

CANADA  
DEPARTMENT OF NORTHERN AFFAIRS AND NATIONAL RESOURCES  
NORTHERN ADMINISTRATION AND LANDS BRANCH  
MINING AND LANDS DIVISION

SCALE: 1/2 MILE TO 1 INCH

FT. 0 1000 2000 3000 4000 5000 6000 7000 8000 9000 10000

ISSUED UNDER THE AUTHORITY OF THE MINISTER  
OF  
NORTHERN AFFAIRS AND NATIONAL RESOURCES

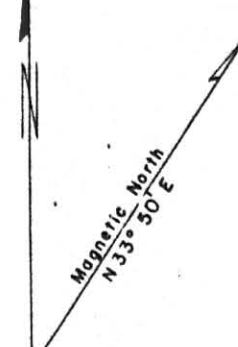

105-A-1	106-D-4	106-D-3
105-P-16	105-M-13	105-M-14
105-P-9	105-M-12	105-M-12

NOTICE

THIS MAP IS ISSUED AS A PRELIMINARY GUIDE FOR WHICH THE DEPARTMENT OF INDIAN AFFAIRS AND NORTHERN DEVELOPMENT WILL ACCEPT NO RESPONSIBILITY FOR ANY ERRORS, INACCURACIES OR OMISSIONS WHATSOEVER.

26	NOV 74	105-M-13	105-M-13
2	NOV 72	105-M-13	105-M-13
3	AUG 72	105-M-13	105-M-13
27	AUG 68	105-M-13	105-M-13
29	JULY 68	105-M-13	105-M-13
18	MAR 59	105-M-13	105-M-13
29	OCT 58	105-M-13	105-M-13
	12 MAR 79	105-M-13	105-M-13

