

CRONE GEOPHYSICS LIMITED

MISSISSAUGA, ONTARIO

007659

PHONE 416
270-0096

3607 WOLFEDALE ROAD
MISSISSAUGA, ONTARIO
CANADA

December 7, 1970.

Mr. W. M. Sirola,
Kerr Addison Mines Limited,
Suite 405,
1112 West Pender Street,
Vancouver 1, B. C.

Dear Bill,

RE: Lyn Group Gravity Survey
by Overland

The Lyn group survey has a total elevation difference of approximately 1000' with a corresponding gravity change of 40.00 milligals. Considering geological conditions a gravity change of 10 milligals could be accepted as reasonable - thus there is an apparent error in the order of 30.00 milligals. It is the large magnitude of this discrepancy that makes it difficult to pin down.

With the elevation survey, the elevations would have to be reduced by 1/2 ie. 500' instead of 1000' to bring the survey into line (-500' x .060 equals -30.00 milligals). This would be a difficult error to make and a review of the survey notes shows that check stations were taken confirming that the survey is correct.

Other correction factors that could be in error such as the assumed densities or terrain corrections (not applied) are of no help because they could only produce a maximum change of 3' or 4 milligals.

I therefore suspect the only factor left - that is the gravity meter itself. I wired Texas Instruments re check up and calibration and obtained a calibration constant .08474. Note that Overland used .08351 but this difference would only account for 2% ie. .80 mg out of 40.

continued

RECEIVED
DEC 17 1970

KERR ADDISON MINES LTD.

PAR.....

Why was correct scale constant not used? We are looking for something drastically wrong and I wonder if the meter was damaged before the survey?

The notes are being returned under separate cover.

Best regards

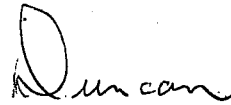
A handwritten signature in cursive script, appearing to read "Duncan".

J. Duncan Crone.

JDC:gs
encl. T.I. Wire

4100'

4050'

4000'

3950'

3900'

3850'

3800'

3750'

3700'

LINE 174 WEST.
Looking west,
ANOMALY - "D"

742 mg/l.

741 mg/l.

740 mg/l.

739 mg/l.

738 mg/l.

737 mg/l.

736 mg/l.

735 mg/l.

3 mg/l.

2 mg/l.

1 mg/l.

BOUGUER GRAVITY

SURFACE ELV.

RESIDUAL GRAVITY

CREEK
↓

SCALE 1" = 200'

45 35 25 15 0 1N 2N 3N 4N 5N 6N 7N 8N 9N 10N

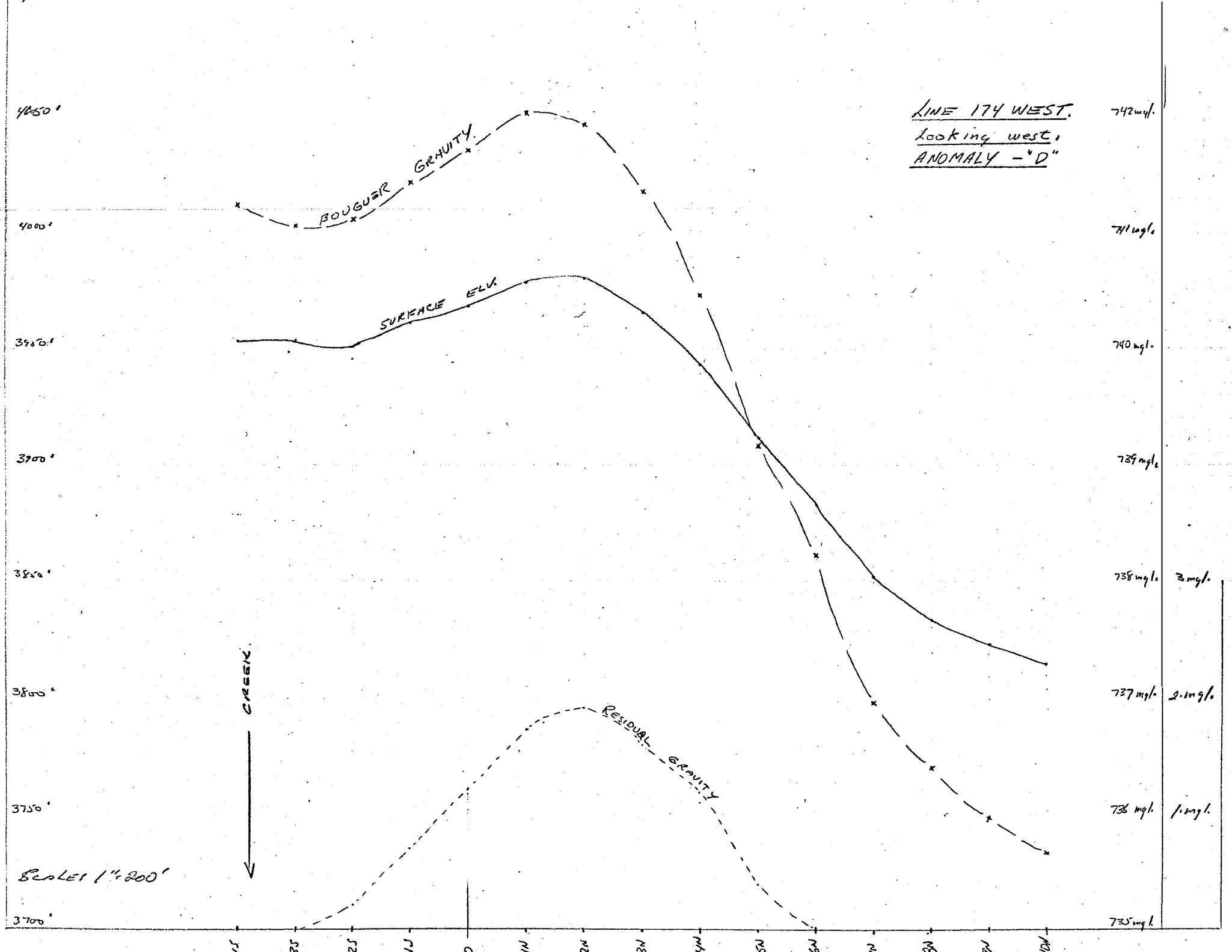

LINE 130 WEST.
 Looking WEST.
 ANOMALY - "M"

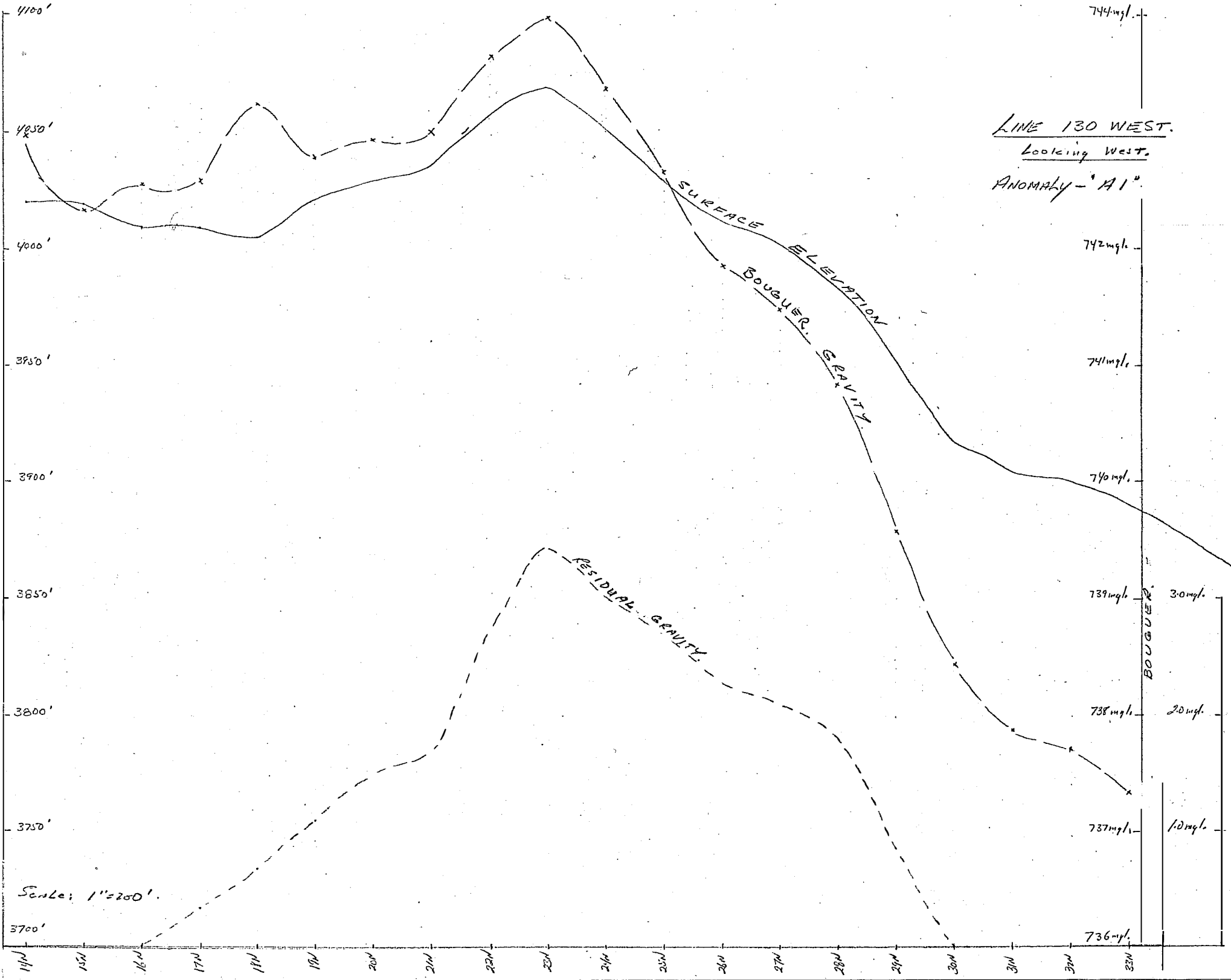

Scale: 1" = 200'

BOUGUER

30mgal
20mgal
10mgal

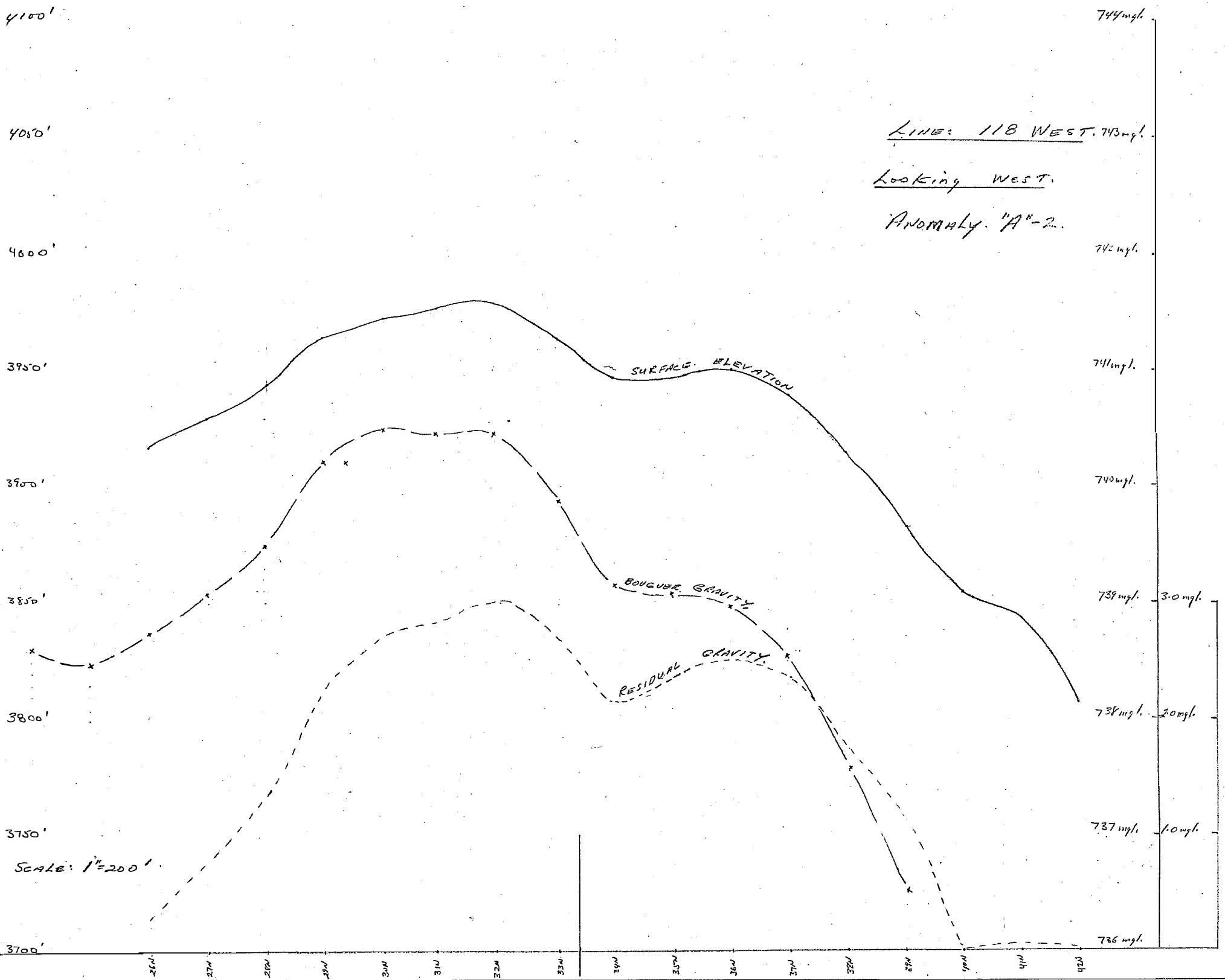

4150'

738 mg/l

4050'

737 mg/l

4000'

736 mg/l

3950'

735 mg/l

3900'

734 mg/l

3850'

733 mg/l

3800'

732 mg/l

3750'

731 mg/l

3700'

730 mg/l

LINE 106 WEST.
Looking WEST.
ANOMALY. "A 3"

CREEK

SCALE: 1" = 200'

BOUGDER GRAVITY

SURFACE ELEV.

RESIDUAL

GRAVITY

BOUGDER

3.1 mg/l

2.1 mg/l

1.1 mg/l

RESIDUAL

23N

24N

25N

26N

27N

28N

29N

30N

31N

32N

33N

34N

35N

36N

37N

38N

39N

40N