

Taken from Map #7  
Proposed Gravity Survey

FOR T. CAROL:

① L 134 - Do I.P. From 1200N TO 3300N  
- Do RES. DEPTH PROBE BY EXPANDING  
BOTH WAYS FROM 16450N UNTIL  
TOTAL SEPARATION = 2L = 1000 FT.

② L 118 - Do I.P. FROM 2100N TO 4100N  
Do DEPTH PROBE FROM 2500N  
EXPANDING BOTH WAYS UNTIL  
2L = 1000 FT.

③ Do E.M. ON BOTH LINES FOR 1000 ON  
EITHER SIDE OF ANOMALY.

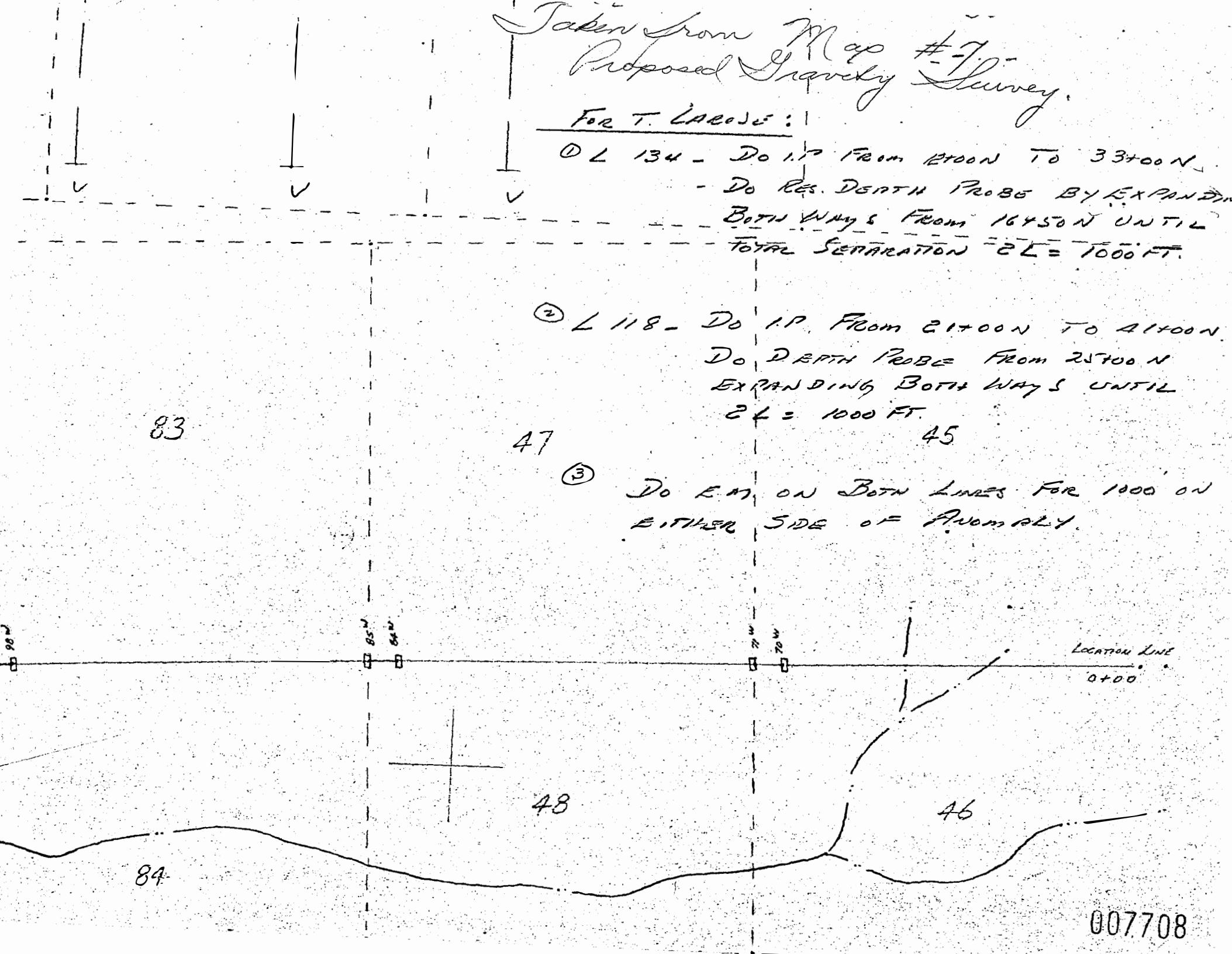

007708