

VANE

NOTE:  
Y67141-43 → LYN 27, 29, 30 (see) staked in Sept 1972 by James H. Stevenson  
Y67144-51 → LYN 139, 141, 143-142 (see) staked by Peter A. Lewis in Sept 1972  
L. Lewis

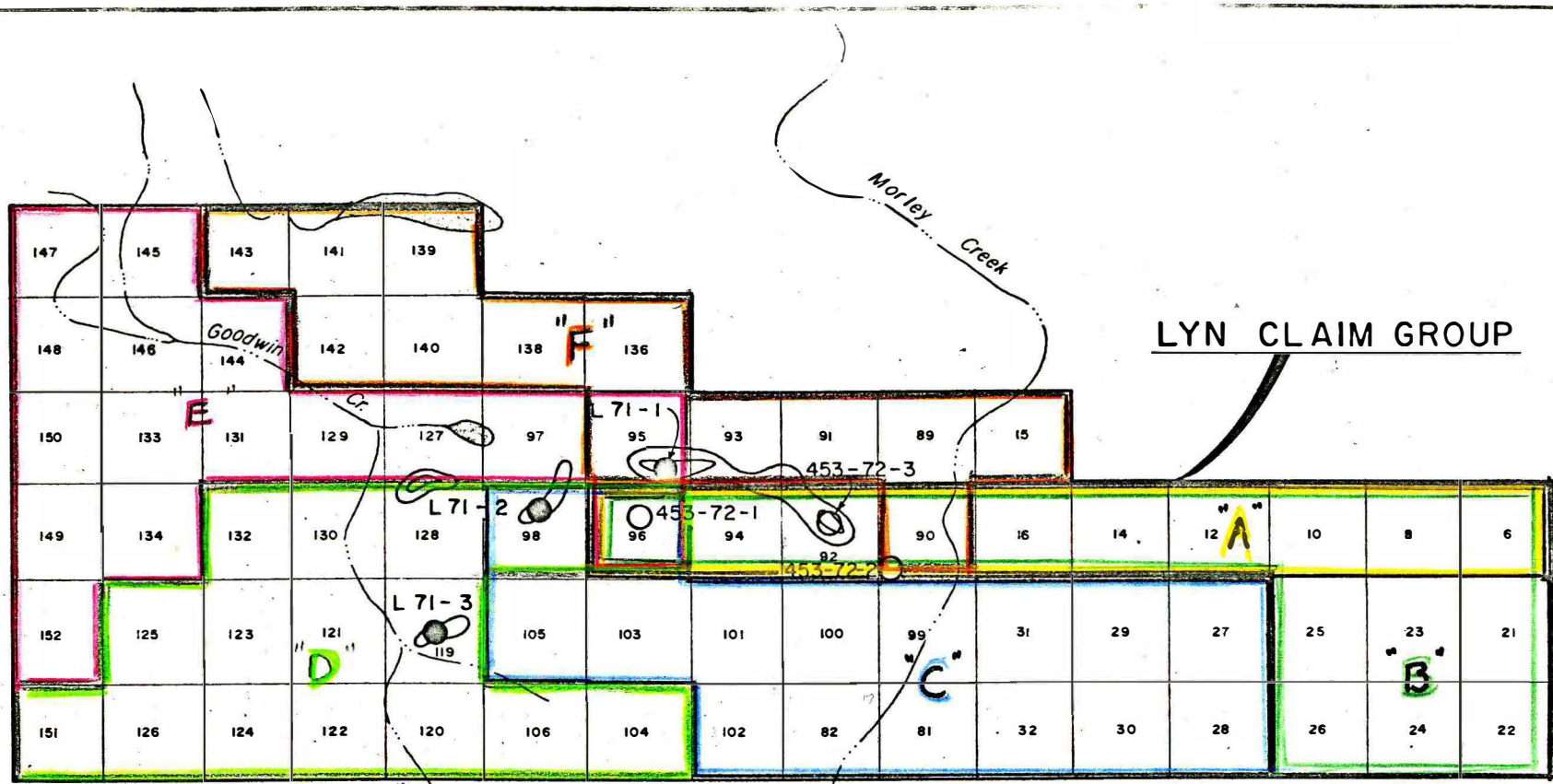

KEY:

- Residual Gravity Anomaly
- L 71-2 ● Diamond Drillhole 1971
- 453-72-1 ○ Diamond Drillhole 1972

<b>THALES EXPLORATION COMPANY</b>
<b>LYN CLAIMS</b>
YUKON TERRITORY
Scale: 1 inch = 0.5 mile
007742
Oct. 15, 1972

All claims good to 1<sup>st</sup> MAR 1977.

19 Dec 72 / S.