

AREA Swim Lakes
 CLIENT Kerr Addison

Swim Lake - Bouguer Gravity
 UNITED GRAVITY CONTROL SYSTEM ET
 007769

PARTY 598
 PARTY CHIEF _____

ELEVATION CORRECTION FACTOR 0.05833 PROSPECT CORRECTION _____ MG _____ COMP. BY _____ CHK. BY _____

Baseline
 $\frac{3}{\Delta}$
 Delta
 S-11

STA. NO.	BOOK PAGE	GRID.	ELEV.	ELEV. CORR.	LAT. CORR.	OBS. GRAV.	TERR. CORR.	BOUG. GRAV.	NO.	RECHECK OBS. GRAV.	BOUG. GRAV.	DATE RUN	DATE RECHECK
01 S	+	1.00	3558.04	907.54	93.38	70.43	.06	194.65	01				
02 S	+	.25	3576.75	908.63	93.37	79.40	.02	194.68	02	79.42			
03 S	+	.00	3592.05	909.82	93.35	78.08	.00	194.55	03				
04 S	+	.83	3616.47	910.98	93.33	76.60	.05	194.27	04				
05									05				
1 06 N	+	.50	3513.41	904.94	93.42	82.61	.03	194.16	06				
2 07 N	+	1.07	3496.77	903.38	93.43	84.12	.10	194.17	07				
08									08				
Δ 09 S-11	-	1.50	3539.69	906.47	93.40	81.52	-.09	194.50	09				
10						.69			10				
11						.03			11				
12									12				
13									13				
14									14				
15									15				
16									16				
17									17				
18									18				
19									19				
20									20				
21									21				
22									22				
23									23				
24									24				
25									25				
26									26				
27									27				
28									28				
29									29				
30									30				
31									31				
32									32				
33									33				
34									34				
35									35				
36									36				
37									37				
38									38				
39									39				
40									40				
41									41				
42									42				
43									43				
44									44				
45									45				
46									46				
47									47				
48									48				
49									49				
50									50				

AREA Swim lake
 CLIENT Kerr Addison

UNITED GEOPHYSICAL
 GRAVITY COMPUTATION SHEET

PARTY 598
 PARTY CHIEF _____
 COMP. BY _____ CHK. BY _____

ELEVATION CORRECTION FACTOR 05833 PROSPECT CORRECTION _____ MG

Line 184

STA. NO.	BOOK PAGE	GRID.	ELEV.	ELEV. CORR.	LAT. CORR.	OBS. GRAV.	TERR. CORR.	BOUG. GRAV.	NO.	RECHECK OBS. GRAV.	BOUG. GRAV.	DATE RUN	DATE RECHECK
01					92.				01				
02		1.0	3137.81	183.04	92.77	104.32	06	194.65	02				
03		1.7	3170.53	184.94	92.76	102.98	04	194.70	03				
04		1.6	3194.05	186.31	92.74	101.21	03	194.81	04				
05		1.6	3215.08	187.54	92.73	100.08	03	194.92	05				
06		-	3238.42	188.90	92.72	98.84	-	195.02	06				
07		1.5	3262.48	190.30	92.70	97.57	03	195.20	07				
08		-	3279.75	191.31	92.69	96.51	-	195.13	08	?			
09		-	3299.46	192.46	92.68	95.53	-	195.31	09				
10		1.8	3319.55	193.63	92.67	94.35	05	195.36	10				
11		1.5	3339.98	194.82	92.65	93.17	03	195.37	11				
12		1.0	3358.68	195.91	92.64	92.13	06	195.46	12				
13		1.8	3380.93	197.21	92.63	90.80	05	195.43	13				
14		1.8	3400.03	198.32	92.62	89.73	05	195.48	14				
15		1.3	3414.41	199.16	92.60	88.83	02	195.41	15				
<u>Boyleher</u> 2		1.5	3424.36	199.74	92.59	88.29	03	195.47	16				
17									17				
18									18				
19									19				
20									20				
21									21				
<u>Bl</u> 1 - 18 W		1.6	3099.20	180.78	92.78	106.54	03	194.57	22				
23									23				
24									24				
25									25				
26									26				
27									27				
28									28				
29									29				
30									30				
31									31				
32									32				
33									33				
34									34				
35									35				
36									36				
37									37				
38									38				
39									39				
40									40				
41									41				
42									42				
43									43				
44									44				
45									45				
46									46				
47									47				
48									48				
49									49				
50									50				

AREA Swim Lake
 CLIENT Kerr Addison

UNITED GEOPHYSICAL
 GRAVITY COMPUTATION SHEET

PARTY 598
 PARTY CHIEF _____
 COMP. BY _____
 CHK. BY _____

ELEVATION CORRECTION FACTOR 0.58 PROSPECT CORRECTION _____ MG

Line 19 W

STA. NO.	BOOK PAGE	GRID.	ELEV.	ELEV. CORR.	LAT. CORR.	OBS. GRAV.	TERR. CORR.	BOUG. GRAV.	NO.	RECHECK OBS. GRAV.	BOUG. GRAV.	DATE RUN	DATE RECHECK
01									01				
02									02				
03									03				
04									04				
05									05				
06									06				
07									07				
08									08				
09									09				
10									10				
11									11				
12									12				
13									13				
14									14				
15									15				
16									16				
17		-	3467.73	202.27	92.60	85.73	-	195.40	17				
18		1.0	3471.54	202.49	92.59	85.42	06	195.38	18				
19		.9	3484.56	203.25	92.58	84.60	05	195.32	19				
20		.8	3493.44	203.77	92.57	84.02	05	195.27	20				
21		.9	3498.96	204.09	92.56	83.76	05	195.34	21				
22		.8	3504.18	204.40	92.54	83.49	05	195.40	22				
23		1.3	3507.28	204.58	92.53	83.35	08	195.48	23				
24		.3	3514.55	205.00	92.52	82.97	02	195.47	24				
25		.7	3520.72	205.36	92.50	82.61	04	195.51	25				
26		-	3524.33	205.57	92.49	82.55	-	195.63	26				
27		1.0	3526.14	205.68	92.47	82.55	06	195.82	27				
28		1.2	3529.14	205.85	92.46	82.38	07	195.84	28				
29		.7	3533.13	206.09	92.45	82.16	04	195.84	29				
30						81.91			30				
31									31				
32									32				
33									33				
34									34				
35									35				
Bl. 3-19 W		1.6	3537.69	206.35	92.43	81.91	03	195.86	36				
37									37				
38									38				
39									39				
40									40				
41									41				
42									42				
43									43				
44									44				
45									45				
46									46				
47									47				
48									48				
49									49				
50									50				

AREA Swim Lake
 CLIENT Kerr Addison

UNITED GEOPHYSICAL
 GRAVITY COMPUTATION SHEET

PARTY 598
 PARTY CHIEF _____

ELEVATION CORRECTION FACTOR 0.5833 PROSPECT CORRECTION _____ MG _____
 COMP. BY _____ CHK. BY _____

Line 14 W

Elbow shown

Box line

Box line

STA. NO.	BOOK PAGE	GRID.	ELEV.	ELEV. CORR.	LAT. CORR.	OBS. GRAV.	BOUG. CORR.	BOUG. GRAV.	NO.	RECHECK OBS. GRAV.	BOUG. GRAV.	DATE RUN	DATE RECHECK
01			3087.86	180.11	92.72	107.49	06	194.94	01				
02			3120.47	182.02	70	105.67	04	195.03	02				
03			3154.26	183.99	69	103.58	09	194.97	03				
04			3191.56	186.16	68	102.04	-	195.51	04	Not	used		
05			3205.58	186.98	67	100.76	04	195.11	05				
06			3234.27	188.66	65	99.18	-	195.19	06				
07			3260.32	190.17	64	97.81	-	195.34	07				
08			3282.07	191.44	63	96.53	-	195.34	08				
09			3299.58	192.46	62	95.51	06	195.41	09				
10			3316.41	193.43	60	94.64	03	195.50	10				
11	-		3331.59	194.33	58	93.76	+05	195.56	11				
12			3347.59	195.26	57	92.86	-	195.55	12				
13			3362.05	196.11	56	91.99	03	195.57	13				
14			3372.35	196.71	55	91.38	05	195.59	14				
15			3388.25	197.64	92.53	90.35	03	195.49	15				
16									16				
17									17				
18	1-14 W		3052.00	178.02	92.73	109.57	02	194.88	18				
19									19				
20									20				
21									21				
22									22				
23									23				
24									24				
25									25				
26									26				
27									27				
28									28				
29									29				
30									30				
31									31				
32									32				
33									33				
34									34				
35									35				
36									36				
37									37				
38									38				
39									39				
40									40				
41									41				
42									42				
43									43				
44									44				
45									45				
46									46				
47									47				
48									48				
49									49				
50									50				

AREA Swim Lake
 CLIENT Kerr Addison

UNITED GEOPHYSICAL
 GRAVITY COMPUTATION SHEET

PARTY 598
 PARTY CHIEF _____

ELEVATION CORRECTION FACTOR 0.05833 PROSPECT CORRECTION _____ MG
 COMP. BY _____ CHK. BY _____

Line 34W

STA. NO.	BOOK PAGE	GRID.	ELEV.	ELEV. CORR.	LAT. CORR.	OBS. GRAV.	TERR. CORR.	BOUG. GRAV.	NO.	RECHECK OBS. GRAV.	BOUG. GRAV.	DATE RUN	DATE RECHECK
01									01				
02									02				
03									03				
04									04				
05									05				
06									06				
07									07				
08									08				
09									09				
10									10				
11									11				
12									12				
13									13				
14									14				
15			6.2	1.2				5.0	15				
16		.8	3593.06	209.57	92.79	77.99	05	194.82	16	5.0			
17	A	.9	3602.92	210.16	92.78	77.52	05	194.95	17	5.0			
18		.9	3608.26	210.46	92.77	77.31	05	195.05	18	5.1			
19		.8	3614.79	210.84	92.75	76.90	05	195.04	19	5.0			
20		.8	3624.44	211.40	92.74	76.28	05	194.99	20	5.0			
21		1.0	3632.84	211.89	92.73	75.81	06	195.03	21	5.0			
22		1.0	3644.64	212.58	92.72	75.16	06	195.09	22	5.1			
23		1.0	3657.07	213.31	92.71	74.40	06	195.06	23	5.1			
24		.8	3663.11	213.64	92.69	74.33	05	195.33	24	5.7			
25		.8	3662.32	213.61	92.68	74.28	05	195.26	25	5.7			
26		.5	3670.34	214.08	92.67	74.09	03	195.53	26	5.5			
27		.8	3674.98	214.35	92.65	73.87	05	195.62	27	5.8			
28									28				
29									29				
30	Line 3	.9	3683.34	214.85	92.64	73.41	05	195.67	30	5.7			
31	Line 2	.8	3593.06	209.58	92.80	77.99	05	194.82	31	7.1			
32									32				
33									33				
34									34				
35									35				
36									36				
37									37				
38									38				
39									39				
40									40				
41									41				
42									42				
43									43				
44									44				
45									45				
46									46				
47									47				
48									48				
49									49				
50									50				

AREA Swim Lake
 CLIENT Kerr Addison

UNITED GEOPHYSICAL
 GRAVITY COMPUTATION SHEET

PARTY 598
 PARTY CHIEF _____
 COMP. BY _____ CHK. BY _____

ELEVATION CORRECTION FACTOR 05833 PROSPECT CORRECTION _____ MG

Line 30

STA. NO.	BOOK PAGE	GRID.	ELEV.	ELEV. CORR.	LAT. CORR.	OBS. GRAV.	TERR. CORR.	BOUG. GRAV.	NO.	RECHECK OBS. GRAV.	BOUG. GRAV.	DATE RUN	DATE RECHECK
01		1.5	3241.57	189.08	92.93	98.49	03	194.67	01	4.76			
02		1.5	3272.59	190.89	92.92	96.65	03	194.65	02	4.74			
03		1.9	3299.65	192.47	92.90	95.13	05	194.75	03	4.84			
04		1.3	3326.14	194.01	92.89	93.61	08	194.83	04	4.92			
05		1.8	3346.31	195.19	92.87	92.47	05	194.84	05	4.93			
06		1.9	3368.68	196.48	92.86	91.20	05	194.82	06	4.96			
07		1.8	3391.25	197.80	92.85	89.98	03	194.95	07	5.04			
08		1.0	3411.55	198.99	92.83	88.81	06	195.03	08	5.12			
09		1.9	3428.00	199.95	92.82	87.94	05	195.12	09	5.21			
10		1.0	3447.45	201.08	92.81	86.69	06	195.02	10	5.11			
11		1.7	3470.92	202.45	92.80	85.14	04	194.83	11	4.92			
12		1.1	3493.34	203.76	92.79	83.78	06	194.81	12	4.90			
13		1.8	3510.54	204.23	92.78	82.71	05	194.81	13	4.90			
14		1.2	3524.20	205.56	92.77	81.93	07	194.79	14	4.88			
15		1.7	3534.70	206.17	92.75	81.36	04	194.82	15	4.91			
16		1.9	3538.39	206.38	92.74	80.84	05	194.83	16	—			
17									17				
18									18				
19									19				
20									20				
21									21				
Bad 22	2	1.7	^{4.1} 3560.24	207.67	92.73	79.99	04	194.97	22	5.06			
23									23				
24									24				
BL. 25	30W	1.5	^{15.1} 3213.55	187.45	92.92	100.47	03	194.73	25	4.82			
26									26				
27									27				
28									28				
29									29				
30									30				
31									31				
32									32				
33									33				
34									34				
35									35				
36									36				
37									37				
38									38				
39									39				
40									40				
41									41				
42									42				
43									43				
44									44				
45									45				
46									46				
47									47				
48									48				
49									49				
50									50				

AREA Swim Lake
 CLIENT Kerr Addison

UNITED GEOPHYSICAL
 GRAVITY COMPUTATION SHEET

PARTY 598
 PARTY CHIEF _____
 COMP. BY _____ CHK. BY _____

ELEVATION CORRECTION FACTOR 05833 PROSPECT CORRECTION _____ MG

Line 21W

STA. NO.	BOOK PAGE	GRID.	ELEV.	ELEV. CORR.	LAT. CORR.	OBS. GRAV.	TERR. CORR.	BOUG. GRAV.	NO.	RECHECK OBS. GRAV.	BOUG. GRAV.	DATE RUN	DATE RECHECK
01									01				
02									02				
03									03				
04									04				
05									05				
06									06				
07									07				
08									08				
09									09				
10									10				
11									11				
12									12				
13									13				
14									14				
15									15				
16	<u>Book 2</u>	<u>15</u>	<u>3546.66</u>	<u>206.88</u>	<u>92.71</u>	<u>80.67</u>	<u>03</u>	<u>194.87</u>	16	<u>5.03</u>			
17		<u>14</u>	<u>3558.85</u>	<u>207.58</u>	<u>92.69</u>	<u>79.98</u>	<u>02</u>	<u>194.89</u>	17	<u>5.05</u>			
18		<u>1.2</u>	<u>3570.69</u>	<u>208.27</u>	<u>92.68</u>	<u>78.73</u>	<u>07</u>	<u>194.39</u>	18	<u>---</u>			
19		<u>1.0</u>	<u>3579.85</u>	<u>208.80</u>	<u>92.66</u>	<u>78.70</u>	<u>06</u>	<u>194.90</u>	19	<u>5.06</u>			
20		<u>17</u>	<u>3583.42</u>	<u>209.01</u>	<u>92.65</u>	<u>78.57</u>	<u>04</u>	<u>194.97</u>	20	<u>5.13</u>			
21		<u>15</u>	<u>3591.21</u>	<u>209.47</u>	<u>92.64</u>	<u>78.19</u>	<u>03</u>	<u>195.05</u>	21	<u>5.21</u>			
22		<u>14</u>	<u>3601.94</u>	<u>210.09</u>	<u>92.63</u>	<u>77.70</u>	<u>02</u>	<u>195.18</u>	22	<u>5.34</u>			
23		<u>15</u>	<u>3612.03</u>	<u>210.68</u>	<u>92.61</u>	<u>77.11</u>	<u>03</u>	<u>195.21</u>	23	<u>5.37</u>			
24		<u>14</u>	<u>3618.75</u>	<u>211.07</u>	<u>92.60</u>	<u>76.73</u>	<u>02</u>	<u>195.22</u>	24	<u>5.38</u>			
25		<u>17</u>	<u>3623.70</u>	<u>211.36</u>	<u>92.58</u>	<u>76.54</u>	<u>04</u>	<u>195.36</u>	25	<u>5.52</u>			
26		<u>1.3</u>	<u>3626.82</u>	<u>211.54</u>	<u>92.57</u>	<u>76.36</u>	<u>08</u>	<u>195.41</u>	26	<u>5.57</u>			
27		<u>15</u>	<u>3624.84</u>	<u>211.43</u>	<u>92.55</u>	<u>76.65</u>	<u>03</u>	<u>195.56</u>	27	<u>5.72</u>			
28	<u>Line 28</u>	<u>3</u>	<u>3626.99</u>	<u>211.56</u>	<u>92.54</u>	<u>76.54</u>	<u>05</u>	<u>195.61</u>	28	<u>5.77</u>			
29									29				
30									30				
31			<u>3620.30</u>	<u>211.1</u>					31				
32									32				
33									33				
34									34				
35									35				
36									36				
37									37				
38									38				
39									39				
40									40				
41									41				
42									42				
43									43				
44									44				
45									45				
46									46				
47									47				
48									48				
49									49				
50									50				

Adjusted
 +116 mgs.

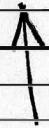

AREA Swim Lake
 CLIENT Kerr Addison

UNITED GEOPHYSICAL
 GRAVITY COMPUTATION SHEET

PARTY 598
 PARTY CHIEF _____
 COMP. BY _____ CHK. BY _____

ELEVATION CORRECTION FACTOR 0.5833 PROSPECT CORRECTION _____ MG

line 26W

STA. NO.	BOOK PAGE	GRID.	ELEV.	ELEV. CORR.	LAT. CORR.	OBS. GRAV.	TERR. CORR.	BOUG. GRAV.	NO.	RECHECK OBS. GRAV.	BOUG. GRAV.	DATE RUN	DATE RECHECK
01		09	3208.88	187.17	92.88	100.30	05	194.64	01	4.7			
02		113	3241.53	189.08	92.86	98.40	08	194.70	02	4.4			
03		05	3272.44	190.88	92.85	96.76	03	194.82	03	4.9			
04		07	3297.22	192.33	92.84	95.52	04	194.97	04	5.1			
05		-	3322.77	193.82	92.82	93.97	-	194.97	05	5.1			
06		08	3343.29	195.01	92.81	92.75	10.5	195.00	06	5.1			
07		10	3364.26	196.24	92.80	91.56	06	195.06	07	5.2			
08		110	3376.82	196.97	92.78	90.89	06	195.14	08	5.2			
09		103	3396.82	198.14	92.77	89.68	08	195.13	09	5.2			
10		03	3425.84	199.83	92.76	88.03	02	195.12	10	5.2			
11		8	3457.42	201.67	92.74	86.06	05	195.04	11	5.1			
12		08	3479.26	202.95	92.73	84.75	05	195.02	12	5.1			
13		08	3509.24	204.69	92.72	83.58	05	195.50	13	5.1			
14		110	3516.68	205.13	92.70	82.46	06	194.95	14	5.1			
15						81.33			15				
16									16				
17									17				
18									18				
19									19				
20									20				
21			79.75						21				
22	Bl. line 26W	06	3180.62	185.53	92.89	102.05	03	194.72	22	5.8			
23	Bl. line 2	110	3535.47	206.22	92.89	81.32	06	194.91	23	5.0			
24									24				
25									25				
26									26				
27									27				
28									28				
29									29				
30									30				
31									31				
32									32				
33									33				
34									34				
35									35				
36									36				
37									37				
38									38				
39									39				
40									40				
41									41				
42									42				
43									43				
44									44				
45									45				
46									46				
47									47				
48									48				
49									49				
50									50				

AREA Swim lake
 CLIENT Kerr Addison

UNITED GEOPHYSICAL
 GRAVITY COMPUTATION SHEET

PARTY 598
 PARTY CHIEF _____
 COMP. BY _____
 CHK. BY _____

ELEVATION CORRECTION FACTOR 0.05833 PROSPECT CORRECTION _____ MG

Line 22w

STA. NO.	BOOK PAGE	GRID. ELEV. <small>Tripod Height</small>	ELEV. CORR.	LAT. CORR.	OBS. GRAV.	TERR. CORR.	BOUG. GRAV.	NO.	RECHECK OBS. GRAV.	BOUG. GRAV.	DATE RUN	DATE RECHECK
01		.8 3178.85	185.42	92.82	101.85	05	194.50	01	4.7			
02		1.3 3207.53	187.10	92.81	100.31	08	194.68	02	4.8			
03		1.2 3231.51	188.49	92.80	99.00	07	194.76	03	4.9			
04		1.1 3254.57	189.84	92.79	97.73	06	194.84	04	5.0			
05		.8 3272.91	190.91	92.77	96.79	05	194.98	05	5.1			
06		1.0 3288.46	191.92	92.76	95.98	06	195.10	06	5.2			
07		.8 3307.16	192.91	92.75	94.94	05	195.15	07	5.3			
08		.5 3328.62	194.16	92.74	93.67	03	195.12	08	5.2			
09		.9 3351.59	195.50	92.72	92.29	05	195.12	09	5.2			
10		1.3 3373.08	196.75	92.71	91.05	08	195.17	10	5.3			
11		1.1 3394.39	197.99	92.70	89.85	06	195.20	11	5.3			
12		.8 3415.68	199.24	92.68	88.59	05	195.20	12	5.3			
13		1.0 3434.52	200.34	92.67	87.47	06	195.20	13	5.3			
14		1.0 3456.36	201.61	92.66	86.14	06	195.15	14	5.3			
15		1.3 3474.99	202.70	92.65	84.94	08	195.07	15	5.2			
16		1.3 3484.13	203.23	92.64	84.37	08	195.04	16	5.2			
17								17				
18								18				
19								19				
20								20				
21								21				
Blue 2		.7 3488.38	203.48	92.63	84.18	02	195.05	22	5.2			
23								23				
24								24				
Blue 1		.9 3461.21	183.52	92.84	103.82	05	194.55	25				
26								26				
27								27				
28								28				
29								29				
30								30				
31								31				
32								32				
33								33				
34								34				
35								35				
36								36				
37								37				
38								38				
39								39				
40								40				
41								41				
42								42				
43								43				
44								44				
45								45				
46								46				
47								47				
48								48				
49								49				
50								50				

AREA Swim Lake
 CLIENT Kerr Addison

UNITED GEOPHYSICAL
 GRAVITY COMPUTATION SHEET

PARTY 598
 PARTY CHIEF _____

ELEVATION CORRECTION FACTOR 0.5833

PROSPECT CORRECTION _____ MG

COMP. BY _____ CHK. BY _____

line 38W

STA. NO.	BOOK PAGE	GRID.	ELEV.	ELEV. CORR.	LAT. CORR.	OBS. GRAV.	TERR. CORR.	BOUG. GRAV.	NO.	RECHECK OBS. GRAV.	BOUG. GRAV.	DATE RUN	DATE RECHECK
01		-	3321.30	193.72	93.07	-		-	01				
02		.2	3343.65	195.02	93.03	92.75	01	194.75	02				
03		.7	3364.19	196.22	93.02	91.54	04	194.78	03				
04		1.3	3382.81	197.31	93.01	90.43	08	194.81	04				
05		.6	3404.17	198.56	92.99	89.16	03	194.76	05				
06		1.3	3422.80	199.64	92.98	88.13	09	194.87	06				
07		1.0	3449.68	201.21	92.97	86.49	06	194.79	07				
08		1.3	3475.49	202.72	92.95	84.89	09	194.74	08				
09		1.1	3496.86	203.96	92.94	83.70	06	194.78	09				
10		.2	3515.03	205.02	92.92	82.63	01	194.74	10				
11		.8	3533.44	206.10	92.91	81.58	05	194.82	11				
12		.8	3548.14	206.95	92.90	80.69	05	194.79	12				
13		.5	3563.71	207.86	92.88	79.73	03	194.74	13				
14		.8	3575.12	208.53	92.87	79.11	05	194.82	14				
15		1.0	3589.41	209.36	92.86	78.29	06	194.85	15				
16		1.1	3602.02	210.10	92.84	77.52	06	194.84	16				
17									17				
18									18				
19									19				
20									20				
21									21				
BL 1 - 38W		2.3	3297.32	192.32	93.05	95.30	13	194.70	22	+1			
23									23				
24									24				
25		.7	3614.27	210.82	92.83	76.85	07	194.88	25	=1			
26									26				
27									27				
28									28				
29									29				
30									30				
31									31				
32									32				
33									33				
34									34				
35									35				
36									36				
37									37				
38									38				
39									39				
40									40				
41									41				
42									42				
43									43				
44									44				
45									45				
46									46				
47									47				
48									48				
49									49				
50									50				

AREA Swim Lake
 CLIENT Kerr Addison

UNITED GEOPHYSICAL
 GRAVITY COMPUTATION SHEET

PARTY 598
 PARTY CHIEF _____
 COMP. BY _____
 CHK. BY _____

ELEVATION CORRECTION FACTOR 05137 PROSPECT CORRECTION _____ MG

Line 134

STA. NO.	BOOK PAGE	GRID.	ELEV.	ELEV. CORR.	LAT. CORR.	OBS. GRAV.	TERR. CORR.	BOUG. GRAV.	NO.	RECHECK OBS. GRAV.	BOUG. GRAV.	DATE RUN	DATE RECHECK
01									01				
02									02				
03									03				
04									04				
05									05				
06									06				
07									07				
08									08				
09									09				
10									10				
11									11				
12									12				
13									13				
14									14				
15			3597.73						15				
16			3578.13						16				
17		1.0	3564.07	207.89	93.31	79.04	06	193.68	17				
18		.8	3578.13	208.71	93.29	78.60	05	194.07	18				
19		1.1	3597.77	209.86	93.28	77.34	06	193.98	19				
20		.9	3617.14	210.99	93.27	76.00	05	193.77	20				
21		.7	3638.34	212.22	93.25	74.48	04	193.49	21				
22		1.0	3663.95	213.72	93.24	72.61	06	193.15	22				
23		.8	3689.28	215.20	93.22	70.88	05	192.91	23				
24		.9	3713.44	216.60	93.21	69.35	05	192.79	24				
25		1.3	3730.23	217.58	93.19	68.33	08	192.80	25				
26		1.3	3743.02	218.33	93.18	67.58	08	192.81	26				
27		1.3	3751.63	218.83	93.16	67.25	08	193.00	27				
28		1.1	3755.03	219.03	93.15	67.16	06	193.10	28				
29		1.2	3759.51	219.29	93.13	67.11	07	193.34	29				
30		1.0	3762.20	219.45	93.12	67.05	06	193.44	30				
31									31				
32									32				
33									33				
Blind 3	69+60	1.0	3763.61	219.53	93.10	67.03	06	193.52	34				
35									35				
Blind 2	73W	1.8	3539.00	206.43	93.33	80.49	05	193.62	36				
37									37				
38									38				
39									39				
40									40				
41									41				
42									42				
43									43				
44									44				
45									45				
46									46				
47									47				
48									48				
49									49				
50									50				

AREA Swim Lake
 CLIENT Kerr Addison

UNITED GEOPHYSICAL
 GRAVITY COMPUTATION SHEET

PARTY 598
 PARTY CHIEF _____

ELEVATION CORRECTION FACTOR .058 PROSPECT CORRECTION _____ MG
 COMP. BY _____ CHK. BY _____

Base Line
3
 ||

STA. NO.	BOOK PAGE	GRID.	ELEV.	ELEV. CORR.	LAT. CORR.	OBS. GRAV.	TERR. CORR.	BOUG. GRAV.	NO.	RECHECK OBS. GRAV.	BOUG. GRAV.	DATE RUN	DATE RECHECK
51									51				
52									52				
53									53				
54									54				
55									55				
56									56				
57									57				
58									58				
line 59	69 W					66.66			59				
60									60				
61									61				
62		18	3780.07	220.49	93.00	66.61	05	194.15	62				
63		18	3784.95	220.78	93.01	66.19	05	194.01	63				
64		12	3779.07	220.37	93.02	66.48	07	193.90	64				
65		1.0	3774.09	220.14	93.04	66.69	06	193.85	65				
66		1.0	3776.95	220.30	93.05	66.60	06	193.91	66				
67		12	3771.03	219.96	93.07	66.86	01	193.76	67				
68		1.1	3768.02	219.79	93.08	66.95	06	193.72	68				
69		18	3765.91	219.67	93.10	66.87	05	193.49	69				
70		1.3	3759.175	219.31	93.11	67.15	08	193.43	70				
71		-	3749.35	218.64	93.13	71.00	-	-	71				
72		1.3	3737.99	218.04	93.14	67.04	08	192.02	72	?			
73	72.80	1.1	3726.07	217.34	93.16	68.74	06	192.98	73				
74		1.1	3714.02	216.64	93.17	69.43	06	192.96	74				
75		.8	3700.22	215.83	93.18	70.25	05	192.95	75				
76		.8	3684.29	214.90	93.20	71.15	05	192.90	76				
77		1.0	3660.30	213.51	93.21	72.88	06	193.24	77	?			
78		1.8	3635.35	212.05	93.23	73.98	05	192.85	78				
79		1.2	3611.66	210.67	93.24	75.32	08	192.83	79				
80			3599.71						80				
81		1.0	3582.86	208.99	93.25	77.09	06	192.89	81				
82		.7	3550.37	207.09	93.27	79.13	04	192.99	82				
83		1.0	3519.80	205.31	93.28	80.91	06	193.00	83				
84		1.35	3488.58	203.49	93.29	82.81	08	193.09	84				
84 + 50		1.0	3469.77	202.39	93.30	84.06	06	193.21	85				
86									86				
87									87				
88									88				
89									89				
90									90				
91									91				
92									92				
93									93				
94									94				
95									95				
96									96				
97									97				
98									98				
99									99				
00									00				

AREA Swim Lake
 CLIENT Kerr Addison

UNITED GEOPHYSICAL
 GRAVITY COMPUTATION SHEET

PARTY 598
 PARTY CHIEF _____
 COMP. BY _____
 CHK. BY _____

ELEVATION CORRECTION FACTOR 0.05833 PROSPECT CORRECTION _____ MG

Base
 Line
 8 E
 3

STA. NO.	BOOK PAGE	GRID.	ELEV.	ELEV. CORR.	LAT. CORR.	OBS. GRAV.	TERR. CORR.	BOUG. GRAV.	NO.	RECHECK OBS. GRAV.	BOUG. GRAV.	DATE RUN	DATE RECHECK
01									01				
02									02				
03									03				
04									04				
05							Tripod		05				
06							Height		06				
07							29		07				
08			3317.04	103.48	92.06	94.57	+109	196.08	08				
09			3332.27	194.37	92.05	93.53	.06	195.91	09				
10			3343.69	195.04	92.03	92.71	.06	195.72	10				
11			3356.70	195.45	92.02	92.27	.05	195.75	11				
12			3363.29	196.18	92.01	91.35	.04	195.56	12				
13			3374.85	196.96	92.00	90.56	.06	195.48	13				
14			3386.02	197.51	91.98	89.82	.06	195.41	14				
15			3393.86	197.96	91.97	89.29	.06	195.33	15				
16	3d		3404.11	198.56	91.95	88.52	.06	195.19	16				
17									17				
18									18				
19									19				
20									20				
21									21				
22									22				
23									23				
24									24				
25									25				
26									26				
27									27				
28									28				
29									29				
30									30				
31									31				
32									32				
33									33				
34									34				
35									35				
36									36				
37									37				
38									38				
39									39				
40									40				
41									41				
42									42				
43									43				
44									44				
45									45				
46									46				
47									47				
48									48				
49									49				
50									50				

AREA Swim Lake
 CLIENT Kerr Addison

UNITED GEOPHYSICAL
 GRAVITY COMPUTATION SHEET

PARTY 598
 PARTY CHIEF _____
 COMP. BY DAD CHK. BY _____

ELEVATION CORRECTION FACTOR 0.05833 PROSPECT CORRECTION _____ MG

Base
 line 2

STA. NO.	BOOK PAGE	GRID.	ELEV.	ELEV. CORR.	LAT. CORR.	OBS. GRAV.	TERR. CORR.	BOUG. GRAV.	NO.	RECHECK OBS. GRAV.	BOUG. GRAV.	DATE RUN	DATE RECHECK
01 E			3227.17	188.24	92.34	100.00		195.90	01				
02			3226.27	187.84	92.32	100.33		195.85	02				
03			3216.09	187.59	92.31	101.10			03				
04			3207.26	187.08	92.30	101.10		195.88	04				
05			3193.19	186.26	92.29	101.90		195.87	05				
06			3178.94	185.43	92.28	102.72		195.87	06				
07			3166.35	184.69	92.27	103.39		195.81	07				
08			3156.87	184.11	92.25	-		-	08				
09			3147.63	183.60	92.24	104.42		195.78	09				
10			3136.83	182.97	92.23	105.12		195.86	10				
11			3125.78	182.33	92.22	105.74		195.85	11				
12			3113.13	181.59	92.21	106.52		195.90	12				
13			3097.60	180.68	92.19	107.40		195.89	13				
14			3080.01	179.66	92.18	108.42		195.91	14				
15			3065.39	178.80	92.17	109.18		195.81	15				
16			3055.23	178.22	92.16	109.79		195.85	16				
Line 16E	145		3054.10	178.15	92.15	-		-	17	NV			
18									18				
19									19				
20									20				
21									21				
22									22				
23									23				
24									24				
25									25				
26									26				
27									27				
28									28				
29									29				
30									30				
31									31				
32									32				
33									33				
34									34				
35									35				
36									36				
37									37				
38									38				
39									39				
40									40				
41									41				
42									42				
43									43				
44									44				
45									45				
46									46				
47									47				
48									48				
49									49				
50									50				

AREA Swim Lake

UNITED GEOPHYSICAL

PARTY 598

CLIENT Kerr Addison

GRAVITY COMPUTATION SHEET

PARTY CHIEF _____

ELEVATION CORRECTION FACTOR 0.05833 PROSPECT CORRECTION _____

MG

COMP. BY BAJ CHK. BY _____

Line 16E

STA. NO.	BOOK PAGE	GRID.	ELEV.	ELEV. CORR.	LAT. CORR.	OBS. GRAV.	TERR. CORR.	BOUG. GRAV.	NO.	RECHECK OBS. GRAV.	BOUG. GRAV.	DATE RUN	DATE RECHECK
01									01				
02									02				
03									03				
04									04				
05									05				
06			3001.82	175.10	92.24	112.82		195.68	06				
07			3007.75	175.44	92.23	112.52		195.73	07				
08			3014.35	175.83	92.22	112.18		195.79	08				
09			3020.29	176.17	92.20	111.77		195.74	09				
10 S			3027.71	176.61	92.19	111.36		195.78	10				
11			3035.28	177.05	92.18	110.89		195.76	11				
12			-	-	-	-		-	12				
13			3046.59	177.71	92.16	110.26		195.81	13				
14			3054.10	178.15	92.15	109.80		195.80	14				
15			3069.63	179.05	92.13	108.85		195.77	15				
16			3084.95	179.95	92.12	107.94		195.77	16				
17			3100.44	180.85	92.11	-		-	17				
18			3116.21	181.77	92.10	106.05		195.72	18				
19			3133.90	182.80	92.08	105.07		195.79	19				
20			3153.16	183.92	92.07	103.94		195.79	20				
21			3180.09	185.49	92.06	102.33		195.76	21				
22			3204.68	186.93	92.05	100.76		195.64	22				
23			3232.82	188.57	92.04	99.06		195.59	23				
24			3256.11	189.93	92.02	-		-	24				
25			3288.71	191.83	92.01	95.70		195.52	25				
26			3315.46	193.39	92.00	94.02		195.41	26				
27			3343.64	195.03	91.99	92.25		195.29	27				
28			3367.11	196.40	91.98	90.82		195.24	28				
29			3386.73	197.55	91.97	89.67		195.25	29				
30			3404.11	198.56	91.95	88.59		195.20	30				
31									31				
32									32				
33									33				
34									34				
35									35				
36									36				
37									37				
38									38				
39									39				
40									40				
41									41				
42									42				
43									43				
44									44				
45									45				
46									46				
47									47				
48									48				
49									49				
50									50				

AREA Swan Lake
 CLIENT Kerr Addison

UNITED GEOPHYSICAL
 GRAVITY COMPUTATION SHEET

PARTY 598
 PARTY CHIEF _____
 COMP. BY DAW CHK. BY _____

ELEVATION CORRECTION FACTOR 0.05833 PROSPECT CORRECTION _____ MG

line 8E

STA. NO.	BOOK PAGE	GRID.	ELEV.	ELEV. CORR.	LAT. CORR.	OBS. GRAV.	TERR. CORR.	BOUG. GRAV.	NO.	RECHECK OBS. GRAV.	BOUG. GRAV.	DATE RUN	DATE RECHECK
01									01				
02									02				
03 S			2998.13	174.82	92.43	113.06		195.45	03				
04			3022.85	176.32	92.42	111.57		195.47	04				
05			3046.26	177.69	92.41	110.27		195.55	05				
06			3064.10	179.73	92.39	109.27		195.61	06				
07			3079.93	179.65	92.38	108.49		195.76	07				
08			3089.92	180.24	92.37	107.94		195.81	08				
09			3097.40	180.67	92.36	107.58		195.89	09				
10			3105.83	181.16	92.35	107.12		195.93	10				
11			3121.89	182.10	92.33	106.16		195.93	11				
12			3142.49	183.30	92.32	104.89		195.87	12				
13			3165.01	184.62	92.31	103.47		195.78	13				
14			3171.33	184.98	92.29	103.19		195.88	14				
15	Box 2		3170.53	184.94	92.28	103.26		195.92	15			Aug 64	
16									16				
17									17				
18									18				
19									19				
20									20				
21									21				
22									22				
23									23				
24									24				
25									25				
26									26				
27									27				
28									28				
29									29				
30									30				
31									31				
32									32				
33									33				
34									34				
35									35				
36									36				
37									37				
38									38				
39									39				
40									40				
41									41				
42									42				
43									43				
44									44				
45									45				
46									46				
47									47				
48									48				
49									49				
50									50				

Line 13E

STA. NO.	BOOK PAGE	GRID.	ELEV.	ELEV. CORR.	LAT. CORR.	OBS. GRAV.	TERR. CORR.	BOUG. GRAV.	NO.	RECHECK OBS. GRAV.	BOUG. GRAV.	DATE RUN	DATE RECHECK
01									01				
02									02				
03									03				
04			3000.71	175.03	92.38	112.92		195.57	04				
05			3014.24	175.82	92.37	112.14		195.59	05				
06			3028.90	176.68	92.36	111.32		195.64	06				
07			3038.71	177.25	92.34	110.87		195.78	07				
08			3045.87	177.67	92.33	110.51		195.85	08				
09			3049.04	177.85	92.31	110.41		195.95	09				
10			3056.34	178.28	92.30	109.96		195.94	10				
11			3067.31	178.92	92.28	109.28		195.92	11				
12			3081.24	179.73	92.27	108.47		195.93	12				
13			3090.72	180.28	92.26	(107.67)		(195.69)	13	Not used			
14			3107.61	181.27	92.24	106.85		195.88	14				
15			3120.05	181.99	92.23	106.03		195.79	15				
16			3127.47	182.42	92.19	105.60		195.83	16				
17			3129.06	182.52	92.18	105.83		196.17	17				
18			3130.04	182.58	92.16	105.64		196.06	18				
19			3131.91	182.68	92.15	105.45		195.98	19				
20			3155.03	184.03	92.13	104.13		196.03	20				
21			3180.30	185.51	92.12	(102.71)		196.10	21	(102.78)			
22			3204.09	186.89	92.10	101.42		196.21	22				
23			3221.40	187.90	92.09	100.35		196.16	23				
24			3239.85	188.98	92.07	99.26		196.17	24				
25			3259.84	190.15	92.06	97.94		196.03	25				
26			3283.26	191.51	92.05	96.47		195.93	26				
27			3308.46	192.98	92.04	94.88		195.82	27				
28			3334.31	194.49	92.02	93.22		195.69	28				
29			3359.82	195.98	92.00	91.62		195.60	29				
30									30				
31									31				
32									32				
33	15 ¹		3127.25	182.41	92.21	105.58		195.78	33				
34	Base Line 2-11E		3125.78	182.33	92.22	105.71		195.82	34				
35									35				
36	Base Line (3-13) 30		3391.40	197.24	91.99	90.23		195.49	36				
37									37				
38									38				
39									39				
40									40				
41									41				
42									42				
43									43				
44									44				
45									45				
46									46				
47									47				
48									48				
49									49				
50									50				

AREA Swim Lake
 CLIENT Kerr Addison

UNITED GEOPHYSICAL
 GRAVITY COMPUTATION SHEET

PARTY 598
 PARTY CHIEF _____

ELEVATION CORRECTION FACTOR 0.05833 PROSPECT CORRECTION _____ MG
 COMP. BY _____ CHK. BY _____

Line 6 E

STA. NO.	BOOK PAGE	GRID.	ELEV.	ELEV. CORR.	LAT. CORR.	OBS. GRAV.	TERR. CORR.	BOUG. GRAV.	NO.	RECHECK OBS. GRAV.	BOUG. GRAV.	DATE RUN	DATE RECHECK
01									01				
02									02				
03									03				
04									04				
05									05				
06									06				
07									07				
08									08				
09									09				
10									10				
11									11				
12									12				
13									13				
14									14				
15									15				
16 S			3213.02	187.42	92.30	100.84		195.96	16				
17			3211.54	187.33	92.28	100.92		195.97	17				
18			3217.09	187.65	92.26	100.57		195.96	18				
19			3224.19	188.07	92.25	100.12		195.94	19				
20			3228.07	188.29	92.24	—		—	20				
21			3234.10	188.65	92.22	99.64		196.07	21				
22			3226.84	188.45	92.21	99.78		196.02	22				
23			3233.30	188.60	92.19	99.66		196.07	23				
24			3240.87	189.04	92.18	99.13		195.99	24				
25			3246.49	189.37	92.16	98.88		196.09	25				
26			3262.16	190.28	92.15	97.91		196.04	26				
27			3282.46	191.47	92.13	96.67		196.01	27				
28			3299.52	192.46	92.11	95.50		195.85	28				
29			3313.18	193.26	92.10	94.63		195.79	29				
30			3326.68	194.05	92.09	94.01		195.97	30				
31									31				
32									32				
33									33				
34									34				
35			3216.09	187.59	92.31	100.57		195.85	35				
36									36				
37									37				
38									38				
39									39				
40									40				
41									41				
42									42				
43									43				
44									44				
45									45				
46									46				
47									47				
48									48				
49									49				
50									50				

AREA Swim Lake
 CLIENT Kerr Addison

UNITED GEOPHYSICAL
 GRAVITY COMPUTATION SHEET

PARTY 598
 PARTY CHIEF _____

ELEVATION CORRECTION FACTOR 0.05833 PROSPECT CORRECTION _____ MG
 COMP. BY _____ CHK. BY _____

Line 77W

STA. NO.	BOOK PAGE	GRID.	ELEV.	ELEV. CORR.	LAT. CORR.	OBS. GRAV.	TERR. CORR.	BOUG. GRAV.	NO.	RECHECK OBS. GRAV.	BOUG. GRAV.	DATE RUN	DATE RECHECK
01									01				
02									02				
03									03				
04									04				
05									05				
06									06				
07									07				
08									08				
09									09				
10									10				
11									11				
12									12				
13									13				
14									14				
15									15				
16		13	3459.19	201.77	93.27	84.66	02	193.08	16				
17		13	3479.98	202.99	93.36	83.42	08	193.13	17				
18		19	3500.81	204.20	93.34	82.15	05	193.06	18				
19		19	3521.24	205.39	93.33	80.97	05	193.09	19				
20		11	3543.98	206.72	93.32	79.48	06	192.94	20				
21		17	3565.43	207.97	93.30	78.13	07	192.84	21				
22		18	3587.85	209.28	93.28	76.83	05	192.83	22				
23		13	3608.97	210.51	93.27	75.52	08	192.84	23				
24		19	3634.18	211.98	93.25	73.91	05	192.69	24				
25		15	3659.07	213.43	93.24	72.32	02	192.53	25				
26		13	3684.00	214.89	93.23	70.77	08	192.51	26				
27		11	3700.05	215.82	93.21	69.85	06	192.52	27				
28		13	3713.41	216.60	93.19	69.19	08	192.68	28	?			
29		13	3721.03	217.05	93.18	68.84	08	192.79	29				
30		13	3724.97	217.28	93.16	68.69	08	192.89	30				
31									31				
32									32				
33									33				
Box 34	13 W	110	3726.07	217.34	93.15	68.69	06	192.94	34				
35									35				
36									36				
Box 37	Line 2-75V	1.3	3448.09	201.13	93.38	85.42	08	193.25	37	?			
38									38				
39									39				
40									40				
41									41				
42									42				
43									43				
44									44				
45									45				
46									46				
47									47				
48									48				
49									49				
50									50				

AREA Swim Lake
 CLIENT Kerr Addison

UNITED GEOPHYSICAL
 GRAVITY COMPUTATION SHEET

PARTY 598
 PARTY CHIEF _____

ELEVATION CORRECTION FACTOR 0.05833 PROSPECT CORRECTION _____ MG
 COMP. BY _____ CHK. BY _____

Line 2W

STA. NO.	BOOK PAGE	GRID.	ELEV.	ELEV. CORR.	LAT. CORR.	OBS. GRAV.	TERR. CORR.	BOUG. GRAV.	NO.	RECHECK OBS. GRAV.	BOUG. GRAV.	DATE RUN	DATE RECHECK
01			3003.96	175.22	92.57	112.82		195.47	01				
02			3012.11	175.70	92.55	—		—	02				
03			3026.79	176.55	92.54	111.42		195.43	03				
04			3042.74	177.48	92.53	110.55		195.50	04				
05			3060.51	178.52	92.52	109.44		195.44	05				
06			3078.77	179.58	92.50	108.31		195.39	06				
07			3095.31	180.55	92.49	107.44		195.50	07				
08			3111.22	181.48	92.48	106.54		195.54	08				
09			3124.87	182.27	92.46	105.75		195.56	09				
10			3147.35	183.58	92.45	104.46		195.59	10				
11			3168.97	184.85	92.43	103.23		195.59	11				
12			3185.01	185.78	92.42	102.34		195.70	12				
13			3199.92	186.65	92.41	101.54		195.78	13				
14			3210.55	187.27	92.40	100.93	to 3	195.80	14				
15			3229.95	188.40	92.38	99.80		195.82	15				
16			3249.39	189.54	92.37	98.69		195.86	16				
Base line 1W Sta 2W			30085	175.04	92.58	113.03		195.49	17				
18									18				
19									19				
20									20				
21									21				
22									22				
23									23				
24									24				
25									25				
26									26				
27									27				
28									28				
29									29				
30									30				
31									31				
32									32				
33									33				
34									34				
35									35				
36									36				
37									37				
38									38				
39									39				
40									40				
41									41				
42									42				
43									43				
44									44				
45									45				
46									46				
47									47				
48									48				
49									49				
50									50				

AREA Swim Lake

UNITED GEOPHYSICAL
GRAVITY COMPUTATION SHEET

PARTY 598

CLIENT Kerr Addison

PARTY CHIEF _____

ELEVATION CORRECTION FACTOR 0.5833

PROSPECT CORRECTION _____

MG

COMP. BY DW

CHK. BY _____

Line 3W

STA. NO.	BOOK PAGE	GRID.	ELEV.	ELEV. CORR.	LAT. CORR.	OBS. GRAV.	TERR. CORR.	BOUG. GRAV.	NO.	RECHECK OBS. GRAV.	BOUG. GRAV.	DATE RUN	DATE RECHECK
01									01				
02									02				
03									03				
04									04				
05									05				
06									06				
07									07				
08									08				
09									09				
10									10				
11									11				
12									12				
13									13				
14									14				
15									15				
16			3258.52	190.07	92.39	98.30		195.98	16				
17			3274.07	190.98	92.38	97.35		195.95	17				
18			3286.03	191.67	92.37	96.66		195.96	18				
19			3299.26	192.45	92.35	95.78		195.88	19				
20			3308.85	193.01	92.34	95.33		196.00	20				
21			3315.76	193.40	92.33	94.83		195.90	21				
22			3324.34	193.91	92.32	94.41		196.00	22				
23			3325.78	193.99	92.30	94.34		196.03	23				
24			3330.01	194.24	92.29	—		—	24				
25			3335.77	194.58	92.28	93.86		196.16	25				
26			3341.77	194.93	92.26	93.48		196.15	26				
27			3350.13	195.41	92.25	—		—	27				
28			3353.98	195.64	92.23	92.81		196.22	28				
29			3372.53	196.72	92.22	91.64		196.14	29				
30			3388.64	197.66	92.21	90.57		196.02	30				
31									31				
32									32				
33									33				
34									34				
35									35				
36									36				
37									37				
38									38				
39									39				
40									40				
41									41				
42									42				
43									43				
44									44				
45									45				
46									46				
47									47				
48									48				
49									49				
50									50				

AREA Swim lake
 CLIENT Kerr Addison

UNITED GEOPHYSICAL
 GRAVITY COMPUTATION SHEET

PARTY 598
 PARTY CHIEF _____
 COMP. BY _____
 CHK. BY _____

ELEVATION CORRECTION FACTOR 05933 PROSPECT CORRECTION _____ MG

Line 6W

STA. NO.	BOOK PAGE	GRID.	ELEV.	ELEV. CORR.	LAT. CORR.	OBS. GRAV.	TERR. CORR.	BOUG. GRAV.	NO.	RECHECK OBS. GRAV.	BOUG. GRAV.	DATE RUN	DATE RECHECK
01			3040.91	177.38	92.62	-			01				
02			3060.61	178.53	92.60	109.56		195.49	02				
03			3083.92	179.89	92.59	108.24		195.54	03				
04			3107.24	181.25	92.58	106.92		195.59	04				
05			3127.49	182.43	92.56	105.70		195.57	05				
06			3146.79	183.55	92.55	104.58		195.58	06				
07			3162.10	184.45	92.54	103.76		195.67	07				
08			3178.99	185.43	92.52	102.69		195.60	08				
09			3196.37	186.44	92.51	108.17		? -	09				
10			3209.14	187.19	92.50	101.05		195.74	10				
11			3220.71	187.86	92.48	100.31		195.69	11				
12			3233.51	188.161	92.47	99.60		195.74	12				
13			3248.61	189.49	92.46	98.73		195.76	13				
14			3257.58	190.01	92.45	98.20		195.76	14				
15			3265.95	190.50	92.44	97.85		195.91	15				
16			3278.25	191.22	92.42	97.07		195.87	16				
17									17				
18									18				
19									19				
20									20				
21									21				
BL 1-6W			3024.70	176.43	92.63	111.64		195.44	22				
23									23				
24									24				
25									25				
26									26				
27									27				
28									28				
29									29				
30									30				
31									31				
32									32				
33									33				
34									34				
35									35				
36									36				
37									37				
38									38				
39									39				
40									40				
41									41				
42									42				
43									43				
44									44				
45									45				
46									46				
47									47				
48									48				
49									49				
50									50				

AREA Swim Lake
 CLIENT Keri Addison

UNITED GEOPHYSICAL
 GRAVITY COMPUTATION SHEET

PARTY 598
 PARTY CHIEF _____
 COMP. BY _____
 CHK. BY _____

ELEVATION CORRECTION FACTOR .05833 PROSPECT CORRECTION _____ MG

line 10W

STA. NO.	BOOK PAGE	GRID.	ELEV.	ELEV. CORR.	LAT. CORR.	OBS. GRAV.	TERR. CORR.	BOUG. GRAV.	NO.	RECHECK OBS. GRAV.	BOUG. GRAV.	DATE RUN	DATE RECHECK
01		.8	3065.13	178.79	92.67	108.78	05	194.95	01				
02		1.0	3097.53	180.68	92.66	106.92	06	195.00	02				
03		.7	3126.86	182.39	92.64	105.36	04	195.15	03				
04		.8	3150.04	183.74	92.63	104.06	05	195.22	04				
05		.5	3172.41	185.05	92.62	102.74	03	195.20	05				
06		.4	3198.02	186.54	92.61	101.19	02	195.14	06				
07		.8	3221.75	187.92	92.59	100.15	05	195.53	07				
08		-	3236.38	188.78	92.58	99.45	-	195.65	08				
09		.5	3251.72	189.67	92.57	98.57	03	195.70	09				
10		-8	3268.31	190.64	92.56	97.69	05	195.82	10				
11		.4	3287.63	191.77	92.54	96.61	02	195.86	11				
12		.7	3306.47	192.87	92.53	95.36	04	195.74	12				
13		-	3314.60	193.34	92.52	94.92	-	195.74	13				
14		-	3327.17	194.07	92.51	94.14	-	195.70	14				
15		-	3343.73	195.04	92.49	93.43	-	195.98	15				
16		-	3354.08	195.64	92.48	92.56	-	195.72	16				
17									17				
18									18				
19									19				
20									20				
21									21				
22									22				
Blind 1	10W	1.0	3031.98	176.86	92.68	110.67	06	194.91	23				
24									24				
25									25				
26									26				
27									27				
28									28				
29									29				
30									30				
31									31				
32									32				
33									33				
34									34				
35									35				
36									36				
37									37				
38									38				
39									39				
40									40				
41									41				
42									42				
43									43				
44									44				
45									45				
46									46				
47									47				
48									48				
49									49				
50									50				

AREA Swim Lake
 CLIENT Kerr Addison

UNITED GEOPHYSICAL
 GRAVITY COMPUTATION SHEET

PARTY 598
 PARTY CHIEF _____
 COMP. BY _____
 CHK. BY _____

ELEVATION CORRECTION FACTOR 0.05833 PROSPECT CORRECTION _____ MG

Line 11W

STA. NO.	BOOK PAGE	GRID.	ELEV.	ELEV. CORR.	LAT. CORR.	OBS. GRAV.	TERR. CORR.	BOUG. GRAV.	NO.	RECHECK OBS. GRAV.	BOUG. GRAV.	DATE RUN	DATE RECHECK
01									01				
02									02				
03									03				
04									04				
05									05				
06									06				
07									07				
08									08				
09									09				
10									10				
11									11				
12									12				
13									13				
14									14				
15									15				
16	2 - 11W	-	3364.69	196.26	92.49	91.91	-	195.68	16				
17		.8	3379.41	197.12	92.48	90.93	05	195.62	17				
18		.7	3384.35	197.41	92.46	90.73	04	195.72	18				
19		.7	3390.46	197.77	92.45	90.39	04	195.75	19				
20		-	3395.51	198.06	92.43	-	-	-	20				
21		-	3401.95	198.44	92.42	89.80	-	195.82	21				
22		-	3407.18	198.74	92.40	89.55	-	195.89	22				
23		.4	3413.81	199.13	92.39	89.16	02	195.92	23				
24		.7	3420.65	199.53	92.37	88.67	04	195.87	24				
25		.8	3423.87	199.71	92.36	88.57	05	195.97	25				
26		.7	3424.73	199.76	92.35	88.54	04	195.99	26				
27		.3	3424.94	199.78	92.33	88.53	02	196.00	27				
28		.7	3426.39	199.86	92.32	88.51	04	196.09	28				
29		.5	3430.66	200.11	92.30	88.24	03	196.08	29				
30	BL 3 - 11W		3429.61		92.30	86.80			30				
31									31				
32									32				
33									33				
34									34				
35									35				
36									36				
37									37				
38									38				
39									39				
40									40				
41									41				
42									42				
43									43				
44									44				
45									45				
46									46				
47									47				
48									48				
49									49				
50									50				

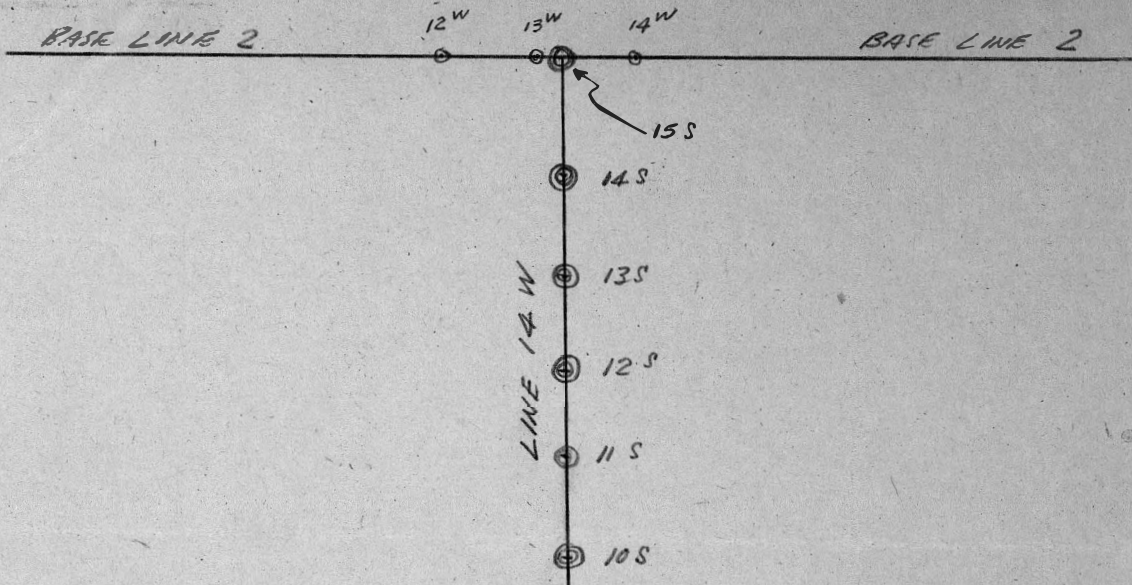

STATION	ELEV. DIFFERENCE FROM L14W/15S ON BASE LINE 2	SLOPE DIST		
		TO STA.	FT	V.A.
LINE 14W/15S	0.00 FT.	L2/12W	126.40	-7°35'
" /14S	-16.27	L2/13W	26.87	-14°15'
" /13S	-26.71	L2/14W	79.37	+5°01'
" /12S	-41.22	L14W/14S	129.40	-7°47'
" /11S	-57.01	L14W/12S	189.85	+40°05'
" /10S	-71.48	L14W/12S	99.85	-8°46'
BASE LINE 2 /12W	-14.43	L14W/11S	95.15	-9°35'
" /13W	-2.36	L14W/10S	200.00	-9°22'
" /14W	+11.19			

3330.86
 3315.68
 14.47
 3130.15
 71.48
 57.01
 14.47