

109 K  
 ROSE CREEK  
 AIRBORNE E. M.

DYNASTY EXPLORATION LIMITED  
 AIRBORNE ELECTROMAGNETIC SURVEY

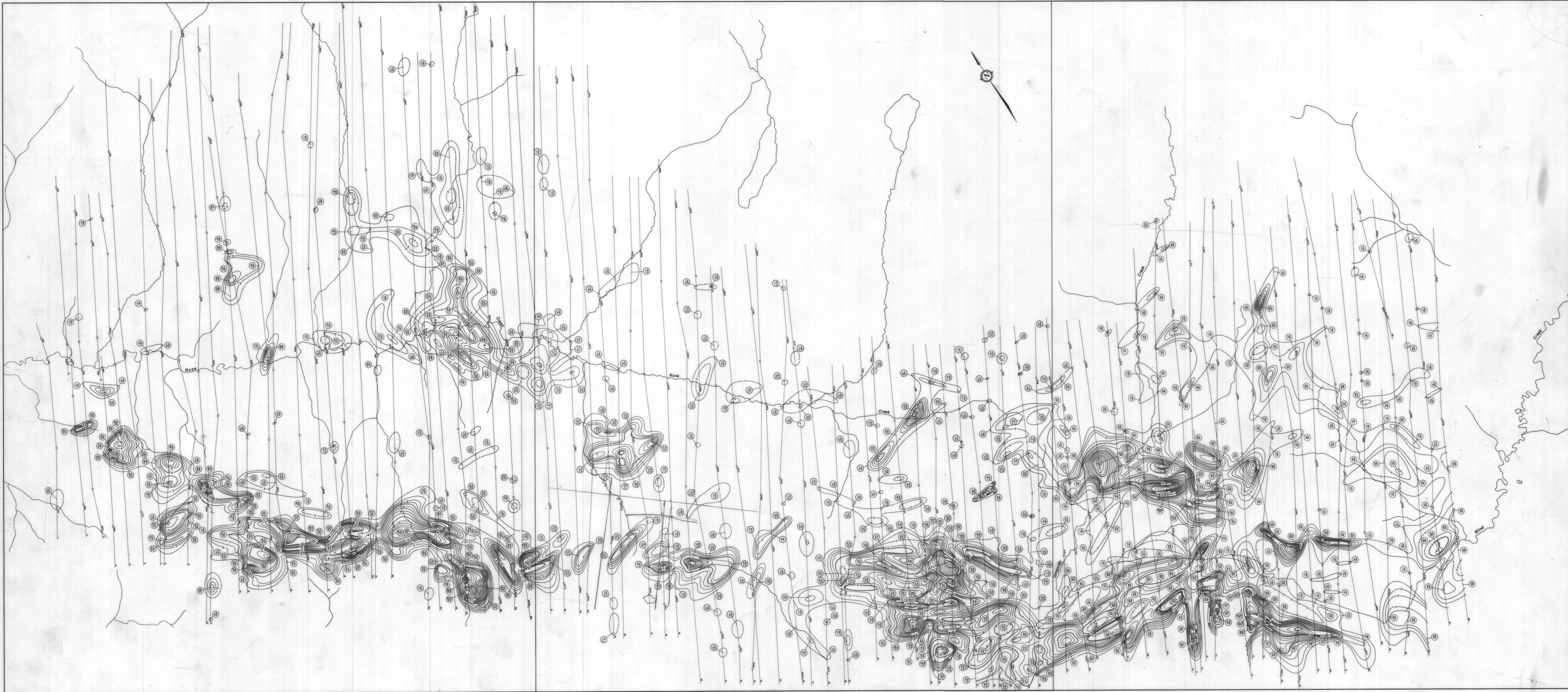

MEAN FLIGHT LINE SPACING ----- 1000 FEET  
 MEAN TERRAIN CLEARANCE ----- 200 FEET  
 ELECTROMAGNETIC CONTOURS 5, 10, 15 etc -----  
 1, 2, 3, 4 etc -----  
 FIDUCIAL POINTS ----- 0.3690  
 FLIGHT LINES -----

The contours represent amplitude of in phase response of the resultant field expressed in parts per million of the primary  
 The figures  $\frac{5}{2}$  represent amplitude in phase component  
 quadrature component  
 The frequency of the primary current is 4000 cycles per second

ROSE CREEK AREA  
 YUKON TERRITORY

010193

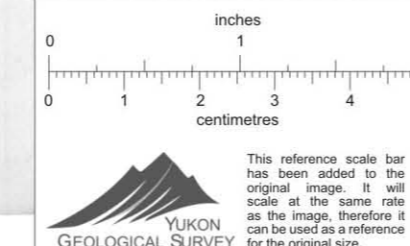
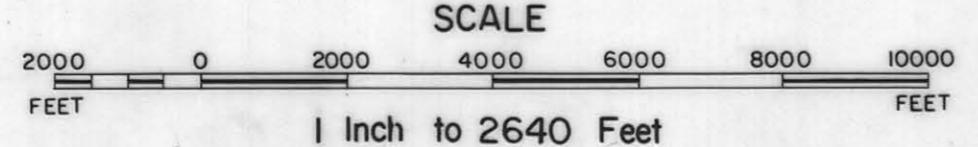

Flown and Compiled  
 by  
 LOCKWOOD SURVEY CORPORATION LIMITED  
 TORONTO, CANADA  
 1965

