

GRUM DEPOSIT
SECTION: 00N
PANEL: 2
FAULT FEATURES

010956

CYPRUS ANVIL MINING CORPORATION	
GRUM	
VERTICAL CROSS SECTION 00N	
42 DEG VIEW AZIMUTH 132 DEG PROFILE	
SCALE: 500 UNITS, METRES	DRAWN BY: PARAGAN SHUKR
PLUME CONNECTION: 40	PANEL NO: 2
3 DEC 1991 2:48 PM	
COORDINATE SYSTEM: S. T. N.	

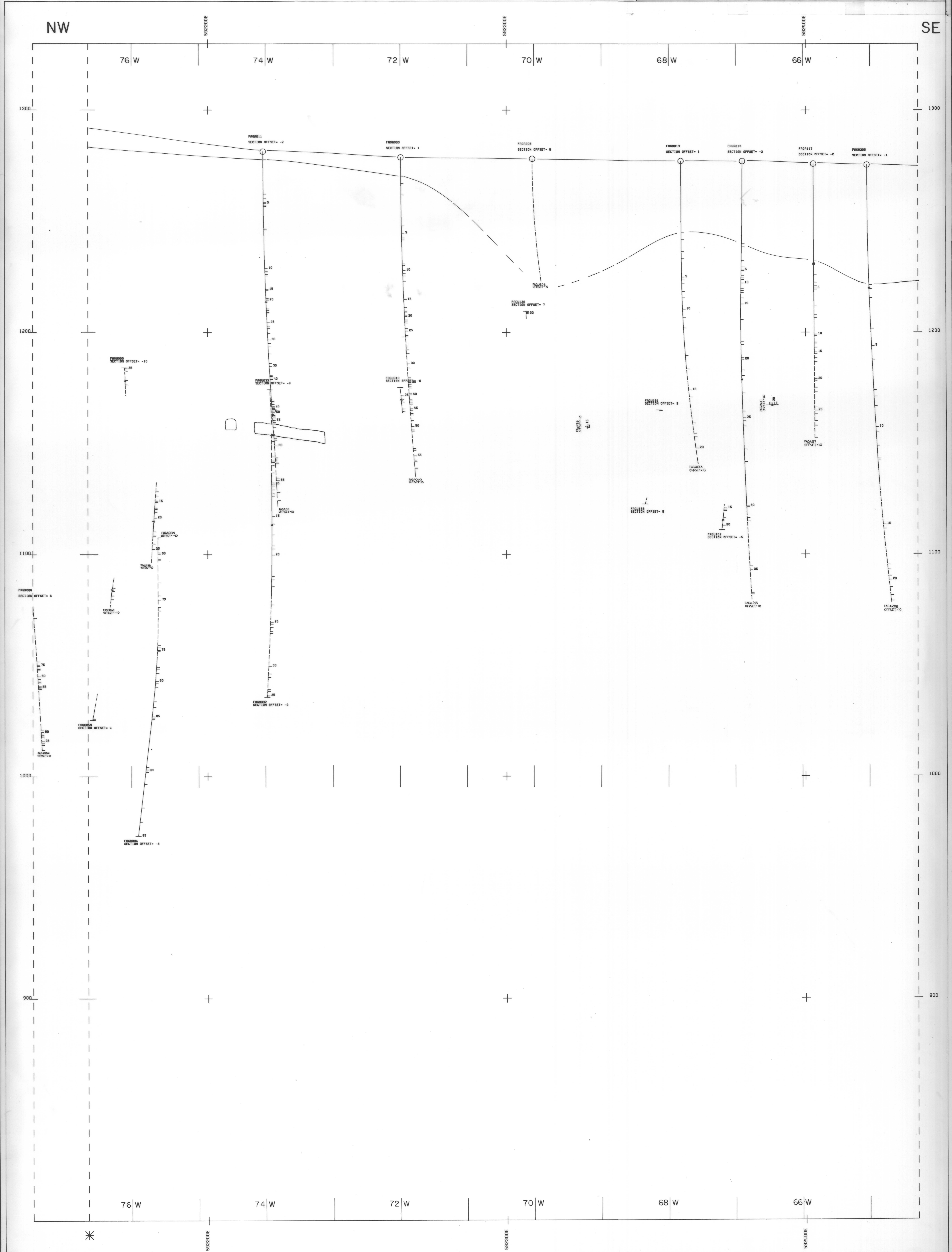

INDEX

SHEET 1	SHEET 2	SHEET 3
---------	---------	---------

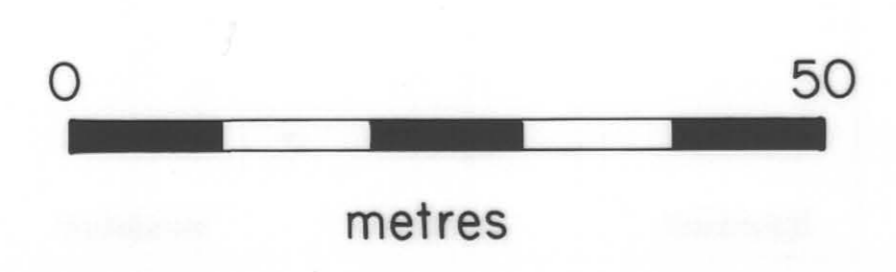

INTERPRETED BY	DATE	DRAWN BY	DATE	CYPRUS ANVIL MINING CORPORATION
				GRUM DEPOSIT
				SCALE: 1:500 metric
				FIGURE NO.