

GRUM DEPOSIT
SECTION: 02N
PANEL: 1
FAULT FEATURES

010980

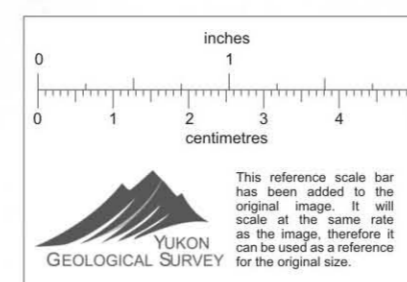

SCALE: 500 METRES
DRAWN BY: PROSODIA DHTD
PLUMBE CONNECTION: NS
10 DEC 1986 1:13 PM
COORDINATE SYSTEM: U. T. M.

CYPRUS ANVIL MINING CORPORATION
GRUM
VERTICAL CROSS SECTION 02N
42 DEG VIEW AZIMUTH 132 DEG PROFILE

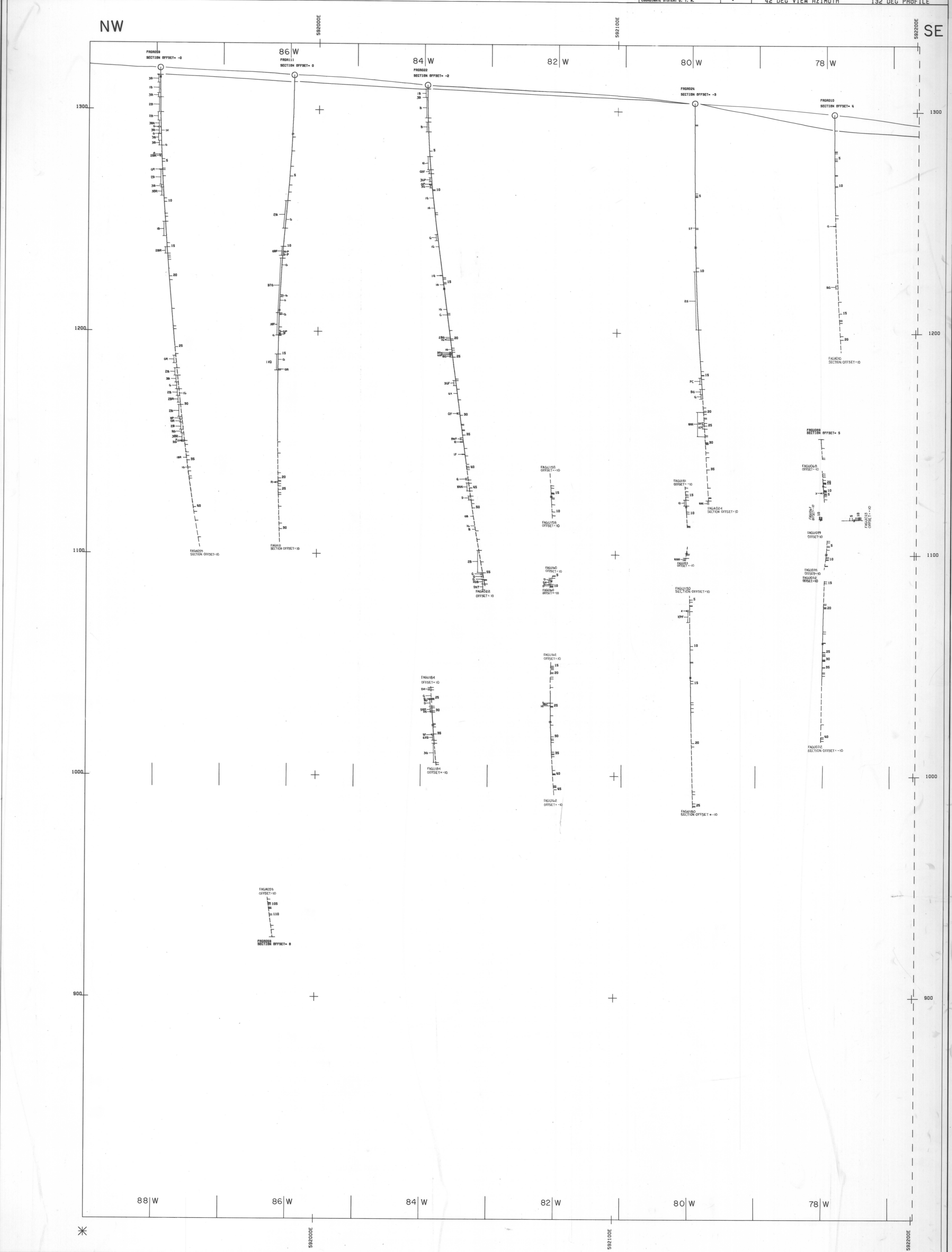

INDEX		
SHEET 1	SHEET 2	SHEET 3

INTERPRETED BY	DATE	DRAWN BY	DATE

CYPRUS ANVIL MINING CORPORATION	
GRUM DEPOSIT	
SCALE: 1:500 metric	FIGURE NO.