

GRUM DEPOSIT  
SECTION: 05N  
PANEL: 1  
FAULT FEATURES

011003

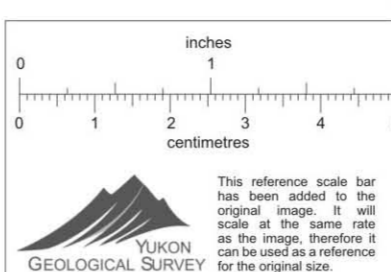

SCALE: 500 METRES  
DRAWN BY: P. P. P. P.  
PLUMB CONNECTION: 95  
10 DEC 1998 1:02 PM  
COORDINATE SYSTEM: U. T. M.  
CYPRUS ANVIL MINING CORPORATION  
GRUM  
VERTICAL CROSS SECTION 05N  
42 DEG VIEW AZIMUTH 132 DEG PROFILE

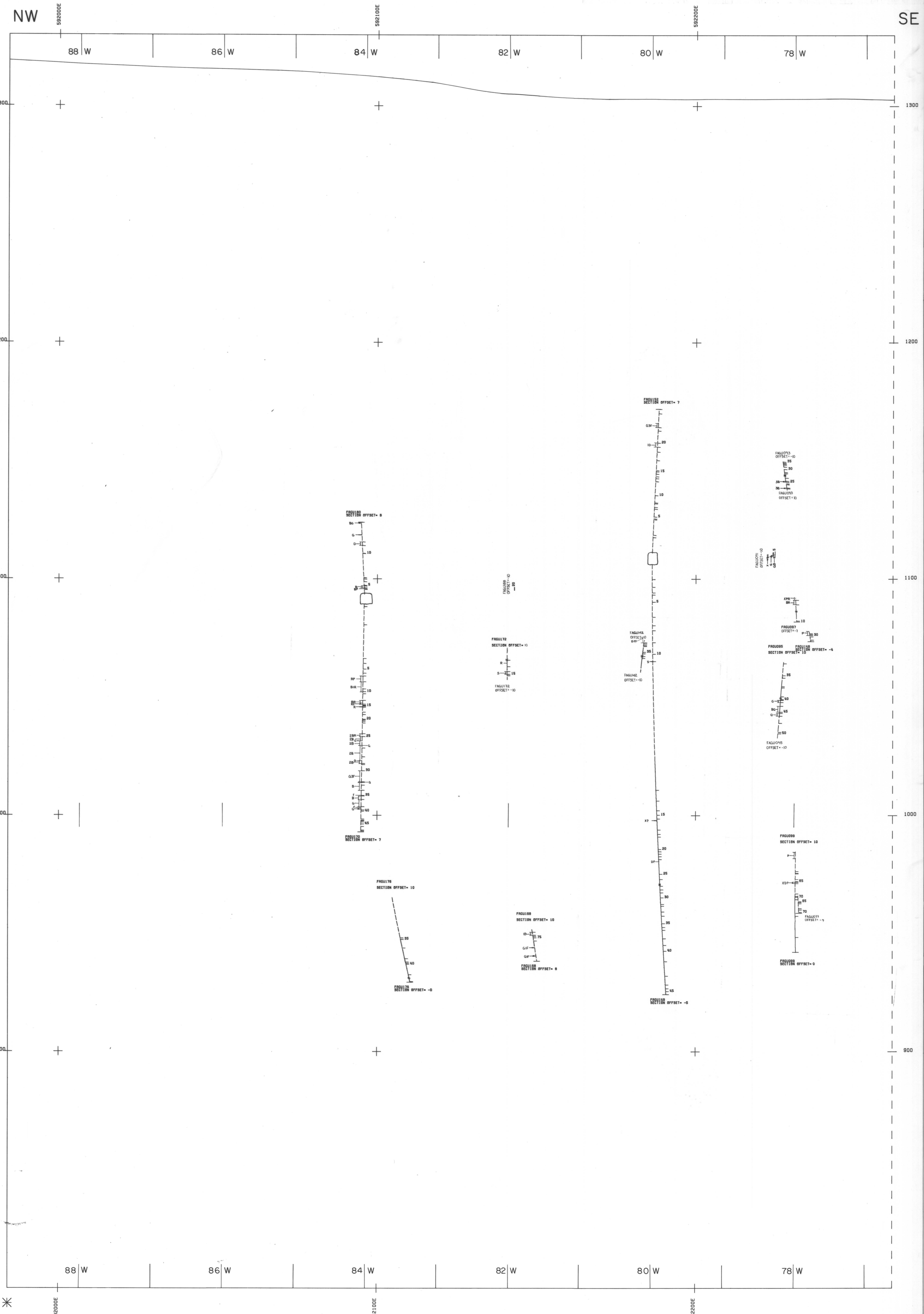

INDEX

SHEET 1	SHEET 2	SHEET 3
---------	---------	---------

INTERPRETED BY	DATE	DRAWN BY	DATE

CYPRUS ANVIL MINING CORPORATION  
GRUM DEPOSIT  
SCALE: 1:500 metric  
FIGURE NO.