

GRUM DEPOSIT
SECTION: 10N
PANEL: 2
S2 STRUCTURE

011042

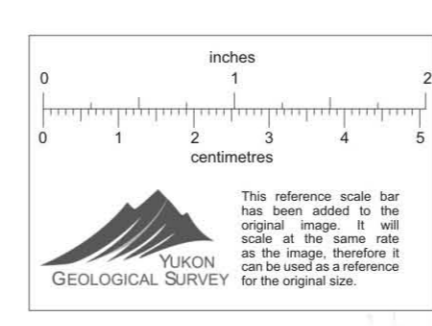

SCALE: 500 UNITS: METRES
DRAWN BY: P. P. DIMITRIADIS
PLANE CORRECTION: 40
27 NOV 1986 11:18 PM
COORDINATE SYSTEM: U. T. M.

CYPRUS ANVIL MINING CORPORATION
GRUM
VERTICAL CROSS SECTION 10N
42 DEG VIEW AZIMUTH 132 DEG PROFILE

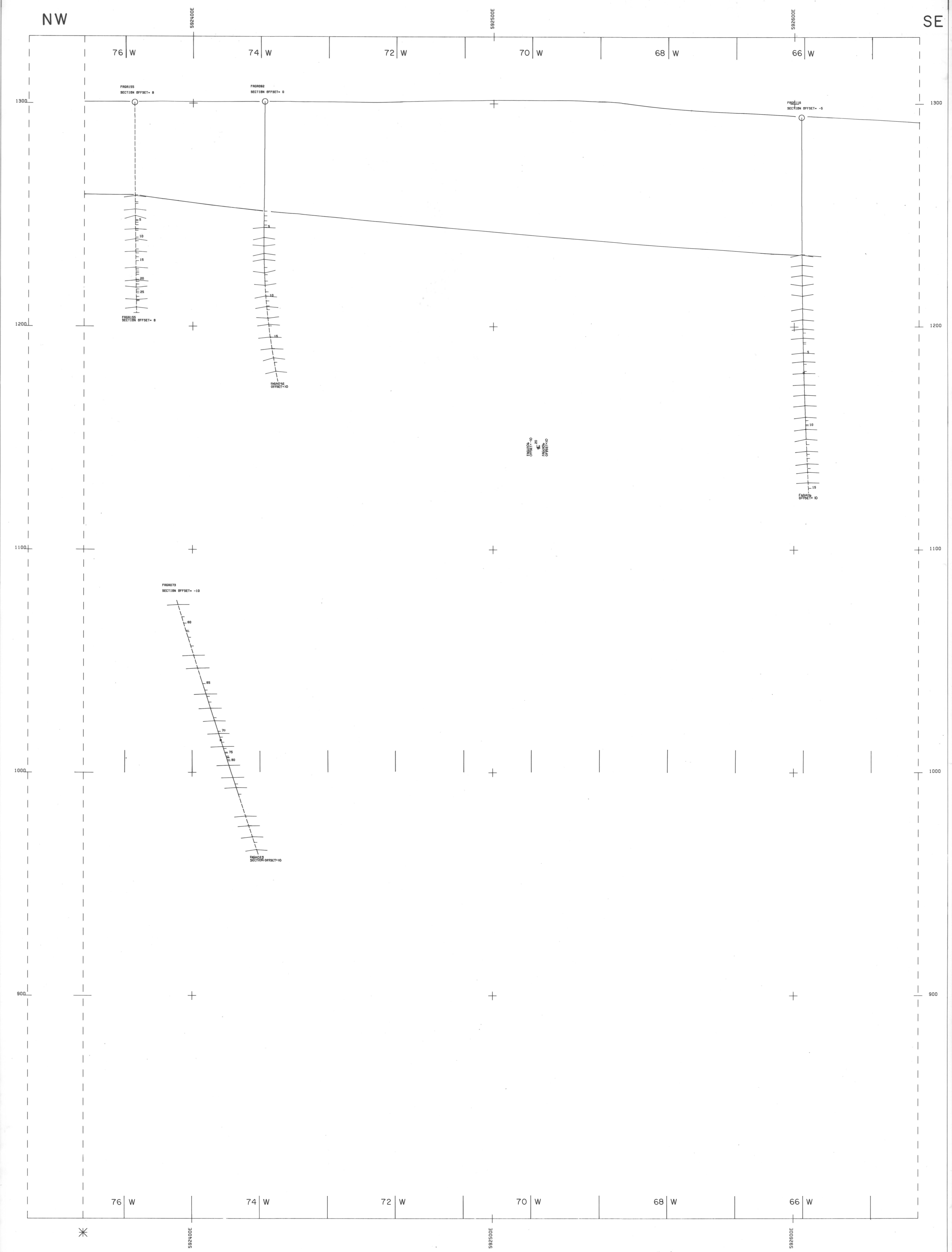

GRUM DEPOSIT
SECTION: 10N
PANEL: 2
S2 STRUCTURE

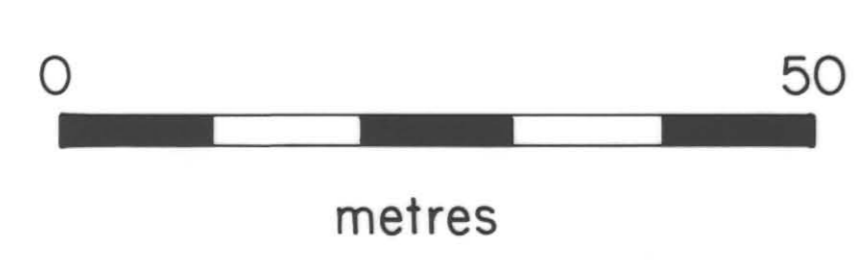

INDEX		
SHEET 1	SHEET 2	SHEET 3

INTERPRETED BY	DATE	DRAWN BY	DATE

CYPRUS ANVIL MINING CORPORATION	
GRUM DEPOSIT	
SCALE: 1:500 metric	FIGURE NO.