

011069

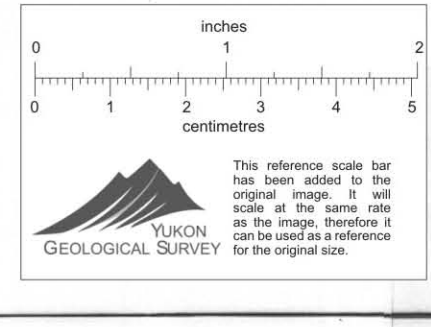

SCALE: 500 METRES	CYPRUS ANVIL MINING CORPORATION
DRAWN BY: PROSODOR DIMITROU	GRUM
PLANNING CONNECTION: PLUMLEY 11 TRUSS, 312	VERTICAL CROSS SECTION 68W
28 SEP 1994 8:10 AM	PANEL NO. 2
COORDINATE SYSTEM: U. T. M.	312 DEG VIEW AZIMUTH 42 DEG PROFILE

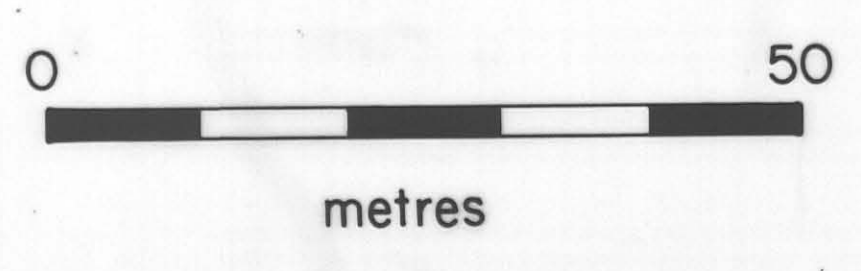
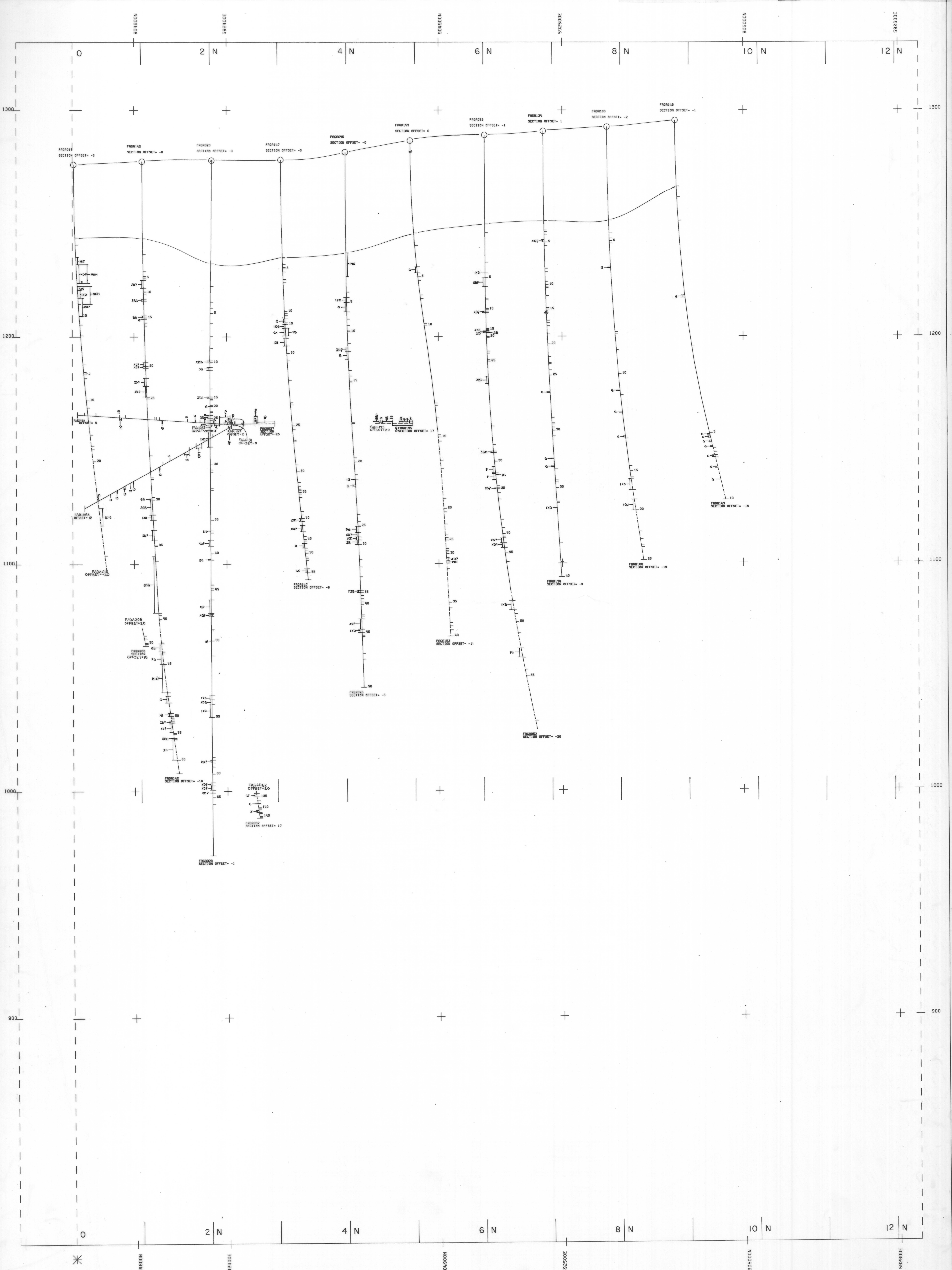

INDEX

SHEET 1	SHEET 2	SHEET 3
---------	---------	---------

INTERPRETED BY	DATE	DRAWN BY	DATE

CYPRUS ANVIL MINING CORPORATION	
GRUM DEPOSIT	
SCALE: 1:500 metric	FIGURE NO.