

011081

CYPRUS ANVIL MINING CORPORATION	
GRUM	
VERTICAL CROSS SECTION 61W	
312 DEG VIEW AZIMUTH 42 DEG PROFILE	
SCALE: 500 UNITS: METRES	DATE: 27 APR 1984 3:19 PM
DRAWN BY: PROBASK OZDOG	COORDINATE SYSTEM: U. T. M.
PLUNGE CORRECTION: PLUNGE: 11 TREND: 312	PANEL NO: 2

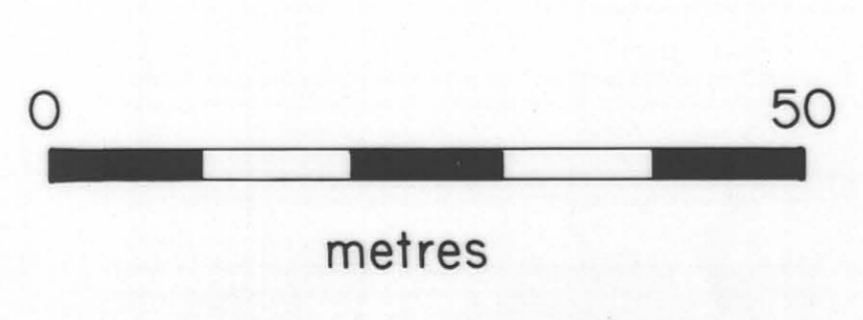
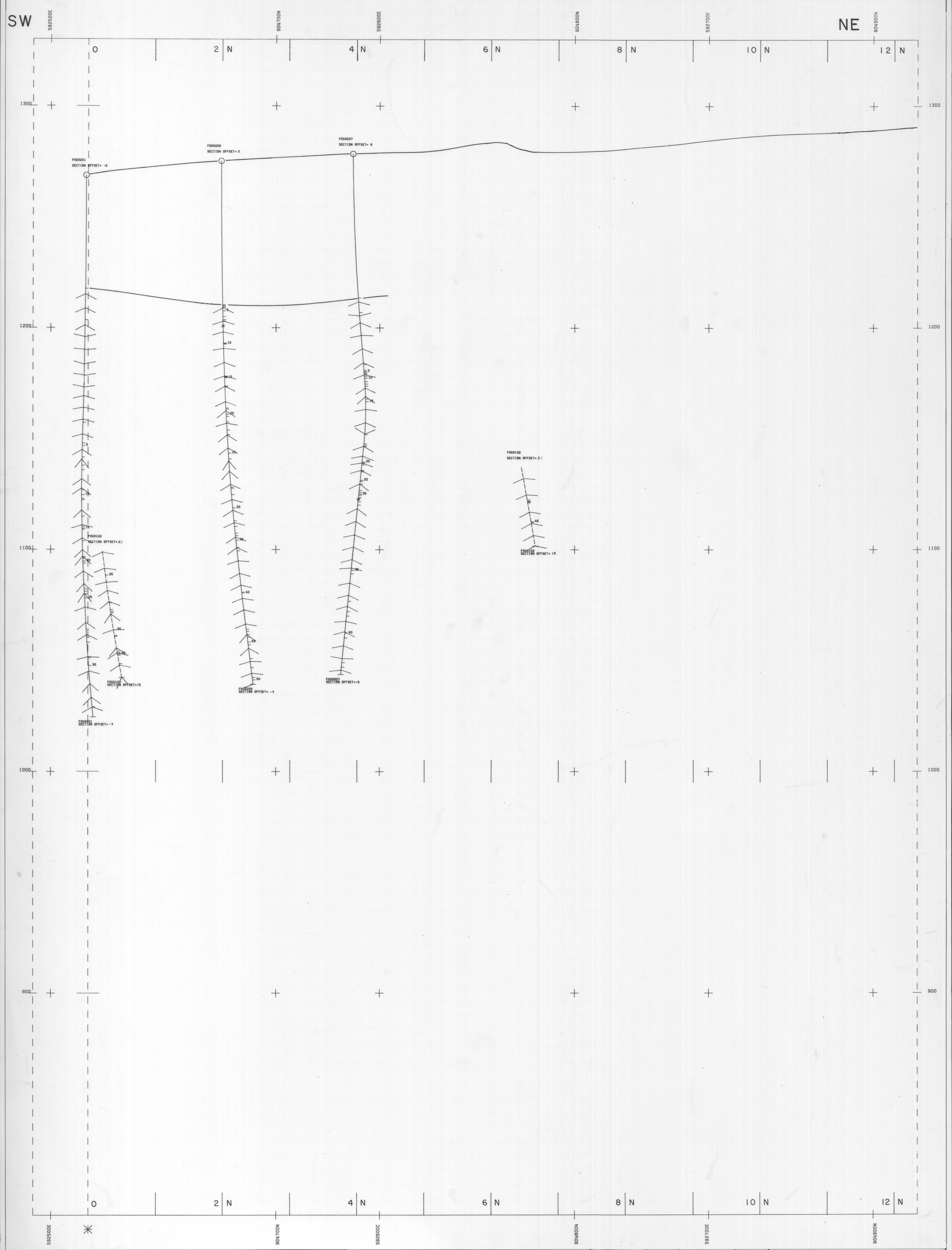

INDEX

SHEET 1	SHEET 2	SHEET 3
---------	---------	---------

INTERPRETED BY	DATE	DRAWN BY	DATE	CYPRUS ANVIL MINING CORPORATION
				SCALE: 1:500 metric
				FIGURE NO.