

50
100
200

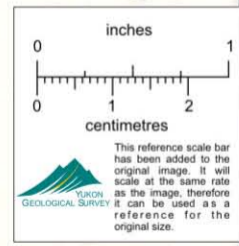
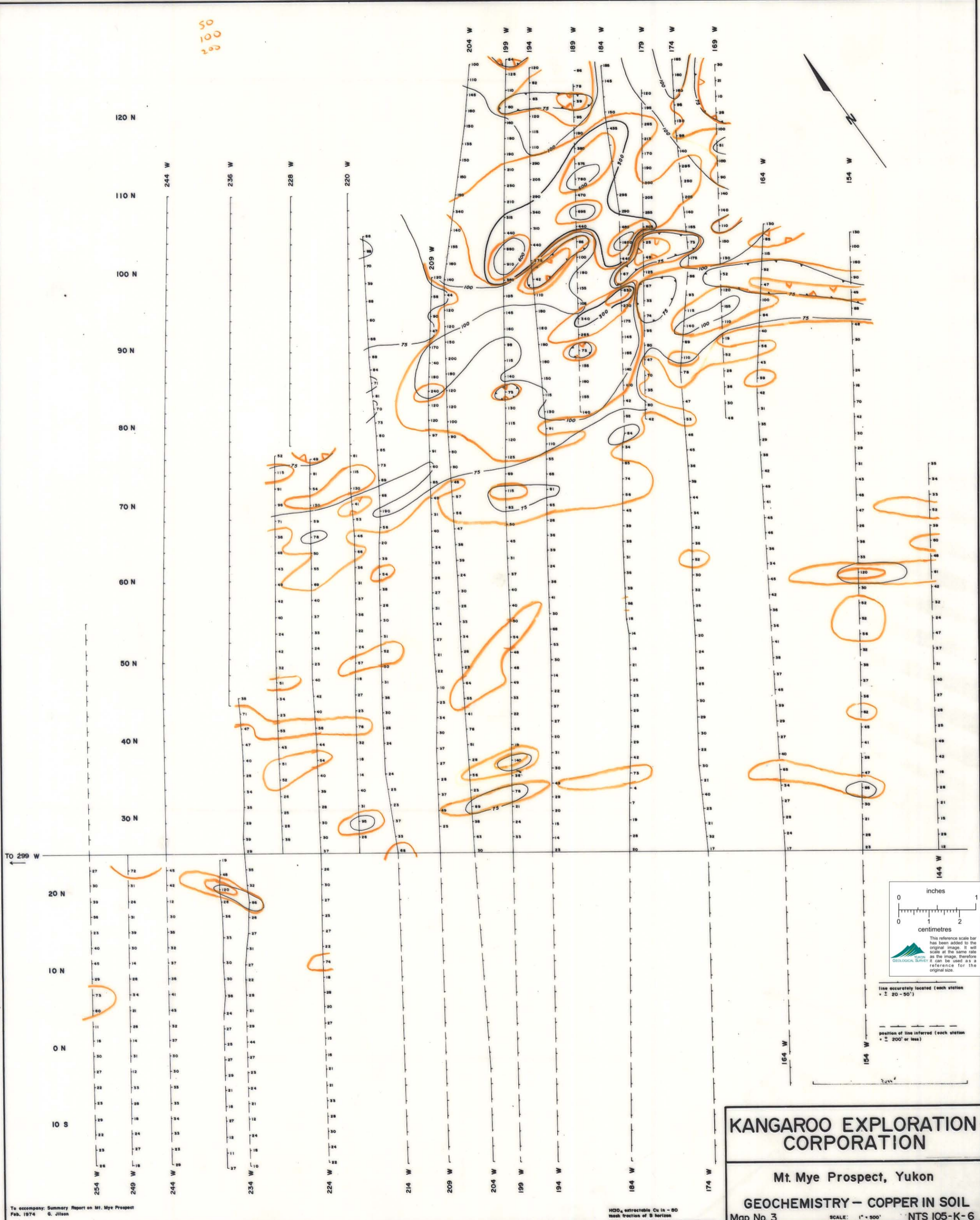

line accurately located (each station
± 20' - 50')

position of line inferred (each station
± 200' or less)

KANGAROO EXPLORATION CORPORATION

Mt. Mye Prospect, Yukon

GEOCHEMISTRY - COPPER IN SOIL

Map No. 3 SCALE: 1" = 500' NTS 105-K-6

To accompany: Summary Report on Mt. Mye Prospect
Feb. 1974 G. Jilson

HClO₄ extractable Cu in - 80
mesh fraction of B horizon

011786