

Name of owner(s) or principal(s) Denise Anderson

012196

Address Box 309 Whitehorse N.T. 209 Strickland road

Location of Property Mount William Creek N.T. 105-I-7

Description of Property: Ag Group

Number of Claims; staked 12, required _____.

Type of Mineralization, Values, and Dimensions:

1/ Copper showing Averaging 1.89% (Censes) Coal sample to 4.89%

2/ No Ag show. Not located.

3/ Proprietor of "Maxine Developments (NPL)", 90-102 oz Ag + 40% Pb across vein on mountain. 12' wide at top 300' wide at base.

4/ Other properties with up to 3438 oz Ag.

Previous Work; prospecting, geological, geophysical, geochemical, and development. (Give dates where possible):

Sampling

Comments: Claim to have very large porphyry type Cu body in central Yukon somewhere. Not staked though + ss was vague about details.

Disposition: Said we'd be in touch if interested.

Cairns

1908

p10

1910

57-60

Burton

1936

p. 56.

1957

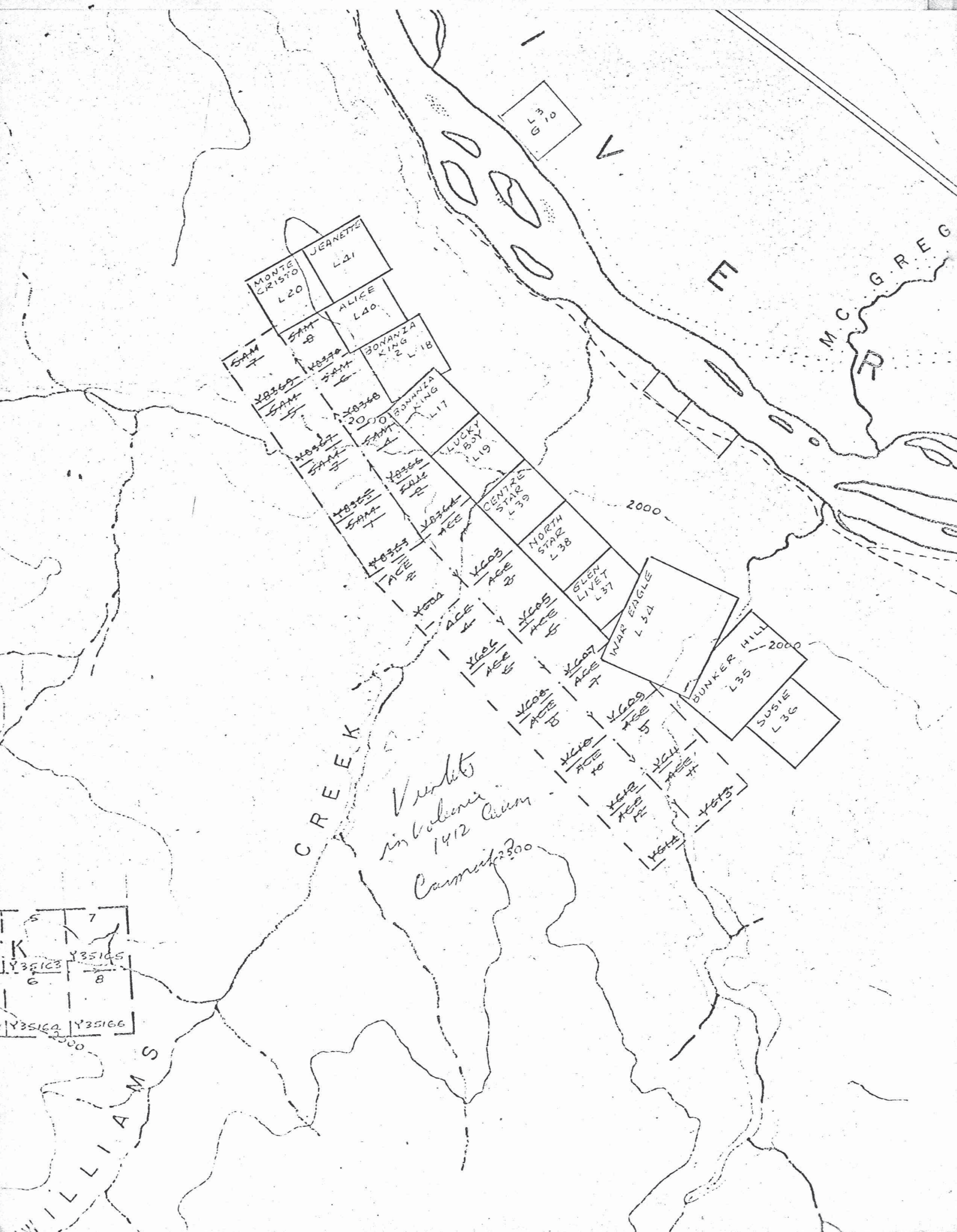

L3
G10

MONTE CRISTO L20
JEANETTE L21

SAM 8
ALICE L40

~~Y3360~~ SAM 8
BONANZA KING 2 L18

~~Y3360~~ SAM 8
BONANZA KING L17

~~Y3360~~ SAM 8
LUCKY BOY L19

~~Y3360~~ SAM 8
CENTRE STAR L39

~~Y3360~~ SAM 8
NORTH STAR L38

~~Y3360~~ ACE 8
ELEN LIVET L37

~~Y3360~~ ACE 8
WAR EAGLE L34

~~Y3360~~ ACE 8
BUNKER HILL L35

~~Y3360~~ ACE 8
SUSIE L36

~~Y3360~~ ACE 8

~~Y3360~~ ACE 8

~~Y3360~~ ACE 8

CREEK

Vendit
in Publica
Curia
1412 Acres
2300

5 7
K
Y351C3 Y351C5
6 8
Y351C6 Y351C8

WILLIAMS

MCGREG

TO MR DENNIS ANDERSON

OFFICE Box 359 WHITEHORSE

FROM ECHISHALM

OFFICE Box 3650 WHITEHORSE, Y.T.

SUBJECT RE- COPPER PROSPECT

DATE JUNE 22/66

MESSAGE Dear Mr Anderson:

When you were last in the office you mentioned to T. Sedler-Brown our geologist that you knew of the location of a large porphyry type copper orebody "somewhere in the central Yukon". May we hear further from you regarding this.

Yours very truly

SIGNED

E. Chisholm (TED CHISHOLM)

EXPLORATION MANAGER

REPLY

DATE

OFFICE

SIGNED

PROPERTY INFORMATION FORM

Name of owner(s) or principal(s) Denise Anderson

Address Box 309 Whitehorse Y.T. 209 Strickland or at Can. Legion.

Location of Property Meritt + William Creeks Y.T. 105-I-7.

Description of Property: Ace Group.

Number of Claims; staked 12, required _____.

Type of Mineralization, Values, and Dimensions:

- 1/ Copper showing Averaging 1.89%. Grab sample to 4.89%.
- 2/ Mo Ag show. Not located.
- 3/ Proprietor of "Maxine Developments (NPL)", 90-102 oz Ag + 40% Pb across vein on mountain. 12' wide at top 300' wide at base.
- 4/ Other properties with up to 3438 oz Ag.

Previous Work; prospecting, geological, geophysical, geochemical, and development. (Give dates where possible):

Sampling

Comments: Claim to have very large porphyry type Cu body in central Yukon somewhere. Not staked though + so was vague about details.

Disposition: Said we'd be in touch if interested.