

# SHEET 115-J-10

LATITUDE 62°30' TO 62°45'  
LONGITUDE 138°30' TO 139°00'

**NOTICE**

THIS MAP IS ISSUED AS A PRELIMINARY GUIDE FOR WHICH THE DEPARTMENT OF NORTHERN AFFAIRS AND NATIONAL RESOURCES WILL ACCEPT NO RESPONSIBILITY FOR ANY ERRORS, INACCURACIES OR OMISSIONS WHATSOEVER ON THE SHEET BEFORE ADEQUATE SURVEYS HAVE BEEN MADE.

**CANADA**  
DEPARTMENT OF NORTHERN AFFAIRS AND NATIONAL RESOURCES  
NORTHERN ADMINISTRATION AND LANDS BRANCH  
MINING AND LANDS DIVISION

SCALE 1/2 MILE TO 1 INCH

ISSUED UNDER THE AUTHORITY OF THE MINISTER  
NORTHERN AFFAIRS AND NATIONAL RESOURCES

012464

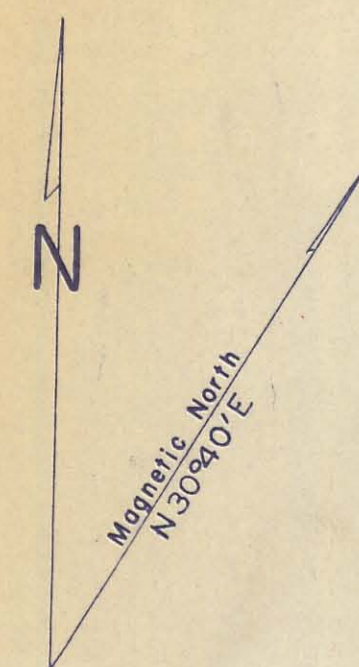
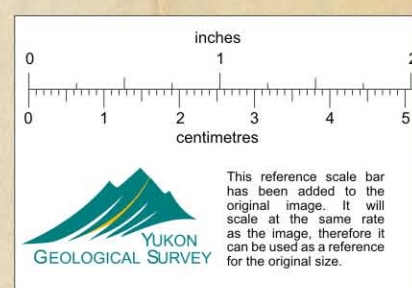

115-J-14	115-J-15	115-J-16
115-J-11	115-J-10	115-J-9
115-J-6	115-J-7	115-J-8

NOTE: FOR PLACER SEE 115J-10PLACER

