

## Casino geology

Paul told me that they had cracked the metallurgical problems of Van Gorda which was good news. Mr. Lieber talked as though Anvil has more ore than has been given out and I wondered if he was just had an optimistic or if he really meant what he said.

Casino strike really indicates the importance of testing the areas around the heads of all the old placer creeks. I look for something to be discovered in the angle of Hayes Creek. There was work on Hayes Creek quite far up in 1898 as well as at Kline Gulch and Butterfield Creek. Then there was a pretty good place on Rude Creek. In 1941 Stevenson and Leslie were still making a steady living from it. They bought a radio but the first time they turned it on they got German Nazi propaganda so they smashed it up and threw it outside. The broken radio was lying outside the cabin when we went by 1941.

Thanks again and very best wishes to all  
of you  
yours sincerely, Hugh S. Bostock

# **SPECIAL RELEASE**

November 10, 1969

We have received partial assays on Hole P22 which are in the opinion of the Directors sufficiently interesting, when read in conjunction with the balance of the report to the shareholders of October 30, 1969, that they should be released immediately.

In the case of Hole P22, which is within the Patton Hill Block, there appears to be little, if any, oxide zone. The secondary zone begins at 30 feet and drilling indicates that from 30 feet to 240 feet, or a length of 210 feet, grade is 1.05% copper and .019% MoS<sub>2</sub>. In a further length of 240 feet to 585 feet, or a total of 345 feet, with results in both the secondary zone and the primary zone the average is .51% copper and .04% MoS<sub>2</sub>. The hole was stopped in mineralization at 1,200 feet. Assays are continuing.

Hole P23 is now being drilled 800 feet to the northwest of P22 and Hole P25 is now being drilled 1,600 feet to the northwest of P22. Assays are not expected for several days.

# **BRAMEDA RESOURCES LIMITED CASINO SILVER MINES LTD. (N.P.L.)**

Report to the Shareholders  
on the Casino and Canadian Creek  
Property, Yukon Territory:

October 30, 1969

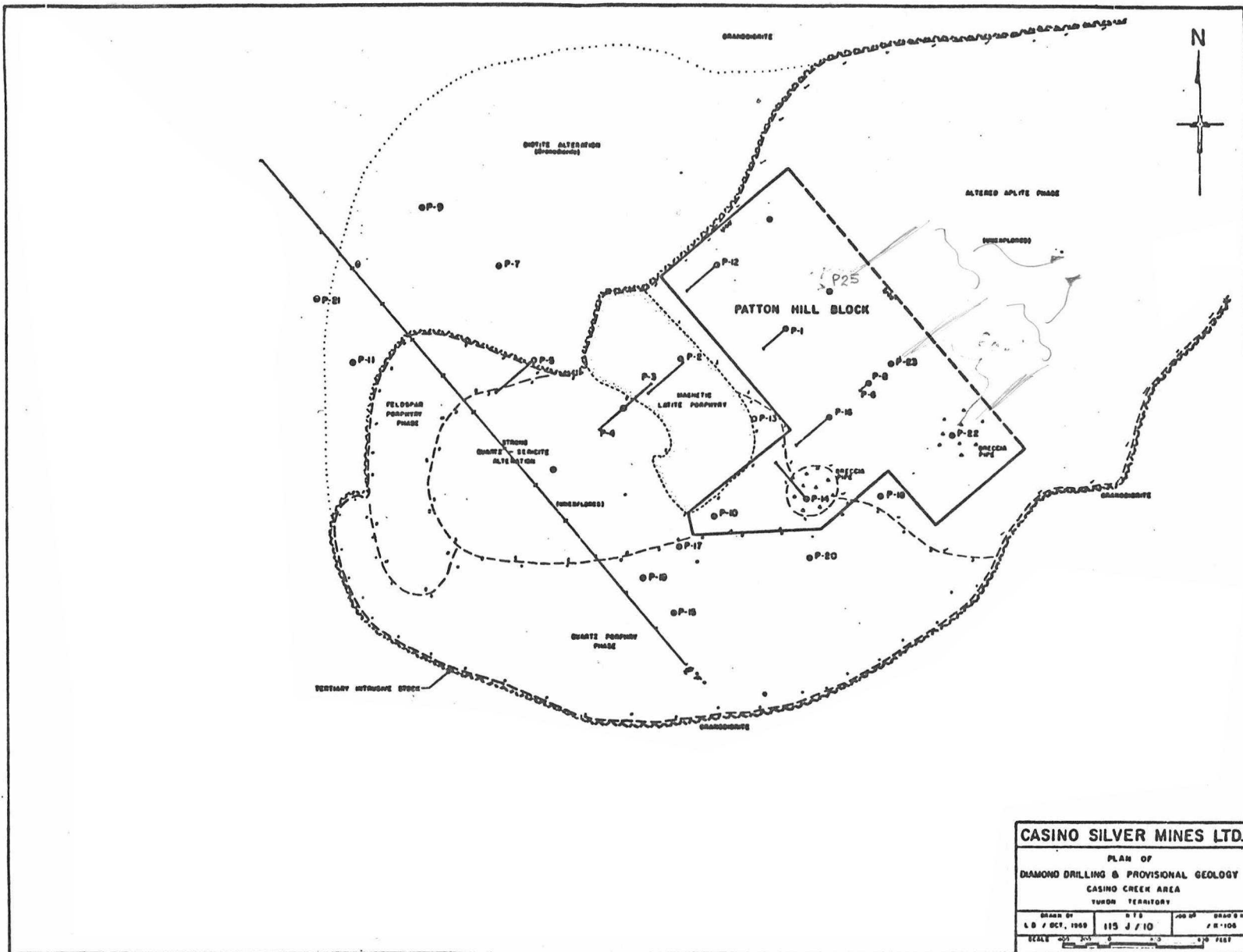

1/4 mi = 1 inch.

115-J-10  
Casino

115J10  
Casino Geology

