

GEOCHEMICAL SURVEYS AND
GEOLOGICAL MAPPING
AH13-28 CLAIMS

June 2-10 & Aug.16-18, 1967

By: R. Vogwill

GEOCHEMICAL SURVEYS AND
GEOLOGICAL MAPPING
AH13-28 CLAIMS,
TWIN LAKES AREA,

WHITEHORSE MINING DISTRICT
YUKON TERRITORY.

LATITUDE $61^{\circ}44'$
LONGITUDE $136^{\circ}05'$

JUNE 2-10, 1967.,
and
AUGUST 16-18, 1967.

Atlas Explorations Limited.

by
Richard I.J. Vogwill.

GEOCHEMICAL SURVEYS AND GEOLOGICAL
MAPPING-PROSPECTING,
CLAIMS AH13-28,
TWIN LAKES AREA.

TABLE OF CONTENTS

	PAGE
Location map for claims.	
Introduction, Previous work, Present work	1
Method of survey	2
Results, Conclusions, Recommendations	3

APPENDICES

1. Cost summary

2. Affidavit supporting summary of costs

3. Personnel

Geological Map of claim group

Geochemical grids on claim group

cc E. O. Gisholm

Photo # A 11369-5

note: original

in Whitehorse

Geological Map of AH 13-28

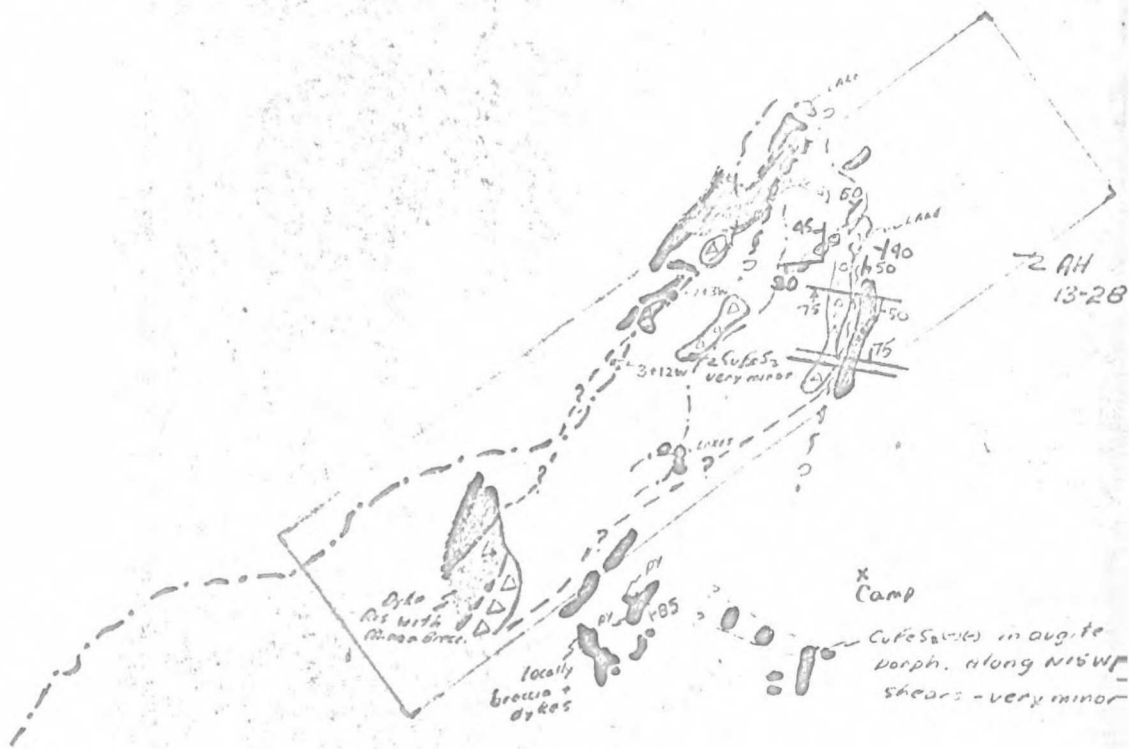
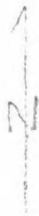

- - - = Assumed contact.
- py = pyrite
- [Solid black box] = Gneiss
- [Dark grey box] = Intrusive
- [Box with triangles] = Volcanic Breccia
- [Box with horizontal lines] = Dike Rocks
- [Line with 'dip & strike of Bedd. + Contacts'] = Dip & strike of Bedd. + Contacts
- [Line with 'Joints'] = Joints
- [Line with 'Possible Faults'] = Possible Faults
- [Line with 'Dip & strike of Mo. Calcite Filled Joint Streams'] = Dip & strike of Mo. Calcite Filled Joint Streams

Scale 1" = 1/2 mile. Riv

Geochemical Grid, AH13-28
Twin Lakes Area.
with closer Grid Superimposed

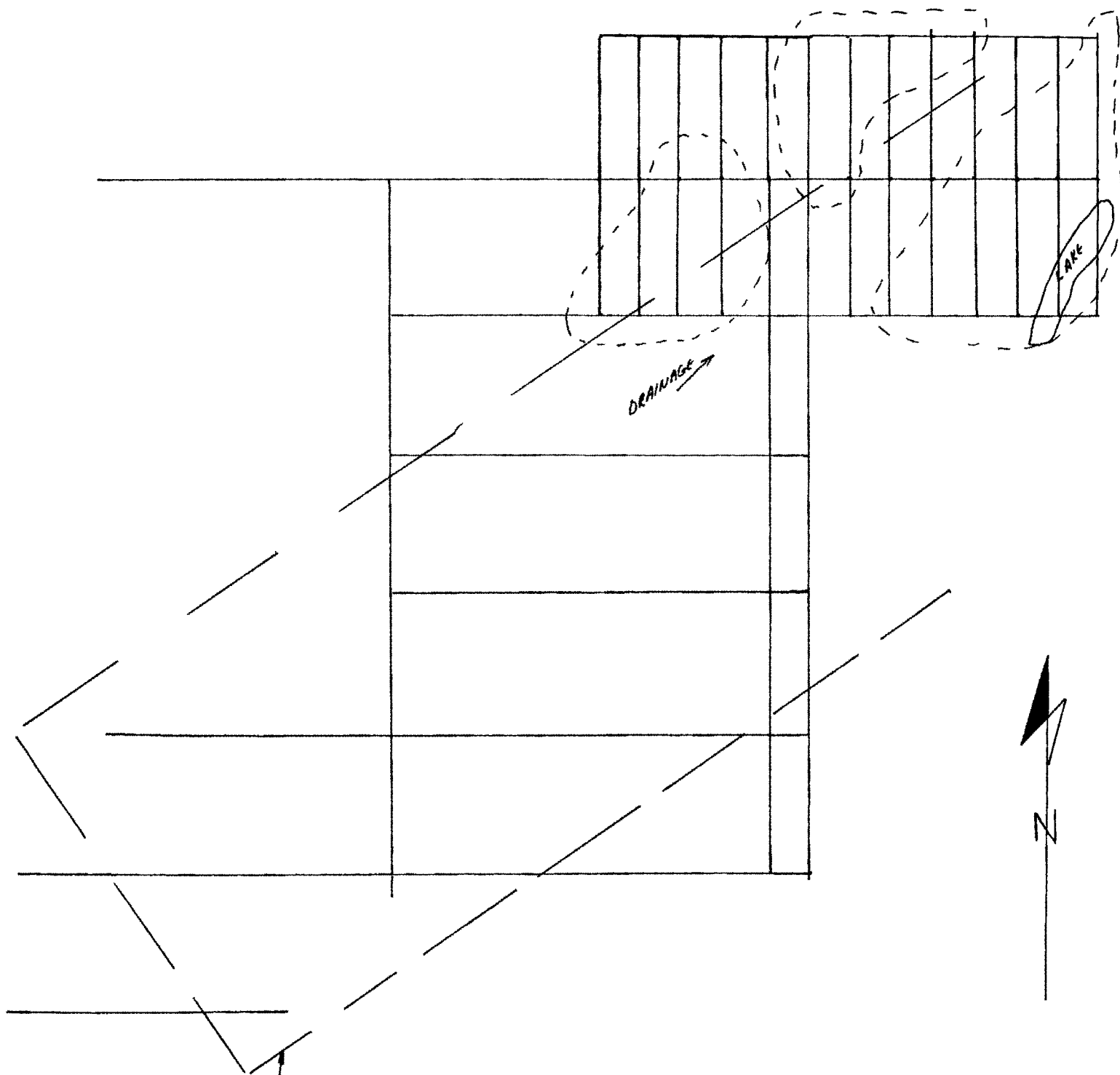

Claim boundary
AH 13-28

○ Anomalous Cu
Areas

Scale 1" = 1000'
R.U.

INTRODUCTION

The AH 13-28 claim group was staked in the Twin Lakes area in October of 1966 in order to cover an area of high geochemical copper values and a Government airbourne magnetic anomaly.

The claim group lies approx. ten miles west of Twin Lakes (mile 71 on the Dawson highway) and eighty miles NNW of Whitehorse.

The area is characterized by gentle rolling topography with heavy spruce covering in places where it is untouched by the large forest fire of 1958. The group runs approx. parallel to the main drainage in the area and traverses three low ridges and two narrow ,steep valleys.

PREVIOUS WORK

The property was originally staked by Archer and Cathro in October of 1966 after they had taken approx. ten soil samples on group and had some favourable values incopper. The group was also staked to cover a high magnetic anomaly , which ,in this area could indicate favourable mineralization.

Besides the initial sampling and staking no work had been done on the claim group.

PRESENT WORK

From the period June 2-10 Atlas Explorations ran a grid type of soil sampling of the claim group with prospecting and geological mapping being carried out simultaneously. The purpose of the grid and prospecting was to try to explain the high values found the previous year. This was done and three favourable areas were outlined with higher than normal copper content.

Geological mapping located only minor mineralization, but it was felt that the group warranted a closer look.

Accordingly, during the period August 16-18 a second geochemical grid was run, this time over the anomalous areas. At the time of writing the second set of results had not been obtained.

A party of three men did the above work (two geochemical soil samplers and a Geologist).

METHOD OF SURVEY

For the first grid, soil samples were collected at three hundred foot intervals along lines that were spaced approx. one thousand feet apart. The base line was six thousand feet long and the whole grid consisted of 42,200 feet of flagged lines. The second grid run on the group consisted of sampling on lines three hundred feet apart with samples being taken every two hundred feet. The whole of the second grid, therefore consisted of 33,800 feet of flagged line.

A total of three hundred and three samples were taken on these two grids.

All soil samples were taken from the 'B' horizon where possible with a small drift pick and samples were marked as to location after being placed in a small paper bag. These samples were then returned to Atlas Explorations soil testing laboratory in Ross River where they were dried and screened down to 80 mesh. Each was then weighed out to 0.5 grams and digested in aqua regia soln. (hot) after which their copper, and molybdenum content was determined by Atomic Absorption Spectrophotometer analysis. Results were returned to the Geologist for plotting.

RESULTS.

The results obtained from the samples collected indicate a strong anomalous copper zone fairly near to known copper mineralization in outcrops of the same rock type. The area as a whole has a fairly low background in copper, while the anomalous area has copper values of three to four times background.

CONCLUSIONS

The results of the soil surveys and geological mapping appear to be favourable as they indicate possible economic concentrations of copper mineralization in an area where minor copper mineralization has been seen. The fact that the anomalous area is three to four times background indicates, in itself, fairly high concentrations of economic mineralization.

RECOMMENDATIONS

It was recommended that a closer soil sampling grid was run over the anomalous areas and this has already been done although the results were not available at the time of writing. If these are favourable it is recommended that possible geophysics be run over the area, followed drilling if the former seem favourable.

Respectfully submitted,

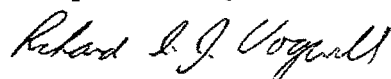

Richard I. J. Vogwill.
Geologist
Atlas Explorations Ltd.

APPENDICES.

PERSONNEL

Richard I.J. Vogwill, Geologist and Party Chief
Duration of employment with Atlas Explorations
6 months.
Residence, Vancouver, B.C.

Christopher Green, Soil Sampler,
Student Seasonal employee.
Residence, Langley, B.C.

David Lightfoot, Soil Sampler,
Student Seasonal employee
Residence, West Vancouver, B.C.

APPENDIX 1.

COST SUMMARY

Geochemical Survey and Geological
Mapping, Claims AH 13-28.

Period: June 2-10, 1967.,
and
August 16-18, 1967.

Wages:	R. Vogwill, Party Chief @ \$24/day for 9 days.....	\$216.00
	C. Green, Soil Sampler @ \$16.00/day for 12 days	\$192.00
	D. Lightfoot, Soil Sampler @ \$15.00/day for 12 days	\$180.00
Subsistence:	@ \$12/man/day for 9 days for 3 men	\$324.00
	@ \$12/man/day for 3 days for 2 men	\$72.00
Transportation:	4x4 truck 2 return trips from Whitehorse to Twin Lakes = 280 miles @ 0.30¢/mile	\$84.00
	Helicopter, 1 return trip Whitehorse to Twin Lakes plus 50 miles of haulage, = 190 miles @ 60mph = 3.16 hrs. @ \$130/hr.	\$411.00
Supervision:	pro rated \$10/man day for 12 days	\$120.00
Presentation of data:	Maps, reports etc.	\$75.00
Geochemical Analysis:	303 soil and silt samples soil prep @ 15¢/sample analysis for Cu, Pb, Zn @ \$2.50 per Total cost /sample = \$2.65 Total cost for 303 samples	\$800.00
		\$2470.00
TOTAL COSTS ON CLAIM GROUP		

AFFIDAVIT SUPPORTING SUMMARY OF COSTS

I, Richard I.J. Vogwill, Geologist for Atlas Explorations Ltd., of Whitehorse, Y.T.do hereby swear that I believe the SUMMARY OF COSTS as presented in this report "Geochemical Surveys and Geological Mapping. AH13-28, Twin Lakes area", is both true and correct to the best of my knowledge and belief.

Richard I.J. Vogwill
Richard I.J. Vogwill.

August 27/1967
Date.

A commissioner of Oaths in
and for the Yukon Territory.

Whitehorse, Y.T.
Delivered at Whitehorse, Y.