

ATLAS EXPLORATIONS LIMITED

(N. P. L.)

330 MARINE BUILDING
355 BURRARD STREET
VANCOUVER 1, B.C.

013231

Whitehorse Office.
October 17, 1966.MEETING WITH MIKE CHEFKOI IN WHITEHORSE

Mike and I discussed four situations which he has been pursuing in the Dawson area. A summary of his reports follows:

1. Mike holds 16 mineral claims (Mike group - 8 claims, Gem group - 8 claims) just north of 60 Mile River, between Miller and Glacier creeks (see sketch map of air photo Al3137-5). The claims cover a mercury showing with cinnebar occurring in a conglomerate bed just west of a north-striking fault which appears to dip 60 - 80° westerly. Another parallel fault from 1 - 2 miles west of the major fault dips roughly 50 - 60° eastward (both dips approximations from air photos). Mike's showings cover the easterly fault and mineralization appears to be related to the fault. Gold and mercury occur in stream placers just north of the western half of the group in Glacier creek, just south of the group in Miller creek, and further south - about 3 miles - in Bedrock creek. The total extent of known Hg mineralization is 2½ - 3 miles along a northerly strike and parallel to the major fault and bedrock trends.

The area is one of diverse mineralization with Pb, WO₃, and serpentine showings within 1 - 2 miles of Mike's group.

At A. Aho's suggestion Mike collected geochem. samples on 400' spaced lines, 200' stations, in the southern half of his group and these are being sent to E. O. Chisholm to be run for Hg. Some samples brought in by Mike from north of his group were suspected to be cinnabar or metacinnabar, but turned out to be fine-grained basalt which is unmineralized.

Mike's recommendations for further work are to stake about 24 more claims in the area surrounding his present block but he does not appear to have any specific targets for staking. I have recommended that he do what prospecting

MEETING WITH MIKE CHEFKOI IN WHITEHORSE (cont'd):

possible before heavy snowfall as well as to continue with the geochemical approach - the intent being to run down targets for staking rather than simple tying-on. I have laid out east-west geochem. lines across the northerly mineralized trend on a spacing of 1/4 mile for a distance of 2 miles north of his group and 2½ miles south of his group. Samples will be taken at 300' intervals on the lines. He will send samples direct to E. O. Chisholm in Vancouver and will also submit summary maps. Results should be sent as soon as possible to Mike so that he may lay out detailed geochemical work in anomalous areas.

Mike will discuss option agreement with E. O. Chisholm for his 16 claims.

December 14, 1966.

Mr. Mike Chefkoi,
General Delivery,
DAWSON CITY, Y. T.

Dear Mike:

Thanks for your letter of December 7th.

The mercury samples you mention are higher than normal but on the low side for samples representative for a mercury district. However, we will analyze the situation later and see where we go from here.

John Anderson's find sounds interesting if he could locate the place again. We should look into it next spring.

I will let you know more regarding the Alaska job after Christmas.

I was sorry to hear about the belt; it sounds like you received quite a jolt. It looks like a fellow should use a goalkeeper's outfit when jockeying one of these machines.

Hope you have a good Christmas.

Yours very truly,

ATLAS EXPLORATIONS LIMITED,

EOC:dh

E. O. Chisholm.

Ge Del.
Dawson City, Y.T.
Dec. 7, 1966.

Dear Ted;

I recieved a phone call from Ivor, he informed me that You, have a job for me for a couple of months in Alaska. Thanks Ted, a change, might change my luck up here, when I get back.

Did not get the skidoo as yet on account of th extreem cold weather we are having up here, I hope it breaks soon so that I can go and get it . Ivor told me to ship it to Whitehorse, as soon as I get it, so that he can have it repaired.

There are three samples that are encouraging for Hg. as this is the first time I had eny trace in all the assaying I had for Hg. Your numbers are, ((I93) (I950) & (I96) I believe that we are getting closer to the sourse.

There is a Indian fellow by the name of John Anderson, his brother Art Anderson is the one that found the Asbestos in Clinton Creek. John was telling me that he found something black and very heavy, and that the vein is about ten feet wide, he wants me to go in with him next spring to have a look at it, if possible. John is reliable, and I personaly believe that it might be worthwhile looking into it, he had no samples of the mineral, as it was a long time ago that he found it while traping. That is all I got to go by Ted. What do You think of it?

This is all for now Ted, exopt that there are a couple of guys going out as soon as the weather breaks to prospect for placer will let You know, ~~xxxx, xxxxx~~ xx as soon as I find out more about it

Best regards.

Mike

Mike Chefkoi.

Dear Mike:

Thanks for your letter of Dec

400 ft / inch.

L1 4

EAST

WEST

200 FT

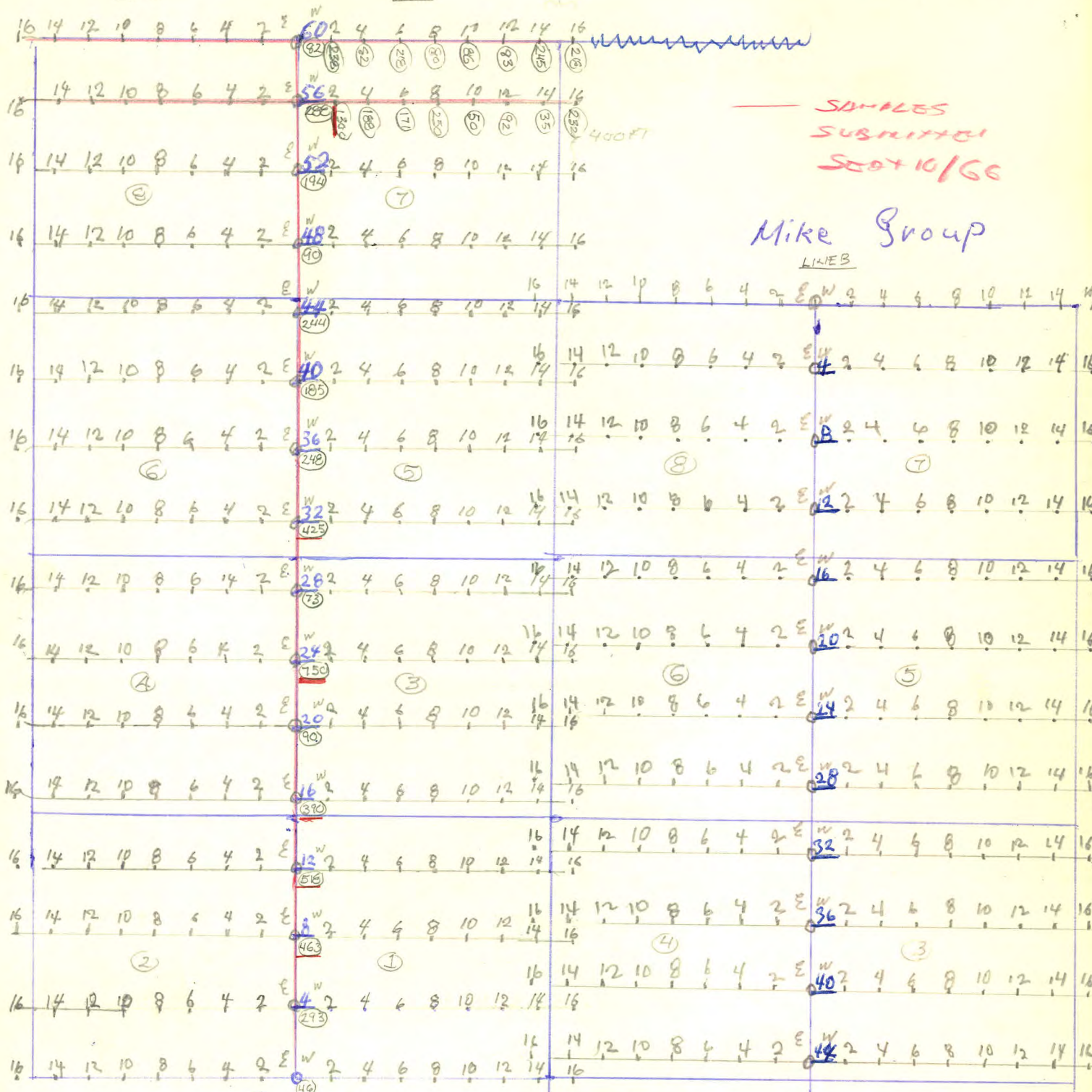

SAMPLES
SUBMITTED
SCOT 10/66

Mike Group
LINES

J E M. Group

LOCATION 1/2 WAY BETWEEN
GLACIER & MURIEL
CREEK SIX MILE AREA
SEE MAP 163-115-02
(DAWSON 944-1000)

LAT 64° 01'
LONG 143° 47'

TRUE-N

LINES 400 FT
SAMPLES 200 FT

BARRINGER RESEARCH LIMITED
304 CARLINGVIEW DRIVE,
REXDALE (TORONTO), ONTARIO

REPORT NO. 319 DATE November 14/66 LOCATION _____ SHEET 1

PROJECT Atlas Exploration Ltd. MATERIAL _____

NO. OF SAMPLES 72 COLLECTOR _____ DATE _____ ANALYST _____ DATE _____

REMARKS _____

* contains organic material

t.t. No.	Sample No.	Hg ppb		Sample Number	Hg ppb		Sample Number	Hg ppb		Sample Number	Hg ppb
	36-2+00E	35		44-10+00E	14		52-2+00W	83		56-10+00E	16
	4+00E	26		44-12+00E	35		52-4+00W	96		56-12+00E	16
	6+00E	26		44-14+00E	21		52-6+00W	100		56-14+00E	4
	8+00E	122		44-16+00E	14		52-8+00W	357		56-16+00E	678*
	10+00E	20		48-2+00W	7		52-10+00W	204		60-2+00E	22
	12+00E	9		48-4+00W	26		52-12+00W	248		60-4+00E	26
	14+00E	24		48-6+00W	10		52-14+00W	175		60-6+00E	41
	16+00E	19		48-8+00W	7		52-16+00W	287		60-8+00E	25
	40-2+00E	48		48-10+00W	20		52-2+00E	18		60-10+00E	31
	4+00E	33		48-12+00W	14		52-4+00E	18		60-12+00E	23
	6+00E	40		48-14+00W	94		52-6+00E	8		60-14+00E	24
	8+00E	25		48-16+00W	25		52-8+00E	33		60-16+00E	31
	10+00E	24		48-2+00E	29		52-10+00E	11			
	12+00E	13		48-4+00E	38		52-12+00E	8			
	14+00E	9		48-6+00E	9		52-14+00E	26			
	16+00E	27		48-8+00E	88		52-16+00E	42			
	44-2+00E	23		48-10+00E	8		56-2+00E	21			
	4+00E	15		48-12+00E	16		56-4+00E	8			
	6+00E	10		48-14+00E	18		56-6+00E	11			
	44-8+00E	11		48-16+00E	29		56-8+00E	13			

LILIEA

EAST

WEST

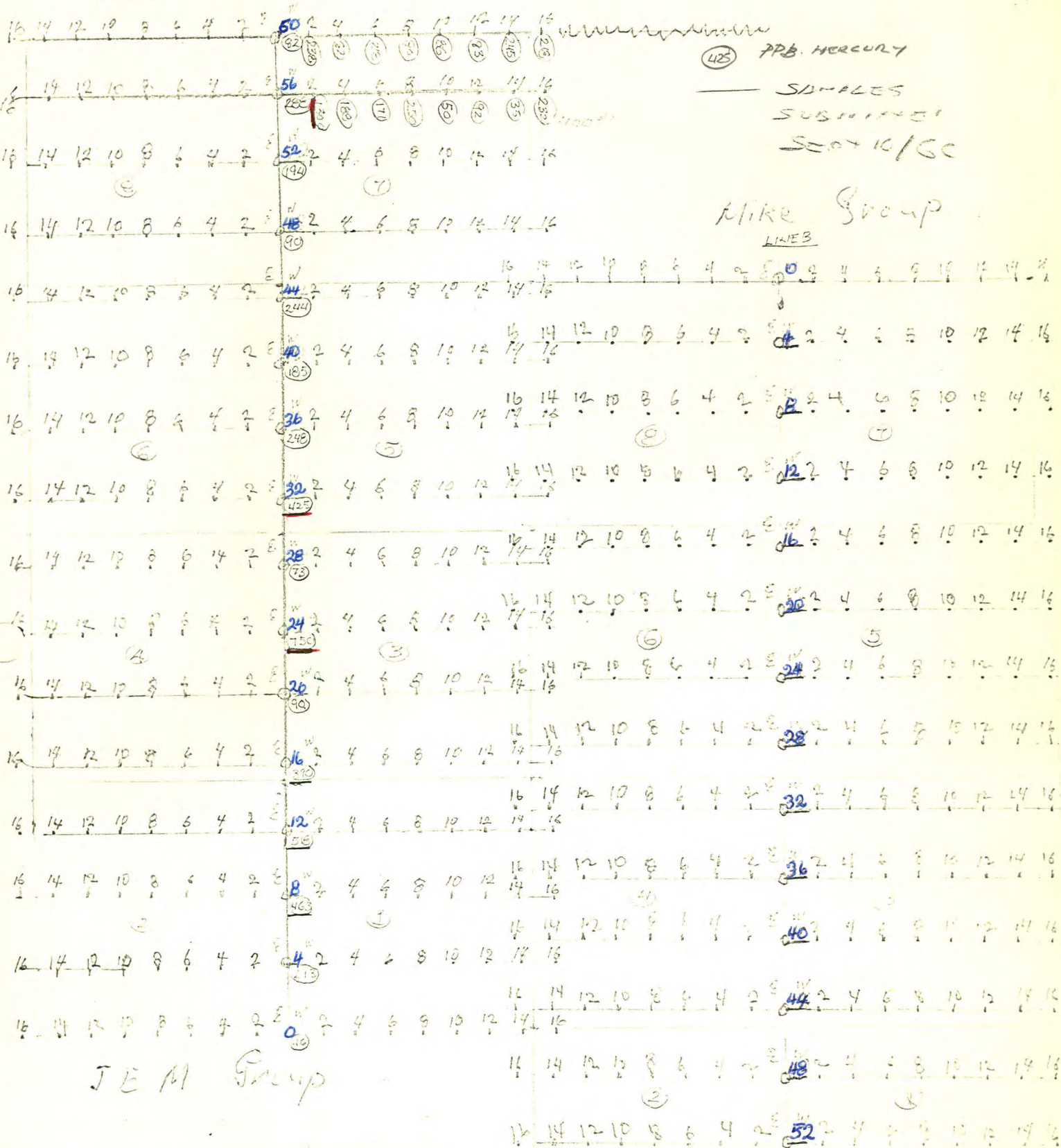

425 PPB. MERCURY
 SAMPLES
 SUBMITTED
 SCOT 10/60

Mike Group
 LINES

JEM Group

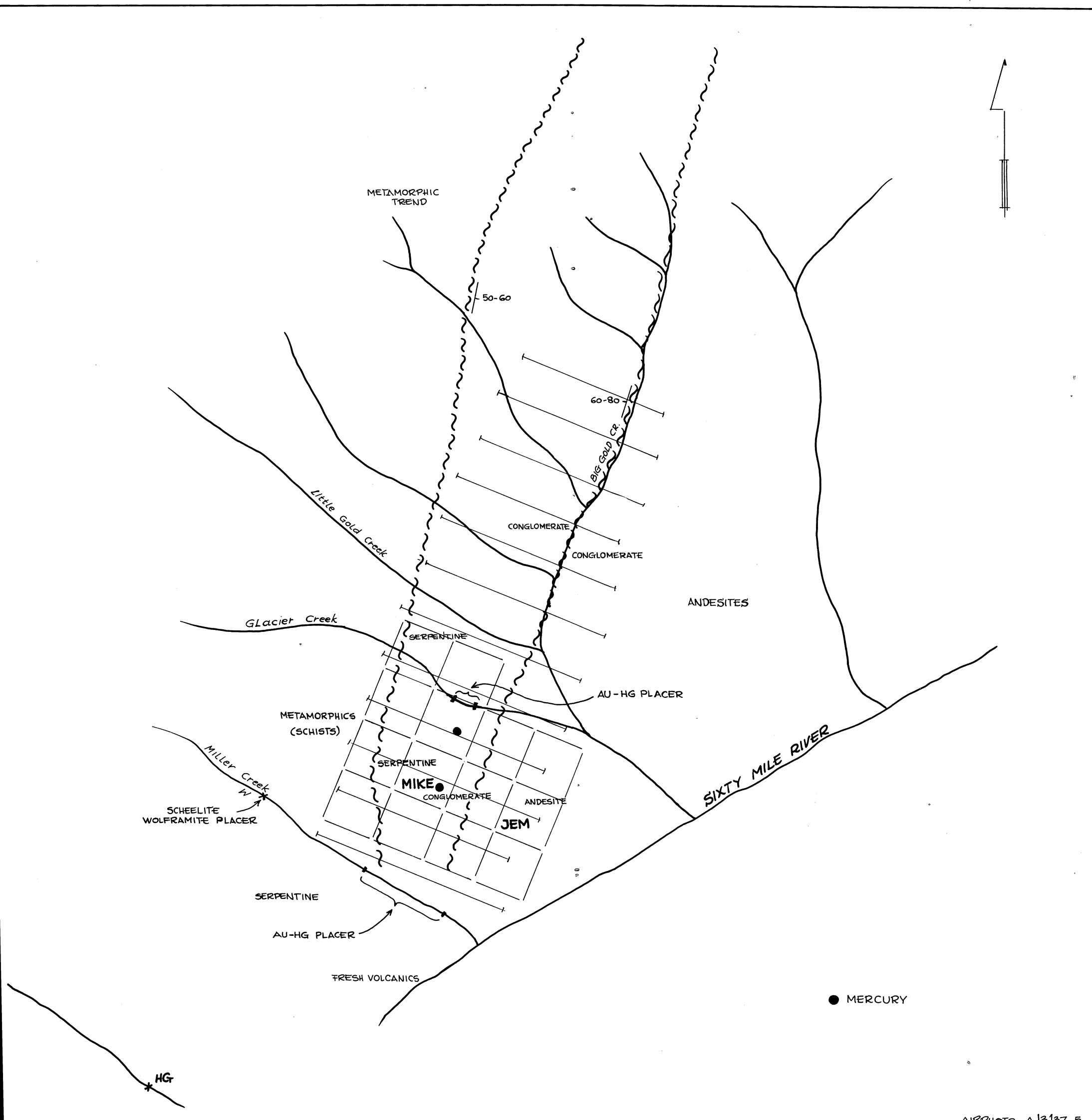

METAMORPHIC TREND

50-60

60-80

Little Gold Creek

Glacier Creek

Miller Creek

SCHEELITE WOLFRAMITE PLACER

METAMORPHICS (SCHISTS)

SERPENTINE

AU-HG PLACER

FRESH VOLCANICS

SERPENTINE

SERPENTINE

MIKE

CONGLOMERATE

ANDESITE

JEM

CONGLOMERATE

CONGLOMERATE

ANDESITES

AU-HG PLACER

SIXTY MILE RIVER

BIG GOLD CR.

● MERCURY

* HG